

INDEX OF SHEETS

SHEET NO.	TITLE
1	COVER SHEET, INDEX OF SHEETS, HIGHWAY STANDARDS
2	LEGEND, ABBREVIATIONS, GENERAL NOTES
3	SUMMARY OF QUANTITIES, SCHEDULE OF MATERIALS, TYPICAL SECTION, BENCHMARKS, COMMITMENTS
4-6	PLAN AND PROFILE: 203RD STREET
7-8	EROSION CONTROL PLAN
9	CROSS SECTIONS
10	DISTRICT ONE DETAIL TC-13 : TYPICAL PAVEMENT MARKINGS
11	DISTRICT ONE DETAIL BD-24 : CURB AND GUTTER REMOVAL AND REPLACEMENT
12	DISTRICT ONE DETAIL BD-51 : BENCHING DETAIL FOR EMBANKMENT WIDENING

STANDARD NO. STANDARD

280001-02	TEMPORARY EROSION CONTROL SYSTEMS
424001-04	CURB RAMPS FOR SIDEWALKS
606001-02	CONCRETE CURB TYPE B AND COMBINATION CONCRETE CURB AND GUTTER
664001-01	CHAIN LINK FENCE
701606-04	URBAN LANE CLOSURE, MULTILANE, 2W, WITH MOUNTABLE MEDIAN
701701-04	URBAN LANE CLOSURE, MULTILANE INTERSECTION
701801-03	LANE CLOSURE MULTILANE 1W OR 2W CROSSWALK OR SIDEWALK CLOSURE
702001-06	TRAFFIC CONTROL DEVICES
720001	SIGN PANEL MOUNTING DETAILS
720006	SIGN PANEL ERECTION DETAILS
720011	METAL POSTS FOR SIGNS, MARKERS AND DELINEATORS
729001	APPLICATIONS OF TYPES A AND B METAL POSTS (FOR SIGNS & MARKERS)
TC-13	DISTRICT ONE DETAIL: TYPICAL PAVEMENT MARKINGS
BD-24	DISTRICT ONE DETAIL: CURB AND GUTTER REMOVAL AND REPLACEMENT
BD-51	DISTRICT ONE DETAIL: BENCHING DETAIL FOR EMBANKMENT WIDENING

**THIS PROJECT IS LOCATED WITHIN THE VILLAGE OF OLYMPIA FIELDS**

CALL JULIE 1-800-592-0123 WITH THE FOLLOWING:  
 COUNTY = COOK  
 CITY-TOWNSHIP = OLYMPIA FIELDS - RICH (AREA 31)  
 SEC. & 9SEC. NO. = N.W. 1/4 OF SECTION 14  
 48 HOURS BEFORE YOU DIG  
 EXCLUDES: SAT., SUN. & HOLIDAYS

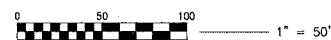
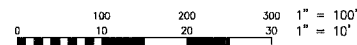

FULL SIZE PLANS HAVE BEEN PREPARED USING STANDARD ENGINEERING SCALES. REDUCED SIZED PLANS WILL NOT CONFORM TO STANDARD SCALES. IN MAKING MEASUREMENTS ON REDUCED SIZE PLANS, THE ABOVE SCALES SHALL BE USED.

BAXTER & WOODMAN, INC.  
 STATE OF ILLINOIS - PROFESSIONAL DESIGN FIRM  
 LICENSE NO. - 184-001121 - EXPIRES 4/30/2007

CONTRACT NO. 83849

COUNTY: COOK SECTION: NUMBER: 04-00023-00-BT

STATE OF ILLINOIS

DEPARTMENT OF TRANSPORTATION

DIVISION OF HIGHWAYS

**PLANS FOR PROPOSED FEDERAL AID PROJECT**

**203RD STREET (FAU 1640)  
 FROM 1/4 MILE EAST OF CRAWFORD AVE (FAU 3778)  
 TO GOVERNORS HIGHWAY (FAU 2820)  
 SECTION NO: 04-00023-00-BT  
 PROJECT NO.: CMM-00D1(650)  
 JOB NO.: C-91-353-04  
 COOK COUNTY, ILLINOIS**

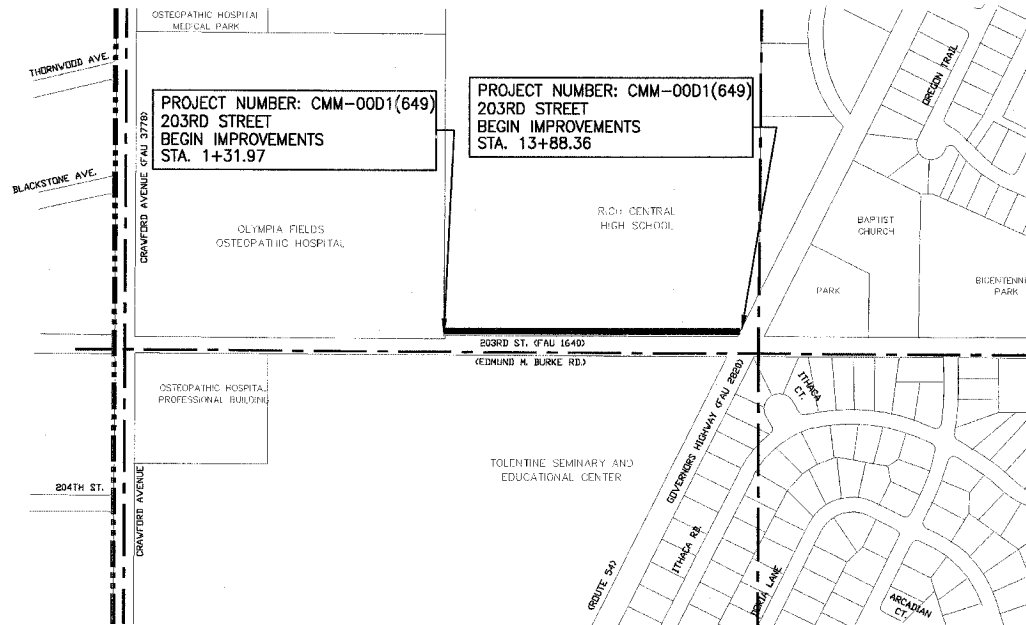

RICH TOWNSHIP (AREA 31) T35, R13E

LOCATION MAP (N.T.S.)

GROSS LENGTH OF IMPROVEMENT = 1,256 LIN. FT. OR 0.24 MILES

NET LENGTH OF IMPROVEMENT = 1,256 LIN. FT. OR 0.24 MILES



Baxter & Woodman

Burlington, Wisconsin 262.763.7834    Crystal Lake, Illinois 815.459.1260    DeKalb, Illinois 815.787.3111    Mokena, Illinois 708.478.2090    Craylake, Illinois 847.223.5088    Rockford, Illinois 815.489.1551    Plainfield, Illinois 815.609.7425

(OFFICE WHICH PREPARED PLANS)

F.A. ROUTE NO.	SECTION	COUNTY	TOTAL SHEETS	SHEET NO.
1640	04-00023-00-BT	COOK	12	1

ILLINOIS PROJECT C-91-353-04 CONTRACT NO. 83849



*Nathan J. Paul*  
 LICENSE EXPIRES 11-30-07  
 PROJECT MANAGER

*Melissa C. Unruh*  
 PROJECT ENGINEER

ENGINEER'S PROJECT NUMBER: 050686 DATE: 02-27-06

STATE OF ILLINOIS  
 DEPARTMENT OF TRANSPORTATION  
 DIVISION OF HIGHWAYS

APPROVED FEBRUARY 27, 2006

PASSED APRIL 11, 2006

SIGNED April 11, 2006

LOCAL REPRESENTATIVE  
 LOCAL REPRESENTATIVE  
 LOCAL ROADS ENGINEER  
 DEPUTY DIRECTOR OF HIGHWAYS, REGION ENGINEER

PRINTED BY THE AUTHORITY OF THE STATE OF ILLINOIS

I.D.O.T. FEDERAL AID DESIGN ENGINEER: JESSICA MILLER, 847-7705-4487 SCHAUMBURG, IL.