

F.A.U. RTE.	SECTION	COUNTY	TOTAL SHEETS	SHEET NO.
168	05-00010-00-RS	MCHENRY	25	15
STA.	118+50	TO STA.	124+50	
FED. ROAD DIST. NO. 1		ILLINOIS	HIGHWAY PROJECT	
CONTRACT # 83854				

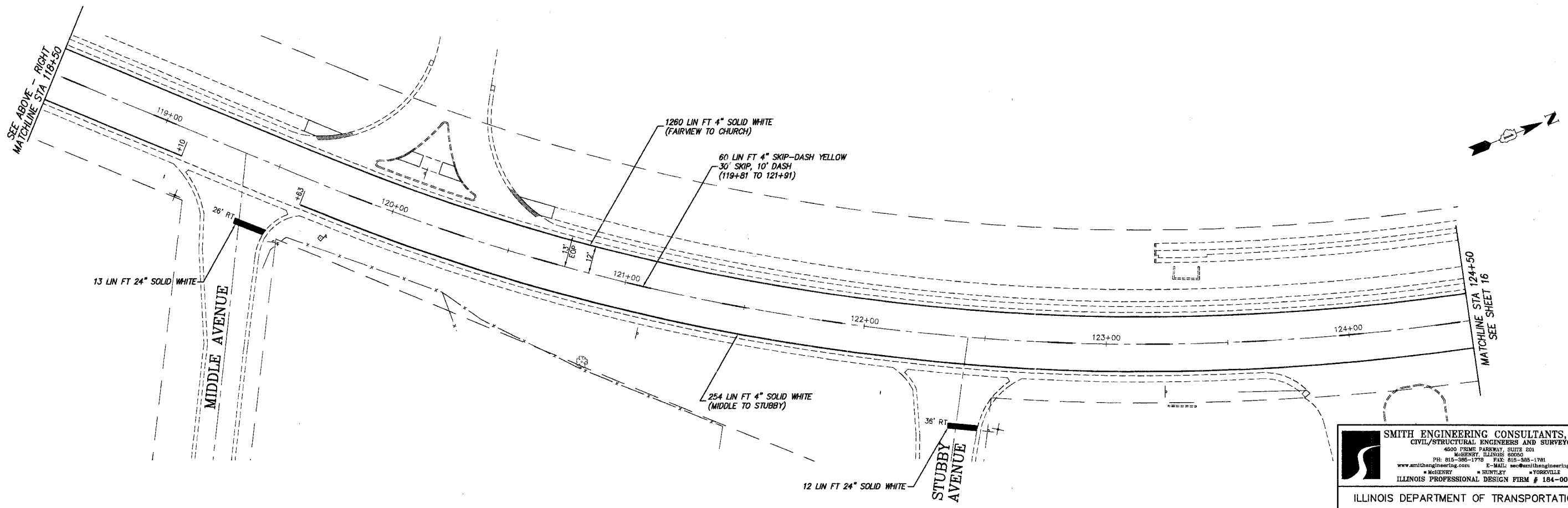
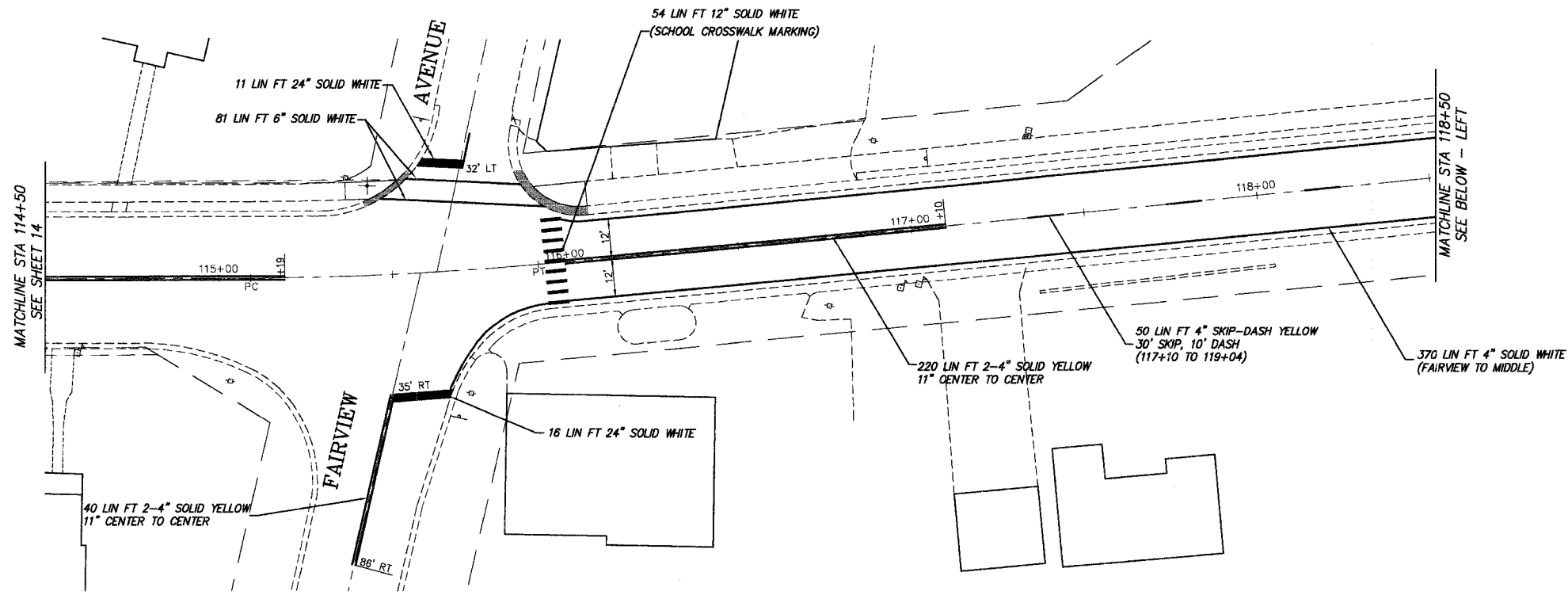
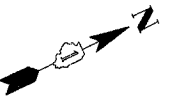

SMITH ENGINEERING CONSULTANTS, INC.
 CIVIL/STRUCTURAL ENGINEERS AND SURVEYORS
 4500 FERN PARKWAY, SUITE 201
 MCHENRY, ILLINOIS 60050
 PH: 815-385-1770 FAX: 815-385-1781
 www.smithengineering.com E-MAIL: sec@smithengineering.com
 * MCHENRY * HUNTLEY * YORKVILLE
 ILLINOIS PROFESSIONAL DESIGN FIRM # 184-000108

ILLINOIS DEPARTMENT OF TRANSPORTATION
 VILLAGE OF JOHNSBURG
 JOHNSBURG ROAD
 PAVEMENT MARKING PLAN

REVISIONS	
NO.	DATE
7.	
6.	
5.	
4.	
3.	
2.	
1.	

SCALE: 1" = 20'
 DATE 01-10-05
 DRAWN BY TK
 CHECKED BY TEH

PLOT FILE STANDARD
 VENDOR: CE-15
 COMPANY: ZEE, GORDON-BOGARD