

|                       |                |          |                 |           |
|-----------------------|----------------|----------|-----------------|-----------|
| F.A.U. RTE.           | SECTION        | COUNTY   | TOTAL SHEETS    | SHEET NO. |
| 168                   | 05-00010-00-RS | MCHENRY  | 25              | 20        |
| STA.                  | 170+50         | TO STA.  | 182+50          |           |
| FED. ROAD DIST. NO. 1 |                | ILLINOIS | HIGHWAY PROJECT |           |
| CONTRACT # 83854      |                |          |                 |           |

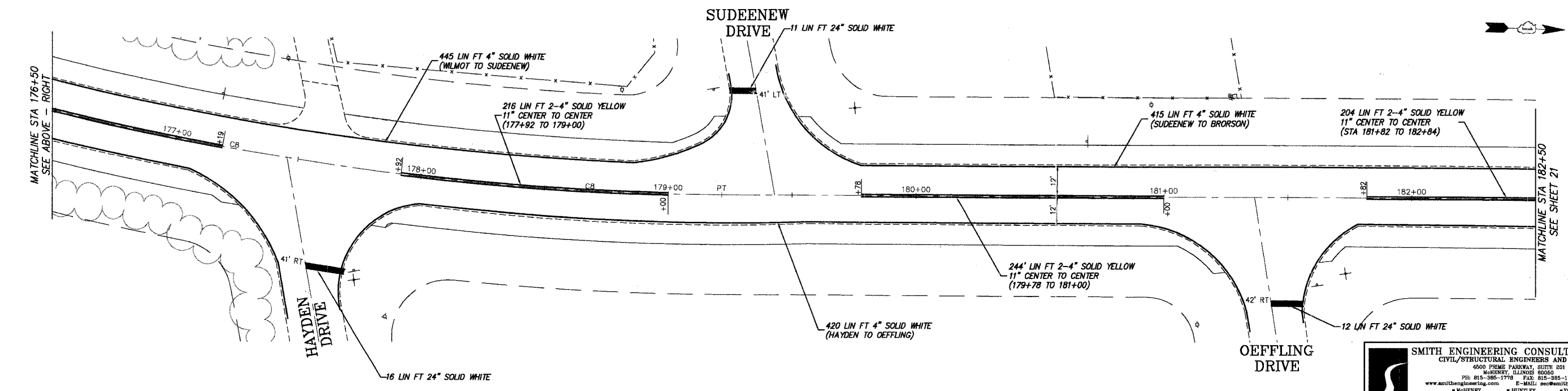
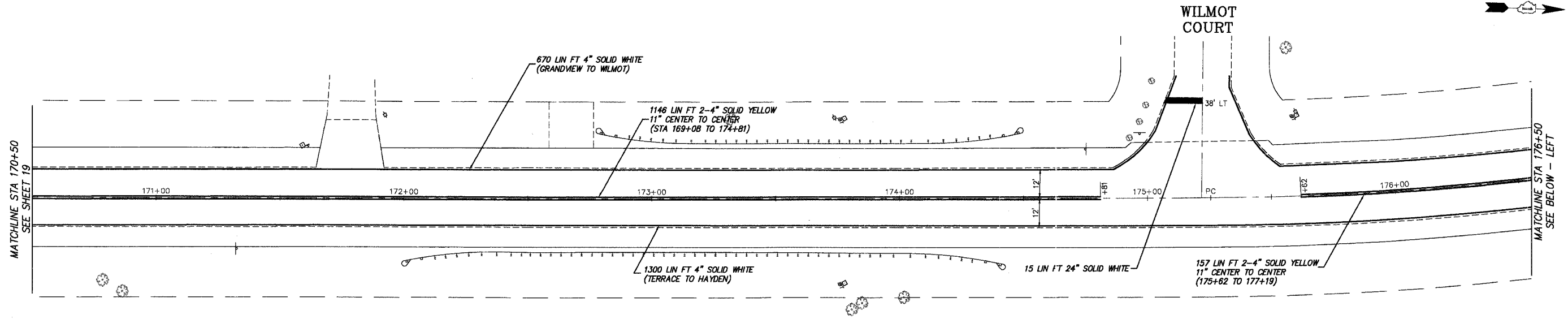
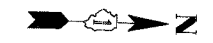

**SMITH ENGINEERING CONSULTANTS, INC.**  
 CIVIL/STRUCTURAL ENGINEERS AND SURVEYORS  
 6500 PERRY PARKWAY, SUITE 301  
 MCHENRY, ILLINOIS 60050  
 TEL: 815-385-1770 FAX: 815-385-1761  
 www.smithengineering.com E-MAIL: seo@smithengineering.com  
 \* MCHENRY \* HUNTLEY \* YORKVILLE  
 ILLINOIS PROFESSIONAL DESIGN FIRM # 184-000108

ILLINOIS DEPARTMENT OF TRANSPORTATION

VILLAGE OF JOHNSBURG  
 JOHNSBURG ROAD  
 PAVEMENT MARKING PLAN

| REVISIONS |      |
|-----------|------|
| NO.       | DATE |
| 7.        |      |
| 6.        |      |
| 5.        |      |
| 4.        |      |
| 3.        |      |
| 2.        |      |
| 1.        |      |

SCALE: 1" = 20'  
 DATE 01-10-05  
 DRAWN BY TK  
 CHECKED BY TEH

PLOT FILE: STANDARD  
 W.P. 01-20  
 COMP. FILE: 010906-000.DWG