

F.A. RYE.	SECTION	COUNTY	TOTAL SHEETS	SHEET NO.
303	03-00520-00-WR	WINNEBAGO	254	65
STA. 200+00 TO STA. 206+00				
FED. ROAD DIST. NO.		ILLINOIS	FED. AID PROJECT	

PLAN	DESIGNED	BY	DATE
	PLOTTED		
	ALIGNMENT CHECKED		
	NOTE BOOK		
	NO.		
	FILE NAME		

PROFILE	DESIGNED	BY	DATE
	PLOTTED		
	GRADES CHECKED		
	NOTE BOOK		
	NO.		
	STRUCTURE NOTATION CHRG		

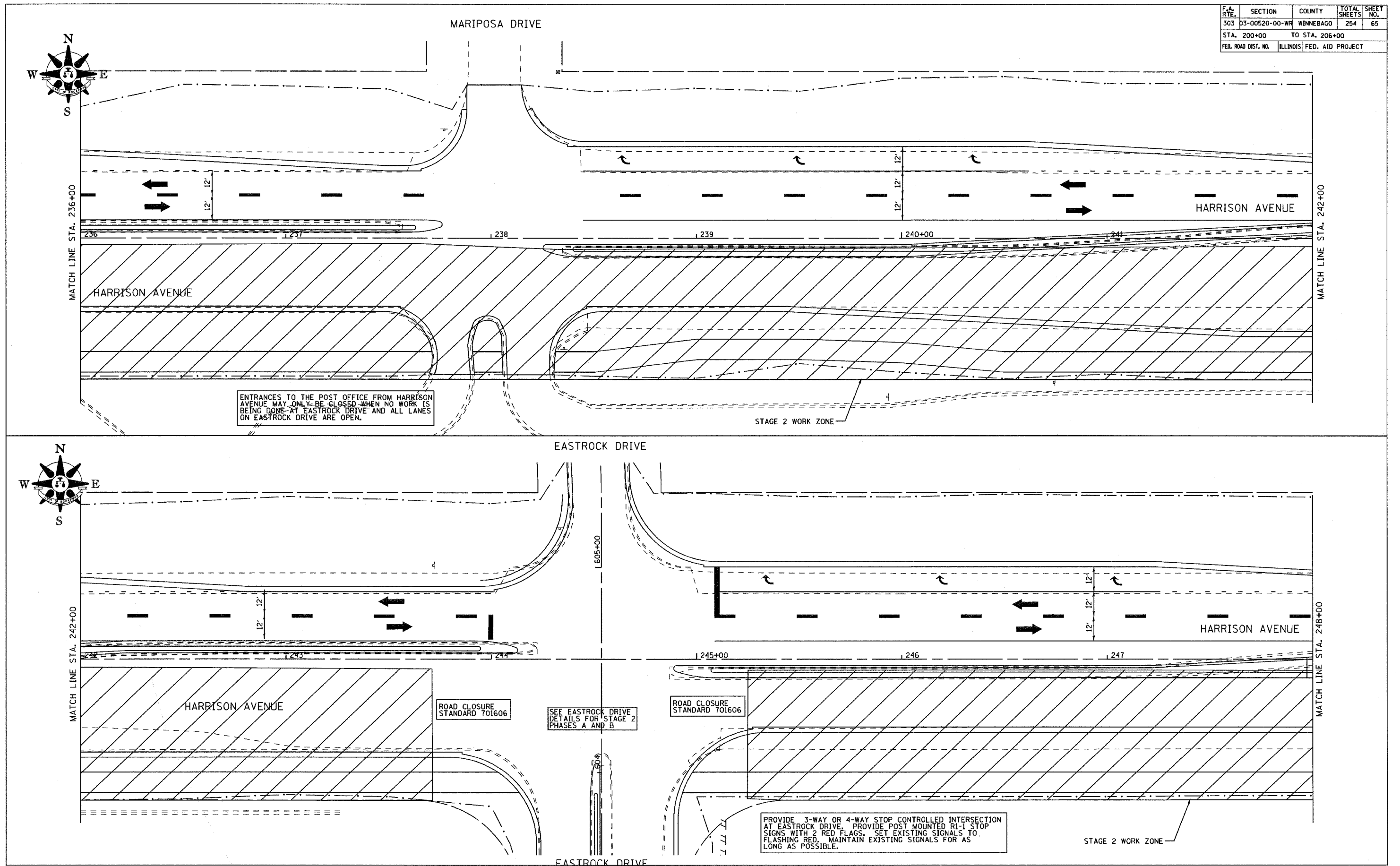

ENTRANCES TO THE POST OFFICE FROM HARRISON AVENUE MAY ONLY BE CLOSED WHEN NO WORK IS BEING DONE AT EASTROCK DRIVE AND ALL LANES ON EASTROCK DRIVE ARE OPEN.

STAGE 2 WORK ZONE

ROAD CLOSURE STANDARD 701606

SEE EASTROCK DRIVE DETAILS FOR STAGE 2 PHASES A AND B

ROAD CLOSURE STANDARD 701606

PROVIDE 3-WAY OR 4-WAY STOP CONTROLLED INTERSECTION AT EASTROCK DRIVE. PROVIDE POST MOUNTED R1-1 STOP SIGNS WITH 2 RED FLAGS. SET EXISTING SIGNALS TO FLASHING RED. MAINTAIN EXISTING SIGNALS FOR AS LONG AS POSSIBLE.

STAGE 2 WORK ZONE

STAGE 2 - STAGING PLAN HARRISON AVENUE