

| F.A. RTE. | SECTION | COUNTY | TOTAL SHEETS | SHEET NO. |
|---------------------|----------------|---------------------------|--------------|-----------|
| 303 | 03-00520-00-WF | WINNEBAGO | 254 | 125 |
| STA. 5+00 | | TO STA. 10+50 | | |
| FED. ROAD DIST. NO. | | ILLINOIS FED. AID PROJECT | | |

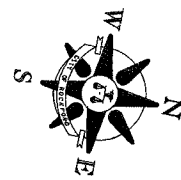

CONTRACTOR SHALL VERIFY LOCATION AND DEPTH OF EXISTING UTILITIES PRIOR TO BEGINNING CONSTRUCTION

61' PIPE CULVERT REMOVAL
 226' STORM SEW CL A 1 18
 R 832.24 - 828.50
 1 EA PRC FLAR END SEC 18
 STA. 8+66.65 38.2' LT

DARLENE DRIVE

EXISTING RIGHT-OF-WAY

MULFORD ROAD

MATCH LINE STA. 10+50

| | |
|----------|--|
| DATE | |
| BY | |
| REVIEWED | |
| PLANNED | |
| NOTED | |
| ALIGNED | |
| CHECKED | |
| FILED | |
| NO. | |

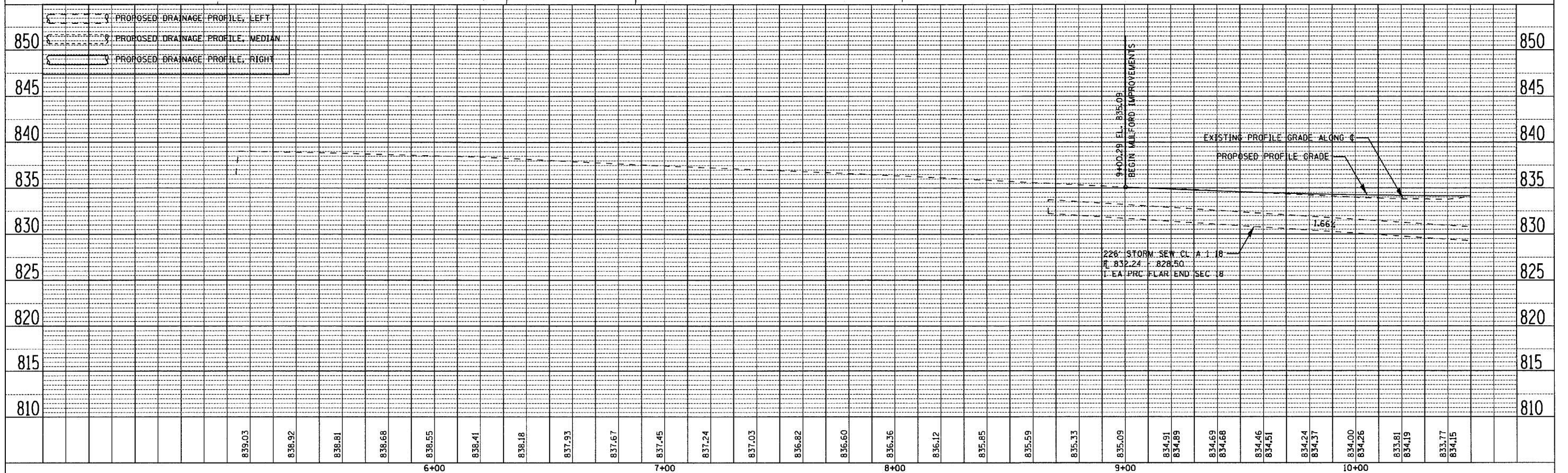
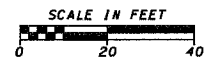

| | |
|----------|--|
| DATE | |
| BY | |
| REVIEWED | |
| PLANNED | |
| NOTED | |
| ALIGNED | |
| CHECKED | |
| FILED | |
| NO. | |

MULFORD ROAD DRAINAGE DETAILS - STA. 5+00 TO 10+50