

E.A. RYE	SECTION	COUNTY	TOTAL SHEETS	SHEET NO.
303	03-00520-00-WR	WINNEBAGO	254	176
STA.		TO STA.		
FED. ROAD DIST. NO.		ILLINOIS		FED. AID PROJECT

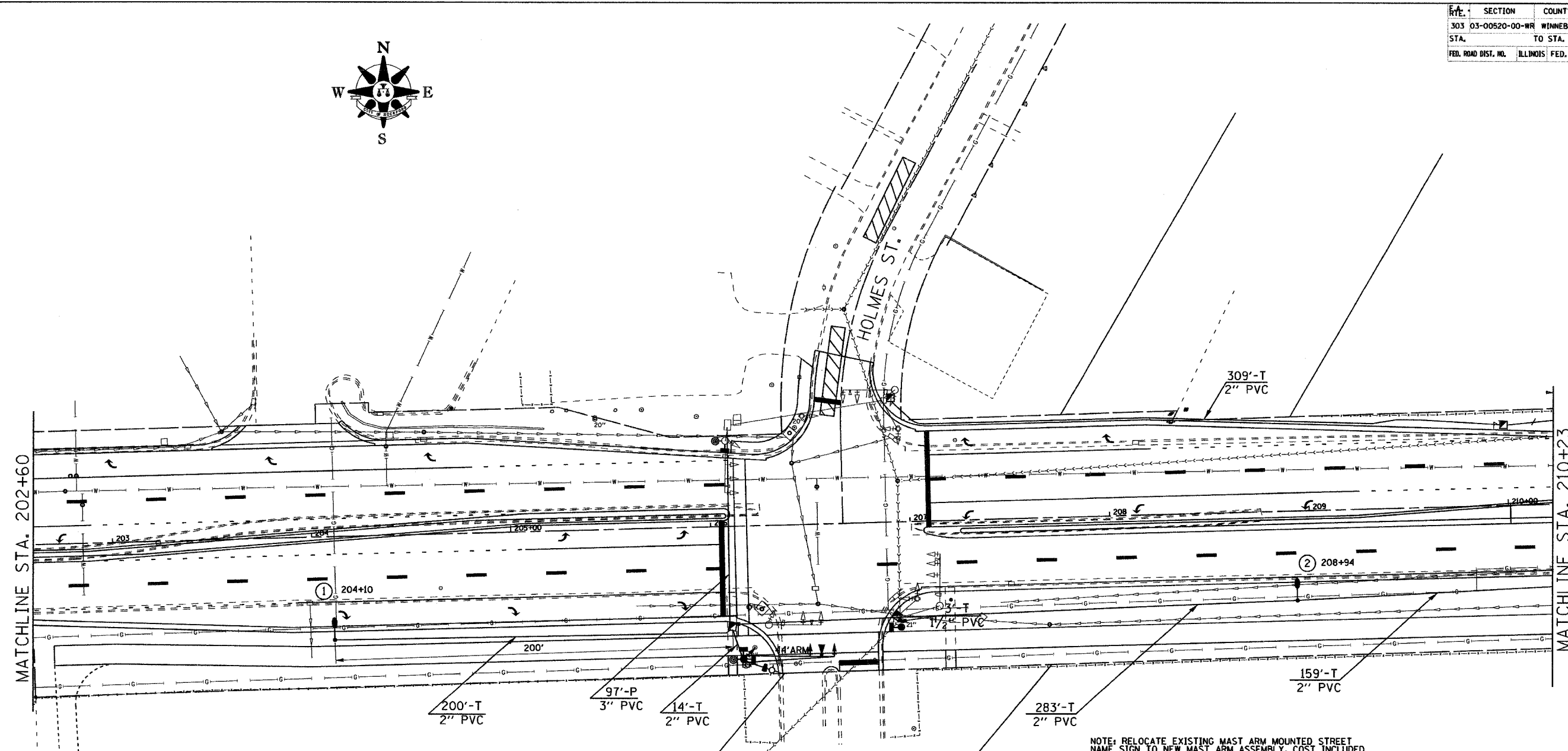

NOTE: RELOCATE EXISTING MAST ARM MOUNTED STREET NAME SIGN TO NEW MAST ARM ASSEMBLY. COST INCLUDED IN STEEL COMBINATION MAST ARM ASSEMBLY AND POLE.

REMOVE EXISTING TRAFFIC SIGNAL EQUIPMENT

- NW CORNER
- SIGNAL POST, SIGNAL BASE, 1-FACE PED HEAD, PED PUSH BUTTON
- NE CORNER
- HANDHOLE, SIGNAL BASE, SIGNAL POST, 2-FACE PED HEAD, 2 PUSH BUTTONS
- SE CORNER
- HANDHOLE, SIGNAL BASE, SIGNAL POST, 2-FACE PED HEAD, 2 PUSH BUTTONS
- SW CORNER
- HANDHOLE, SIGNAL BASE, SIGNAL POST, 1-FACE PED HEAD, 1 PUSH BUTTON, MAST ARM ASSEMBLY AND BASE, 3 SIGNAL HEADS, 1 VIDEO DETECTION CAMERA, 1 EMERGENCY VEHICLE DETECTOR

- LEGEND**
- STEEL COMBINATION MAST ARM ASSEMBLY AND POLE
 - PEDESTRIAN PUSH BUTTON
 - PEDESTRIAN SIGNAL HEAD
 - VIDEO DETECTION CAMERA
 - TRAFFIC SIGNAL HEAD
 - EMERGENCY VEHICLE LIGHT DETECTOR
 - VIDEO SURVEILLANCE CAMERA