

| F.A.P. RTE. | SECTION | COUNTY | TOTAL SHEETS | SHEET NO. |
|---------------------|--------------|---------------------------|--------------|-----------|
| 669 | 11W-3,RS-8,* | TAZEWELL | 442 | 125 |
| STA. 258+30 | | TO STA. 273+70 | | |
| FED. ROAD DIST. NO. | | ILLINOIS FED. AID PROJECT | | |

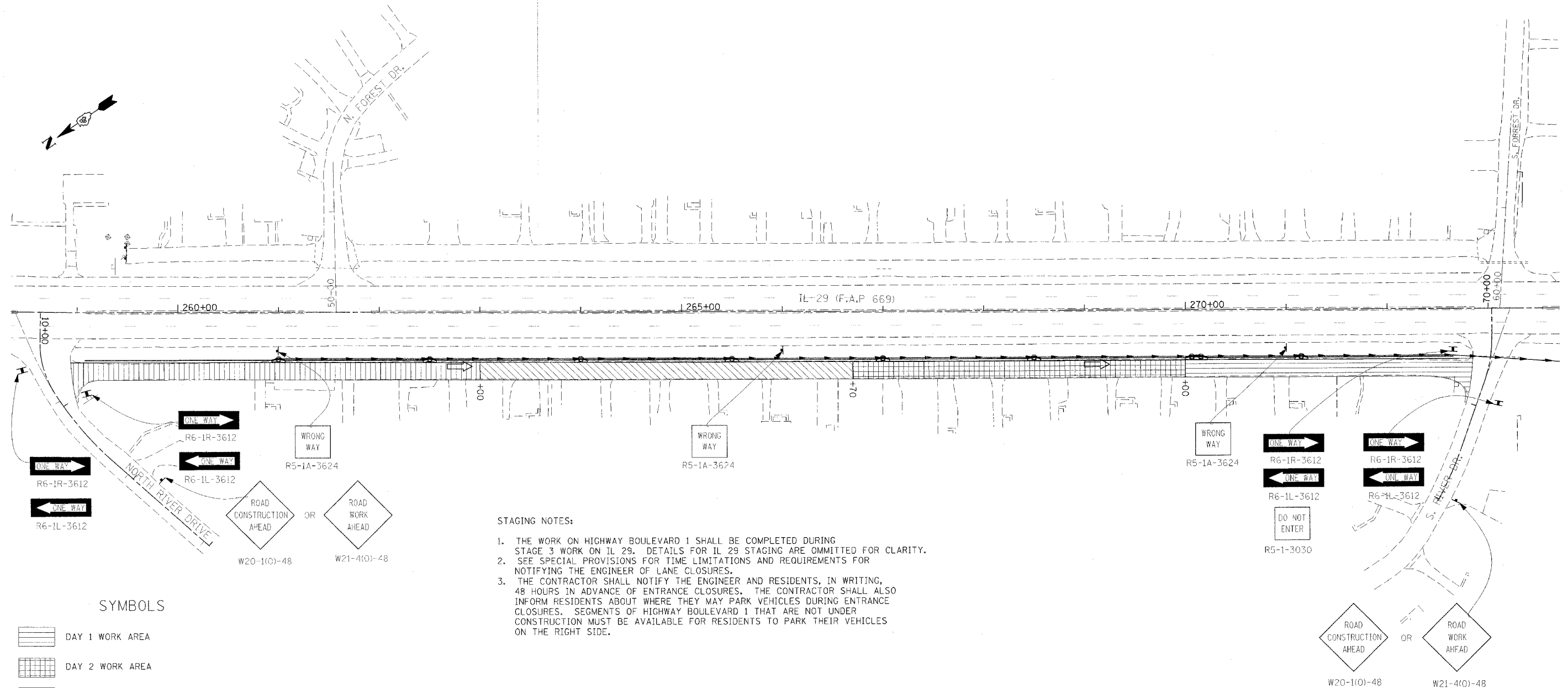

STAGING NOTES:

1. THE WORK ON HIGHWAY BOULEVARD 1 SHALL BE COMPLETED DURING STAGE 3 WORK ON IL 29. DETAILS FOR IL 29 STAGING ARE OMITTED FOR CLARITY.
2. SEE SPECIAL PROVISIONS FOR TIME LIMITATIONS AND REQUIREMENTS FOR NOTIFYING THE ENGINEER OF LANE CLOSURES.
3. THE CONTRACTOR SHALL NOTIFY THE ENGINEER AND RESIDENTS, IN WRITING, 48 HOURS IN ADVANCE OF ENTRANCE CLOSURES. THE CONTRACTOR SHALL ALSO INFORM RESIDENTS ABOUT WHERE THEY MAY PARK VEHICLES DURING ENTRANCE CLOSURES. SEGMENTS OF HIGHWAY BOULEVARD 1 THAT ARE NOT UNDER CONSTRUCTION MUST BE AVAILABLE FOR RESIDENTS TO PARK THEIR VEHICLES ON THE RIGHT SIDE.

SYMBOLS

- DAY 1 WORK AREA
- DAY 2 WORK AREA
- DAY 3 WORK AREA
- DAY 4 WORK AREA
- Arrow board
- Sign
- Direction Indicator barricade with steady burn monodirectional light
- Drum with steady burn monodirectional light
- Type III barricade with flashing monodirectional lights
- Flexible delineator
- Type II barricade, drum, or vertical barricade with steady burn monodirectional light

CONSTRUCTION

1. REMOVE EXISTING PAVEMENT, GRADE FOR BASE COURSE, AND PLACE BASE COURSE IN ONE DAY FOR EACH WORK AREA SHOWN. THIS WORK SHALL ONLY BE PERFORMED ON WEEKDAYS BETWEEN 8:00 AM AND 4:00 PM. THE PROPOSED BASE COURSE SHALL BE OPEN TO TRAFFIC BY 4:00 PM. WORK AREAS SHOWN ARE RECOMMENDED. THEY MAY BE REVISED WITH WRITTEN PERMISSION FROM THE ENGINEER. USE AGGREGATE FOR TEMPORARY ACCESS TO CONSTRUCT TEMPORARY RAMPS AT THE ENDS OF THE BASE COURSE PLACED EACH DAY. ALSO USE AGGREGATE FOR TEMPORARY ACCESS AT ENTRANCES. ACCESS TO ALL DRIVEWAYS SHALL BE PROVIDED BY 4 PM.
2. PLACE SURFACE COURSE ONE LANE AT A TIME.
3. RECONSTRUCT ENTRANCES. ENTRANCES SHALL NOT BE CLOSED FOR LONGER THAN 48 HOURS.

TRAFFIC CONTROL

MAINTAIN ONE OPEN LANE SOUTHBOUND. TWO WAY TRAFFIC WILL BE ALLOWED IN THE ONE OPEN LANE ONLY WHEN THE CONTRACTOR IS WORKING ON PAVEMENT REMOVAL OR BASE COURSE IN ONE OF THE WORK AREAS BETWEEN 8:00 AM AND 4:00 PM ON WEEKDAYS. A FLAGGER WILL BE REQUIRED WHEN MOVING CONSTRUCTION EQUIPMENT OR TRUCKS IN THIS ONE OPEN LANE. RESIDENTS SHALL BE ALLOWED TO PARK VEHICLES ALONG THE RIGHT SIDE OF THE FRONTAGE ROAD IN AREAS THAT ARE NOT UNDER CONSTRUCTION.

MAINTAIN ONE OPEN LANE SOUTHBOUND.

MAINTAIN ONE OPEN LANE SOUTHBOUND. RESIDENTS MAY PARK ALONG THE RIGHT SIDE OF HIGHWAY BOULEVARD 1.

| REVISIONS | |
|-----------|------|
| NAME | DATE |
| | |
| | |
| | |
| | |
| | |
| | |
| | |
| | |
| | |
| | |

ILLINOIS DEPARTMENT OF TRANSPORTATION

FRONTAGE ROAD
SUGGESTED STAGES OF CONSTRUCTION
AND TRAFFIC CONTROL
STAGE 3B

SCALE: VERT.
HORIZ.
DATE

DRAWN BY
CHECKED BY

PLOT DATE = 4/19/2006
 FILE NAME = c:\projects\secta\29\stage3b.dgn
 PLOT SCALE = 1/8"=1'-0"
 USER NAME = harsky