

F.A.P. RTE.	SECTION	COUNTY	TOTAL SHEETS	SHEET NO.
669	11W-3,RS-8,*	TAZEWELL	442	157
STA. 331+50		TO STA. 337+00		
FED. ROAD DIST. NO.		ILLINOIS	FED. AID PROJECT	

\* 11BR-1, 11BR-2

MATCH LINE STATION 331+50

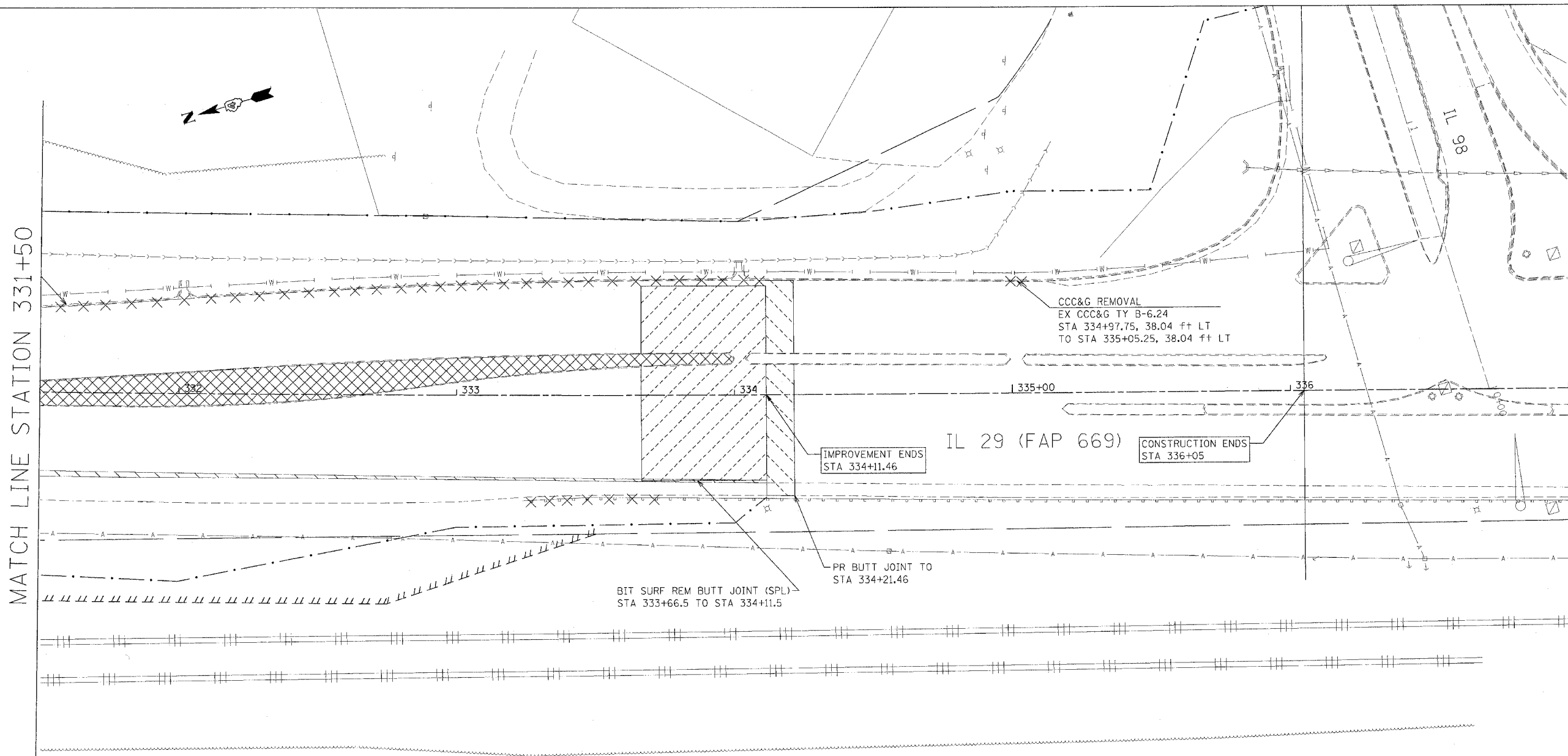

LEGEND FOR REMOVAL ITEMS

- |  |                                |  |                      |  |                               |
|--|--------------------------------|--|----------------------|--|-------------------------------|
|  | PAVEMENT REMOVAL               |  | CCC & G REMOVAL      |  | BIT SURF REM BUTT JOINT (SPL) |
|  | PAVEMENT REMOVAL (SPECIAL)     |  | GUARDRAIL REMOVAL    |  | BIT SURF REM - BUTT JOINT     |
|  | SHOULDER REMOVAL               |  | BUILDING REMOVAL     |  |                               |
|  | DRIVEWAY PAVEMENT REMOVAL      |  | SPECIAL EXCAVATION   |  |                               |
|  | MEDIAN REMOVAL                 |  | TREE REMOVAL         |  |                               |
|  | MEDIAN REMOVAL (PARTIAL DEPTH) |  | TREE REMOVAL (ACRE)  |  |                               |
|  |                                |  | REVTMENT MAT REMOVAL |  |                               |

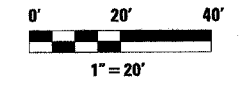

NOTE: BIT SURF REM 2" FROM STA 258+00 TO STA 267+83 AND STA 277+39.82 TO 286+05 IN SOUTH BOUND LANES ONLY AND BIT SURF REM 1-1/2" ELSEWHERE ON IL 29 MAINLINE.

REVISIONS	
NAME	DATE

ILLINOIS DEPARTMENT OF TRANSPORTATION

## REMOVAL PLANS

SCALE: VERT. \_\_\_\_\_  
 HORIZ. \_\_\_\_\_  
 DATE \_\_\_\_\_

DRAWN BY \_\_\_\_\_  
 CHECKED BY \_\_\_\_\_