

F.A.P. RTE.	SECTION	COUNTY	TOTAL SHEETS	SHEET NO.
669	11W-3,RS-8,*	TAZEWELL	442	195
STA. 258+50		TO STA.264+00		
FED. ROAD DIST. NO.		ILLINOIS	FED. AID PROJECT	

* 11BR-1, 11BR-2

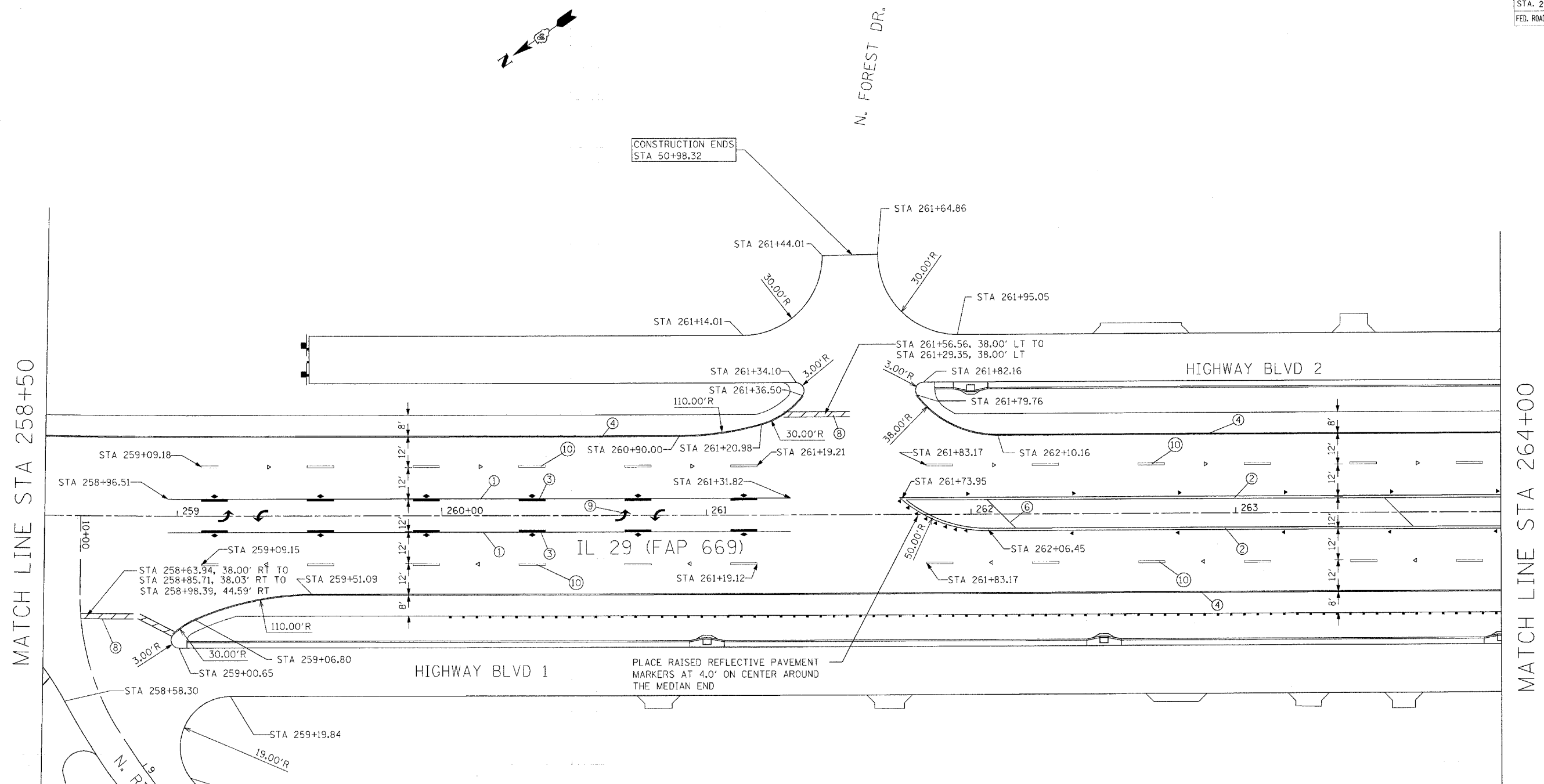

CONSTRUCTION ENDS
STA 50+98.32

CONSTRUCTION ENDS
STA 8+54.27

LEGEND

- ① EPOXY PAVEMENT MARKING - LINE 4" YELLOW SOLID
- ② EPOXY PAVEMENT MARKING - LINE 4" DOUBLE YELLOW SOLID
- ③ EPOXY PAVEMENT MARKING - LINE 4" YELLOW SKIP DASH
- ④ EPOXY PAVEMENT MARKING - LINE 4" WHITE SOLID
- ⑤ EPOXY PAVEMENT MARKING - LINE 8" WHITE SOLID
- ⑥ EPOXY PAVEMENT MARKING - LINE 12" YELLOW SOLID
- ⑦ EPOXY PAVEMENT MARKING - LINE 12" WHITE SOLID
- ⑧ EPOXY PAVEMENT MARKING - LINE 24" WHITE SOLID
- ⑨ EPOXY PAVEMENT MARKING - LETTERS AND SYMBOLS
- ⑩ PREFORMED PLASTIC PAVEMENT MARKING, TYPE B - LINE 6" WHITE SKIP DASH
- ⑪ PAINT PAVEMENT MARKING - LINE 4" YELLOW SOLID
- ⑫ PAINT PAVEMENT MARKING - LETTERS AND SYMBOLS

- △ ONE-WAY CRYSTAL MARKER
- ▲ ONE-WAY AMBER MARKER
- ◆ TWO-WAY AMBER MARKER

NOTE: SEE STANDARDS 780001, 781001, AND 780001-D4 FOR DETAILS NOT SHOWN.

PLACE RAISED REFLECTIVE PAVEMENT MARKERS AT 4.0' ON CENTER AROUND THE MEDIAN END

MATCH LINE STA 258+50

MATCH LINE STA 264+00

PLOT DATE = 4/10/2005
 FILE NAME = c:\pwork\11w-3\11w-3rs-8\p195.dgn
 PLOT SCALE = 20.00000 / IN.
 USER NAME = ahoughz

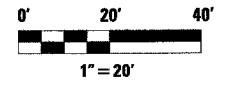

REVISIONS	
NAME	DATE

ILLINOIS DEPARTMENT OF TRANSPORTATION

PAVEMENT MARKING PLANS

SCALE: VERT. _____
HORIZ. _____
DATE _____

DRAWN BY _____
CHECKED BY _____