

F.A.P. RTE.	SECTION	COUNTY	TOTAL SHEETS	SHEET NO.
669	11W-3,RS-8,*	TAZEWELL	442	204
STA. 309+50		TO STA.315+00		
FED. ROAD DIST. NO.	ILLINOIS	FED. AID PROJECT		

• 11BR-1, 11BR-2

MATCH LINE STATION 309+50

MATCH LINE STATION 315+00

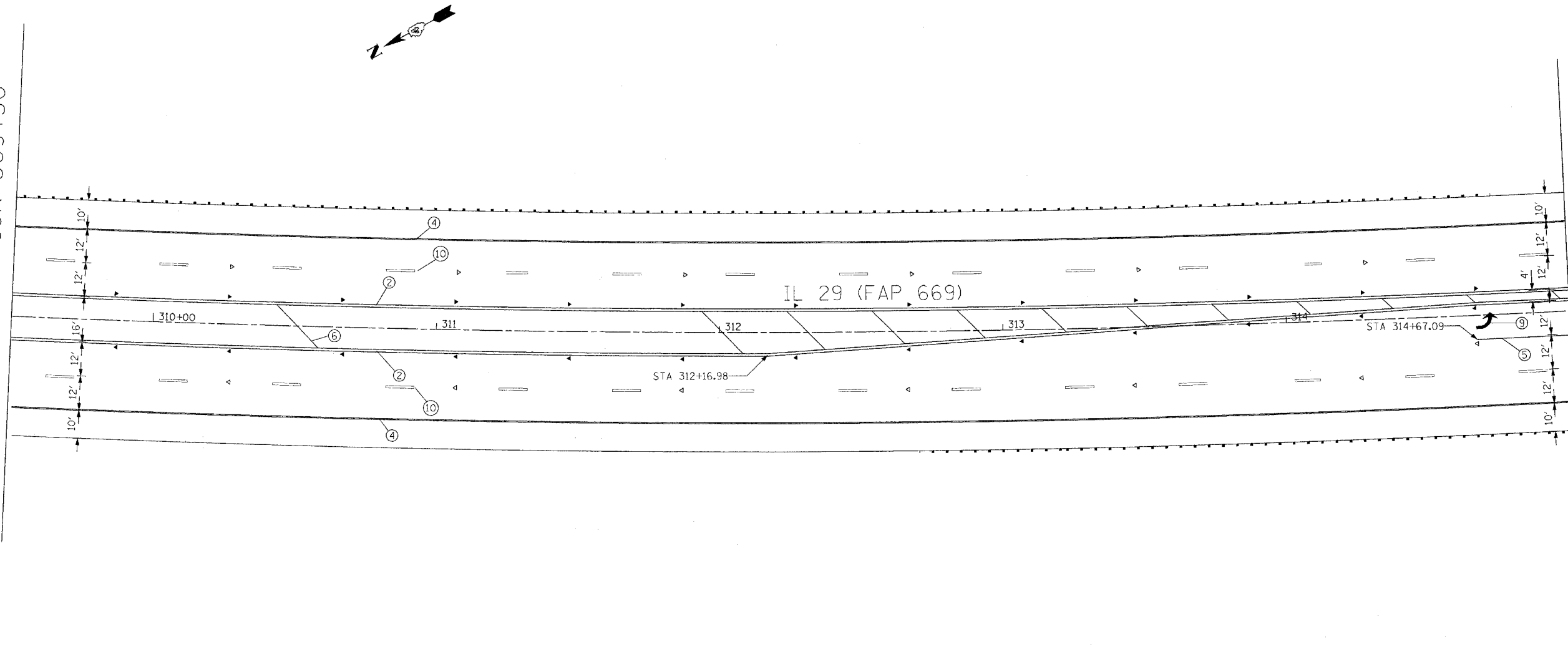

LEGEND

- ① EPOXY PAVEMENT MARKING - LINE 4" YELLOW SOLID
 - ② EPOXY PAVEMENT MARKING - LINE 4" DOUBLE YELLOW SOLID
 - ③ EPOXY PAVEMENT MARKING - LINE 4" YELLOW SKIP DASH
 - ④ EPOXY PAVEMENT MARKING - LINE 4" WHITE SOLID
 - ⑤ EPOXY PAVEMENT MARKING - LINE 8" WHITE SOLID
 - ⑥ EPOXY PAVEMENT MARKING - LINE 12" YELLOW SOLID
 - ⑦ EPOXY PAVEMENT MARKING - LINE 12" WHITE SOLID
 - ⑧ EPOXY PAVEMENT MARKING - LINE 24" WHITE SOLID
 - ⑨ EPOXY PAVEMENT MARKING - LETTERS AND SYMBOLS
 - ⑩ PREFORMED PLASTIC PAVEMENT MARKING, TYPE B - LINE 6" WHITE SKIP DASH
 - ⑪ PAINT PAVEMENT MARKING - LINE 4" YELLOW SOLID
 - ⑫ PAINT PAVEMENT MARKING - LETTERS AND SYMBOLS
- △ ONE-WAY CRYSTAL MARKER
 - ▲ ONE-WAY AMBER MARKER
 - ◆ TWO-WAY AMBER MARKER

NOTE: SEE STANDARDS 780001, 781001, AND 780001-D4 FOR DETAILS NOT SHOWN.

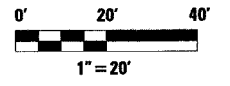

REVISIONS	
NAME	DATE

ILLINOIS DEPARTMENT OF TRANSPORTATION
PAVEMENT MARKING PLANS

SCALE: VERT. _____
HORIZ. _____
DATE _____ DRAWN BY _____
CHECKED BY _____

PLOT DATE = 4/18/2005
FILE NAME = c:\p\projects\1126\pavmark\phase_11_26\pld\p.mxd
PLOT SCALE = 20.00000 / IN.
USER NAME = shoppz