

F.A.P. RTE.	SECTION	COUNTY	TOTAL SHEETS	SHEET NO.
669	11W-3,RS-8,*	TAZEWELL	442	207
STA. 326+00		TO STA.331+50		
FED. ROAD DIST. NO.		ILLINOIS FED. AID PROJECT		
* 11BR-1, 11BR-2				

MATCH LINE STATION 326+00

MATCH LINE STATION 331+50

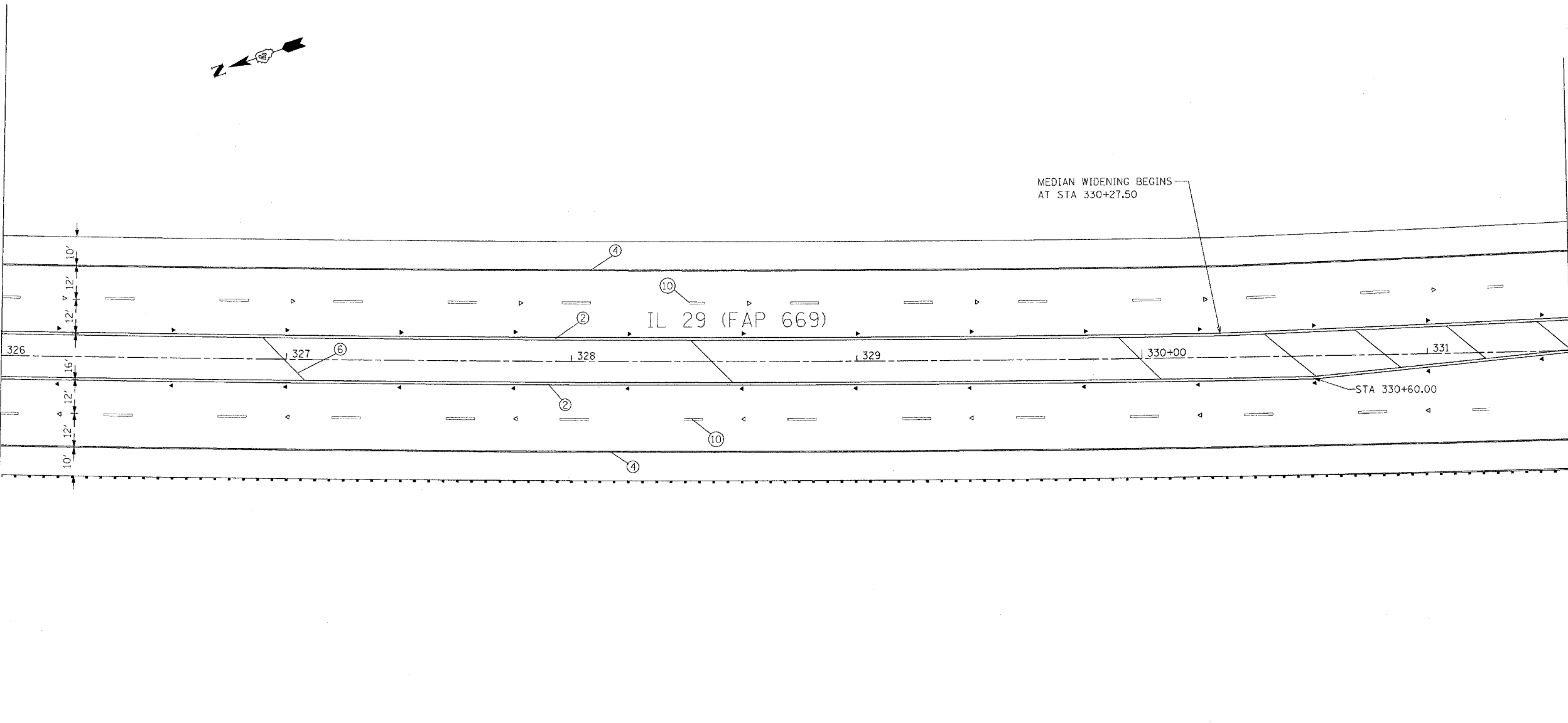

LEGEND

- | | |
|------------------------------------------------------------------------|--------------------------|
| ① EPOXY PAVEMENT MARKING - LINE 4" YELLOW SOLID | △ ONE-WAY CRYSTAL MARKER |
| ② EPOXY PAVEMENT MARKING - LINE 4" DOUBLE YELLOW SOLID | ▲ ONE-WAY AMBER MARKER |
| ③ EPOXY PAVEMENT MARKING - LINE 4" YELLOW SKIP DASH | ◆ TWO-WAY AMBER MARKER |
| ④ EPOXY PAVEMENT MARKING - LINE 4" WHITE SOLID | |
| ⑤ EPOXY PAVEMENT MARKING - LINE 8" WHITE SOLID | |
| ⑥ EPOXY PAVEMENT MARKING - LINE 12" YELLOW SOLID | |
| ⑦ EPOXY PAVEMENT MARKING - LINE 12" WHITE SOLID | |
| ⑧ EPOXY PAVEMENT MARKING - LINE 24" WHITE SOLID | |
| ⑨ EPOXY PAVEMENT MARKING - LETTERS AND SYMBOLS | |
| ⑩ PREFORMED PLASTIC PAVEMENT MARKING, TYPE B - LINE 6" WHITE SKIP DASH | |
| ⑪ PAINT PAVEMENT MARKING - LINE 4" YELLOW SOLID | |
| ⑫ PAINT PAVEMENT MARKING - LETTERS AND SYMBOLS | |

NOTE: SEE STANDARDS 780001, 781001, AND 780001-D4 FOR DETAILS NOT SHOWN.

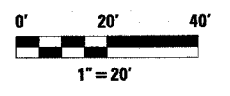

REVISIONS	
NAME	DATE

ILLINOIS DEPARTMENT OF TRANSPORTATION

PAVEMENT MARKING PLANS

SCALE: VERT. _____
 HORIZ. _____
 DATE _____

DRAWN BY _____
 CHECKED BY _____