

STATE OF ILLINOIS
DEPARTMENT OF TRANSPORTATION

ROUTE NO.	SECTION	COUNTY	TOTAL SHEETS	SHEET NO.	SHEET NO. 2
F.A.P. 669	IIBR-1	TAZEWELL	442	271	32 SHEETS
FED. ROAD DIST. NO. 7	ILLINOIS	FED. AID PROJECT-			

Contract #88804

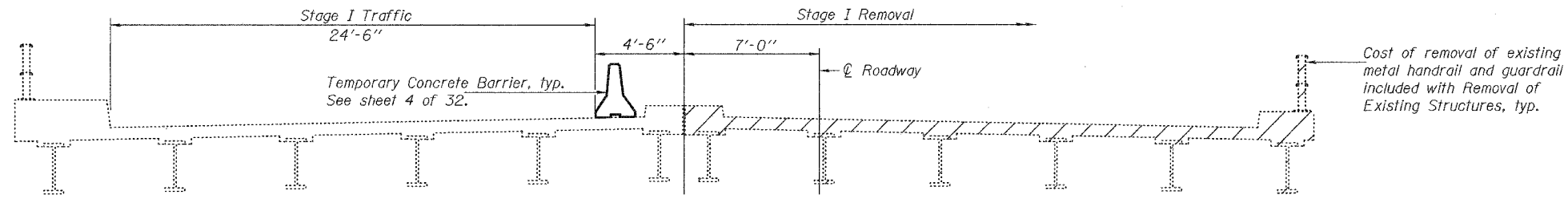

STAGE I REMOVAL
(Looking South)

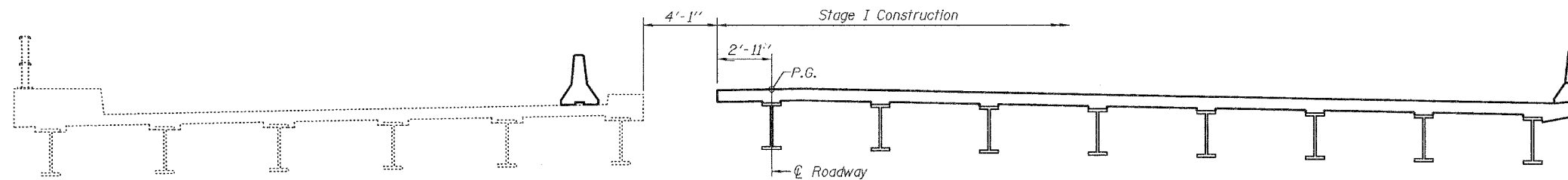

STAGE I CONSTRUCTION
(Looking South)

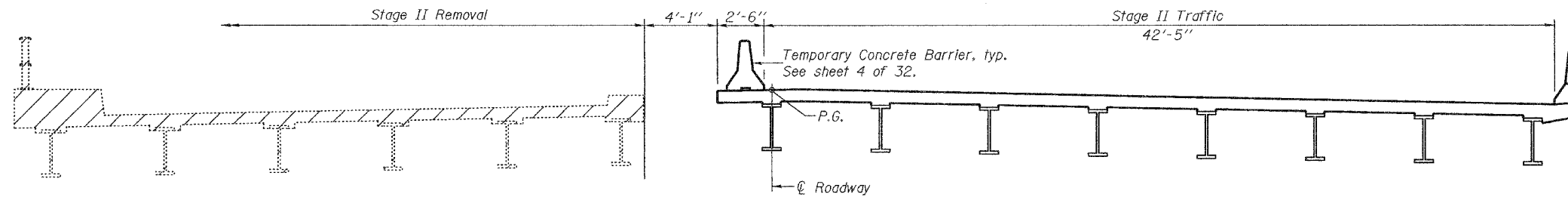

STAGE II REMOVAL
(Looking South)

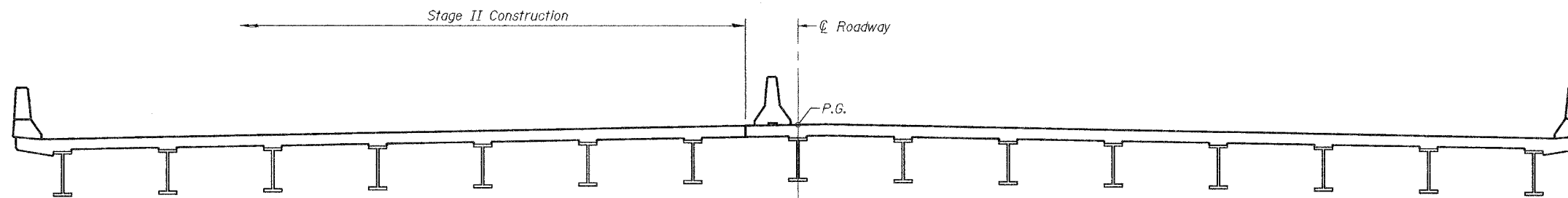

STAGE II CONSTRUCTION
(Looking South)

DESIGNED	T.L.K.
CHECKED	A.M.J.
DRAWN	BECKY M. LEACH
CHECKED	A.M.J. & P.E.C.

May 18, 2006

EXAMINED *Thomas J. Domagalak*
ENGINEER OF BRIDGE DESIGN

PASSED *Ralph E. Anderson*
ENGINEER OF BRIDGES AND STRUCTURES

Notes:
Hatched area indicates Removal of Existing Structures.
For quantity of Temporary Concrete Barrier, see roadway plans.

STAGE CONSTRUCTION DETAILS
F.A.P. ROUTE 669 - SECTION IIBR-1
TAZEWELL COUNTY
STATION 301+87.90
STRUCTURE NO. 090-0172