

F.A.P. RTE.	SECTION	COUNTY	TOTAL SHEETS	SHEET NO.
669	11W-3,RS-8,*	TAZEWELL	442	342
STA. 257+00.00		TO STA. 258+38.44		
FED. ROAD DIST. NO.		ILLINOIS FED. AID PROJECT		

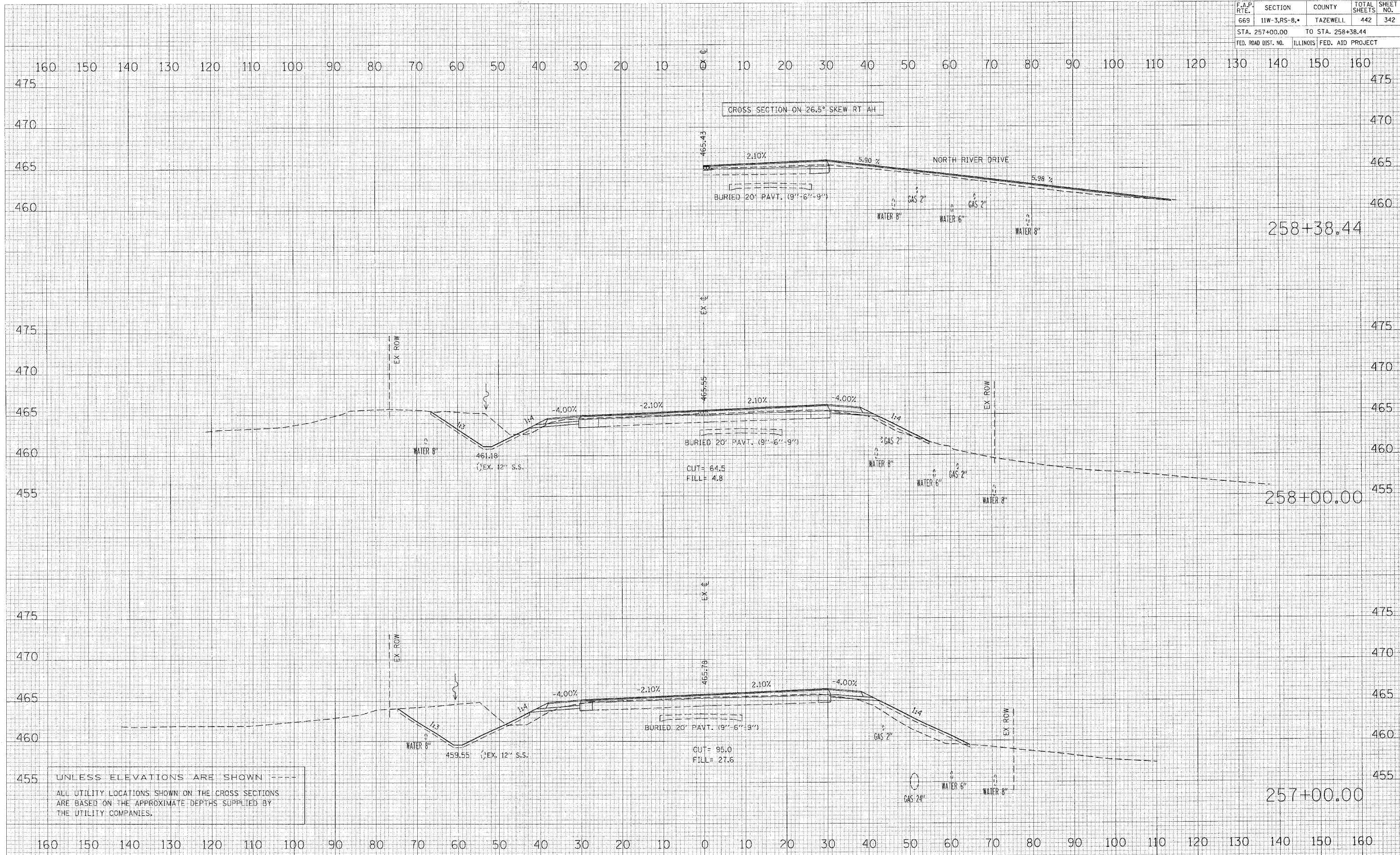

258+38.44

258+00.00

257+00.00

CROSS SECTION ON 26.5° SKEW RT. AH

NORTH RIVER DRIVE

BURIED 20' PAVT. (9'-6"-9'-9")

BURIED 20' PAVT. (9'-6"-9'-9")

BURIED 20' PAVT. (9'-6"-9'-9")

CUT = 64.5
FILL = 4.8

CUT = 95.0
FILL = 27.6

461.18
EX. 12" S.S.

459.55
EX. 12" S.S.

UNLESS ELEVATIONS ARE SHOWN ---
ALL UTILITY LOCATIONS SHOWN ON THE CROSS SECTIONS
ARE BASED ON THE APPROXIMATE DEPTHS SUPPLIED BY
THE UTILITY COMPANIES.

DATE	
BY	
ORIGINAL SURVEY	
SUBMITTED	
PLOTTED	
TEMPLATE	
AREAS	
CHECKED	
NO.	

DATE	
BY	
ORIGINAL SURVEY	
SUBMITTED	
PLOTTED	
TEMPLATE	
AREAS	
CHECKED	
NO.	

PLOT DATE = 4/19/2006
FILE NAME = c:\p\p\j\o\j\11\mainline\phase.11\mainline\plot\mainline.dwg
PLOT SCALE = 1/8" = 1'-0"
USER NAME = shoupan