

F.A.P. RTE.	SECTION	COUNTY	TOTAL SHEETS	SHEET NO.
669	11W-3,RS-8,*	TAZEWELL	442	430
STA. 10+40.00		TO STA. 10+60.00		
FED. ROAD DIST. NO.	ILLINOIS	FED. AID PROJECT		
		• 11BR-1, 11BR-2		

160 150 140 130 120 110 100 90 80 70 60 50 40 30 20 10 0 10 20 30 40 50 60 70 80 90 100 110 120 130 140 150 160

DATE	BY
DATE	BY
DATE	BY

DATE	BY
DATE	BY
DATE	BY

PLOT DATE = 4/18/2008
 FILE NAME = c:\p\projects\2008\phase 11\workspace\11.dwg
 USER NAME =

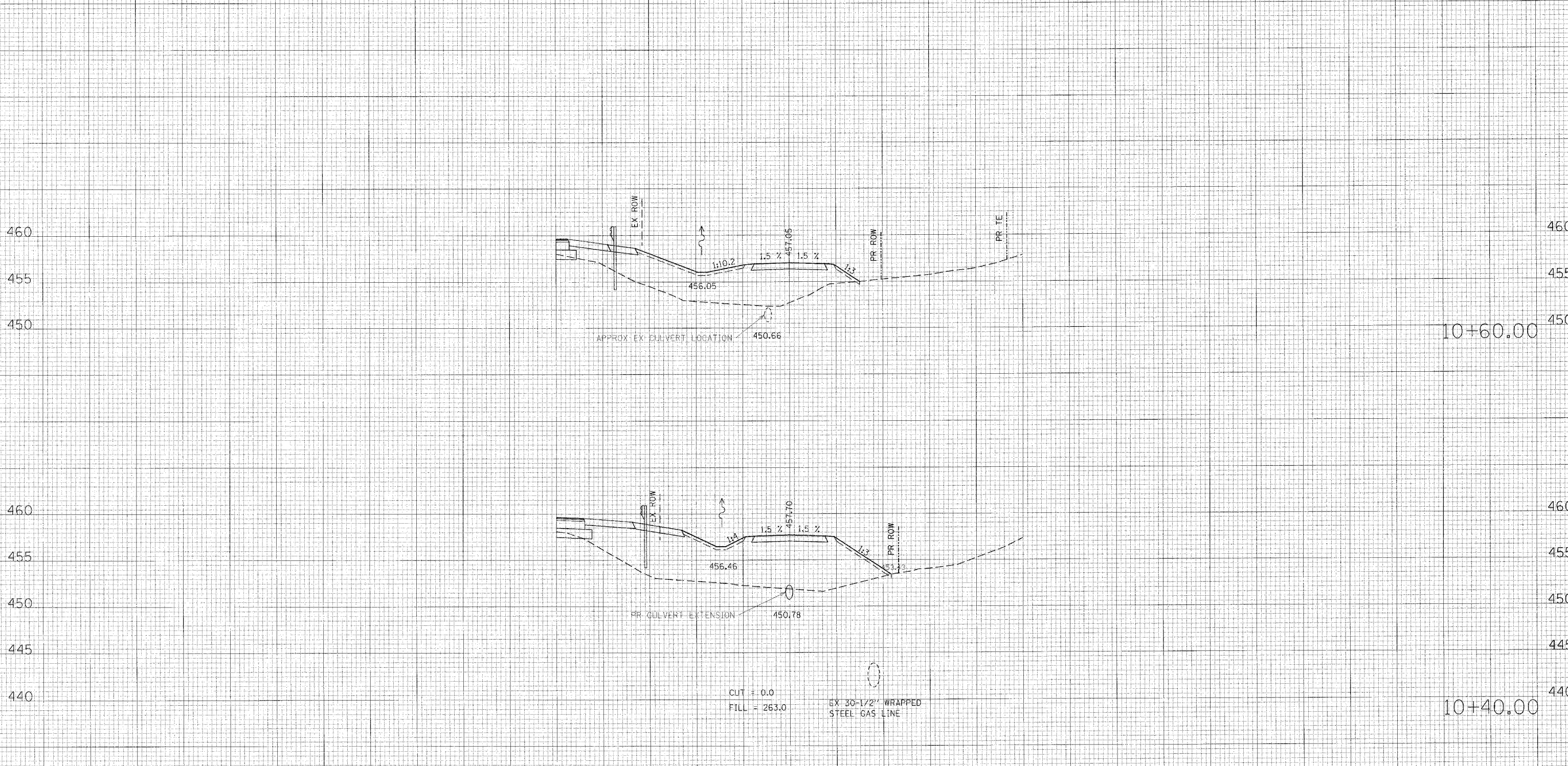

CUT = 0.0
 FILL = 263.0
 EX 30-1/2" WRAPPED STEEL GAS LINE

UNLESS ELEVATIONS ARE SHOWN ----
 ALL UTILITY LOCATIONS SHOWN ON THE CROSS SECTIONS
 ARE BASED ON THE APPROXIMATE DEPTHS SUPPLIED BY
 THE UTILITY COMPANIES.

160 150 140 130 120 110 100 90 80 70 60 50 40 30 20 10 0 10 20 30 40 50 60 70 80 90 100 110 120 130 140 150 160