

LOGAN TOWNSHIP T8N R6E 4PM

EXISTING STRUCTURE NO.072-3056
47'-3 5/8" 1-SPAN STEEL I-BEAM BRIDGE
25 FT. WIDE WITH CONCRETE DECK
TO BE REMOVED. (SEE SPECIAL PROVISIONS)

ROUTE NO.	SECTION	COUNTY	TOTAL SHEETS	SHEET NO.
1381	89-00005-00-BR	PEORIA	29	4
FED. ROAD DIST. NO.	ILLINOIS PROJECT	BR-S-1381 (105)	CONTRACT: 89066	

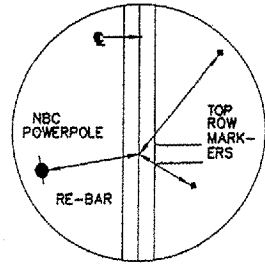

PC STA. 229+12.39

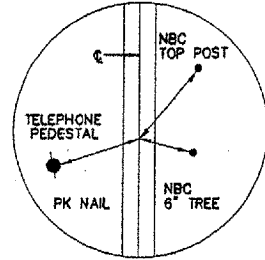

PT STA. 215+23.41

SECTION BEGINS
STATION 217+66.07

SECTION ENDS
STATION 223+36.11

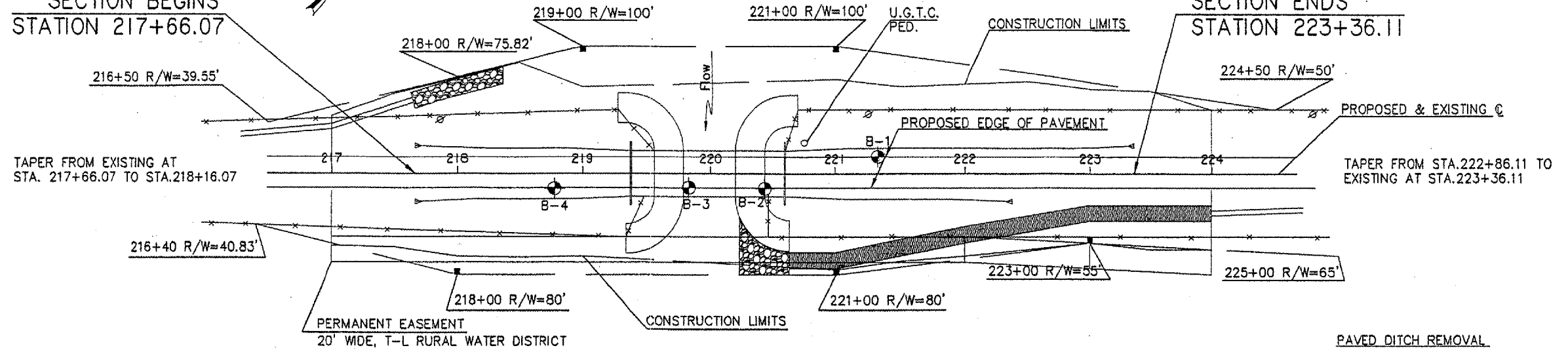

BARBED WIRE FENCE REMOVAL
STA. 216+50 TO STA. 224+50 LT.
735 FT.
STA. 216+40 TO STA. 225+00 RT.
810 FT.

WOVEN WIRE FENCE, 4'
STA. 216+50 TO STA. 224+50 LT.
820 FT.
STA. 216+40 TO STA. 225+00 RT.
868 FT.

FABRIC FORMED CONCRETE REVETMENT MAT DITCH
STA. 220+64 TO STA. 224+00 RT. - 484.6 SQ.YD.

PROPOSED STRUCTURE
STA. 219+33.41 TO STA. 220+60.00
126'-7" 3-SPAN P.P.C. DECK BRIDGE
STRUCTURE NO.072-3129

STEEL PLATE BEAM GUARDRAIL, TYPE B
STA. 217+91.07 TO STA. 219+33.41 LT. - 142.3 FT.
STA. 217+91.07 TO STA. 219+33.41 RT. - 142.3 FT.
STA. 220+60.00 TO STA. 223+11.11 LT. - 251.1 FT.
STA. 220+60.00 TO STA. 222+12.50 RT. - 152.5 FT.
TAPER GUARDRAIL AT EACH BRIDGE CORNER
TO EDGE OF SHOULDER 50 FEET FROM BRIDGE

PAVED DITCH REMOVAL
STA. 221+92 TO STA. 224+00 RT. - 210 FT.

TRAFFIC BARRIER TERM. TY.1 SPECIAL (TANGENT)
STA. 217+66.07 TO STA. 217+91.07 LT. - 1 EACH
STA. 217+66.07 TO STA. 217+91.07 RT. - 1 EACH
STA. 223+11.11 TO STA. 223+36.11 LT. - 1 EACH
STA. 222+12.50 TO STA. 222+37.50 RT. - 1 EACH

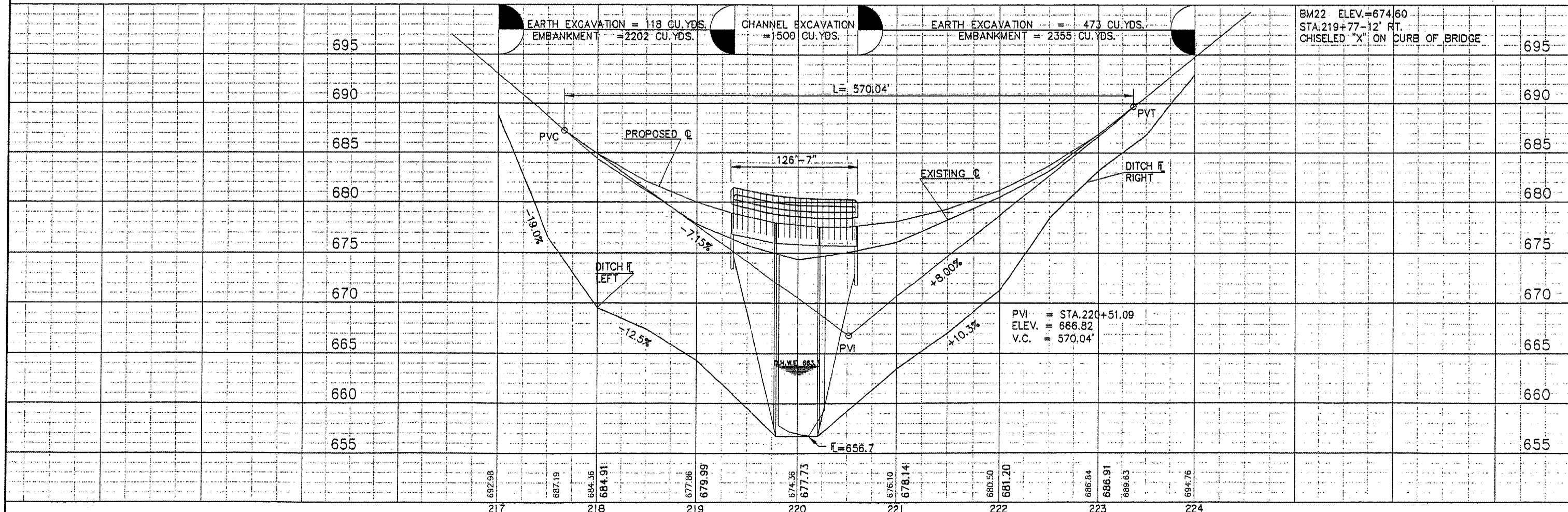

filename 'PLANPRO'