

C:\2006\2006_04\25-06013A_Canton Ave. St. & 11th Ave. (Phase I) Pref. Eng. Sec. 04-00093-01-RS (Construction Plans) 13-Ash St. - Erosion Control.dwg

F.A.U. RTE.	SECTION	COUNTY	TOTAL SHEETS	SHEET NO.
-	04-00093-00-RS	FULTON	11	11
* FAU 6883 & 6904			CONTRACT NO. 89379	

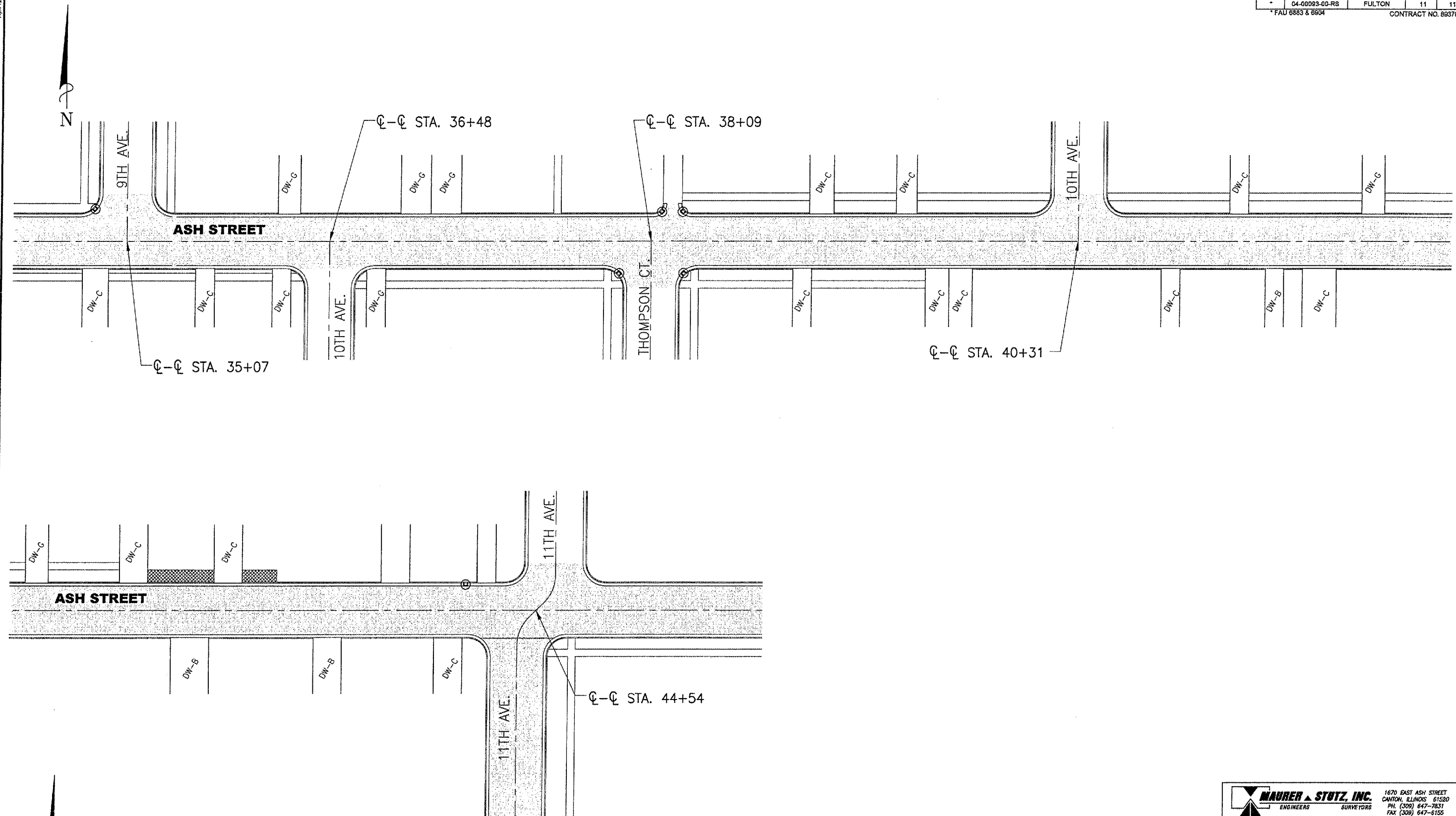

LEGEND

⊙ INLET REQUIRING APPLICATION OF STANDARD #280001-02

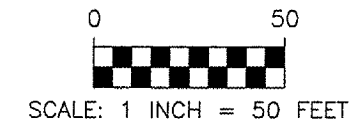

MAURER & STUTZ, INC. ENGINEERS SURVEYORS		1670 EAST ASH STREET CANTON, ILLINOIS 61520 PH. (309) 647-7831 FAX (309) 647-6155
ASH STREET EROSION CONTROL 9TH AVE. TO 11TH AVE.		
FOR: CITY OF CANTON, ILLINOIS		
REVISIONS DESIGNED CHECKED DRAWN CHECKED	DATE <i>04/14/06</i> -- -- JAM GBM	PROJECT NO. 234-06013A DRAWING NO. 1 SHEET 2 OF 2
FIELD BK.		