

April 12, 2006
 01241-2006 Job: 02402013A, Canton Ash St. & 11th Ave. (Phase 1) Plan, Eng. Sec. 04-00093-00-RS (Construction Plans) - Cover Sheet (Day)

F.A.U. RTE.	SECTION	COUNTY	TOTAL SHEETS	SHEET NO.
* 04-00093-00-RS		FULTON	11	1
* FAU 6883 & 6904				

**STATE OF ILLINOIS
 DEPARTMENT OF TRANSPORTATION
 DIVISION OF HIGHWAYS**

**PROPOSED
 HIGHWAY PLANS**

**PROPOSED LOCAL AGENCY IMPROVEMENTS
 CITY OF CANTON, ILLINOIS**

**ASH STREET FAU ROUTE 6883
 11TH AVENUE FAU ROUTE 6904
 SECTION 04-00093-00-RS
 PROJECT M-5007(019)**

INDEX OF SHEETS

- 1 TITLE SHEET AND INDEX OF SHEETS
- 2 TYPICAL SECTIONS (ASH STREET)
- 3 TYPICAL SECTIONS (11TH AVENUE) & DETAILS
- 4 SUMMARY OF QUANTITIES
- 5 TABULATIONS
- 6 ASH STREET - REMOVAL/REPLACEMENT (5TH AVE. TO 9TH AVE.)
- 7 ASH STREET - REMOVAL/REPLACEMENT (9TH AVE. TO 11TH AVE.)
- 8 ASH STREET - STRIPING (5TH AVE. TO 15TH AVE.)
- 9 11TH AVENUE - STRIPING (CHESTNUT ST. TO ASH ST.)
- 10 ASH STREET - EROSION CONTROL (5TH AVE. TO 9TH AVE.)
- 11 ASH STREET - EROSION CONTROL (9TH AVE. TO 11TH AVE.)

LIST OF STANDARDS

TRAFFIC CONTROL STANDARDS

STANDARD #	DESCRIPTION
280001-02	TEMPORARY EROSION CONTROL SYSTEMS
424001-04	CURB RAMPS FOR SIDEWALKS
606001-02	CONCRETE CURB TYPE B AND COMBINATION CONCRETE CURB AND GUTTER
701301-02	TRAFFIC CONTROL AND PROTECTION, STANDARD 701301
701311-02	TRAFFIC CONTROL AND PROTECTION, STANDARD 701311
701501-03	TRAFFIC CONTROL AND PROTECTION, STANDARD 701501
701801-03	TRAFFIC CONTROL AND PROTECTION, STANDARD 701801
702001-06	TRAFFIC CONTROL DEVICES
780001-01	TYPICAL PAVEMENT MARKINGS

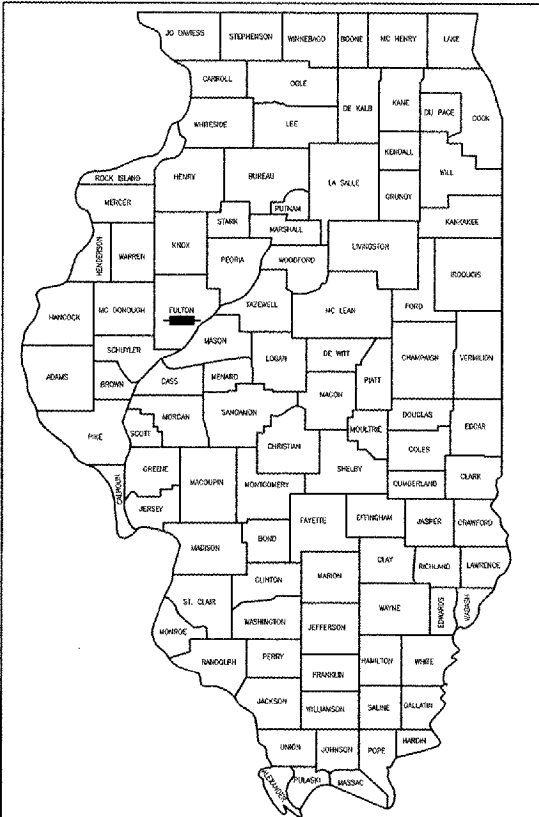

LOCATION OF SECTION INDICATED THUS: -

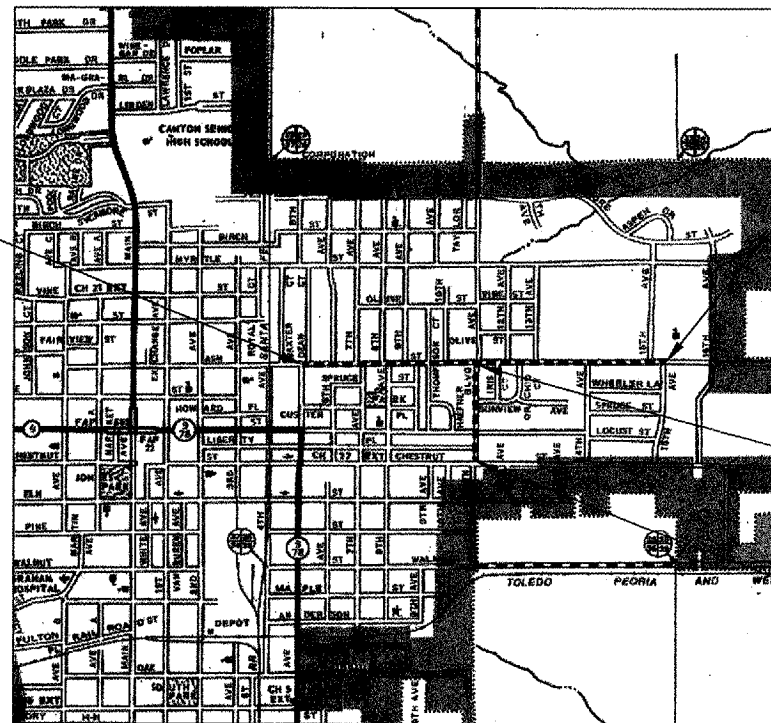

SECTION 04-00093-00-RS
 BEGINS STA. 21+76 (ASH STREET)

SECTION 04-00093-00-RS
 ENDS STA. 68+72 (ASH STREET)

SECTION 04-00093-00-RS
 ENDS STA. 12+82 (11TH AVENUE)

SECTION 04-00093-00-RS
 BEGINS STA. 0+00 (11TH AVENUE)

R4E
LOCATION MAP
 NOT TO SCALE

TOTAL LENGTH OF PROJECT AND IMPROVEMENTS: 5978 LIN. FT. = 1.132 MILES

HIGHWAY CLASS URBAN COLLECTOR
 DESIGN SPEED 30 MPH
 POLICY 3R GUIDELINES

JOB NO. C-94-095-05
 CATALOG NO. 033087-00

**STATE OF ILLINOIS
 DEPARTMENT OF TRANSPORTATION
 DIVISION OF HIGHWAYS**

APPROVED *[Signature]* 4-17-06
 MAYOR OF THE CITY OF CANTON, ILLINOIS

PASSED *[Signature]* 4-17-06
 DISTRICT FOUR ENGINEER OR LOCAL ROADS & STREETS

Releasing For Bid Based on Limited Review *[Signature]* 4-17-06
 DEPUTY DIRECTOR, DIVISION OF HIGHWAYS, REGION THREE ENGINEER



04/14/2006
 KEITH J. PLAVEC, P.E. IL REG. NO. 062-055403
 EXP. DATE: 11/30/2007

QC/QA BITUMINOUS

**J.U.L.I.E.
 JOINT UTILITY LOCATION INFORMATION FOR EXCAVATION
 1-800-892-0123**

CONTRACT NO. 89379

PLANS PREPARED BY:



7615 NORTH HARKER DRIVE PEORIA, ILLINOIS 61615 PH: (309) 683-7915 FAX: (309) 683-7916
 1670 EAST ASH STREET CANTON, ILLINOIS 61820 PH: (309) 647-7831 FAX: (309) 647-8155

April 12, 2006
C:\234\0205\06013A\Canton Ash St. & 11th Ave. (Phase II) Plan, Eng. Sta. 06-00000-01-RS\Construction Plans\3-Typical Sections-11b.dwg

F.A.U. RTE.	SECTION	COUNTY	TOTAL SHEETS	SHEET NO.
04-00093-00-RS		FULTON	11	3
* FAU 6883 & 6904			CONTRACT NO. 89379	

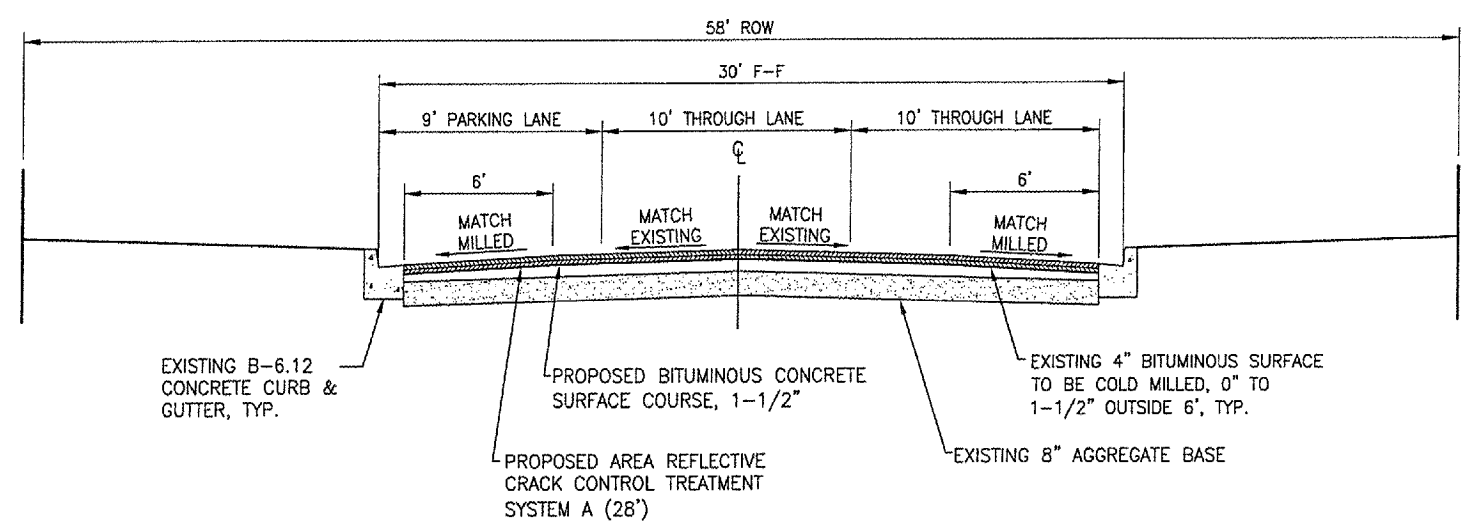

TYPICAL SECTION NO. 1
11TH AVENUE
STA. 0+00 TO STA. 12+82

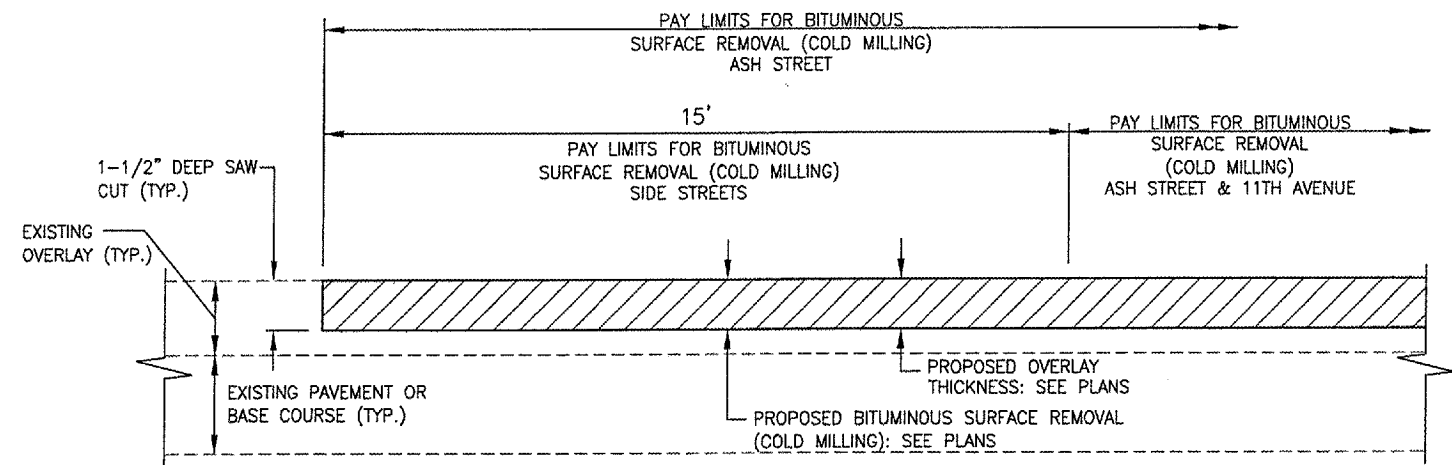

BUTT JOINT DETAIL ON MAINLINE ASH STREET AT WEST END OF PROJECT AND AT ALL SIDE STREETS

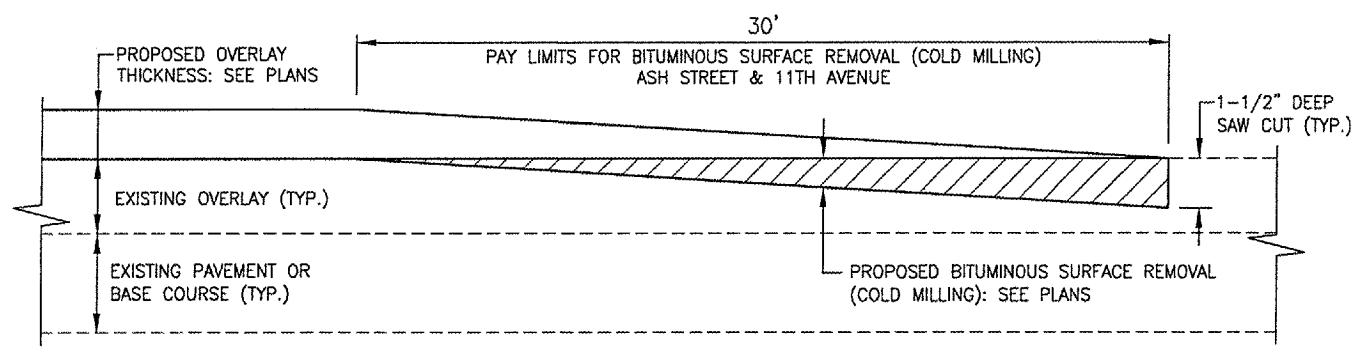

BUTT JOINT DETAIL ON MAINLINE ASH STREET AT EAST END OF PROJECT AND 11TH AVENUE AT SOUTH END OF PROJECT

- GENERAL NOTES:**
1. THE WORK SHALL BE DONE IN ACCORDANCE WITH ARTICLE 406.18 AND THE SPECIAL PROVISION FOR BITUMINOUS SURFACE REMOVAL (COLD MILLING).
 2. THE SAW CUT JOINTS SHALL BE PRIMED JUST PRIOR TO THE PLACING OF BITUMINOUS MATERIALS. THE WORK WILL BE IN ACCORDANCE WITH THE APPLICABLE PORTIONS OF ARTICLE 406.06.

		1670 EAST ASH STREET CANTON, ILLINOIS 61520 PH. (309) 647-7831 FAX (309) 647-6155	
		TYPICAL SECTIONS & DETAILS	
FOR: CITY OF CANTON, ILLINOIS			
REVISIONS	DATE	PROJECT NO.	
	04/14/06	234-06013A	
	DESIGNED CJE	DRAWING NO.	
	CHECKED GBM	1	
	DRAWN JAM	SHEET 2 OF 2	
FIELD BK.	CHECKED GBM		

F.A.U. RTE.	SECTION	COUNTY	TOTAL SHEETS	SHEET NO.
*	04-00093-00-RS	FULTON	11	4
* FAU 6883 & 6904			CONTRACT NO. 89378	

SUMMARY OF QUANTITIES					TOTAL QUANTITIES	CONSTRUCTION TYPE CODE
SPECIALTY ITEMS	CODE NO.	ITEM	UNIT	1000		
	28000500	INLET AND PIPE PROTECTION	EACH	16	16	
	40600100	BITUMINOUS MATERIALS (PRIME COAT)	GALLON	613	613	
	40600300	AGGREGATE (PRIME COAT)	TON	21	21	
	40600400	MIXTURE FOR CRACKS, JOINTS, & FLANGEWAYS	TON	13	13	
	40600990	TEMPORARY RAMP	SQ. YD.	405	405	
	40800040	INCIDENTAL BITUMINOUS SURFACING	TON	10	10	
	42400100	PORTLAND CEMENT CONCRETE SIDEWALK 4 INCH	SQ. FT.	1740	1740	
	42400800	DETECTABLE WARNINGS	SQ. FT.	72	72	
	44000075	BITUMINOUS SURFACE REMOVAL (COLD MILLING)	SQ. YD.	13279	13279	
	44000100	PAVEMENT REMOVAL	SQ. YD.	26	26	
	44000500	COMBINATION CURB & GUTTER REMOVAL	FOOT	4229	4229	
	44000600	SIDEWALK REMOVAL	SQ. FT.	1812	1812	
	44300300	AREA REFLECTIVE CRACK CONTROL TREATMENT, SYSTEM A	SQ. YD.	19933	19933	
	60255500	MANHOLES TO BE ADJUSTED	EACH	37	37	
	60260100	INLETS TO BE ADJUSTED	EACH	10	10	
	60266600	VALVE BOXES TO BE ADJUSTED	EACH	9	9	
	60604400	COMBINATION CONCRETE CURB & GUTTER, TYPE B-6.18	FOOT	4229	4229	
	67100100	MOBILIZATION	L SUM	1.0	1.0	
	70102620	TRAFFIC CONTROL & PROTECTION, STANDARD 701501	L SUM	1.0	1.0	
	70102640	TRAFFIC CONTROL & PROTECTION, STANDARD 701801	L SUM	1.0	1.0	
	70300100	SHORT-TERM PAVEMENT MARKING	FOOT	1372	1372	
	70301000	WORK ZONE PAVEMENT MARKING REMOVAL	SQ. FT.	175	175	
*	78000200	THERMOPLASTIC PAVEMENT MARKING - LINE, 4"	FOOT	1440	1440	
*	78000400	THERMOPLASTIC PAVEMENT MARKING - LINE, 6"	FOOT	356	356	
*	78000650	THERMOPLASTIC PAVEMENT MARKING - LINE, 24"	FOOT	133	133	
	X0656100	DRIVEWAY PAVEMENT REMOVAL AND REPLACEMENT	SQ. YD.	198	198	
	X4066424	BITUMINOUS CONCRETE SURFACE COURSE, SUPERPAVE, MIXTURE "D", N50	TON	1698	1698	
	XX003643	BASE REPAIR, SPECIAL	SQ. YD.	194	194	

		1670 EAST ASH STREET CANTON, ILLINOIS 61520 PH. (309) 647-7851 FAX (309) 647-6155
SUMMARY OF QUANTITIES		
FOR: CITY OF CANTON, ILLINOIS		
REVISIONS DESIGNED CHECKED DRAWN CHECKED	DATE 04/14/06 -- -- JAM GEM	PROJECT NO. 234-08013A DRAWING NO. 1 SHEET 1 OF 1

April 12, 2006
 C:\24\2006\240619A\Canton_Ash St. & 11th Ave. (Phase 3) Final Eng. Sacs\040206\01-RES\CONSTRUCTION Plans\11-Tabulations.dwg

STATION TO STATION	SIDEWALK REMOVAL SQ. FT.	PORTLAND CEMENT CONCRETE SIDEWALK 4" SQ. FT.	DETECTABLE WARNINGS SQ. FT.	COMBINATION CURB AND GUTTER REMOVAL FOOT	COMBINATION CONCRETE CURB & GUTTER, TYPE B-6.18 FOOT	DRIVEWAY PAVEMENT REMOVAL & REPLACEMENT			PAVEMENT REMOVAL SQ. YD.	INCIDENTAL BITUMINOUS SURFACING TON	MANHOLES TO BE ADJUSTED EACH	VALVE BOXES TO BE ADJUSTED EACH
						CONCRETE	BITUMINOUS	GRAVEL				
						SQ. YD.	SQ. YD.	SQ. YD.				
ASH STREET - LT 21+76 - 22+57				40	40							
LT 22+57 - 25+80	108	96	12	298	298	15.3						
LT 25+80 - 28+72	117	93	24	285	285	8.4		4.0				
LT 28+72 - 32+04	104	92	12	301	301	8.6	2.7	2.0		1		
LT 32+04 - 35+07	1040	1028	12	248	248	24.6	5.8			1		3
LT 35+07 - 38+09	7	7		268	268			10.4				1
LT 38+09 - 40+31				182	182	5.3						
LT 40+31 - 44+54	203	203		408	408	17.3		5.1				
ASH STREET - RT 21+76 - 29+62	112	112		720	720	18.9	20					
RT 29+62 - 32+95	55	49	6	295	295	4.2			20.2	7		
RT 32+95 - 36+48	66	60	6	353	353	13.8			5.8	3		1
RT 36+48 - 38+09				161	161			3.1				
RT 38+09 - 44+54				600	600	18.5	9.5					
ASH STREET - 44+54 - 68+72				20	20							
11TH AVENUE - 0+00 - 12+82				50	50							
TOTAL	1812	1740	72	4229	4229	134.9	38.0	24.6	26.0	10	2	5

LOCATION	EACH
11TH AVENUE - STA. 0+00 TO STA. 12+82	6
ASH STREET - STA. 21+76 TO STA. 68+72	29
TOTAL	35

LOCATION	EACH
ASH STREET - STA. 21+76 TO STA. 68+72	4
TOTAL	4

LOCATION	EACH
ASH STREET - STA. 21+76 TO STA. 68+72	10
TOTAL	10

LOCATION	SQ. YDS.
11TH AVENUE - VARIOUS LOCATIONS	100
ASH STREET - VARIOUS LOCATIONS	94
TOTAL	194

LOCATION	TON
VARIOUS LOCATIONS	13
TOTAL	13

LOCATION	FOOT
ASH ST. AND 11TH AVE.	1372
TOTAL	1372

LOCATION	SQ. FT.
ASH ST. AND 11TH AVE.	175
TOTAL	175

LOCATION	FOOT
ASH ST. AND 11TH AVE	1440
TOTAL	1440

CROSSWALKS AT:	FEET
ASH STREET - AT 13TH AVE. - 2 @ 36"	76
- WEST SIDE OF 14TH AVE. - 2 @ 34"	68
- WEST SIDE OF 15TH AVE. - 2 @ 36"	76
- NORTH SIDE OF ASH ON 15TH AVE. - 2 @ 34"	68
- AT ORCHID STREET - 2 @ 34"	68
TOTAL	356

LOCATION	APPROX LENGTH (FEET)
11TH AND CHESTNUT - NORTH SIDE	14
11TH AND ASH - NORTH SIDE	14
- SOUTH SIDE	14
- EAST SIDE	17
- WEST SIDE	12
15TH AND ASH - NORTH SIDE	14
- SOUTH SIDE	14
- EAST SIDE	17
- WEST SIDE	17
TOTAL	133

LOCATION	TON
11TH AVENUE - STA. 0+00 TO STA. 12+82	4.5
ASH STREET - STA. 21+76 TO STA. 44+54	6
STA. 44+54 TO STA. 50+38	2
STA. 50+38 TO STA. 68+72	7
SIDE STREETS - VARIOUS LOCATIONS	1.5
TOTAL	21

LOCATION	GALS
11TH AVENUE - STA. 0+00 TO STA. 12+82	134
ASH STREET - STA. 21+76 TO STA. 44+54	175
STA. 44+54 TO STA. 50+38	62
STA. 50+38 TO STA. 68+72	202
SIDE STREETS - VARIOUS LOCATIONS	40
TOTAL	613

LOCATION	SQ. YD.
11TH AVENUE - STA. 0+00 TO STA. 12+82	3989
ASH STREET - STA. 21+76 TO STA. 44+54	5822
STA. 44+54 TO STA. 50+38	2077
STA. 50+38 TO STA. 68+72	6725
SIDE STREETS - VARIOUS LOCATIONS	1320
TOTAL	19933

LOCATION	TON
11TH AVENUE - STA. 0+00 TO STA. 12+82	359
ASH STREET - STA. 21+76 TO STA. 44+54	518
STA. 44+54 TO STA. 50+38	145
STA. 50+38 TO STA. 68+72	565
SIDE STREETS - VARIOUS LOCATIONS	111
TOTAL	1698

LOCATION	SQ. YDS.
11TH AVENUE - STA. 0+00 TO STA. 12+82	2049
ASH STREET - STA. 21+76 TO STA. 44+54	6581
STA. 44+54 TO STA. 50+38	779
STA. 50+38 TO STA. 68+72	2550
SIDE STREETS - VARIOUS LOCATIONS	1320
TOTAL	13279

LOCATION	L. SUM
11TH AVENUE - ASH STREET	
STANDARD 701501	1.0
11TH AVENUE - ASH STREET	
STANDARD 701801	1.0

LOCATION	L. SUM
PROJECT	1.0
TOTAL	1.0

LOCATION	SQ. FT.
11TH AVENUE	
AT CHESTNUT STREET	15.6
VARIOUS SIDE STREETS	62.2
ASH STREET	
AT 5TH AVENUE	12.8
VARIOUS SIDE STREETS	295.6
AT 15TH AVENUE	18.3
TOTAL	404.5

LOCATION	EACH
ASH ST. - STA. 21+76 - STA. 44+54	16
TOTAL	16

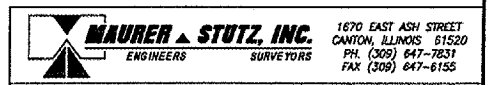

FOR: CITY OF CANTON, ILLINOIS			
REVISIONS	DATE	PROJECT NO.	234-06013A
DESIGNED	04/14/06	DRAWING NO.	1
CHECKED		FIELD BK.	
DRAWN	JAM	CHECKED	GBM
			SHEET 1 OF 1

April 12, 2006
C:\2342025\Jed\2342025A\Canton A01 St. & 11th Ave. (Phase II) Plan, Eng. Sec 04-00093-00-RS\Construction Plans\4-14-06 St. Demo.dwg

F.A.I. RTE.	SECTION	COUNTY	TOTAL SHEETS	SHEET NO.
*	04-00093-00-RS	FULTON	11	6
* FAU 6893 & 6904			CONTRACT NO. 89376	

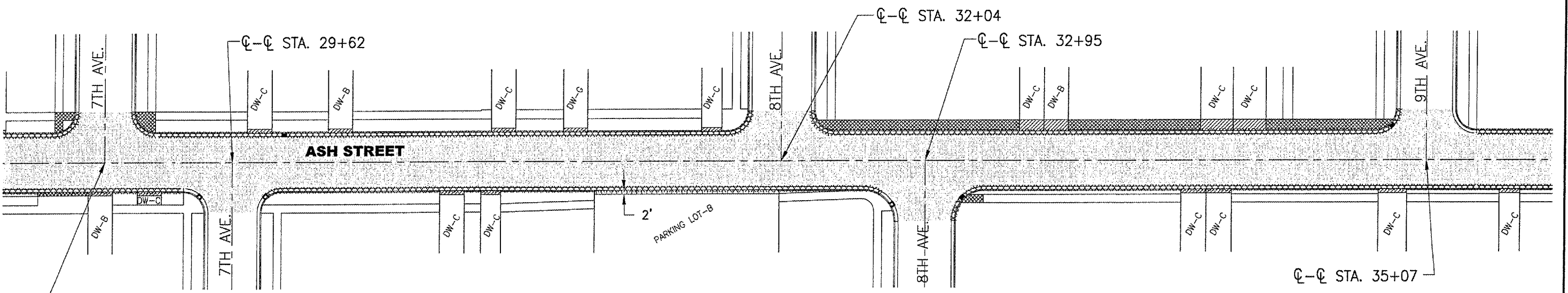
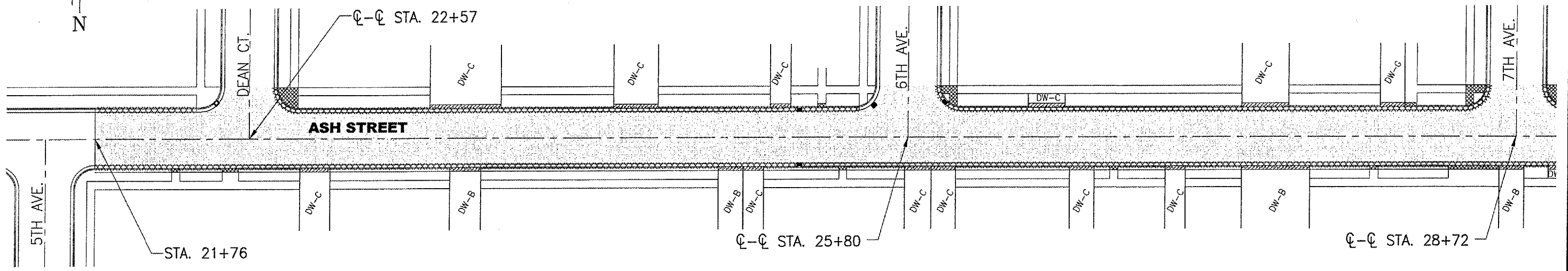

LEGEND

- ▣ EXISTING INLET
- ▣ EXISTING INLET TO BE ADJUSTED
- ▨ SIDEWALK REMOVAL AND REPLACEMENT
- ▨ DRIVEWAY REMOVAL AND REPLACEMENT
- ▨ PAVEMENT REMOVAL AND REPLACEMENT
- xxxxxxx COMBINATION CURB AND GUTTER REMOVAL AND REPLACEMENT
- ▨ APPROXIMATE LIMITS OF STREET IMPROVEMENT
- DW-C EXISTING CONCRETE DRIVEWAY
- DW-B EXISTING BITUMINOUS DRIVEWAY
- DW-G EXISTING GRAVEL DRIVEWAY



		<small>1670 EAST ASH STREET CANTON, ILLINOIS 61520 PH (309) 647-7831 FAX (309) 647-6155</small>	
		ASH STREET REMOVAL/REPLACEMENT 5TH AVE. TO 9TH AVE.	
FOR: CITY OF CANTON, ILLINOIS			
REVISIONS	DATE	PROJECT NO.	
	04/14/06	234-06013A	
	DESIGNED		DRAWING NO.
	CHECKED		1
	DRAWN	JAM	SHEET 1 OF 2
FIELD BK.	CHECKED	GBM	

April 12, 2009
 C:\2342009 Jobs\23420013A_Canton_Ash St. & 11th Ave. (Phase I) Proj. Eng. Sec 08 00093-01 HSI\Construction Plans\15 Ash St - Demo.dwg

F.A.U. RTE.	SECTION	COUNTY	TOTAL SHEETS	SHEET NO.
04-00093-00-RS		FULTON	11	7
* FAU 6883 & 6804			CONTRACT NO. 89379	

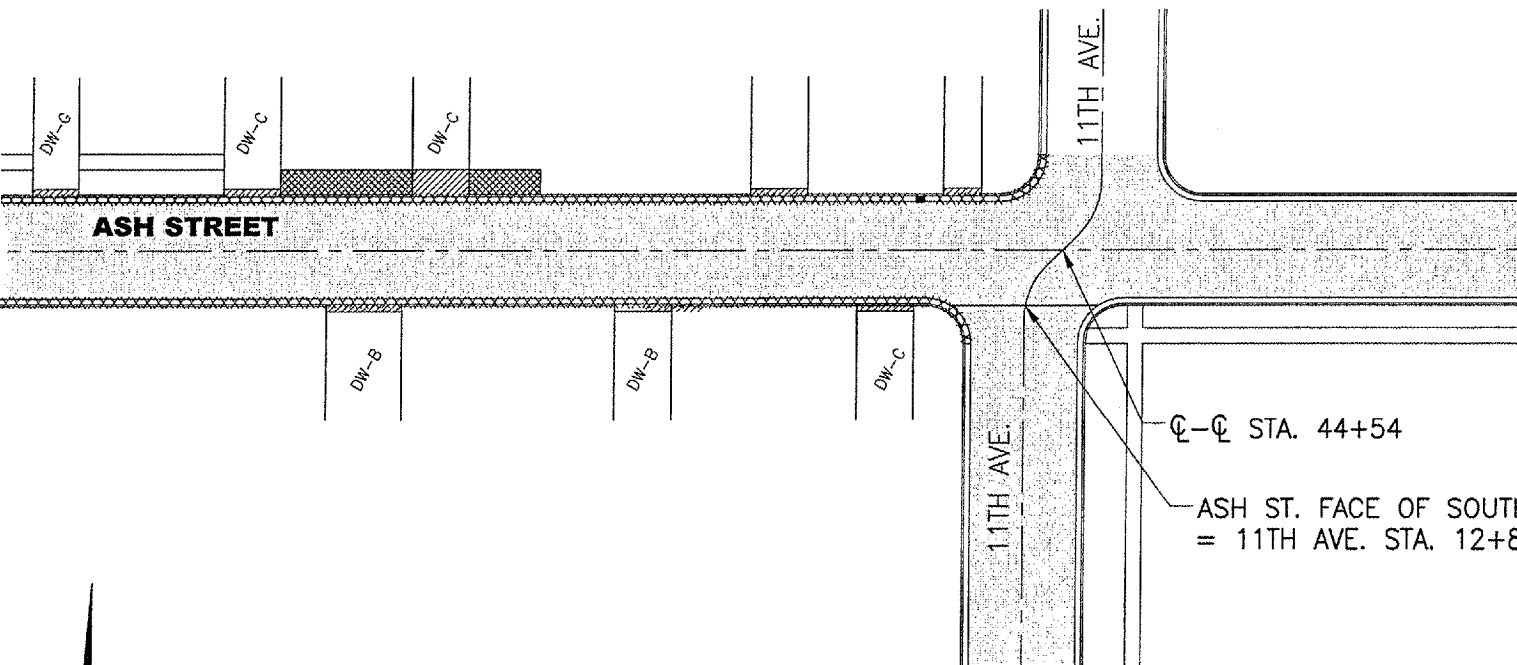
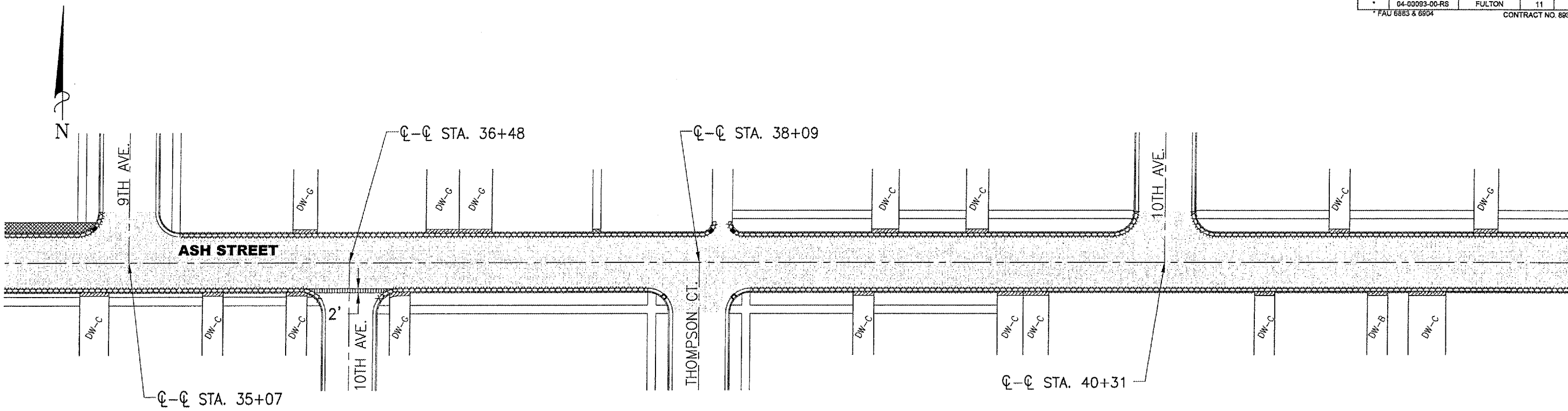

11TH AVENUE (STA. 0+00 TO STA. 12+82) -
 VARIOUS COMBINATION CURB AND GUTTER
 REMOVAL AND REPLACEMENT (OWNER/ENGINEER
 WILL FIELD LOCATE PRIOR TO CONSTRUCTION)

ASH STREET (STA. 44+54 TO STA.
 68+72) - VARIOUS COMBINATION
 CURB AND GUTTER REMOVAL AND
 REPLACEMENT (OWNER/ENGINEER
 WILL FIELD LOCATE PRIOR TO
 CONSTRUCTION)

LEGEND

- ▣ EXISTING INLET
- EXISTING INLET TO BE ADJUSTED
- SIDEWALK REMOVAL AND REPLACEMENT
- DRIVEWAY REMOVAL AND REPLACEMENT
- PAVEMENT REMOVAL AND REPLACEMENT
- xxxxxxx COMBINATION CURB AND GUTTER REMOVAL AND REPLACEMENT
- APPROXIMATE LIMITS OF STREET IMPROVEMENT
- DW-C EXISTING CONCRETE DRIVEWAY
- DW-B EXISTING BITUMINOUS DRIVEWAY
- DW-G EXISTING GRAVEL DRIVEWAY



SCALE: 1 INCH = 50 FEET

		1670 EAST ASH STREET CANTON, ILLINOIS 61520 Ph: (309) 647-7831 Fax: (309) 647-8155
ASH STREET REMOVAL/REPLACEMENT 9TH AVE. TO 11TH AVE.		
FOR: CITY OF CANTON, ILLINOIS		
REVISIONS DESIGNED CHECKED DRAWN CHECKED	DATE 04/14/08 - - JAM GBM	PROJECT NO. 234-06013A DRAWING NO. 1 SHEET 2 OF 2

April 12, 2006
 012410001 Job: 234-06013A, Canton Ash St. & 11th Ave. (Phase 1) Prel. Eng. See 04-00093-01-RS (Construction Plans) Ash St. - Striping.dwg

F.A.U. RTE.	SECTION	COUNTY	TOTAL SHEETS	SHEET NO.
-	04-00093-00-RS	FULTON	11	8
* FAU 6883 & 6904			CONTRACT NO. 89379	

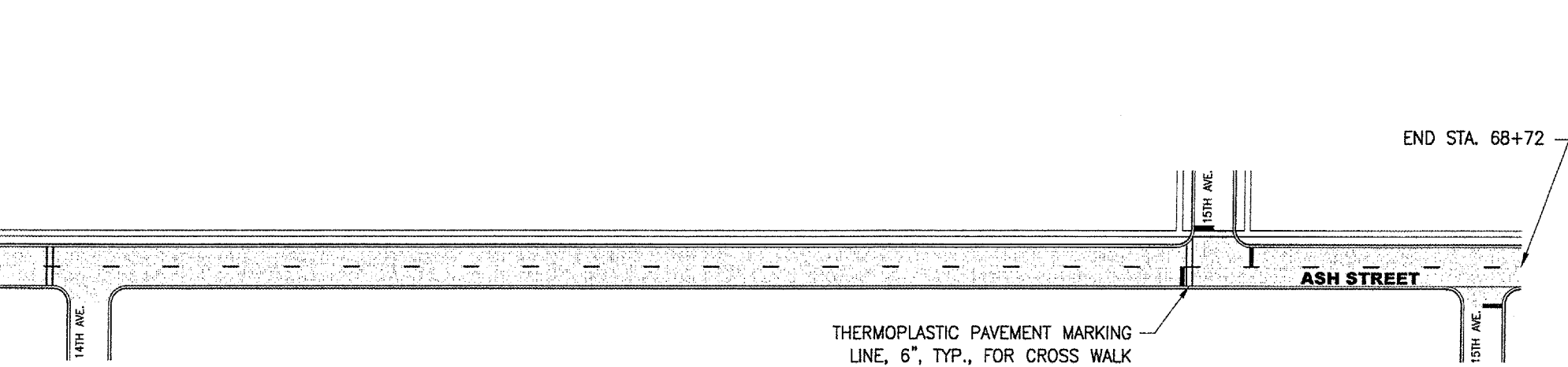
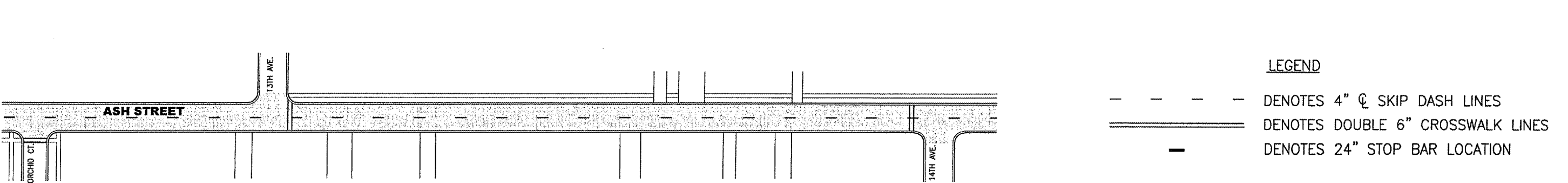
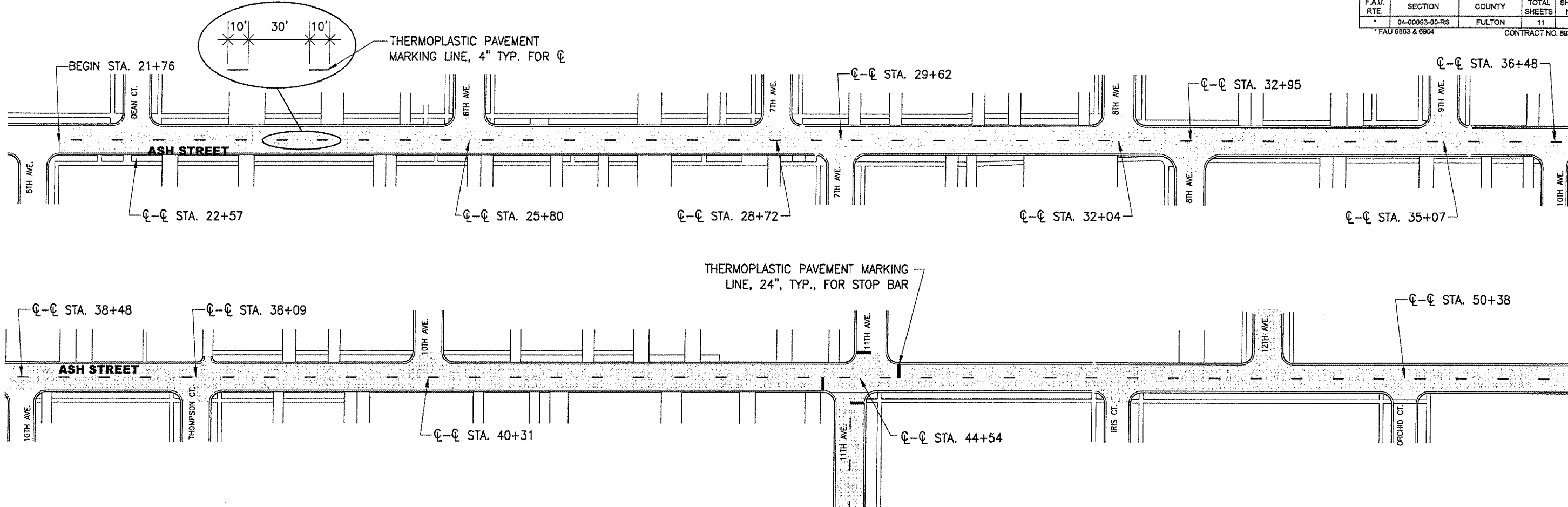

LEGEND

- DENOTES 4" ϕ SKIP DASH LINES
- DENOTES DOUBLE 6" CROSSWALK LINES
- DENOTES 24" STOP BAR LOCATION

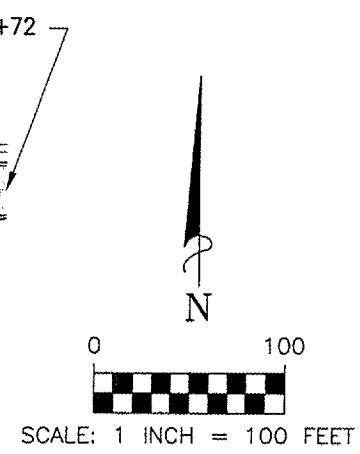

		1670 EAST ASH STREET CANTON, ILLINOIS 61520 PH. (309) 647-7831 FAX (309) 647-6155	
		ASH STREET STRIPING 5TH AVE. TO 15TH AVE.	
FOR: CITY OF CANTON, ILLINOIS			
REVISIONS	DATE	PROJECT NO.	
	04/14/06	234-06013A	
		DRAWING NO.	
		1	
FIELD BK.	CHECKED	GBM	SHEET 1 OF 2

April 12, 2008

F.A.U. RTE.	SECTION	COUNTY	TOTAL SHEETS	SHEET NO.
*	04-00093-00-RS	FULTON	11	9
* FAU 6883 & 6904			CONTRACT NO. 68379	

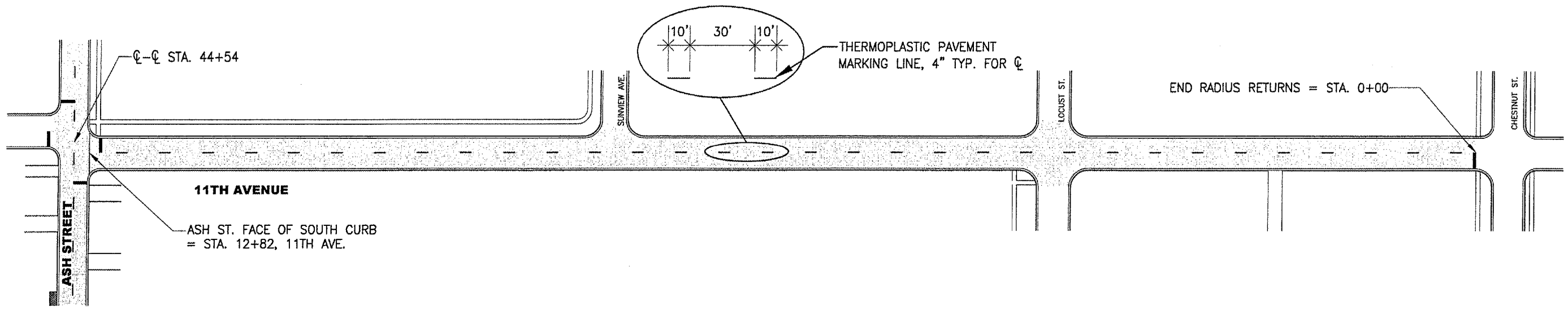

LEGEND

- - - - DENOTES 4" CL SKIP DASH LINES
- ==== DENOTES DOUBLE 6" CROSSWALK LINES
- DENOTES 24" STOP BAR LOCATION



SCALE: 1 INCH = 100 FEET

MAURER & STUTZ, INC.
ENGINEERS SURVEYORS
1670 EAST ASH STREET
CANTON, ILLINOIS 61520
PH. (309) 647-7831
FAX (309) 647-5155

**11TH AVENUE STRIPING
ASH ST. TO CHESTNUT ST.**

FOR: CITY OF CANTON, ILLINOIS		
REVISIONS	DATE	PROJECT NO.
DESIGNED	04/14/06	234-06013A
CHECKED	-	DRAWING NO.
DRAWN	JAM	1
FIELD BK.	CHECKED GBM	SHEET 2 OF 2

C:\234\234010\1013A\Canton Ash St. & 11th Ave. (Please!) Pref. Eng. Set 06-00093-01-RS\Construction Plans\09-11th Ave - Striping.dwg

April 12, 2006
 0123452006 50x32 400 134 Canton Ash St. & 11th Ave. (Phase 1) Proj. Eng. Eric 04-00093-01-RS/Construction Plans/12-Ash St. - Erosion Control.dwg

F.A.U. RTE.	SECTION	COUNTY	TOTAL SHEETS	SHEET NO.
04-00093-00-RS		FULTON	11	10
* FAU 6883 & 6904			CONTRACT NO. 88378	

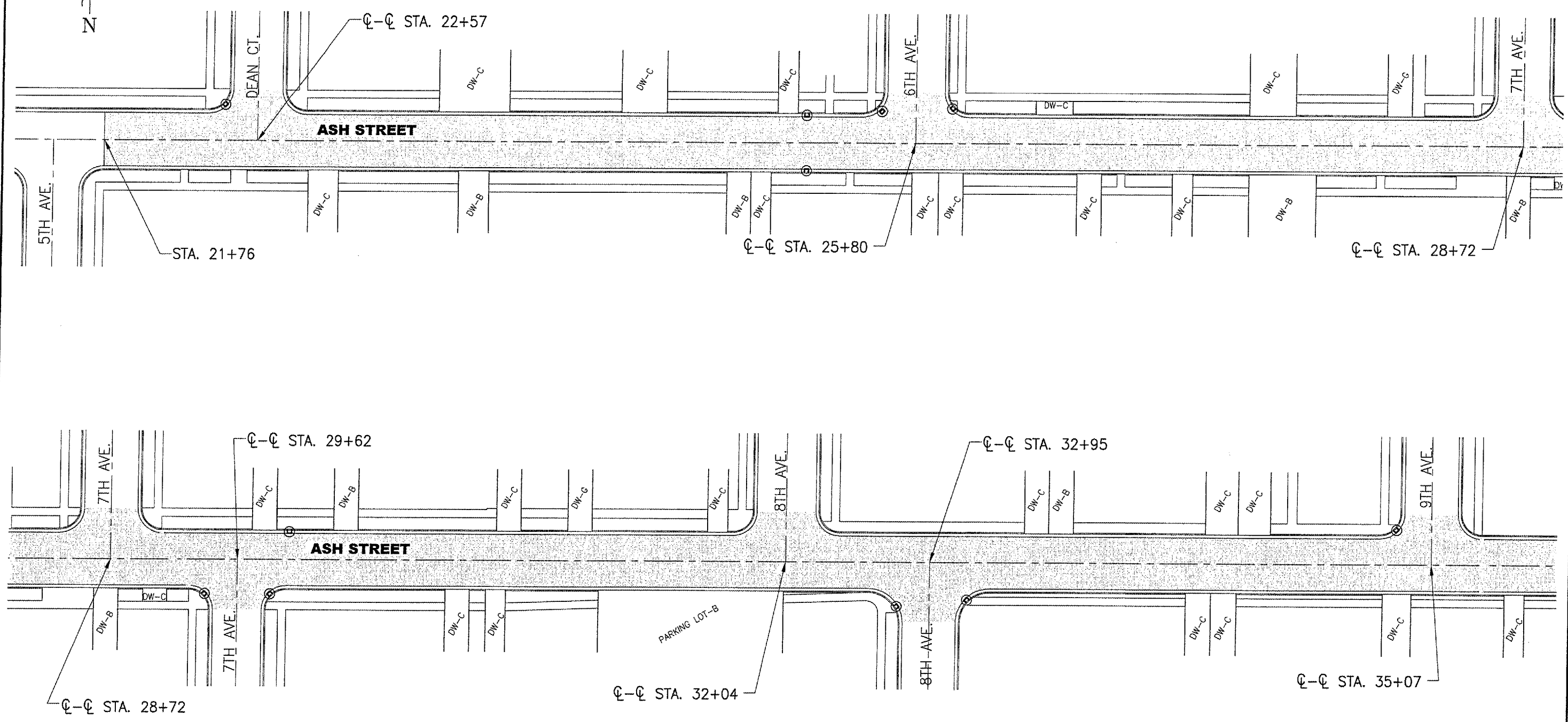

LEGEND

⊙ INLET REQUIRING APPLICATION OF STANDARD #280001-02

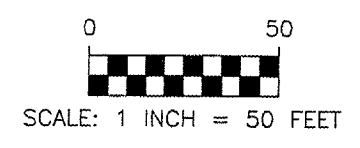

		1670 EAST ASH STREET CANTON, ILLINOIS 61520 PH. (309) 647-7831 FAX (309) 647-6155
ASH STREET EROSION CONTROL 5TH AVE. TO 9TH AVE.		
FOR: CITY OF CANTON, ILLINOIS		
REVISIONS	DATE	PROJECT NO.
DESIGNED	04/14/06	234-06013A
CHECKED		DRAWING NO.
DRAWN	JAM	1
FIELD BK.	CHECKED GEM	SHEET 1 OF 2

C:\2006\2006_04\25-06013A_Canton Ave. St. & 11th Ave. (Phase I) Pref. Eng. Sec. 04-00093-01-RS (Construction Plans) 13-Ash St. - Erosion Ctrl.dwg April 12, 2006

F.A.U. RTE.	SECTION	COUNTY	TOTAL SHEETS	SHEET NO.
-	04-00093-00-RS	FULTON	11	11
* FAU 6883 & 6904			CONTRACT NO. 89379	

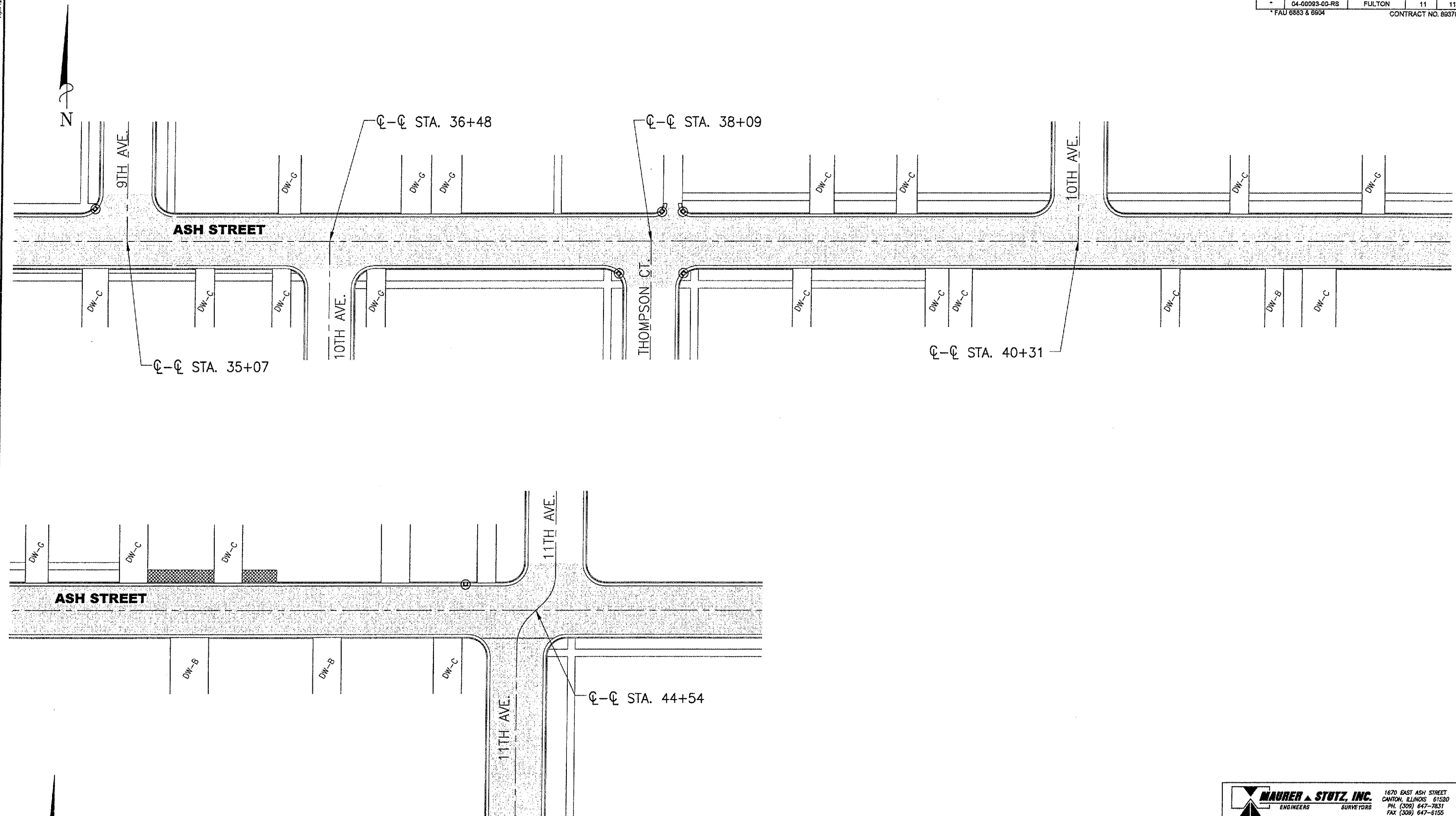

LEGEND

Ⓜ INLET REQUIRING APPLICATION OF STANDARD #280001-02



SCALE: 1 INCH = 50 FEET

MAURER & STUTZ, INC. ENGINEERS SURVEYORS		1670 EAST ASH STREET CANTON, ILLINOIS 61520 PH. (309) 647-7831 FAX (309) 647-6155
ASH STREET EROSION CONTROL 9TH AVE. TO 11TH AVE.		
FOR: CITY OF CANTON, ILLINOIS		
REVISIONS DESIGNED CHECKED DRAWN CHECKED	DATE: 04/14/06 - - JAM GBM	PROJECT NO. 234-06013A DRAWING NO. 1 SHEET 2 OF 2
FIELD BK.		