

| F.A. RTE. | SECTION | CITY | TOTAL SHEETS | SHEET NO. |
|---------------------------|---------|---------------|--------------|-----------|
| * | *** | SPRINGFIELD | 34 | 5 |
| STA. 30+50 | | TO STA. 36+00 | | ** |
| ILLINOIS FED. AID PROJECT | | | | |
| * N&W RAILROAD BIKE TRAIL | | | | |
| *** 99-P4001-00-BT | | | | |
| ** TE-0006(070) | | | | |

| PLAN | DATE | BY |
|-----------|------|----|
| REVISIONS | | |
| NOTED | | |
| NOTE BOOK | | |
| NO. | | |

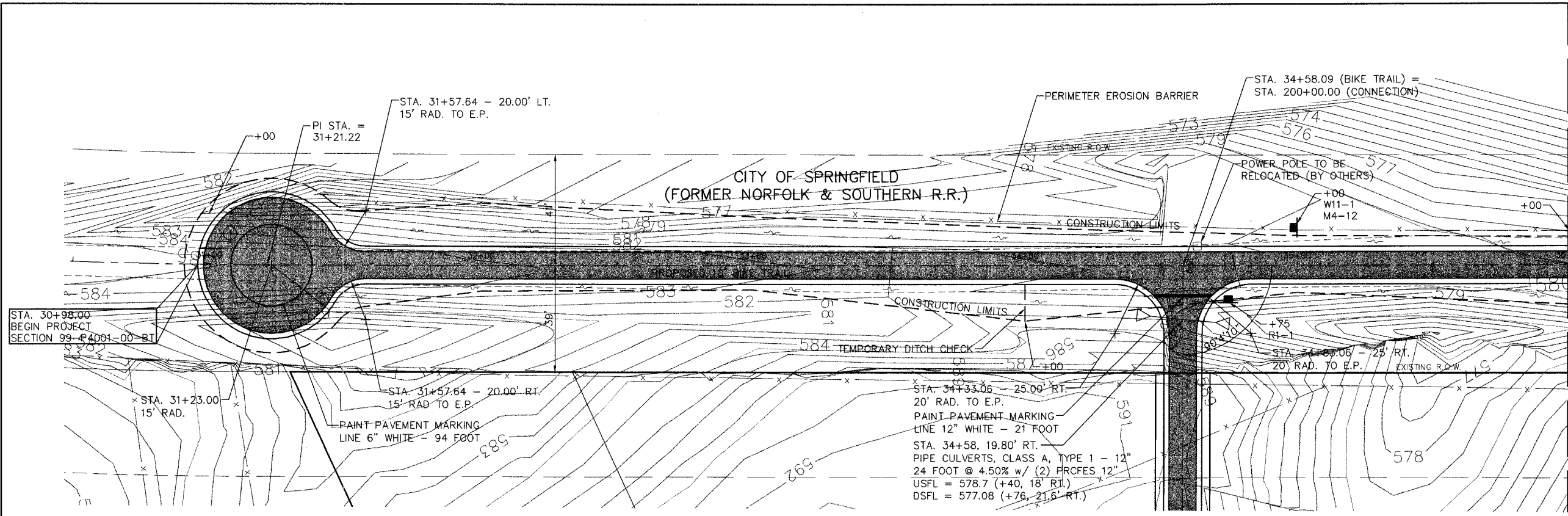

MATCH LINE STA. 36+00

LEGEND

- BIKE TRAIL
- PROPOSED 6' & VARIABLE PERMANENT EASEMENT
- TREE REMOVAL
- PRELIMINARY SURVEY POINTS

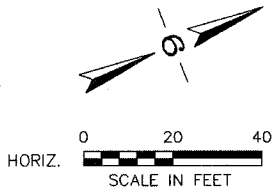

BENCHMARK: RAILROAD SPIKE IN POWER POLE (TBM #290)
 STA. 34+63.28 - 7.15' LT.
 ELEVATION = 582.42

| REVISIONS | DATE | BY |
|-----------|------|----|
| | | |
| | | |

GREENE & BRADFORD, INC.
 OF SPRINGFIELD
 CONSULTING ENGINEERS
 3005 CONSTITUTION DRIVE
 SPRINGFIELD, ILLINOIS 62707
 (217) 793-8844, (217) 793-8227 FAX

COMPUTER FILE NO.
 99391PP05 - 20
 PROJECT:
 99-391

| PROFILE | DATE | BY |
|-----------|------|----|
| REVISIONS | | |
| NOTED | | |
| NOTE BOOK | | |
| NO. | | |

