

SEC 7, T 1 N, R 1 W, 4TH PM

PROP. CURVE SSUGAR-15
 PI STA. = 222+80.94
 $\Delta = 1^\circ 55' 45''$ (LT)
 $D = 0^\circ 30' 00''$
 $R = 11,460.00'$
 $T = 192.94'$
 $L = 385.85'$
 $E = 1.62'$
 $\theta = \text{NONE}$
 P.C. STA. = 220+87.99
 P.T. STA. = 224+73.84

F.A.S. RTE.	SECTION	COUNTY	TOTAL SHEETS	SHEET NO.
582	92-00061-00-RS	SCHUYLER	21	13
STA. 209+00.00		TO STA. 239+00.00		
FED. ROAD DIST. NO.		ILLINOIS PROJECT NO. SR-582(115)		

CONTRACT NO. 93410

SEC 6, T 1 N, R 1 W, 4TH PM

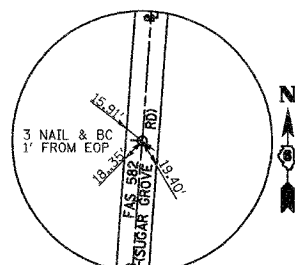
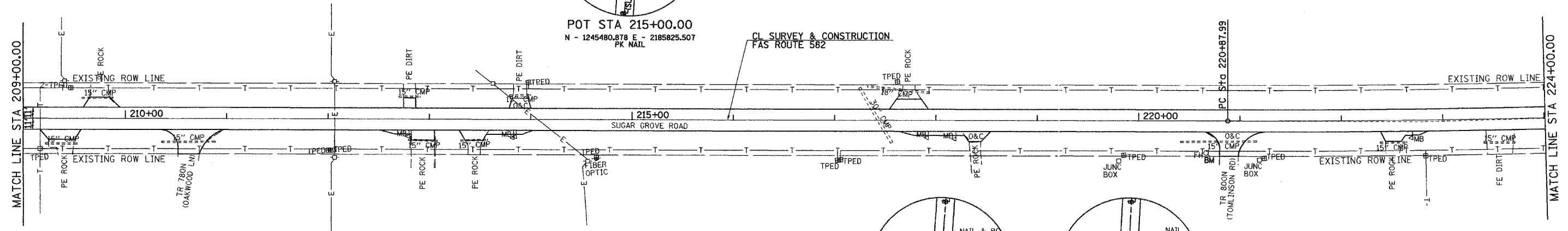

POT STA 215+00.00
 N - 1245480.878 E - 2185825.507
 PK NAIL

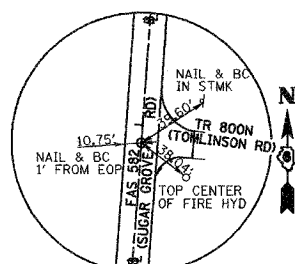

PC STA 220+87.99
 N - 1246067.212 E - 2185869.651
 PK NAIL

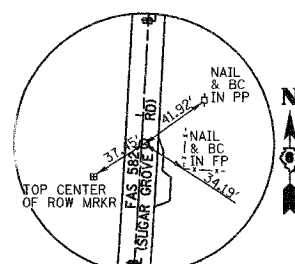

PI STA 222+80.94
 N - 1246259.610 E - 2185884.137
 PK NAIL

SEC 6, T 1 N, R 1 W, 4TH PM

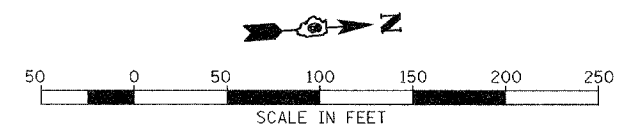

SEC 7, T 1 N, R 1 W, 4TH PM

SEC 6, T 1 N, R 1 W, 4TH PM

PROP. CURVE SSUGAR-16
 PI STA. = 231+91.73
 $\Delta = 2^\circ 13' 18''$ (LT)
 $D = 0^\circ 30' 00''$
 $R = 11,460.00'$
 $T = 222.22'$
 $L = 444.39'$
 $E = 2.15'$
 $\theta = \text{NONE}$
 P.C. STA. = 229+69.51
 P.T. STA. = 234+13.89

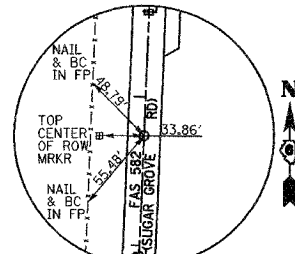
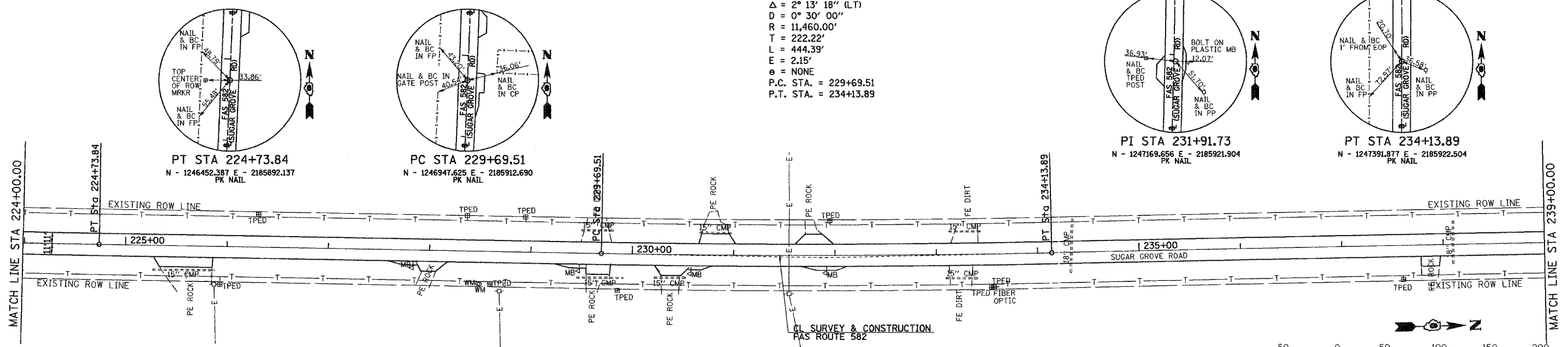

PT STA 224+73.84
 N - 1246452.387 E - 2185892.137
 PK NAIL

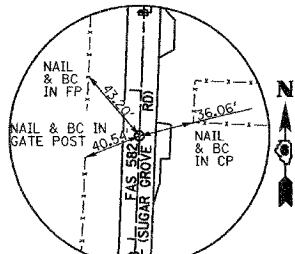

PC STA 229+69.51
 N - 1246947.625 E - 2185912.690
 PK NAIL

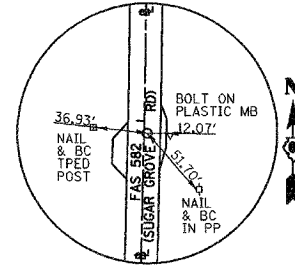

PI STA 231+91.73
 N - 1247169.656 E - 2185921.904
 PK NAIL

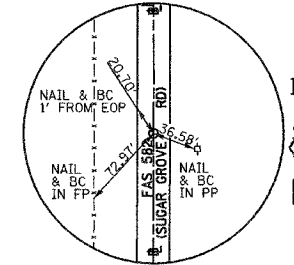

PT STA 234+13.89
 N - 1247391.877 E - 2185922.504
 PK NAIL

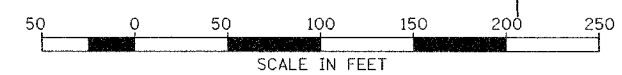

SEC 6, T 1 N, R 1 W, 4TH PM

REVISIONS	
NAME	DATE

ILLINOIS DEPARTMENT OF TRANSPORTATION
 COUNTY HIGHWAY 1
 RESURFACING PLANS
 STA 209+00 TO STA 239+00
 DATE JULY 27, 2005
 DRAWN BY: JCW
 CHECKED BY: JRB