

37TH STREET

	HARRISON		37TH STREET		ELEVATION
	STATION	OFFSET	STATION	OFFSET	
B1	203+62.86	49.38 LT	10+49.27	13.00 LT	661.29
B2	203+62.46	44.86 LT	10+44.74	13.34 LT	661.26
B3	203+61.42	40.46 LT	10+40.32	14.36 LT	661.14
B4	203+59.75	36.28 LT	10+36.11	16.04 LT	660.97
B5	203+57.48	32.42 LT	10+32.19	18.33 LT	660.78
B6	203+54.65	28.98 LT	10+28.67	21.19 LT	660.60
B7	203+51.33	26.03 LT	10+25.62	24.54 LT	660.45
B8	203+47.60	23.66 LT	10+23.10	28.32 LT	660.31
B9	203+43.54	21.92 LT	10+21.19	32.43 LT	660.20
B10	203+39.26	20.86 LT	10+19.92	36.79 LT	660.11
B11	203+34.87	20.50 LT	10+19.32	41.28 LT	660.01

	HARRISON		37TH STREET		ELEVATION
	STATION	OFFSET	STATION	OFFSET	
A1	204+15.13	20.50 LT	10+19.32	41.28 RT	662.02
A2	204+10.74	20.86 LT	10+19.92	36.79 RT	661.90
A3	204+06.46	21.92 LT	10+21.19	32.43 RT	661.77
A4	204+02.40	23.66 LT	10+23.10	28.32 RT	661.64
A5	203+98.67	26.03 LT	10+25.62	24.54 RT	661.53
A6	203+95.35	28.98 LT	10+28.67	21.19 RT	661.45
A7	203+92.52	32.42 LT	10+32.19	18.33 RT	661.41
A8	203+90.25	36.28 LT	10+36.11	16.04 RT	661.37
A9	203+88.58	40.46 LT	10+40.32	14.36 RT	661.35
A10	203+87.54	44.86 LT	10+44.74	13.34 RT	661.33
A11	203+87.14	49.38 LT	10+49.27	13.00 RT	661.29

HARRISON CURVE #1 DATA
 PI STA = 205+34.20
 $\Delta = 53^{\circ}55'06''$ RT
 D = 8'11'06"
 R = 700.00'
 T = 356.04'
 L = 658.74'
 E = 85.34'
 SE = RC (2.0%)
 PC STA = 201+78.16
 PRC STA = 208+36.89
 SE ATTAINED STA 201+42 TO STA 201+96
 SE REMOVED STA 207+83 TO STA 208+37

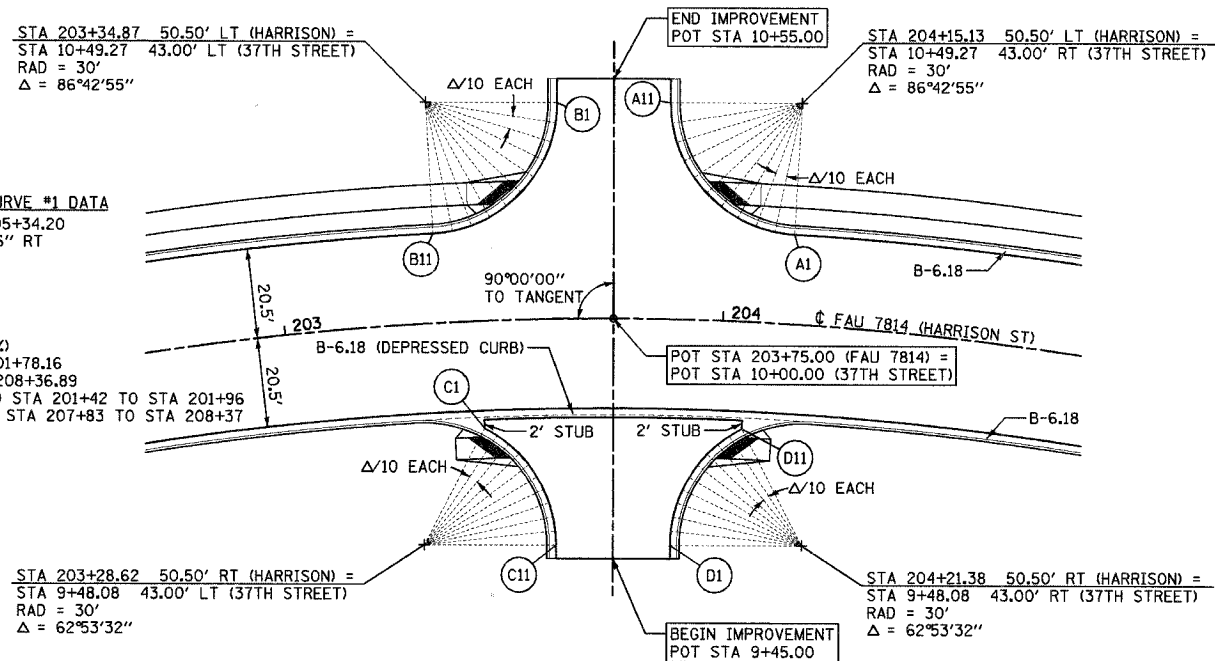

	HARRISON		37TH STREET		ELEVATION
	STATION	OFFSET	STATION	OFFSET	
C1	203+44.59	24.58 RT	9+74.78	29.33 LT	660.33
C2	203+47.47	26.36 RT	9+73.12	26.49 LT	660.44
C3	203+50.14	28.42 RT	9+71.16	23.84 LT	660.55
C4	203+52.58	30.73 RT	9+68.92	21.43 LT	660.65
C5	203+54.76	33.29 RT	9+66.44	19.27 LT	660.77
C6	203+56.65	36.05 RT	9+63.73	17.41 LT	660.90
C7	203+58.22	38.98 RT	9+60.83	15.85 LT	661.02
C8	203+59.45	42.06 RT	9+57.78	14.61 LT	661.14
C9	203+60.33	45.25 RT	9+54.61	13.72 LT	661.23
C10	203+60.84	48.51 RT	9+51.36	13.18 LT	661.31
C11	203+60.96	51.79 RT	9+48.08	13.00 LT	661.38

	HARRISON		37TH STREET		ELEVATION
	STATION	OFFSET	STATION	OFFSET	
D1	203+89.04	51.79 RT	9+48.08	13.00 RT	661.38
D2	203+89.16	48.51 RT	9+51.36	13.18 RT	661.39
D3	203+89.67	45.25 RT	9+54.61	13.72 RT	661.44
D4	203+90.55	42.06 RT	9+57.78	14.61 RT	661.50
D5	203+91.78	38.98 RT	9+60.83	15.85 RT	661.56
D6	203+93.35	36.05 RT	9+63.73	17.41 RT	661.62
D7	203+95.24	33.29 RT	9+66.44	19.27 RT	661.68
D8	203+97.42	30.73 RT	9+68.92	21.43 RT	661.73
D9	203+99.86	28.42 RT	9+71.16	23.84 RT	661.77
D10	204+02.53	26.36 RT	9+73.12	26.49 RT	661.81
D11	204+05.41	24.58 RT	9+74.78	29.33 RT	661.85

NOTE:
 PAY LIMITS OF THE B-6.18 CURB AND GUTTER SHALL FOLLOW THE CURB AROUND THE RADII AND BETWEEN THE 2' STUBS FOR THE SOUTH LEG OF 37TH STREET. THE COST OF THE ADDITIONAL CONCRETE AND REINFORCEMENT FOR THE STUB AREAS SHALL BE INCLUDED IN THE COST OF THE PAY ITEM "COMBINATION CONCRETE CURB AND GUTTER, TYPE B-6.18".

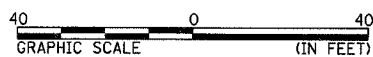

38TH STREET

	HARRISON		38TH STREET		ELEVATION
	STATION	OFFSET	STATION	OFFSET	
B1	210+70.96	51.79 LT	50+51.92	13.00 LT	674.52
B2	210+70.64	46.90 LT	50+47.04	13.40 LT	674.50
B3	210+69.47	42.12 LT	50+42.28	14.59 LT	674.47
B4	210+67.51	37.57 LT	50+37.78	16.55 LT	674.43
B5	210+64.83	33.38 LT	50+33.65	19.21 LT	674.39
B6	210+61.50	29.64 LT	50+30.02	22.50 LT	674.35
B7	210+57.61	26.46 LT	50+26.97	26.34 LT	674.30
B8	210+53.27	23.90 LT	50+24.59	30.63 LT	674.26
B9	210+48.58	22.03 LT	50+22.94	35.25 LT	674.21
B10	210+43.66	20.88 LT	50+22.07	40.08 LT	674.15
B11	210+38.62	20.50 LT	50+21.99	44.99 LT	674.07

	HARRISON		38TH STREET		ELEVATION
	STATION	OFFSET	STATION	OFFSET	
A1	211+31.38	20.50 LT	50+21.99	44.99 RT	675.66
A2	211+26.34	20.88 LT	50+22.07	40.08 RT	675.57
A3	211+21.42	22.03 LT	50+22.94	35.25 RT	675.44
A4	211+16.73	23.90 LT	50+24.59	30.63 RT	675.28
A5	211+12.39	26.46 LT	50+26.97	26.34 RT	675.10
A6	211+08.50	29.64 LT	50+30.02	22.50 RT	674.88
A7	211+05.17	33.38 LT	50+33.65	19.21 RT	674.67
A8	211+02.49	37.57 LT	50+37.78	16.55 RT	674.49
A9	211+00.53	42.12 LT	50+42.28	14.59 RT	674.47
A10	210+99.36	46.90 LT	50+47.04	13.40 RT	674.50
A11	210+99.04	51.79 LT	50+51.92	13.00 RT	674.52

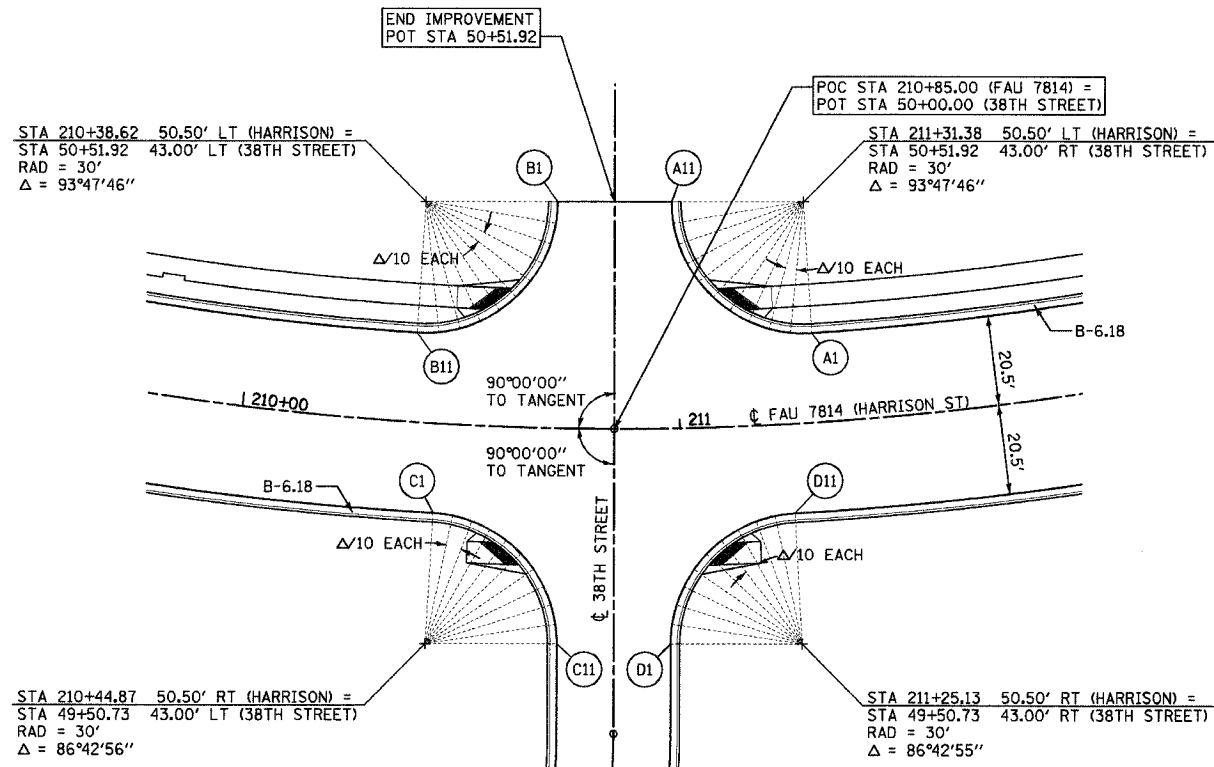

	HARRISON		38TH STREET		ELEVATION
	STATION	OFFSET	STATION	OFFSET	
C1	210+44.87	20.50 RT	49+80.68	41.28 LT	675.00
C2	210+49.26	20.86 RT	49+80.08	36.79 LT	675.08
C3	210+53.54	21.92 RT	49+78.81	32.43 LT	675.15
C4	210+57.60	23.66 RT	49+76.90	28.32 LT	675.20
C5	210+61.33	26.03 RT	49+74.38	24.54 LT	675.23
C6	210+64.65	28.98 RT	49+71.33	21.19 LT	675.22
C7	210+67.48	32.42 RT	49+67.81	18.33 LT	675.18
C8	210+69.75	36.28 RT	49+63.89	16.04 LT	675.13
C9	210+71.42	40.46 RT	49+59.68	14.36 LT	675.08
C10	210+72.46	44.86 RT	49+55.26	13.34 LT	675.02
C11	210+72.86	49.38 RT	49+50.73	13.00 LT	674.93

HARRISON CURVE #2 DATA
 PI STA = 211+99.41
 $\Delta = 54^{\circ}45'28''$ LT
 D = 8'11'06"
 R = 700.00'
 T = 362.52'
 L = 668.99'
 E = 88.30'
 SE = RC (2.0%)
 PRC STA = 208+36.89
 PT STA = 215+05.89
 SE ATTAINED STA 208+37 TO STA 208+91
 SE REMOVED STA 214+88 TO STA 113+56

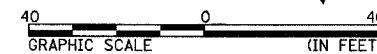

REVISIONS	
NAME	DATE
TITLE BLOCK - SEB	9/26/05
ROW COMM. - SEB	3/6/06

GEOMETRIC DETAILS
 SIDE STREETS
 FAU 7814 (HARRISON STREET)
 SECTION 05-00186-01-PV
 ADAMS COUNTY
 SCALE: 1"=20'
 DATE: 9/12/05
 DRAWN BY: SEB
 CHECKED BY: SRW