

FINAL SURVEY PLOTTED
 SURVEY PLOTTED
 NOTE BOOK
 AREAS CHECKED

ORIGINAL SURVEY PLOTTED
 SURVEY PLOTTED
 NOTE BOOK
 AREAS CHECKED

3/6/2006

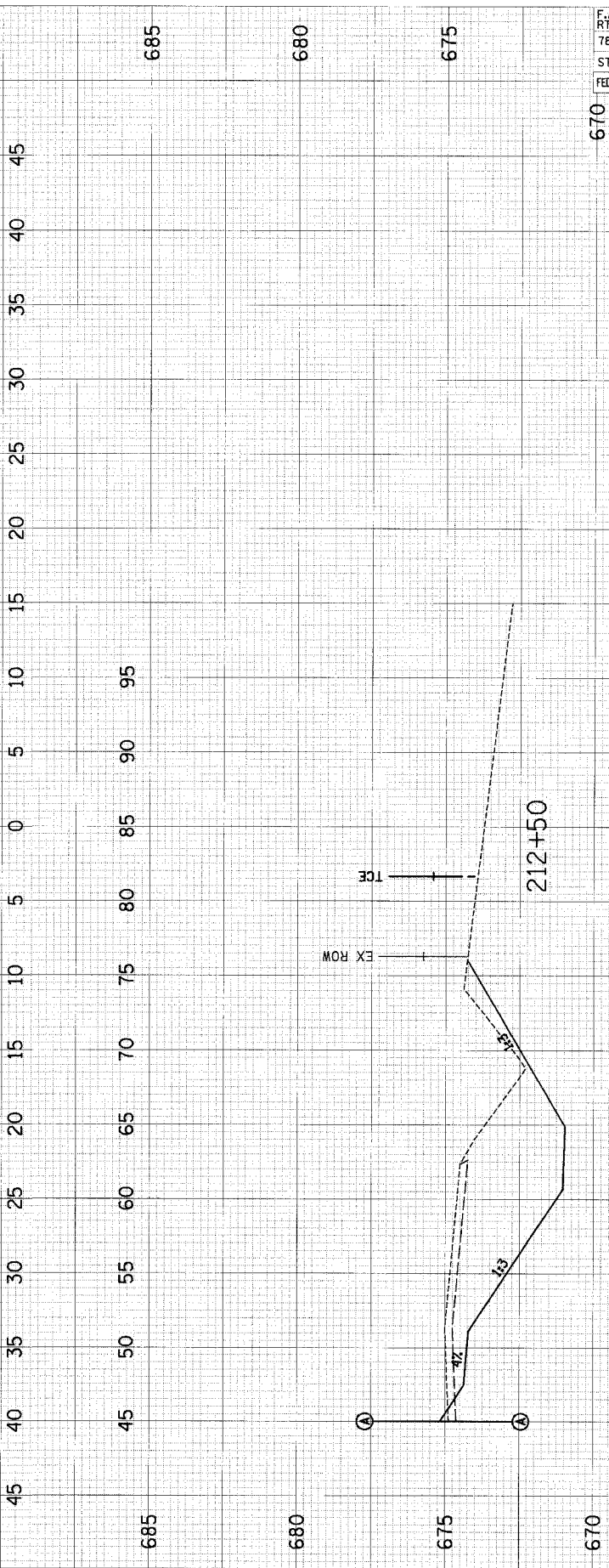
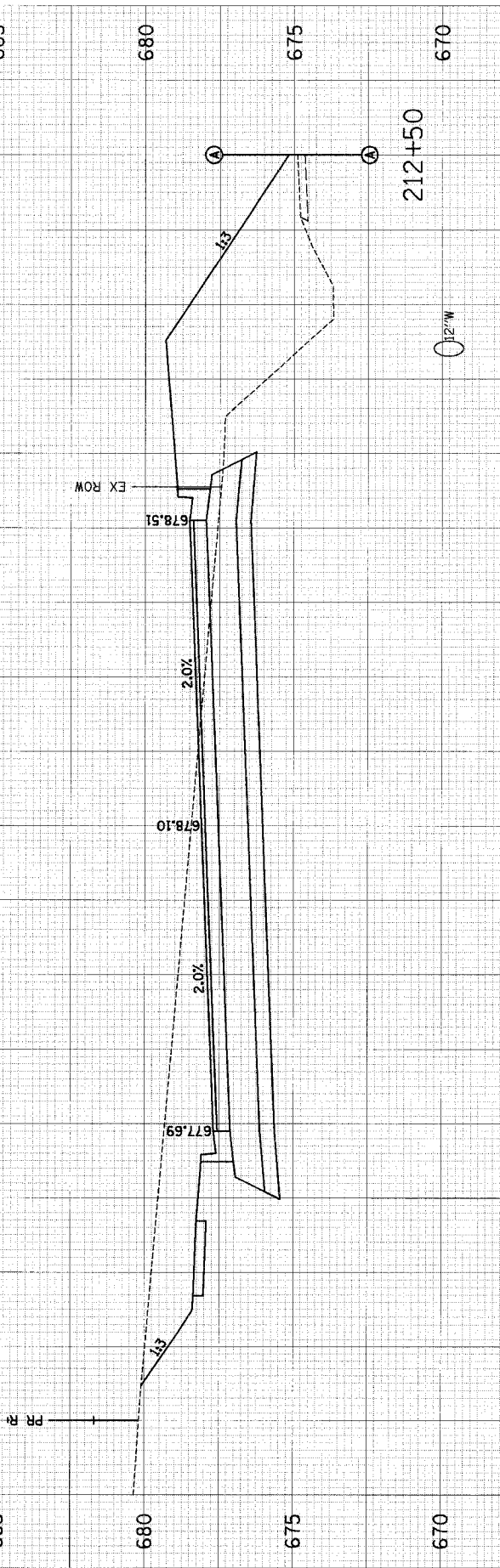
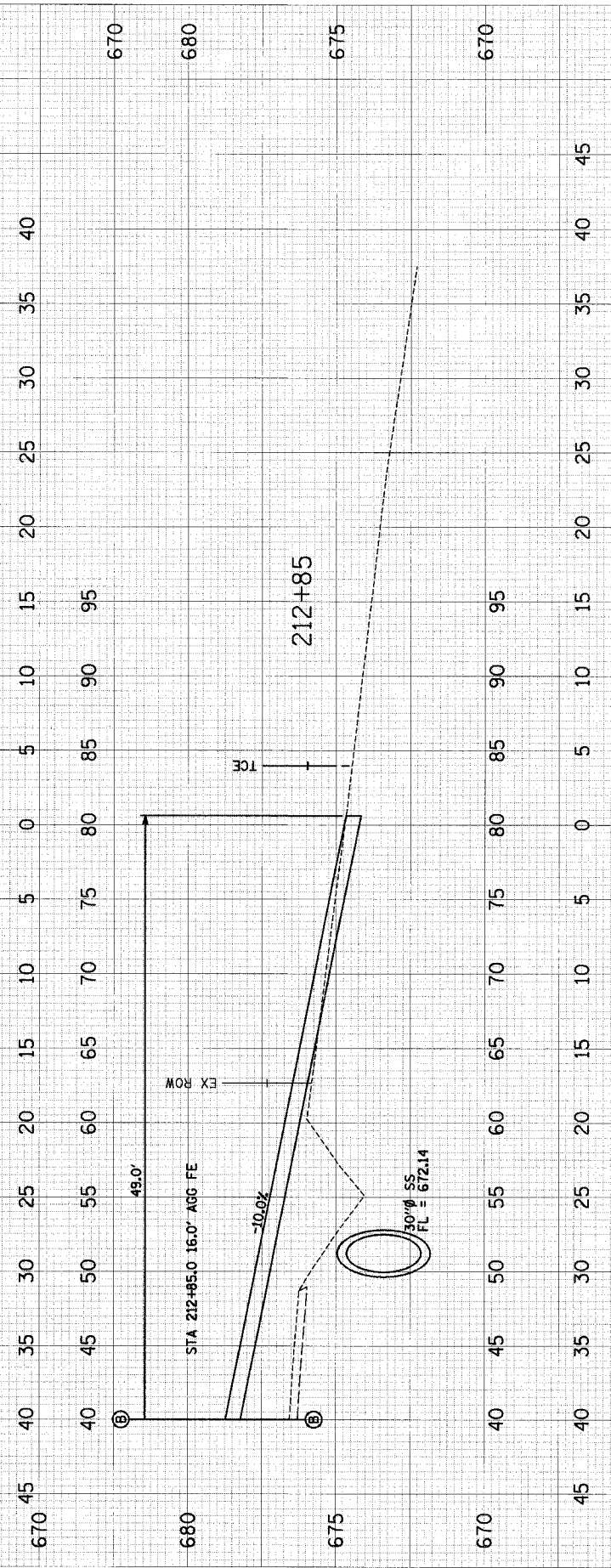
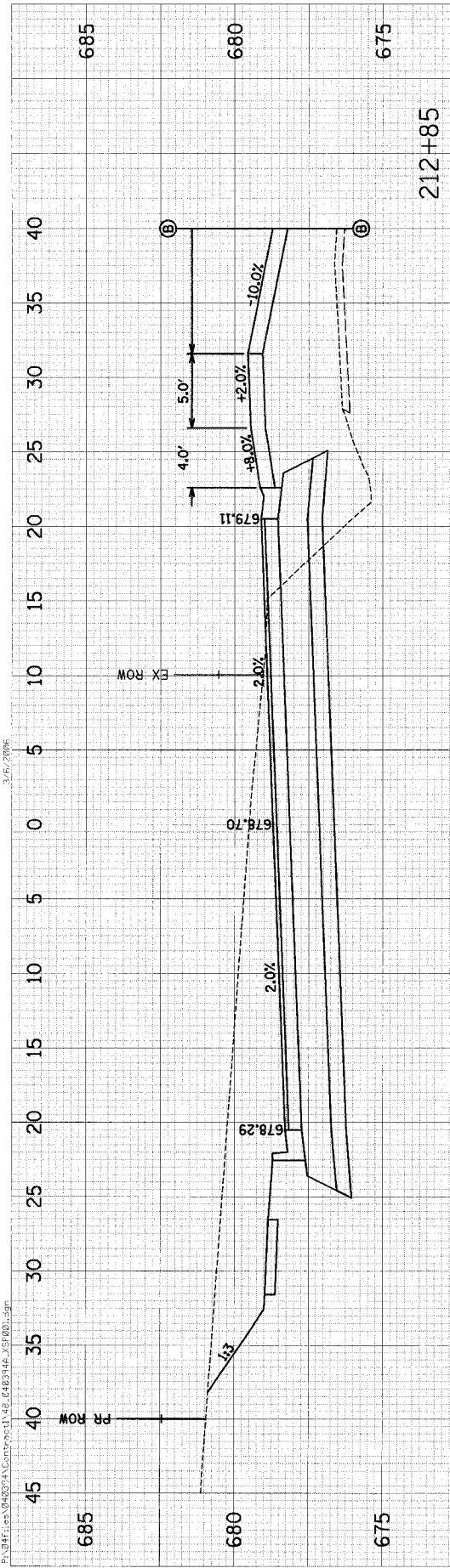

F.A.U. RTE.	SECTION	COUNTY	TOTAL SHEETS	SHEET NO.
7814	05-00186-01-PV	ADAMS	78	56
STA.		TO STA.		
FED. ROAD DIST. NO.		ILLINOIS FED. AID PROJECT		