

3/3/2006
 c:\projects\94867\d05503
 REV: C

PROJECT ENGINEER : BILL STANLEY
 SQUAD LEADER : MYRA OLTMAN
 DESIGNER : MYRA OLTMAN
 TELEPHONE : 217/342-3951 EX 314

STATE OF ILLINOIS
 DEPARTMENT OF TRANSPORTATION
 DIVISION OF HIGHWAYS
**PROPOSED
 HIGHWAY PLANS**
 FAP ROUTE 116 (IL 130)
 SECTION 121RS-3, 122RS-4
 PROJECT NO: F-0116(047)
 JASPER COUNTY
 C-97-070-03

94867

FAP ETC.	SECTION	COUNTY	TOTAL SHEETS	SHEET NO.
116	121RS-3 122RS-4	JASPER	31	1

FED. ROAD DIST. NO. 1 ILLINOIS FED. AID PROJECT NO.

INDEX OF SHEETS
 SEE SHEET 2 FOR INDEX OF SHEETS

STATION EQUATIONS
 STATION 50+35.90 BK = STATION 50+89.10 AH
 STATION 132+03.20 BK = STATION 132+08.40 AH
 STATION 135+61.10 BK = STATION 135+79.50 AH
 STATION 245+33.80 BK = STATION 245+33.60 AH
 STATION 293+63.80 BK = STATION 293+72.40 AH
 STATION 379+44.50 BK = STATION 379+57.80 AH

OMISSIONS
 STATION 99+79.77 TO STATION 101+03.23

2003 ADT = 4200

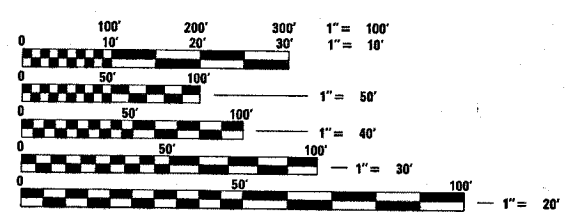

FULL SIZE PLANS HAVE BEEN PREPARED USING STANDARD ENGINEERING SCALES, REDUCED SIZED PLANS WILL NOT CONFORM TO STANDARD SCALES, IN MAKING MEASUREMENTS ON REDUCED PLANS, THE ABOVE SCALES MAY BE USED.

J.U.L.I.E.
 JOINT UTILITY LOCATION INFORMATION FOR EXCAVATION
 1-800-892-0123

CONTRACT NO. 94867

TOWNSHIP : WADE AND FOX

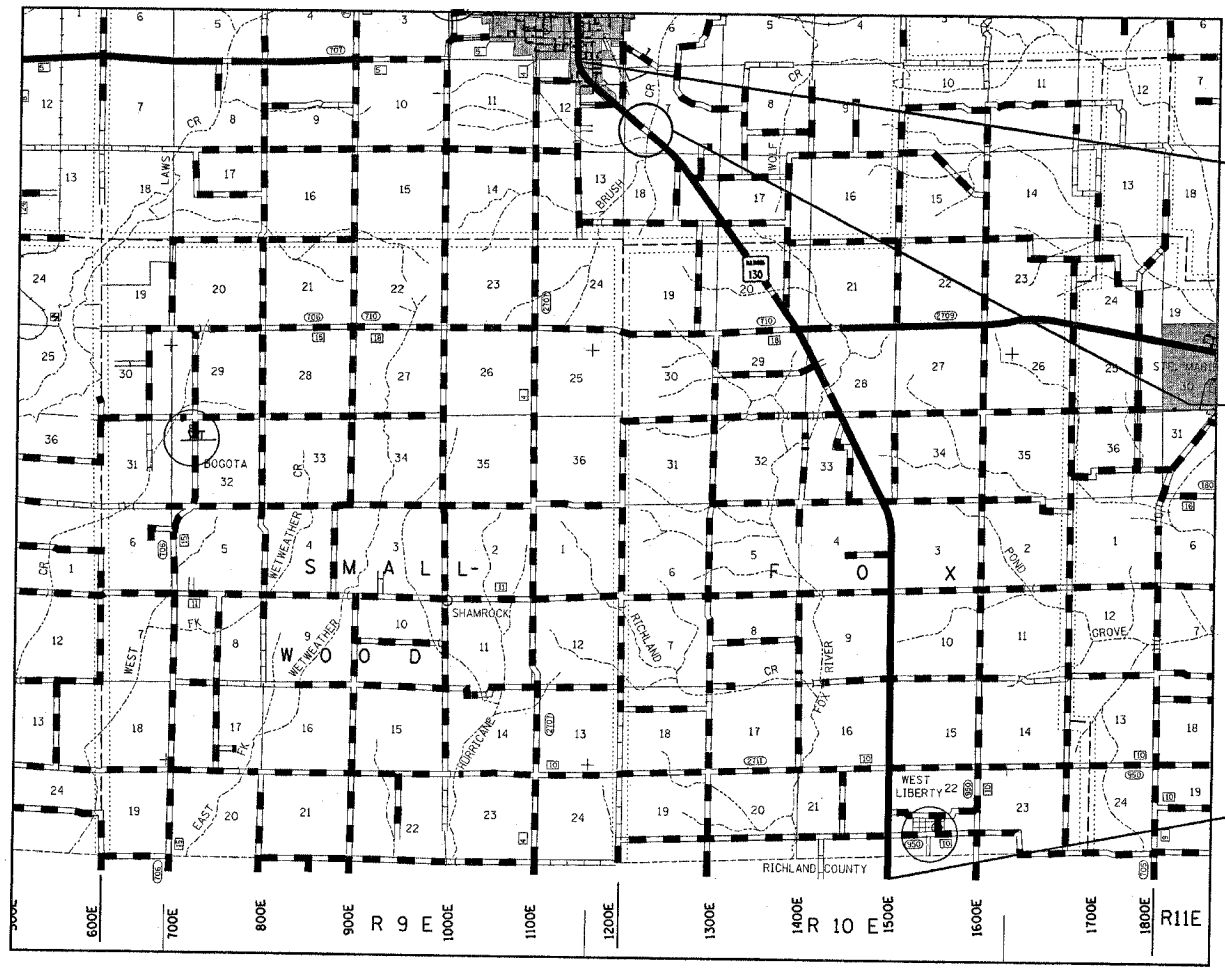

LOCATION MAP
 GROSS LENGTH = 54195.5 FEET = 10.26 MILES
 NET LENGTH = 54028.5 FEET = 10.23 MILES

PROJECT BEGINS
 STA. 40+00

BRIDGE OMISSION
 STR# 040-0018

PROJECT ENDS
 STA. 582+94

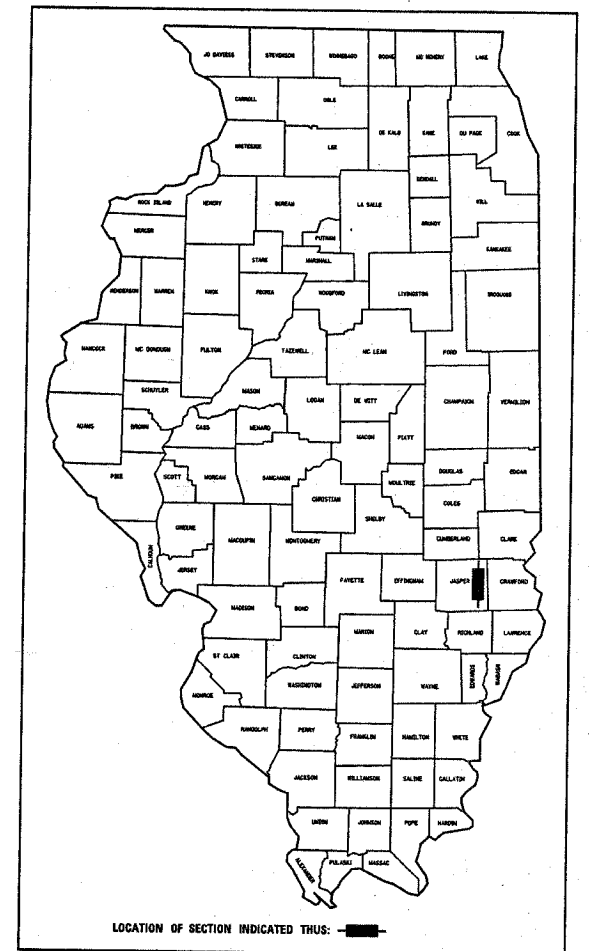

STATE OF ILLINOIS
 DEPARTMENT OF TRANSPORTATION
 DIVISION OF HIGHWAYS

SUBMITTED March 7, 2006
Christ M. Reed
 DISTRICT ENGINEER

ENGINEER OF PROJECT DEVELOPMENT AND IMPLEMENTATION
May 12, 2006
Mike Stone
 ENGINEER OF DESIGN AND ENVIRONMENT

May 12, 2006
Milton R. Sees, P.E.
 DIRECTOR, DIVISION OF HIGHWAYS

PRINTED BY THE AUTHORITY OF
 THE STATE OF ILLINOIS

SEAL

district
teasleyk+_DATE-
ci:\projects\94867\d05503pa.dgn
GN&I

GENERAL NOTES

THIS SECTION SHALL BE CONSTRUCTED IN ACCORDANCE WITH THE PLANS; THE "STANDARD SPECIFICATIONS FOR ROAD AND BRIDGE CONSTRUCTION", ADOPTED JANUARY 1, 2002; THE "SUPPLEMENTAL SPECIFICATIONS AND RECURRING SPECIAL PROVISIONS" INDICATED ON THE CHECK SHEET, AND "THE SPECIAL PROVISIONS" INCLUDED IN THE PROPOSAL.

THIS PROJECT IS LOCATED ON ILLINOIS ROUTE 130 IN JASPER COUNTY FROM EDWARDS STREET IN NEWTON FOR 10.23 MILES SOUTH TO THE RICHLAND COUNTY LINE. THE WORK INCLUDED IN SECTION (121RS-3, & 122RS-4) CONSISTS OF PAVEMENT PATCHING, MILLING, BITUMINOUS RESURFACING, AGGREGATE SHOULDER WEDGE, PAVEMENT MARKING, AND OTHER WORK NECESSARY TO COMPLETE THE SECTION.

THE CONTRACTOR WILL PROVIDE INTERNET ACCESSIBILITY TO THE BITUMINOUS PLANT QUALITY CONTROL LAB SO THAT BITUMINOUS PLANT REPORTS CAN BE E-MAILED TO THE DISTRICT HEADQUARTERS. THIS WORK SHALL BE INCLUDED IN THE COST OF ALL BITUMINOUS ITEMS.

PAVEMENT MARKING SHALL BE APPLIED IN ACCORDANCE WITH SECTION 780 OF THE STANDARD SPECIFICATIONS. SHORT TERM PAVEMENT MARKING SHALL BE APPLIED TO THE MILLED SURFACE, BITUMINOUS MATERIALS (PRIME COAT), LEVEL BINDER, AND BITUMINOUS SURFACE COURSE AS SPECIFIED IN SECTION 703 OF THE STANDARD SPECIFICATIONS. TEMPORARY TAPE SHALL BE USED ON THE SURFACE COURSE AND PAINT SHALL BE USED ON MILLED SURFACES.

THE TOTAL QUANTITY OF PAINT PAVEMENT MARKING-LINE 4" CONSISTS OF 15657 FEET OF YELLOW AND 106311 FEET OF WHITE.

THE TOTAL QUANTITY OF PAINT PAVEMENT MARKING-LINE 6" CONSISTS OF 400 FEET OF WHITE.

THE TOTAL QUANTITY OF RAISED REFLECTIVE PAVEMENT MARKERS IS 688 TWO-WAY AMBER.

THE MATERIAL USED FOR AGGREGATE SHOULDERS, TYPE B AND AGGREGATE SURFACE COURSE, TYPE B SHALL BE CRUSHED STONE, CRUSHED CONCRETE, OR RAP.

ANY EXCAVATION REQUIRED TO CONSTRUCT BITUMINOUS SHOULDERS 8" SHALL BE INCLUDED IN THE COST OF PAVED SHOULDER REMOVAL.

BITUMINOUS MATERIALS (PRIME COAT), THE CONTRACTOR SHALL USE EITHER RC-70 OR AN EMULSIFIED POLYMER PRIME SS-1HP.

THE PAY ITEM TEMPORARY RAMP HAS BEEN INCLUDED FOR THE CONSTRUCTION OF TEMPORARY RAMPS IN ACCORDANCE WITH ARTICLE 406.18 OF THE STANDARD SPECIFICATIONS. THE COST SHALL INCLUDE BOTH THE INSTALLATION AND THE REMOVAL OF THE TEMPORARY RAMPS.

THE RESIDENT ENGINEER SHALL BE THE SOLE JUDGE CONCERNING THE CURING TIME FOR THE VARIOUS BITUMINOUS LIFTS.

THE FOLLOWING MIXTURE REQUIREMENTS ARE APPLICABLE TO THIS PROJECT:

MIXTURE USE: SURFACE COURSE
APPLICATION: BITUMINOUS CONCRETE SURFACE COURSE SUPERPAVE
PG GRADE: PG 64-22
RAP%: 15%
DESIGN AIR VOIDS: 4.0% @ NDESIGN = 70
MIXTURE COMPOSITION: IL-9.5
FRICTION AGGREGATE: MIXTURE C

MIXTURE USE: LEVEL BINDER SUPERPAVE
APPLICATION: LEVEL BINDER MACHINE METHOD SUPERPAVE
PG GRADE: PG 64-22
RAP%: 15%
DESIGN AIR VOIDS: 4.0% @ NDESIGN = 70
MIXTURE COMPOSITION: IL-9.5
FRICTION AGGREGATE: N/A

MIXTURE USE: PAVEMENT PATCHING
APPLICATION: BITUMINOUS CONCRETE BINDER COURSE SUPERPAVE
PG GRADE: PG 64-22
RAP%: 25%
DESIGN AIR VOIDS: 4.0% @ NDESIGN = 70
MIXTURE COMPOSITION: IL-19.0
FRICTION AGGREGATE: N/A

MIXTURE USE: BITUMINOUS SHOULDERS SUPERPAVE
APPLICATION: BITUMINOUS SHOULDERS SUPERPAVE, 6 INCH COURSE SUPERPAVE
PG GRADE: PG 64-22
RAP%: 25%
DESIGN AIR VOIDS: 4.0% @ NDESIGN = 70
MIXTURE COMPOSITION: IL-19.0
FRICTION AGGREGATE: N/A

MIXTURE USE: INCIDENTAL BITUMINOUS SURFACE (DRIVEWAYS)
APPLICATION: INCIDENTAL BITUMINOUS SURFACING SUPERPAVE
PG GRADE: PG 64-22
RAP%: 15%
DESIGN AIR VOIDS: 4.0% @ NDESIGN = 50
MIXTURE COMPOSITION: IL-9.5
FRICTION AGGREGATE: MIXTURE C

THE FOLLOWING RATES OF APPLICATION HAVE BEEN USED IN THE CALCULATING PLAN QUANTITIES:

AGGREGATE SURFACE COURSE	2.05 TONS/CU. YD.
AGGREGATE SHOULDERS	2.05 TONS/CU. YD.
BITUMINOUS MATERIALS (PRIME COAT)	0.10 GAL/SQ. YD.
AGGREGATE (PRIME COAT)	4 LBS./SQ. YD.
BITUMINOUS CONCRETE	112 LBS./SQ. YD/INCH

FAP ETC.	SECTION	COUNTY	TOTAL SHEETS	SHEET NO.
116	121RS-3 122RS-4	JASPER	31	2
FED. ROAD DIST. NO. 7		ILLINOIS	FED. AID PROJECT NO.	

CONTRACT NO. 94867

INDEX OF SHEETS

SHEET NO.	ITEM
1	COVER SHEET
2	INDEX OF SHEETS AND GENERAL NOTES
3	SUMMARY OF QUANTITIES
4-5	TYPICAL SECTIONS
6	ENTRANCE SCHEDULE & MAILBOX TURNOUT DETAIL
7	RESURFACING AND PAVEMENT MARKING SCHEDULE
8	BUTT JOINT DETAIL & BITUMINOUS FEATHER DETAIL
9	PAVEMENT MARKING SCHEDULES & PATCHING DETAILS
10	PAVEMENT MARKING DETAILS AT ST. MARIE ROAD
11-12	PAVEMENT MARKING DETAILS
13-31	PLAN SHEETS

THE FOLLOWING STANDARDS ARE A PART OF THESE PLANS AND ARE INCLUDED AFTER SHEET NO. 31.

STD. NO.	DESCRIPTION
000001-04	STANDARD SYMBOLS, ABBREVIATIONS, AND PATTERNS
001001	AREAS OF REINFORCEMENT BARS
406201	MAILBOX TURNOUT
442101-05	CLASS B PATCHES
442201-01	CLASS C AND D PATCHES
482006-01	BITUMINOUS SHOULDER ADJACENT TO RIGID PAVEMENT
701001-01	OFF-RD OPERATIONS, 2L, 2W, 15 FT. MIN. AWAY, FOR SPEEDS >=45 MPH
701006-02	OFF-RD OPERATIONS, 2L, 2W, 15 FT. TO 2 FT. AWAY, FOR SPEEDS >=45 MPH
701011-01	OFF-RD MOVING OPERATIONS, 2L, 2W, DAY ONLY
701301-02	LANE CLOSURE, 2L, 2W, SHORT-TIME OPERATIONS
701306-01	LANE CLOSURE, 2L, 2W, SLOW MOVING DAY ONLY OPERATIONS, FOR SPEEDS >=45 MPH
701311-02	LANE CLOSURE, 2L, 2W, MOVING DAY ONLY OPERATIONS
701336-04	LANE CLOSURE, 2L, 2W, WORK AREAS IN SERIES, FOR SPEEDS >=45 MPH
702001-06	TRAFFIC CONTROL DEVICES
780001-01	TYPICAL PAVEMENT MARKINGS
781001-02	TYPICAL APPLICATIONS RAISED REFLECTIVE PAVEMENT MARKERS

REVISIONS	
NAME	DATE

ILLINOIS DEPARTMENT OF TRANSPORTATION

**GENERAL NOTES
&
INDEX OF SHEETS**

SCALE: VERT.
HORIZ.
DATE

DRAWN BY
CHECKED BY

district
 3/3/2006
 c:\projects\94867\d\05503pa.dgn

FAP SITE	SECTION	COUNTY	TOTAL SHEETS	SHEET NO.
116	121RS-3 122RS-4	JASPER	31	3
FED. ROAD DIST. NO. 7		ILLINOIS	FED. AID PROJECT NO.	

CONTRACT NO. 94867

SUMMARY OF QUANTITIES			90% FED. 20% STATE	CONSTRUCTION TYPE CODE	
CODE NO	ITEM	UNIT	TOTAL QUANTITIES	1000	
40200800	AGGREGATE SURFACE COURSE, TYPE B	TON	253	253	
40600100	BITUMINOUS MATERIALS (PRIME COAT)	GALLON	18098	18098	
40600300	AGGREGATE (PRIME COAT)	TON	291	291	
40600895	CONSTRUCTING TEST STRIP	EACH	1	1	
40600980	BITUMINOUS SURFACE REMOVAL - BUTT JOINT	SQ YD	427	427	
40600990	TEMPORARY RAMP	SQ YD	64	64	
44000030	BITUMINOUS SURFACE REMOVAL (VARIABLE DEPTH)	SQ YD	180600	180600	
44004250	PAVED SHOULDER REMOVAL	SQ YD	200	200	
44201815	CLASS D PATCHES, TYPE II, 14 INCH	SQ YD	3300	3300	
44201819	CLASS D PATCHES, TYPE III, 14 INCH	SQ YD	394	394	
44201821	CLASS D PATCHES, TYPE IV, 14 INCH	SQ YD	313	313	
48101200	AGGREGATE SHOULDERS, TYPE B	TON	7251	7251	
48202600	BITUMINOUS SHOULDERS SUPERPAVE 8"	SQ YD	200	200	
67000500	ENGINEER'S FIELD OFFICE, TYPE B	CAL MO	4	4	
67100100	MOBILIZATION	L SUM	1	1	
70100460	TRAFFIC CONTROL AND PROTECTION, STANDARD 701306	L SUM	1	1	
70100600	TRAFFIC CONTROL AND PROTECTION, STANDARD 701336	L SUM	1	1	
70300100	SHORT-TERM PAVEMENT MARKING	FOOT	21838	21838	
70300210	TEMPORARY PAVEMENT MARKING - LETTERS AND SYMBOLS	SQ FT	78	78	
70300220	TEMPORARY PAVEMENT MARKING - LINE 4"	FOOT	121968	121968	
70300240	TEMPORARY PAVEMENT MARKING - LINE 6"	FOOT	400	400	
70301000	WORK ZONE PAVEMENT MARKING REMOVAL	SQ FT	1820	1820	
* 78001100	PAINT PAVEMENT MARKING - LETTERS AND SYMBOLS	SQ FT	78	78	
* 78001110	PAINT PAVEMENT MARKING - LINE 4"	FOOT	121968	121968	
* 78001130	PAINT PAVEMENT MARKING - LINE 6"	FOOT	400	400	
* 78100100	RAISED REFLECTIVE PAVEMENT MARKER	EACH	688	688	
X4066416	BITUMINOUS CONCRETE SURFACE COURSE, SUPERPAVE, MIX "C", N70	TON	16716	16716	
X4066770	LEVELING BINDER (MACHINE METHOD), SUPERPAVE N70	TON	6088	6088	
X4080020	INCIDENTAL BITUMINOUS SURFACING, SUPERPAVE, N50	TON	252	252	

*SPECIALTY ITEMS

REVISIONS	
NAME	DATE

ILLINOIS DEPARTMENT OF TRANSPORTATION

**SUMMARY
OF
QUANTITIES**

SCALE: VERT.
HORIZ.
DATE

DRAWN BY
CHECKED BY

district 3/3/2006
 c:\projects\94867\d\05503po.dgn

TYP 2

FAP ATE.	SECTION	COUNTY	TOTAL SHEETS	SHEET NO.
116	12IRS-3 122RS-4	JASPER	31	4
FED. ROAD DIST. NO. 7	ILLINOIS	FED. AID PROJECT NO.	CONTRACT NO. 94867	

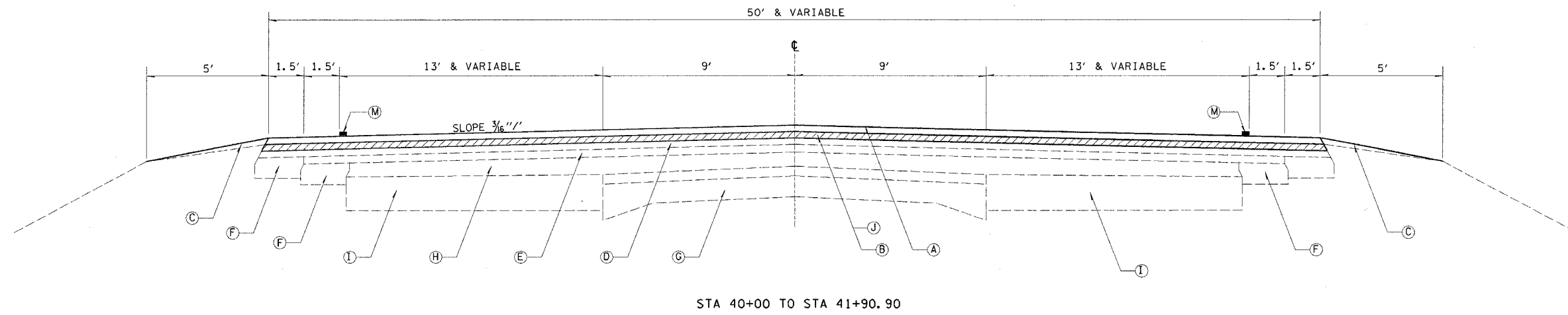

- A. BITUMINOUS CONCRETE SURFACE COURSE, MIX "C", N70 (1 1/2")
- B. LEVELING BINDER (MACHINE METHOD) SUPERPAVE, N70 (3/4")
- C. AGGREGATE SHOULDERS, TYPE B
- D. EXISTING SURFACE COURSE (VARIABLE DEPTH)
- E. EXISTING BITUMINOUS RESURFACING (3")
- F. EXISTING BITUMINOUS SHOULDERS (CONSTRUCTED IN ACCORDANCE WITH STD. 2239 EXCEPT WIDTH IS 18")
- G. EXISTING PCC PAVEMENT (9"-6"-9")
- H. EXISTING BITUMINOUS RESURFACING (5"-7")
- I. EXISTING PCC WIDENING (9")
- J. BITUMINOUS SURFACE REMOVAL (VARIABLE DEPTH)
- K. EXISTING RESURFACING
- L. EXISTING BITUMINOUS CONCRETE BASE COURSE WIDENING (9")
- M. PAINT PAVEMENT MARKING - LINE 4"

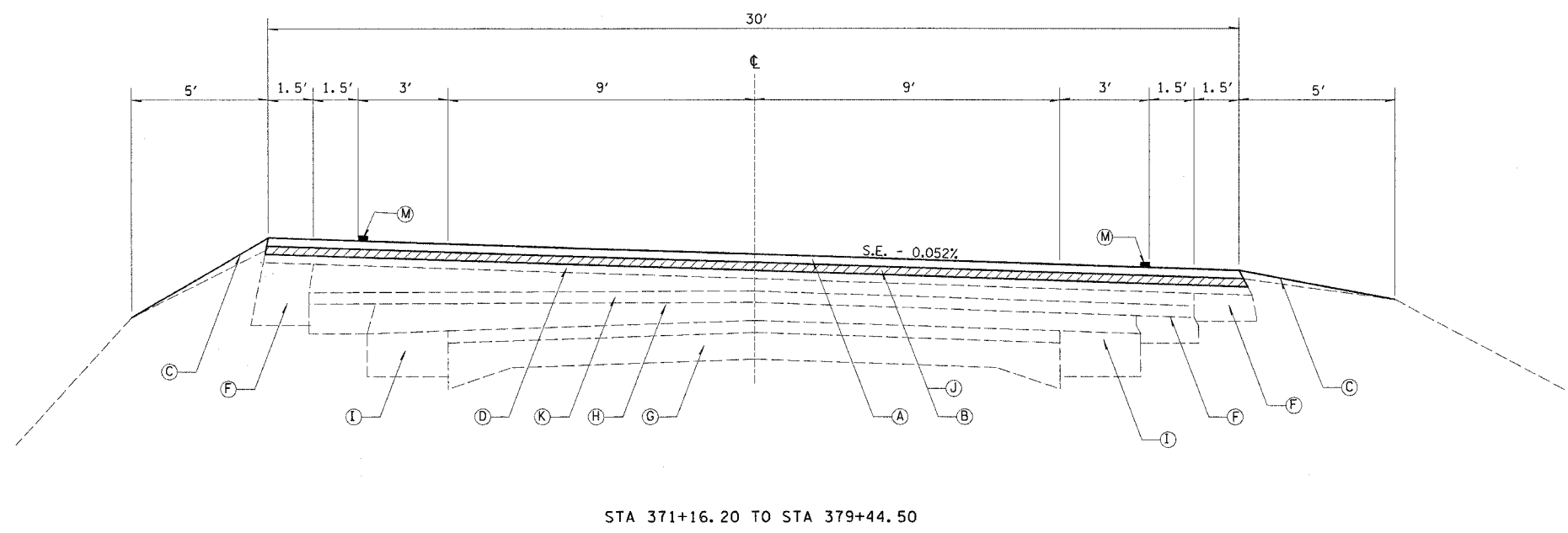

REVISIONS	
NAME	DATE

ILLINOIS DEPARTMENT OF TRANSPORTATION

TYPICAL SECTIONS

SCALE: VERT. _____
 HORIZ. _____

DATE _____ DRAWN BY _____
 CHECKED BY _____

district
3/3/2006
c:\projects\94867\d05503pa.dgn
TYP 1

FAP NO.	SECTION	COUNTY	TOTAL SHEETS	SHEET NO.
116	121RS-3 122RS-4	JASPER	31	5
FED. ROAD DIST. NO. 7		ILLINOIS	FED. AID PROJECT NO.	
CONTRACT NO. 94867				

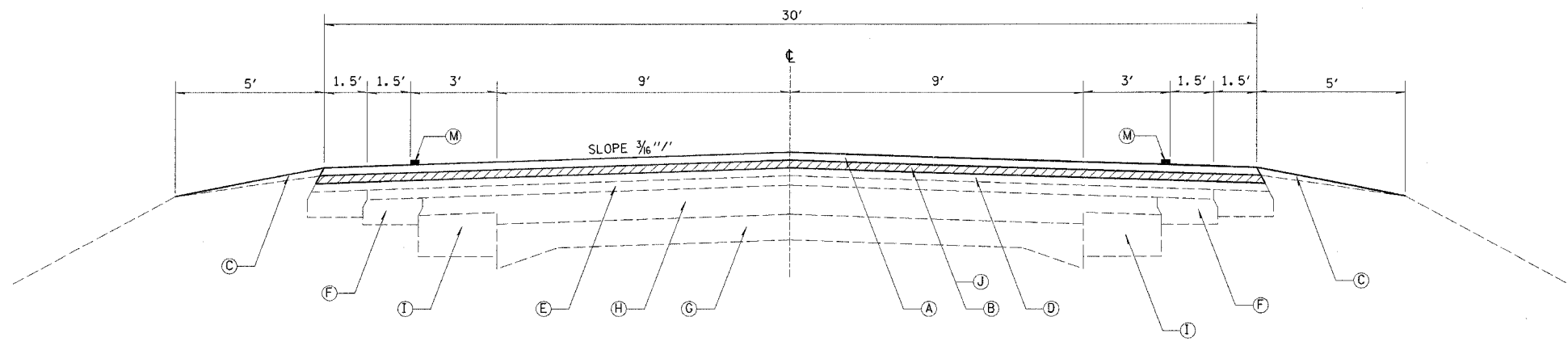

- STA 41+90.90 TO 50+35.90
- STA 50+89.10 TO 99+80.50
- STA 101+02.50 TO 132+03.20
- STA 132+08.40 TO 135+61.10
- STA 135+79.50 TO 245+33.80
- STA 245+33.60 TO 251+20.00
- STA 256+20.00 TO 293+63.80
- STA 293+72.40 TO 371+16.20
- STA 379+57.80 TO 582+94.00

- A. BITUMINOUS CONCRETE SURFACE COURSE, MIX "C", N70 (1 1/2")
- B. LEVELING BINDER (MACHINE METHOD) SUPERPAVE, N70 (3/4")
- C. AGGREGATE SHOULDERS, TYPE B
- D. EXISTING SURFACE COURSE (VARIABLE DEPTH)
- E. EXISTING BITUMINOUS RESURFACING (3")
- F. EXISTING BITUMINOUS SHOULDERS (CONSTRUCTED IN ACCORDANCE WITH STD. 2239 EXCEPT WIDTH IS 18")
- G. EXISTING PCC PAVEMENT (9"-6"-9")
- H. EXISTING BITUMINOUS RESURFACING (5"-7")
- I. EXISTING PCC WIDENING (9")
- J. BITUMINOUS SURFACE REMOVAL (VARIABLE DEPTH)
- K. EXISTING RESURFACING
- L. EXISTING BITUMINOUS CONCRETE BASE COURSE WIDENING (9")
- M. PAINT PAVEMENT MARKING - LINE 4"

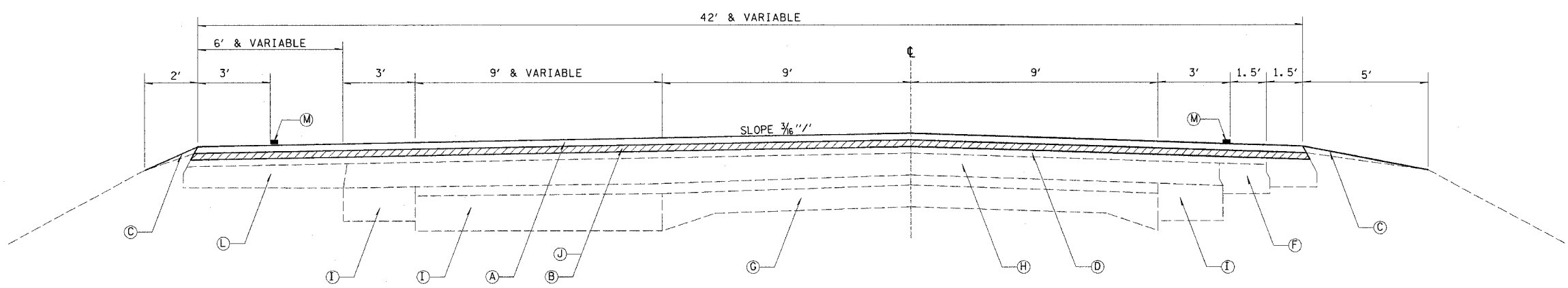

STA 251+20 TO STA 256+20

REVISIONS	
NAME	DATE

ILLINOIS DEPARTMENT OF TRANSPORTATION
TYPICAL SECTIONS
SCALE: VERT. _____
HORIZ. _____
DATE _____ DRAWN BY _____
CHECKED BY _____

c:\projects\94867\94867.dwg
 teasleyck\47_DATE_

REBS

FAP RTE.	SECTION	COUNTY	TOTAL SHEETS	SHEET NO.
116	12IRS-3 122RS-4	JASPER	31	6
FED. ROAD DIST. NO. 7		ILLINOIS	FED. AID PROJECT NO.	
CONTRACT NO. 94867				

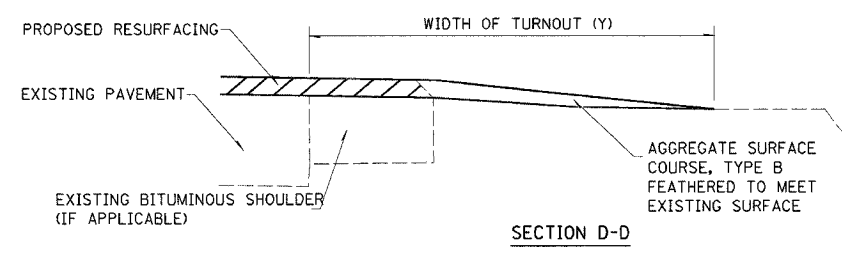
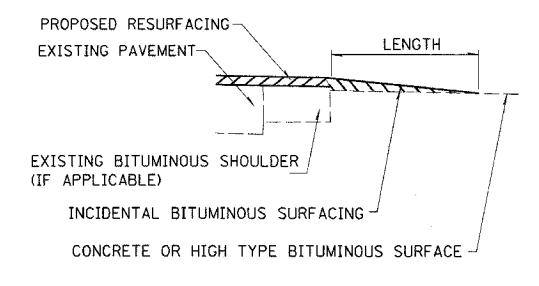
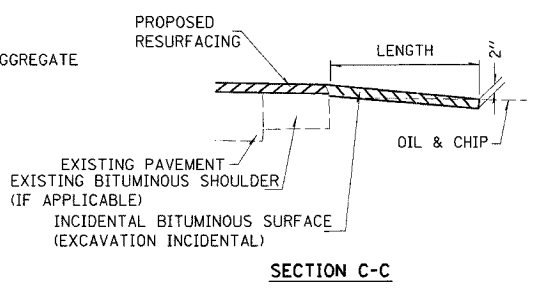
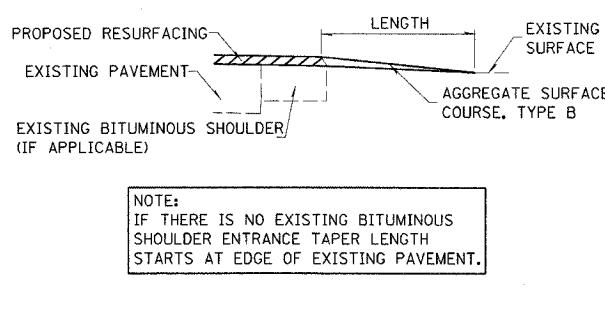
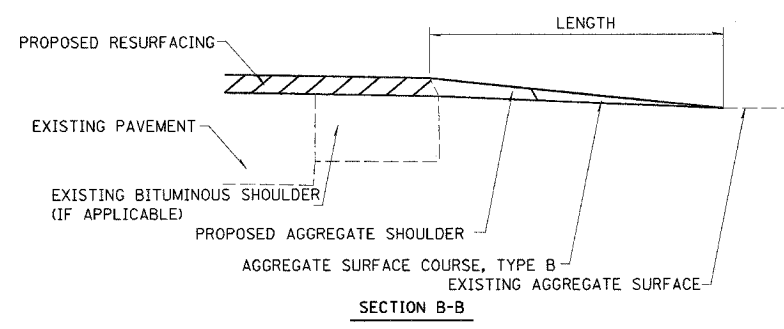
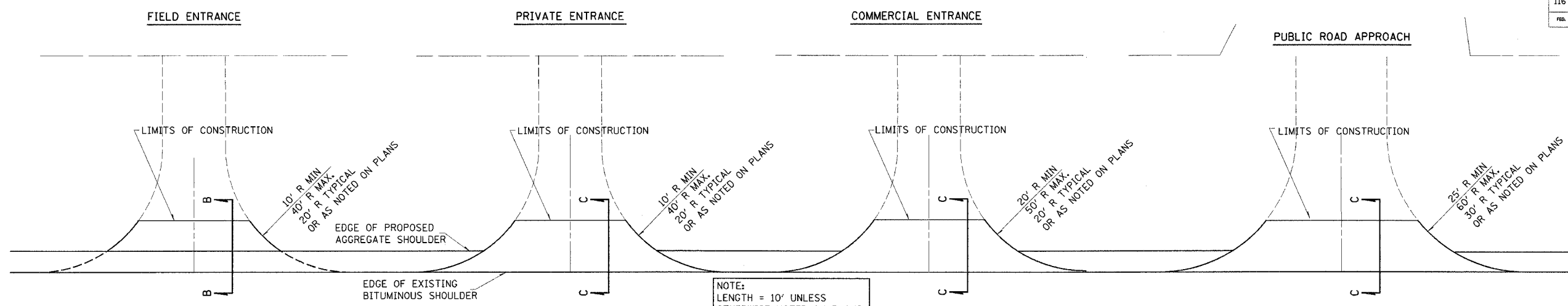

SIDE	STATION	TYPE	INCIDENTAL BITUMINOUS SURFACING*		AGGREGATE SURFACE COURSE, TYPE B
			TON	TON	
RT	40+18	PE		1.5	
RT	40+99	PE		1.6	
RT	41+65	PE		2.0	
RT	42+10	PE		1.0	
RT	43+15	CE	3.9		
RT	43+54	PE	1.8		
RT	44+67	PRA	16.1		
LT	45+24	PRA	10.5		
RT	50+90	CE	6.0		
RT	55+77	CE	3.7		
LT	56+00	PRA	5.1		
RT	57+28	PRA	5.0		
LT	57+60	FE		4.1	
RT	58+19	CE	3.1		
LT	59+06	MBT		3.2	
LT	61+00	MBT		3.2	
RT	61+27	PE	1.4		
RT	61+60	PE	2.5		
RT	62+18	PE	2.2		
RT	62+80	CE		2.8	
LT	63+10	PRA	24.8		
RT	63+35	CE	3.1		
RT	64+04	CE	3.1		
RT	64+65	CE		2.5	
RT	65+10	CE	4.2		
RT	66+12	CE	5.6		
LT	66+25	CE		3.2	
RT	67+30	CE	2.5		

SIDE	STATION	TYPE	INCIDENTAL BITUMINOUS SURFACING*		AGGREGATE SURFACE COURSE, TYPE B
			TON	TON	
LT	67+65	CE		4.3	
RT	71+00	CE	5.3		
RT	72+40	CE	2.4		
LT	75+10	CE	2.7		
LT	76+00	CE	2.6		
RT	76+55	PRA	4.1		
LT	77+27	PRA	2.9		
LT	77+90	FE		2.4	
LT	82+70	PRA	6.7		
RT	82+87	PE		3.6	
RT	83+23	MBT		3.2	
LT	84+80	PE	1.7		
LT	85+50	MBT		3.2	
LT	85+72	PE		2.3	
RT	91+30	CE	5.4		
LT	91+80	FE		1.9	
LT	94+50	CE	2.4		
RT	96+76	FE	2.3		
RT	104+55	PE		3.5	
RT	126+05	PRA	3.0		
RT	139+25	FE		6.2	
RT	139+25	PRA	6.1		
RT	161+25	PE		2.8	
LT	161+25	FE		1.5	
LT	161+45	MBT		3.2	
RT	171+60	PRA	2.7		
LT	172+02	PRA	4.2		
RT	193+60	FE		2.6	

SIDE	STATION	TYPE	INCIDENTAL BITUMINOUS SURFACING*		AGGREGATE SURFACE COURSE, TYPE B
			TON	TON	
RT	199+54	CE	6.5		
LT	202+59	FE		2.8	
RT	203+07	PE		2.6	
RT	212+10	FE		3.3	
RT	218+30	FE		2.2	
RT	234+50	FE		3.2	
LT	237+50	PRA	4.7		
RT	238+30	FE		2.3	
RT	249+86	PRA	4.1		
LT	249+86	PRA	9.8		
RT	252+90	PE		2.0	
LT	255+00	FE		4.0	
LT	260+15	FE		2.4	
RT	261+24	PE	3.2		
LT	262+13	FE		2.7	
RT	262+35	PE		3.0	
LT	267+70	FE		2.3	
RT	268+82	PE		2.0	
RT	275+08	PE	2.7		
LT	275+08	PRA	2.8		
RT	282+85	PE		3.2	
RT	300+60	PE	2.3		
RT	308+40	PRA	4.8		
LT	308+61	PRA	4.7		
RT	310+32	PRA	4.8		
RT	323+65	FE		2.4	
LT	323+65	FE		2.2	
LT	338+50	FE		2.5	

SIDE	STATION	TYPE	INCIDENTAL BITUMINOUS SURFACING*		AGGREGATE SURFACE COURSE, TYPE B
			TON	TON	
RT	346+22	FE		2.7	
RT	360+35	FE		2.5	
RT	366+46	PRA	3.0		
LT	366+68	PRA	4.5		
LT	380+70	CE		3.6	
LT	387+35	FE		2.2	
RT	395+30	FE		2.8	
LT	400+00	FE		2.0	
RT	403+75	PRA		4.8	
LT	406+35	FE		1.9	
LT	414+22	FE		2.3	
RT	418+45	CE	7.2		
RT	422+46	PRA	6.9		
LT	422+46	PRA	2.8		
LT	432+93	FE		2.1	
RT	433+10	FE		2.3	
RT	435+75	FE		2.4	
LT	439+30	PE	3.4		
RT	440+31	MBT		3.2	
LT	440+60	PE		2.6	
LT	449+05	FE		1.9	
RT	452+50	FE		2.2	
RT	462+18	FE		2.2	
LT	462+18	FE		2.3	
LT	468+35	PE		2.3	
RT	470+86	PE		1.7	
LT	471+10	MBT		3.2	
RT	471+30	PE		1.1	

SIDE	STATION	TYPE	INCIDENTAL BITUMINOUS SURFACING*		AGGREGATE SURFACE COURSE, TYPE B
			TON	TON	
RT	475+50	PRA	2.7		
LT	475+50	PRA	2.4		
LT	482+35	FE		2.4	
RT	488+45	MBT		3.2	
RT	488+75	PE	1.7		
RT	495+75	FE		2.6	
LT	495+75	FE		2.4	
RT	500+50	PE		2.4	
RT	500+68	MBT		3.2	
RT	502+15	PE		2.2	
RT	502+50	PE		2.1	
LT	502+50	FE		3.3	
RT	502+68	MBT		3.2	
RT	507+30	MBT		3.2	
RT	507+45	PE		1.7	
RT	514+40	FE		2.4	
RT	515+78	FE		2.0	
LT	515+78	PE	4.7		
RT	515+93	MBT		3.2	
RT	517+10	FE		2.4	
LT	518+60	PE		3.6	
RT	527+53	PE		2.4	
RT	527+78	MBT		3.2	
RT	529+22	PRA	3.9		
LT	529+22	PRA	3.4		
RT	540+40	FE		2.4	
LT	543+60	FE		2.3	
RT	544+30	PE		2.3	

SIDE	STATION	TYPE	INCIDENTAL BITUMINOUS SURFACING*		AGGREGATE SURFACE COURSE, TYPE B
			TON	TON	
RT	544+50	MBT		3.2	
RT	556+37	FE		2.6	
LT	556+55	PRA	2.4		
RT	569+90	PRA	3.7		
LT	569+90	PRA	8.0		
LT	570+77	FE		3.2	
RT	574+94	FE		2.3	
	TOTALS		252.0	253.0	

FE - FIELD ENTRANCE PRA - PUBLIC ROAD APPROACH
 PE - PRIVATE ENTRANCE MBT - MAILBOX TURNOUT
 CE - COMMERCIAL ENTRANCE

*BITUMINOUS MATERIALS AND AGGREGATE (PRIME COAT) FOR ENTRANCES AND PUBLIC ROAD APPROACHES SHALL BE CONSIDERED INCIDENTAL TO INCIDENTAL BITUMINOUS SURFACING AS NOTED IN THE SPECIAL PROVISIONS

ISSUED: 08-03-99

district
 teasleyck+*.DATE.
 c:\projects\94867d\05503pa.dgn
 SCH

RESURFACING SCHEDULE

STATION TO STATION	LENGTH	EXISTING PAVEMENT WIDTH	AREA	BITUMINOUS MATERIALS (PRIME COAT)	AGGREGATE (PRIME COAT)	BITUMINOUS SURFACE COURSE, SUPERPAVE, MIX "C", N70, 1/2"	LEVEL BINDER, MACHINE METHOD SUPERPAVE, N70, 3/4"	BITUMINOUS SURFACE REMOVAL - BUTT JOINT	BITUMINOUS SURFACE REMOVAL, 2 1/4	AGGREGATE SHOULDERS, TYPE B	TEMPORARY RAMP
40+00.00 TO 40+30.00	30.00	50	167	17	0	15	6	167		4	24
40+30.00 TO 41+90.90	160.90	30	536	54	1	50	18		536	22	
41+90.90 TO 50+35.90	845.00	30	2817	282	5	260	95		2817	114	
50+35.90 = 50+89.10											
50+89.10 TO 99+29.77	4840.67	30	16136	1614	26	1493	542		16136	651	13
99+29.77 TO 99+59.77	30.00	30	100	10	0	7	3	80	100	4	
99+59.77 TO 99+79.77	20.00	30	67	7	0	6	2		13	3	
99+79.77 TO 101+03.23	123.46	30	BRIDGE OMISSION		1						
101+03.23 TO 101+23.23	20.00	30	67	7	0	6	2		13	3	
101+23.23 TO 101+53.23	30.00	30	100	10	0	7	3	80	100	4	13
101+53.23 TO 132+03.20	3049.97	30	10167	1017	16	941	342		10167	410	
132+03.20 = 132+08.40											
132+08.40 TO 135+61.10	352.70	30	1176	118	2	109	40		1176	47	
135+61.10 = 135+79.50											
135+79.50 TO 245+33.80	10954.30	30	36514	3651	58	3374	1227		36514	1473	
245+33.80 = 245+33.60											
245+33.60 TO 251+20.00	586.40	30	1955	196	3	181	66		1955	79	
251+20.00 TO 256+20.00	500.00	42	2333	233	4	210	84		2333	47	
256+20.00 TO 293+63.80	3743.80	30	12479	1248	20	1153	419		12479	503	
293+63.80 = 293+72.40											
293+72.40 TO 371+16.20	7743.80	30	25813	2581	41	2385	867		25813	1041	
371+16.20 TO 379+44.50	828.30	30	2761	276	4	255	93		2761	111	
379+44.50 = 379+57.80											
379+57.80 TO 582+64.00	20306.20	30	67687	6769	108	6254	2274		67687	2730	
582+64.00 TO 582+94.00	30.00	30	100	10	0	9	3	100		4	13
PROJECT TOTALS	54195.50		180973	18098	291	16716	6088	427	180600	7251	64

FAP RFL	SECTION	COUNTY	TOTAL SHEETS	SHEET NO.
116	121RS-3 122RS-4	JASPER	31	7
FED. ROAD DIST. NO. 1	ILLINOIS	FED. AID PROJECT NO.	CONTRACT NO. 94867	

PAVEMENT MARKING SCHEDULE

STATION TO STATION	LENGTH	SHORT TERM PAVEMENT MARKING	WORK ZONE PAVEMENT MARKING REMOVAL	PAINT PAVEMENT MARKING - LINE 4"	RAISED REFLECTIVE PAVEMENT MARKER	TEMPORARY PAINT PAVEMENT MARKING LINE 4"	PAINT PAVEMENT MARKING - LINE 6"	TEMPORARY PAINT PAVEMENT MARKING LINE 6"	TEMPORARY PAVEMENT MARKING - LETTERS & SYMBOLS	PAINT PAVEMENT MARKING - LETTERS & SYMBOLS
40+00.00 TO 40+30.00	30.0	12	1	68	0	68				
40+30.00 TO 41+90.90	160.9	64	5	362	2	362				
41+90.90 TO 50+35.90	845.0	338	28	1551	11	1551				
50+35.90 = 50+89.10										
50+89.10 TO 99+24.77	4835.7	1934	161	10215	60	10215				
99+24.77 TO 99+59.77	35.0	14	1	79	0	79				
99+59.77 TO 99+79.77	20.0	8	1	45	0	45				
99+79.77 TO 101+03.23	123.5	49	4	278	2	278				
101+03.23 TO 101+23.23	20.0	8	1	45	0	45				
101+23.23 TO 101+58.23	35.0	14	1	79	0	79				
101+58.23 TO 132+03.20	3045.0	1218	102	7863	38	7863				
132+03.20 = 132+08.40										
132+08.40 TO 135+61.10	352.7	141	12	794	4	794				
135+61.10 = 135+79.50										
135+79.50 TO 245+33.80	10954.3	4382	365	25451	137	25451				
245+33.80 = 245+33.60										
245+33.60 TO 251+20.00	586.4	288	24	1132	11	1132	134	134		
251+20.00 TO 256+20.00	500.0	306	26	1480	13	1480	266	266	78	78
256+20.00 TO 293+63.80	3743.8	1498	125	8383	47	8383				
293+63.80 = 293+72.40										
293+72.40 TO 371+16.20	7743.8	3098	258	17114	97	17114				
371+16.20 TO 379+44.50	828.3	331	28	1864	10	1864				
379+44.50 = 379+57.80										
379+57.80 TO 582+64.00	20306.2	8123	677	45099	254	45099				
582+64.00 TO 582+94.00	30.0	12	1	68	0	68				
PROJECT TOTALS	54195.5	21838	1820	121968	688	121968	400	400	78	78

REVISIONS	
NAME	DATE

ILLINOIS DEPARTMENT OF TRANSPORTATION
RESURFACING & PAVEMENT MARKING SCHEDULES
 SCALE: VERT. DATE
 HORIZ. DATE
 DRAWN BY
 CHECKED BY

district
teesleyck+-DATE_
c:\projects\94867\d05503pa.dgn
BTJNT

FAP RTE.	SECTION	COUNTY	TOTAL SHEETS	SHEET NO.
116	12IRS-3 122RS-4	JASPER	31	8
FED. ROAD DIST. NO. 7		ILLINOIS	FED. AID PROJECT NO.	
CONTRACT NO. 94867				

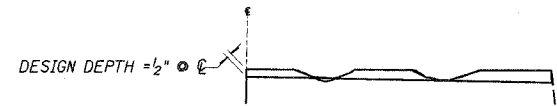
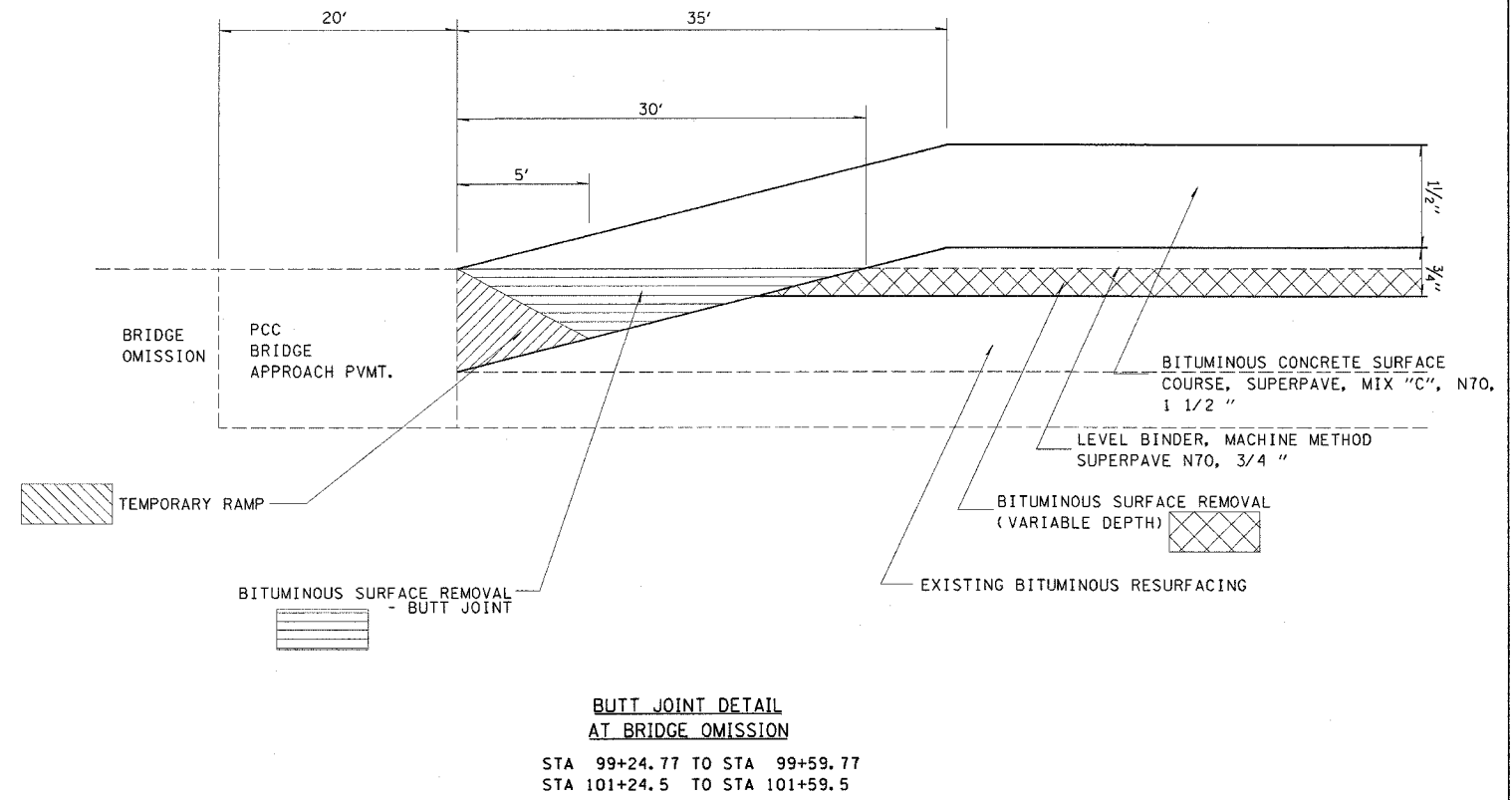
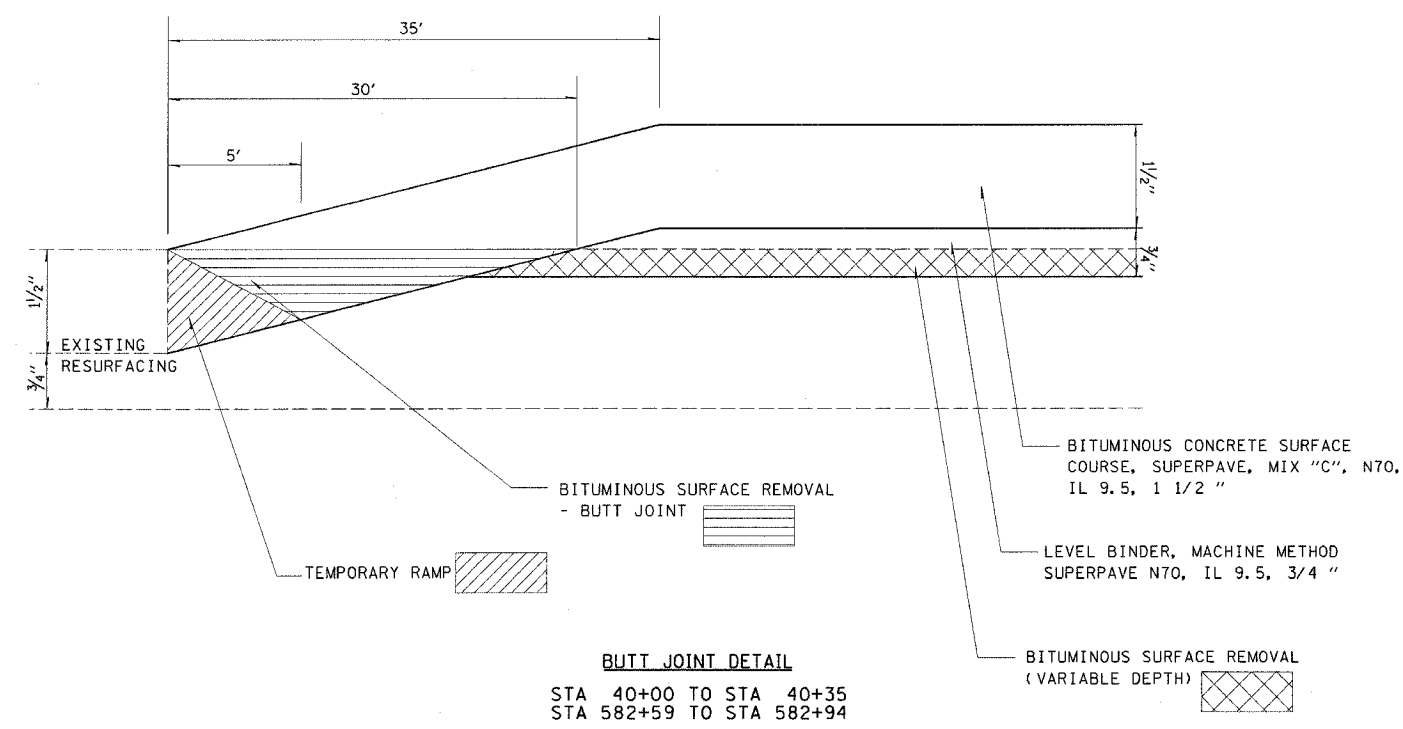

NOTES:

- MILLING SHALL BE DONE TO ATTAIN A 3/16" SLOPE IN CROWN SECTIONS
- EXISTING S.E. AND S.E. TRANSITIONS SHALL BE MAINTAINED UNLESS OTHERWISE SHOWN ON THE PLANS.
- MILLING TO THE BOTTOM OF WHEEL RUTS SHALL NOT BE NECESSARY UNLESS REQUIRED TO OBTAIN SLOPE OR THE DESIGN DEPTH AT CENTERLINE.
- THE AVERAGE DEPTH OF MILLING IS ESTIMATED TO BE 1/2" BUT MAY VARY IN ISOLATED LOCATIONS.

BITUMINOUS SURFACE REMOVAL (VARIABLE DEPTH) DETAIL

REVISIONS	
NAME	DATE

ILLINOIS DEPARTMENT OF TRANSPORTATION

BUTT JOINT DETAIL AND BITUMINOUS FEATHER DETAIL

SCALE: VERT. _____
HORIZ. _____

DATE _____ DRAWN BY _____
CHECKED BY _____

district
3/3/2006
c:\projects\94867\d05503pa.dgn

FAP RTE.	SECTION	COUNTY	TOTAL SHEETS	SHEET NO.
116	121RS-3 122RS-4	JASPER	31	10
FED. ROAD DIST. NO. 7	ILLINOIS	FED. AID PROJECT NO.		

CONTRACT NO. 94867

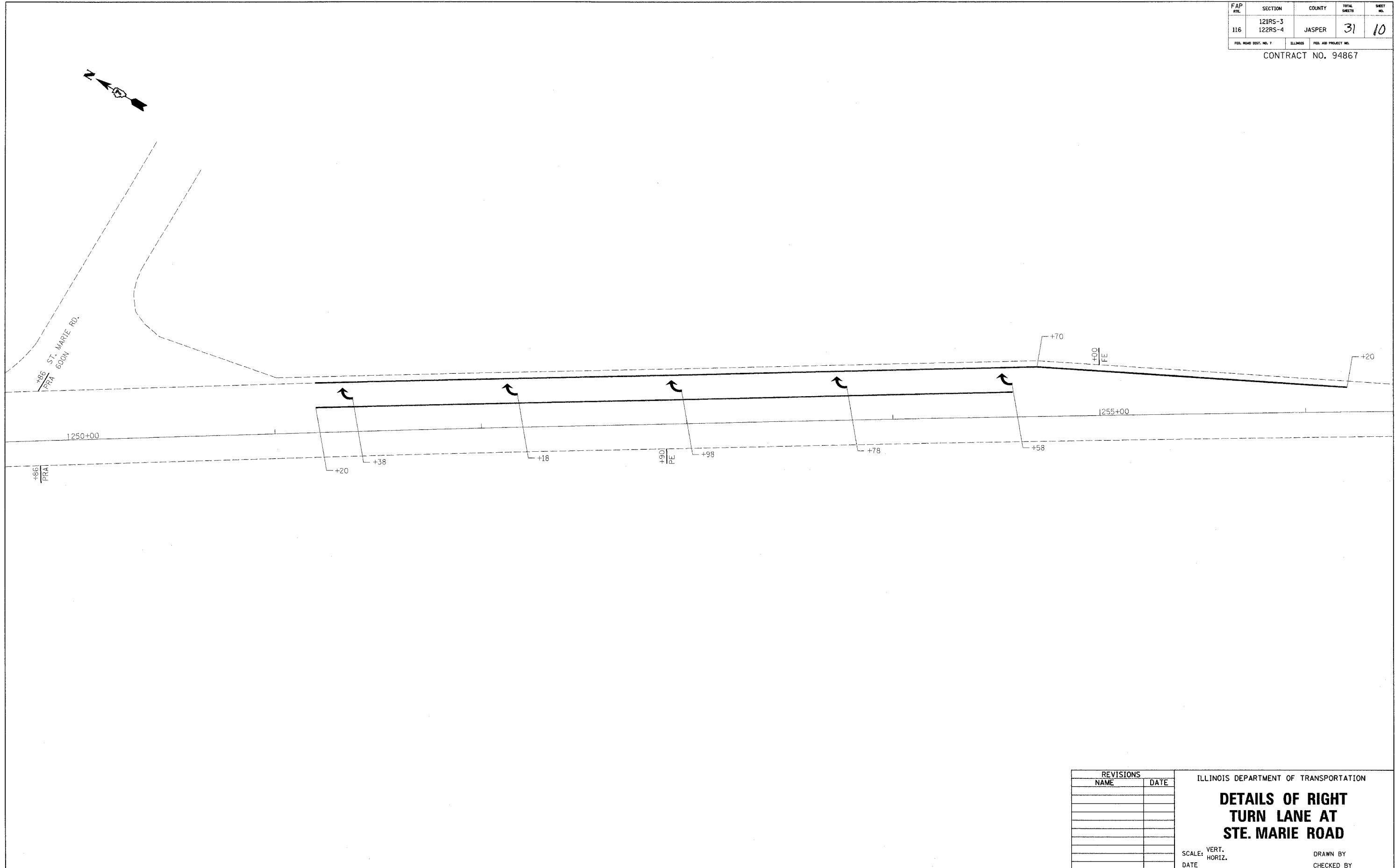

REVISIONS	
NAME	DATE

ILLINOIS DEPARTMENT OF TRANSPORTATION

**DETAILS OF RIGHT
TURN LANE AT
STE. MARIE ROAD**

SCALE: VERT.
HORIZ.

DATE

DRAWN BY
CHECKED BY

3/3/2006
 c:\projects\894867\894867.dwg
 MMO REV: 05-06-96
 EPMD

FAP RTE.	SECTION	COUNTY	TOTAL SHEETS	SHEET NO.
116	12IRS-3 122RS-4	JASPER	31	//
FED. ROAD DIST. NO. 7	ILLINOIS	FED. AID PROJECT NO.	CONTRACT NO. 94867	

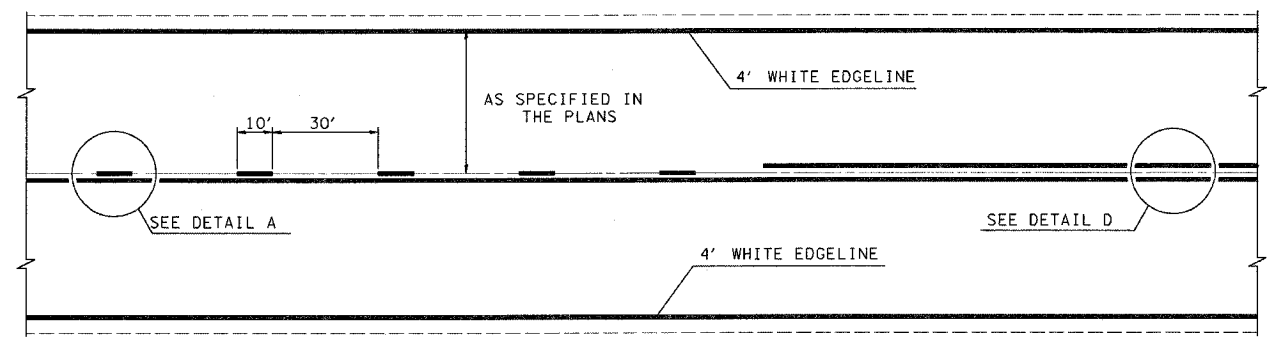

TYPICAL CENTERLINE, NO PASSING ZONE LINE (NPZ) & EDGELINE MARKINGS
 2-LANE PAVEMENT

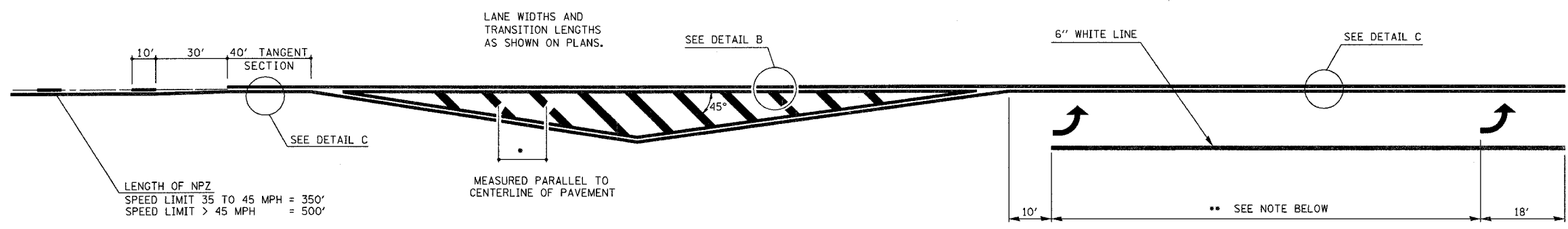

LENGTH OF NPZ
 SPEED LIMIT 35 TO 45 MPH = 350'
 SPEED LIMIT > 45 MPH = 500'

•DIAGONAL SPACING

SPEED LIMIT	< 30 MPH	= 15'
SPEED LIMIT	30 TO 45 MPH	= 20'
SPEED LIMIT	> 45 MPH	= 30'

** PLACE THE FIRST ARROW EVEN WITH THE BEGINNING OF THE TURN BAY.
 PLACE ANOTHER ARROW 18' BACK FROM THE STOP BAR, IF REQUIRED.
 ADD ADDITIONAL ARROWS TO MAINTAIN A MAXIMUM OF 80' SPACING.

- NOTES:
1. OMIT EDGELINE THRU SIDE ROADS.
 2. TAPER RATES, LANE WIDTHS, AND STORAGE LENGTHS AS SHOWN ON THE PLANS.
 3. WHEN MEDIANS ARE PRESENT, PLACE A SINGLE YELLOW STRIPE AROUND ITS PERIMETER.

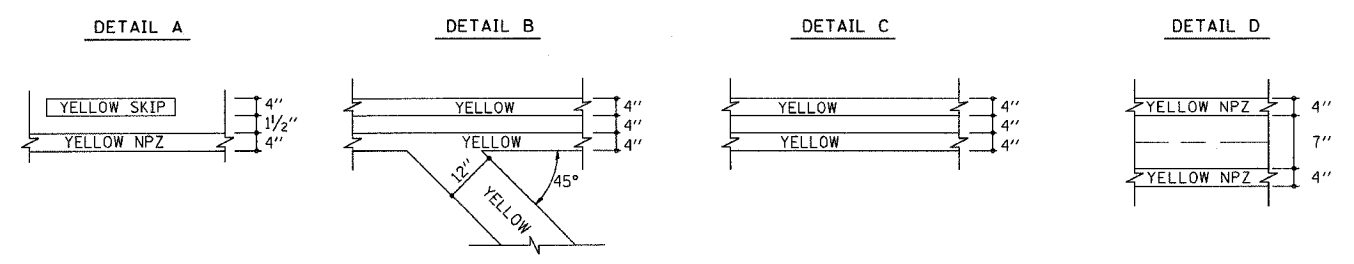

NOT TO SCALE

REVISIONS	
NAME	DATE
MMO	12-99
DRM	08-04

ILLINOIS DEPARTMENT OF TRANSPORTATION
TYPICAL APPLICATION OF PAVEMENT MARKINGS
 1 OF 2
 SCALE: VERT. _____
 DATE _____ HORIZ. _____
 ISSUED: 05-06-96
 DRAWN BY _____
 CHECKED BY _____

c:\projects\894867\894867.dwg
 teasleyck\+ DATE

3/3/2006
 c:\projects\94867\94867.dwg
 MM0 REV: 05-06-96
 EPMD1

FAP RTE.	SECTION	COUNTY	TOTAL SHEETS	SHEET NO.
116	121RS-3 122RS-4	JASPER	31	12
FED. ROAD DIST. NO. 7		ILLINOIS	FED. AID PROJECT NO.	
CONTRACT NO. 94867				

** PLACE THE FIRST ARROW EVEN WITH THE BEGINNING OF THE TURN BAY.
 PLACE ANOTHER ARROW 18' BACK FROM THE STOP BAR, IF REQUIRED.
 ADD ADDITIONAL ARROWS TO MAINTAIN A MAXIMUM OF 80' SPACING.

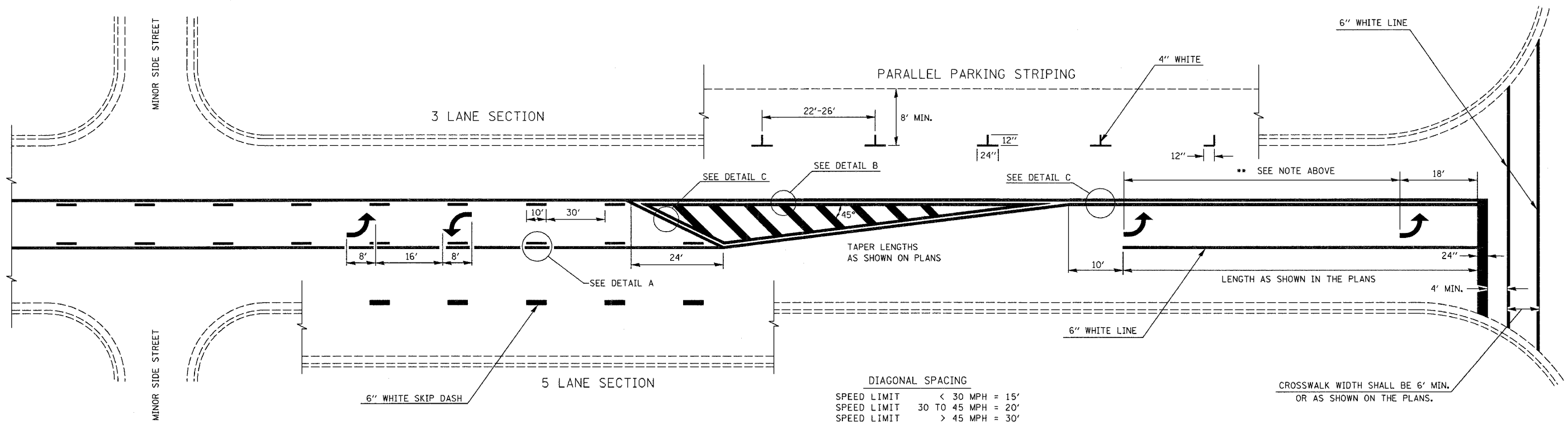

DIAGONAL SPACING

SPEED LIMIT	< 30 MPH	= 15'
SPEED LIMIT	30 TO 45 MPH	= 20'
SPEED LIMIT	> 45 MPH	= 30'

CROSSWALK WIDTH SHALL BE 6' MIN.
 OR AS SHOWN ON THE PLANS.

TYPICAL BI-DIRECTIONAL TURN LANE MARKINGS
 (SHOWING TRANSITION TO EXCLUSIVE LEFT TURN LANE)

- NOTES:
1. NO LESS THAN 2 ARROWS SHALL BE USED.
 2. TAPER RATES, LANE WIDTHS, AND STORAGE LENGTHS AS SHOWN ON THE PLANS.
 3. AVOID PLACING BI-DIRECTIONAL ARROWS IN INTERSECTIONS.
 4. BI-DIRECTIONAL ARROWS SHALL BE SPACED A MAXIMUM OF 250'.

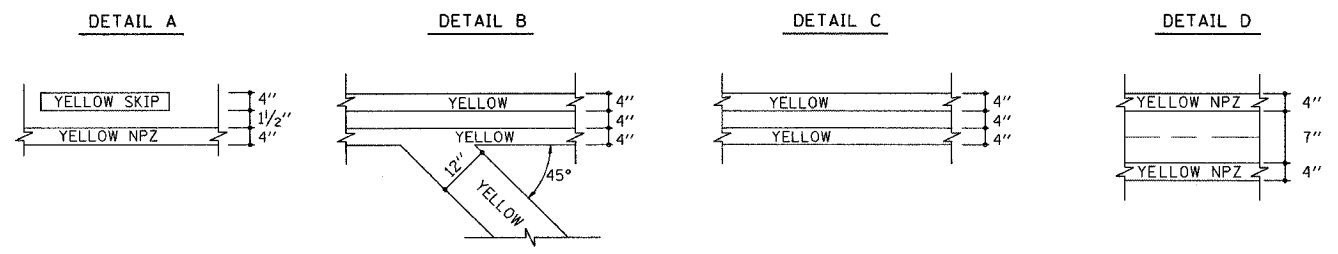

NOT TO SCALE

REVISIONS	
NAME	DATE
MMO	12-99
DRM	08-04

ILLINOIS DEPARTMENT OF TRANSPORTATION
**TYPICAL APPLICATION OF
 PAVEMENT MARKINGS**
SHEET 2 OF 2

SCALE: VERT. _____
 HORIZ. _____
 DATE _____

DRAWN BY _____
 CHECKED BY _____

c:\projects\94867\94867.dwg
 Tedsleyck 4-11-04

district
3/3/2006
c:\projects\94867\d05503pe.dgn

PS 1

FAP RTE.	SECTION	COUNTY	TOTAL SHEETS	SHEET NO.
116	121RS-3 122RS-4	JASPER	31	13
FED. ROAD DIST. NO. 7		ILLINOIS	FED. AID PROJECT NO.	

CONTRACT NO. 94867



PROJECT BEGINS
STATION 40+00

BUTT JOINT
STA. 40+00 TO STA. 40+35
SEE SHEET 8 FOR DETAILS

EXIST. CURVE CURVE4
PI STA. = 46+40.00
 Δ = 47° 53' 00" (LT.)
D = 5° 39' 52"
R = 1,011.50'
T = 449.12'
L = 845.33'
E = 95.22'
e = -----
T.R. = -----
S.E. RUN = -----
P.C. STA. = 41+90.88
P.T. STA. = 50+36.22

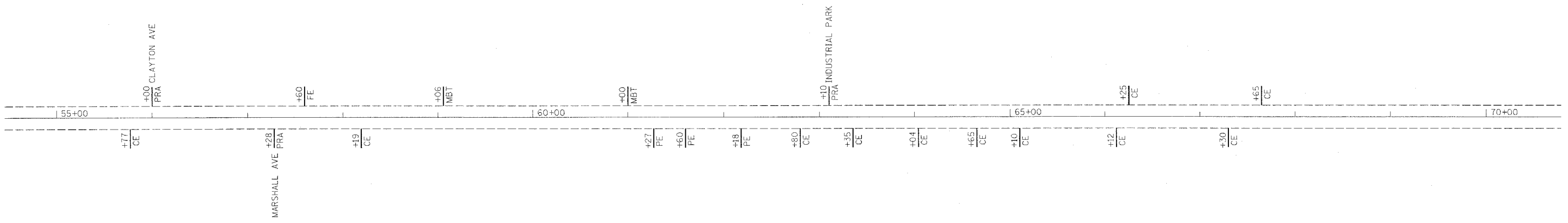
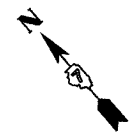
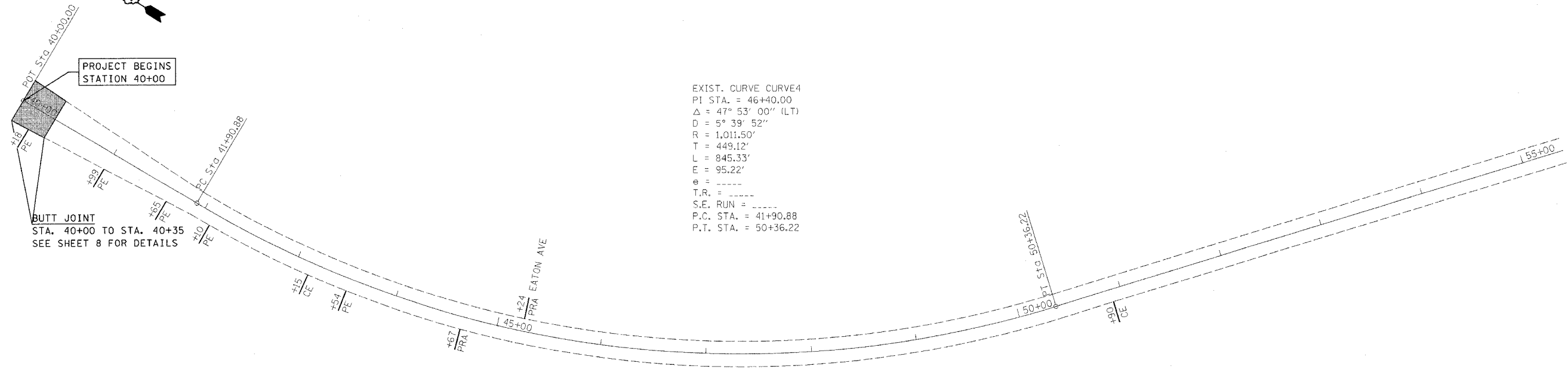

REVISIONS	
NAME	DATE

ILLINOIS DEPARTMENT OF TRANSPORTATION

**STA. 40+00
TO
STA. 70+00**

SCALE: VERT.
HORIZ.
DATE

DRAWN BY
CHECKED BY

district
3/3/2006
c:\projects\94867\d\05503pa.dgn
PS 2

FAP RFL	SECTION	COUNTY	TOTAL SHEETS	SHEET NO.
116	121RS-3 122RS-4	JASPER	31	14

CONTRACT NO. 94867

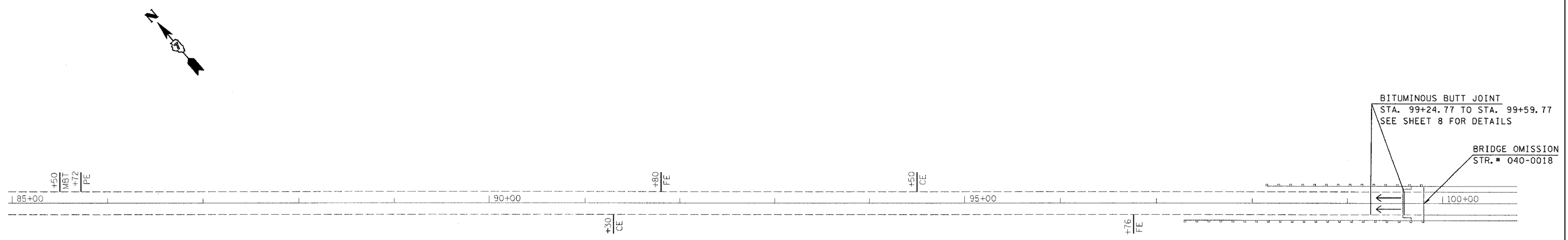
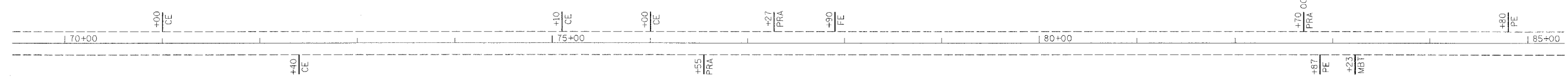

REVISIONS	
NAME	DATE

ILLINOIS DEPARTMENT OF TRANSPORTATION
**STA. 70 + 00
TO
STA. 100 + 00**
SCALE: VERT. _____
HORIZ. _____
DATE _____ DRAWN BY _____
CHECKED BY _____

district
3/3/2006
c:\projects\94867\05503pa.dgn
PS

FAP ATE.	SECTION	COUNTY	TOTAL SHEETS	SHEET NO.
116	121RS-3 122RS-4	JASPER	31	15
FED. ROAD DIST. NO. 7		ALIGNMENT	FED. AID PROJECT NO.	

CONTRACT NO. 94867

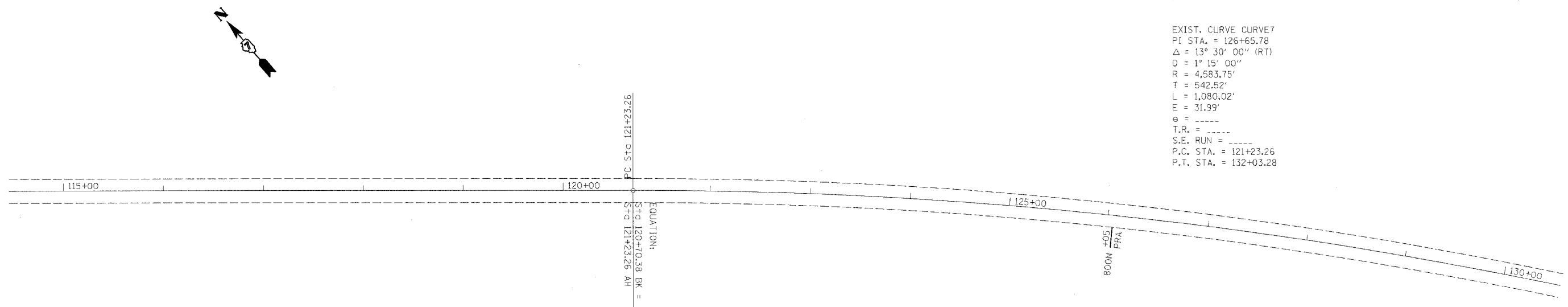

EXIST. CURVE CURVE7
 PI STA. = 126+65.78
 $\Delta = 13^\circ 30' 00''$ (RT)
 $D = 1^\circ 15' 00''$
 $R = 4,583.75'$
 $T = 542.52'$
 $L = 1,080.02'$
 $E = 31.99'$
 $e = \text{-----}$
 $T.R. = \text{-----}$
 $S.E. RUN = \text{-----}$
 $P.C. STA. = 121+23.26$
 $P.T. STA. = 132+03.28$

EQUATION:
 $HW \ 92^{\circ}C^2 + 121 \ D +$
 $Sta. 120+70.38 \ BK =$
 $Sta. 121+23.26 \ AH =$

REVISIONS	
NAME	DATE

ILLINOIS DEPARTMENT OF TRANSPORTATION
**STA. 100 + 00
 TO
 STA. 130 + 00**
 SCALE: VERT. _____
 HORIZ. _____
 DATE _____
 DRAWN BY _____
 CHECKED BY _____

district
3/3/2006
c:\projects\94867\d\05503pe.dgn
PS 4

FAP RTE.	SECTION	COUNTY	TOTAL SHEETS	SHEET NO.
116	121RS-3 122RS-4	JASPER	31	16
FED. ROAD DIST. NO. 7		ILLINOIS	FED. AID PROJECT NO.	

CONTRACT NO. 94867

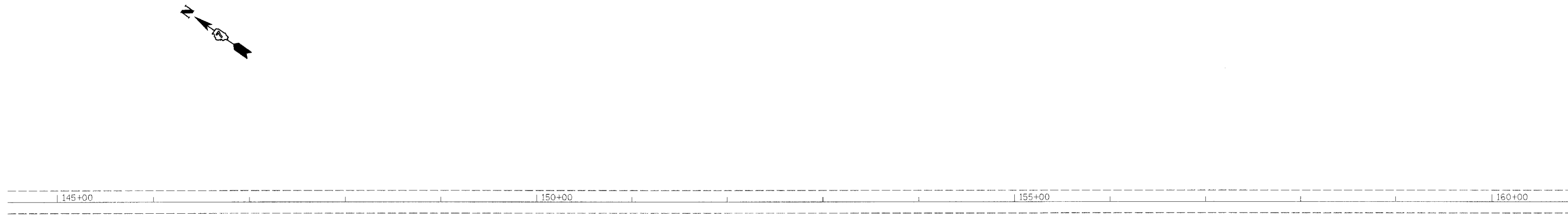
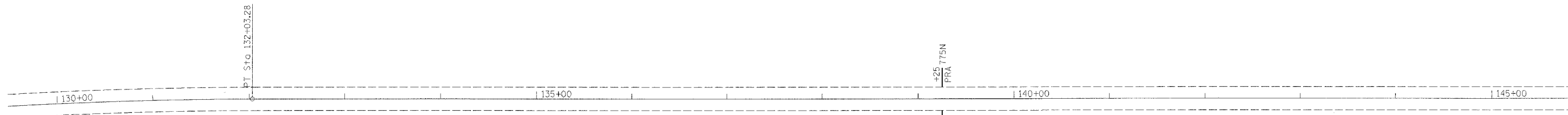

REVISIONS	
NAME	DATE

ILLINOIS DEPARTMENT OF TRANSPORTATION

**STA. 130 + 00
TO
STA. 160 + 00**

SCALE: VERT.
HORIZ.

DATE

DRAWN BY
CHECKED BY

district
3/3/2006
c:\projects\94867\d05503pa.dgn
PS 5

FAP R/L	SECTION	COUNTY	TOTAL SHEETS	SHEET NO.
116	121RS-3 122RS-4	JASPER	31	17
FED. ROAD DIST. NO. 7		ILLINOIS	FED. AID PROJECT NO.	

CONTRACT NO. 94867



REVISIONS	
NAME	DATE

ILLINOIS DEPARTMENT OF TRANSPORTATION

**STA. 160 + 00
TO
STA. 190 + 00**

SCALE: VERT.
DATE

DRAWN BY
CHECKED BY

district
 3/3/2006
 c:\projects\94867\d\05503pa.dgn
 PS 6

FAP RTE.	SECTION	COUNTY	TOTAL SHEETS	SHEET NO.
116	121RS-3 122RS-4	JASPER	31	18
FED. ROAD DIST. NO. 7		ILLINOIS	FED. AID PROJECT NO.	

CONTRACT NO. 94867

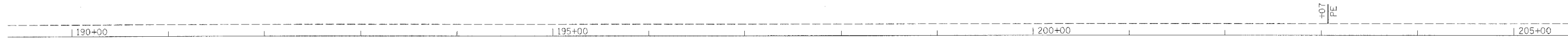

+60
FE

+54
CE

+59
FE

+07
PE

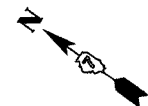

+10
FE

+30
FE

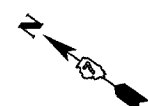

REVISIONS	
NAME	DATE

ILLINOIS DEPARTMENT OF TRANSPORTATION

**STA. 190 + 00
 TO
 STA. 220 + 00**

SCALE: VERT.
 HORIZ.
 DATE

DRAWN BY
 CHECKED BY

district
3/3/2006
c:\projects\94867\d\05503pa.dgn
PS 7

FAP RFL.	SECTION	COUNTY	TOTAL SHEETS	SHEET NO.
116	121RS-3 122RS-4	JASPER	31	19
FED. ROAD DIST. NO. 7		ILLINOIS	FED. AID PROJECT NO.	

CONTRACT NO. 94867

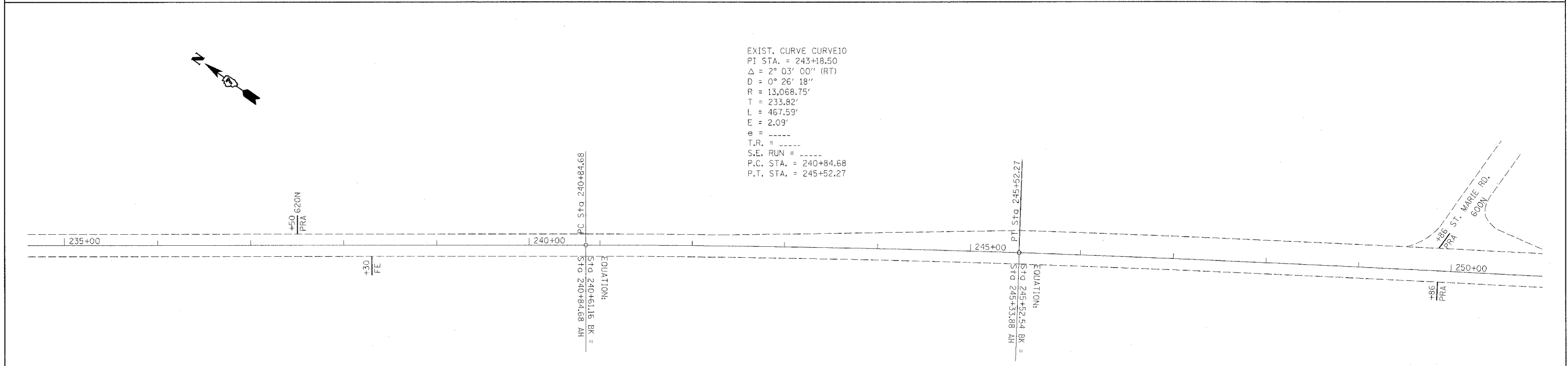
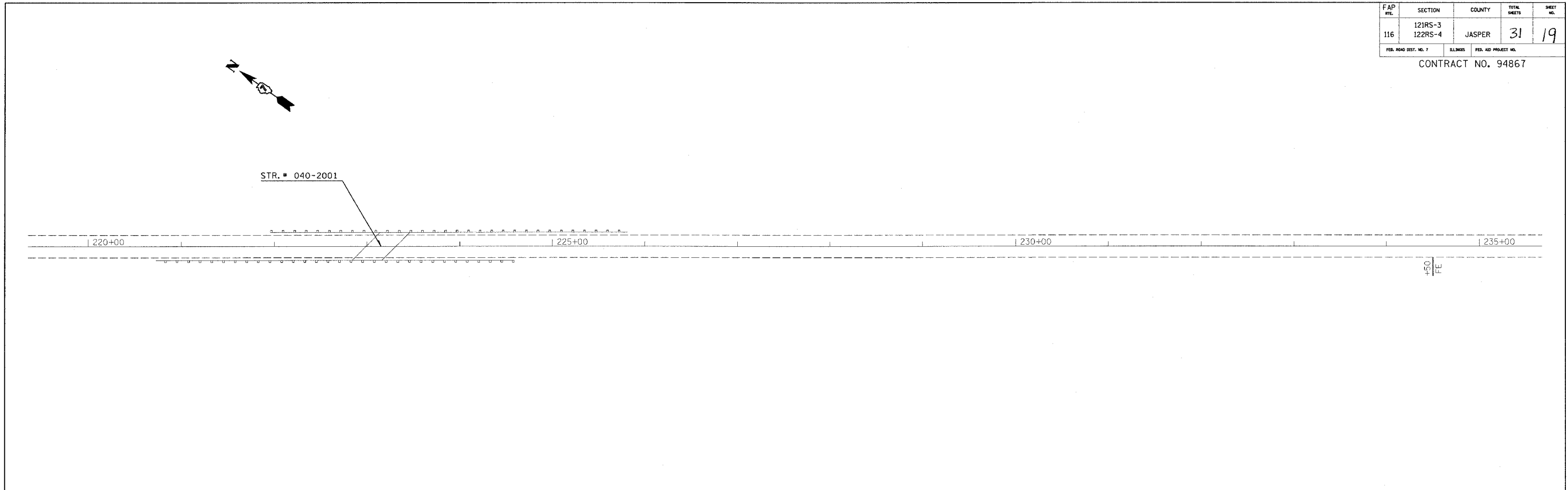

EXIST. CURVE CURVE10
 PI STA. = 243+18.50
 Δ = 2° 03' 00'' (RT)
 D = 0° 26' 18''
 R = 13,068.75'
 T = 233.82'
 L = 467.59'
 E = 2.09'
 e = -----
 T.R. = -----
 S.E. RUN = -----
 P.C. STA. = 240+84.68
 P.T. STA. = 245+52.27

REVISIONS	
NAME	DATE

ILLINOIS DEPARTMENT OF TRANSPORTATION

**STA. 220 + 00
TO
STA. 250 + 00**

SCALE: VERT.
HORIZ.
DATE

DRAWN BY
CHECKED BY

district
3/3/2006
c:\projects\94867\d05503pe.dgn
PS 8

FAP No.	SECTION	COUNTY	TOTAL SHEETS	SHEET NO.
116	121RS-3 122RS-4	JASPER	31	20

CONTRACT NO. 94867

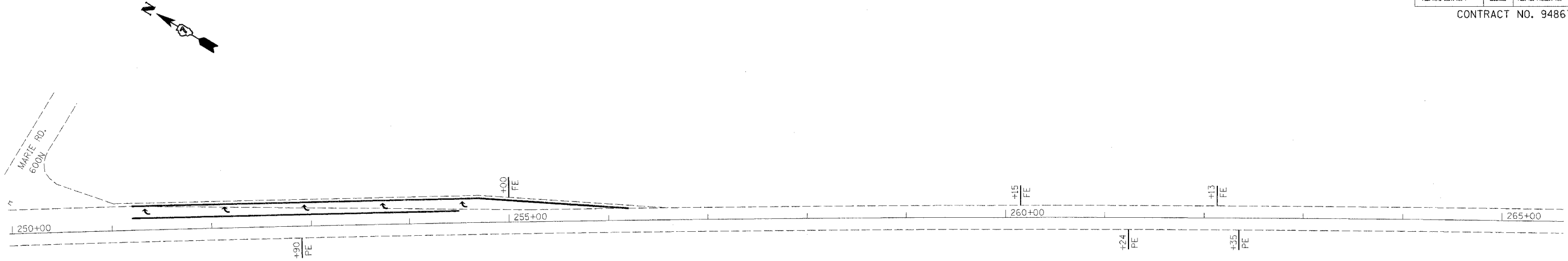

EXIST. CURVE CURVE12
 PI STA. = 269+52.86
 $\Delta = 8^\circ 03' 00''$ (RT)
 $D = 0^\circ 10' 00''$
 $R = 34,377.50'$
 $T = 2,418.98'$
 $L = 4,830.00'$
 $E = 85.00'$
 $\theta =$ -----
 $T.R. =$ -----
 $S.E. RUN =$ -----
 $P.C. STA. = 245+33.88$
 $P.T. STA. = 293+63.88$

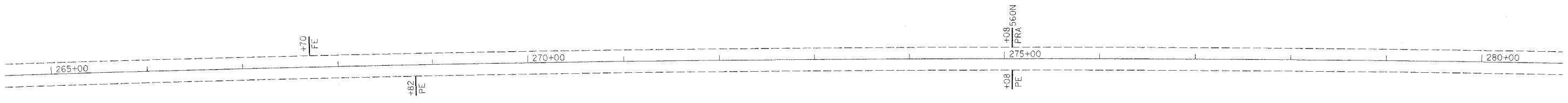

REVISIONS	
NAME	DATE

ILLINOIS DEPARTMENT OF TRANSPORTATION

**STA. 250 + 00
TO
STA. 280 + 00**

SCALE: VERT.
DATE: HORIZ.

DRAWN BY
CHECKED BY

district
3/3/2006
ci:\projects\94867\d05503pe.dgn
PS

FAP REF.	SECTION	COUNTY	TOTAL SHEETS	SHEET NO.
116	121RS-3 122RS-4	JASPER	31	21
FED. ROAD DIST. NO. 7		ILLINOIS	FED. AID PROJECT NO.	

CONTRACT NO. 94867

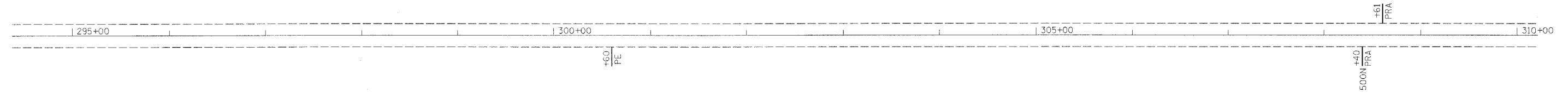
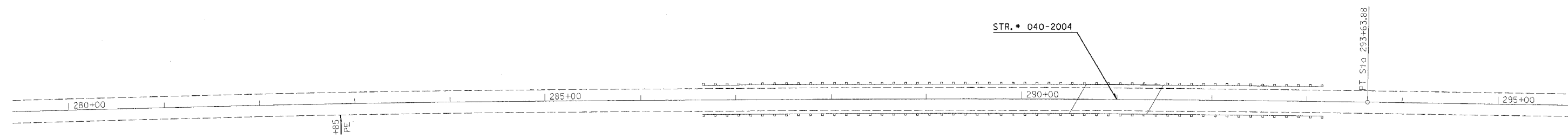

REVISIONS	
NAME	DATE

ILLINOIS DEPARTMENT OF TRANSPORTATION
**STA. 280 + 00
TO
STA. 310 + 00**
SCALE: VERT. _____
HORIZ. _____
DATE _____ DRAWN BY _____
CHECKED BY _____

district
 3/3/2006
 c:\projects\94867\d05503pe.dgn
 PS 10

FAP No.	SECTION	COUNTY	TOTAL SHEETS	SHEET NO.
116	121RS-3 122RS-4	JASPER	31	22
FED. ROAD DIST. NO. 7		ILLINOIS	FED. AID PROJECT NO.	

CONTRACT NO. 94867

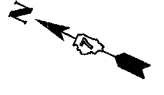
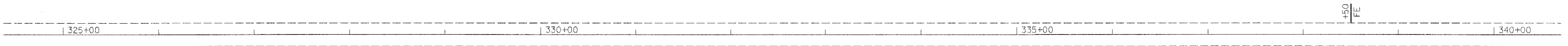

REVISIONS	
NAME	DATE

ILLINOIS DEPARTMENT OF TRANSPORTATION

STA. 310 + 00
TO
STA. 340 + 00

SCALE: VERT.
 HORIZ.
 DATE

DRAWN BY
 CHECKED BY

district
 3/3/2006
 c:\projects\94867\d05503p.dgn
 PS 11

FAP ATE.	SECTION	COUNTY	TOTAL SHEETS	SHEET NO.
116	121RS-3 122RS-4	JASPER	31	23
FED. ROAD DIST. NO. 7		ILLINOIS	FED. AID PROJECT NO.	

CONTRACT NO. 94867

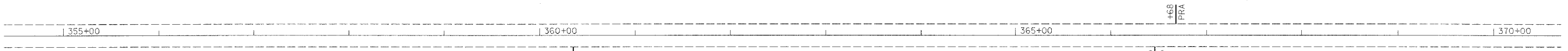
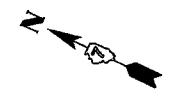
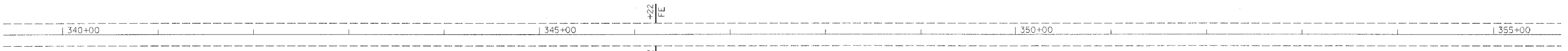

REVISIONS	
NAME	DATE

ILLINOIS DEPARTMENT OF TRANSPORTATION

**STA. 340 + 00
 TO
 STA. 370 + 00**

SCALE: VERT.
 HORIZ.
 DATE

DRAWN BY
 CHECKED BY

district
3/3/2006
c:\projects\94867\d\05503pa.dgn
PS 12

FAP EST.	SECTION	COUNTY	TOTAL SHEETS	SHEET NO.
116	121RS-3 122RS-4	JASPER	31	24
FED. ROAD DIST. NO. 7		SLIPDIS	FED. AID PROJECT NO.	

CONTRACT NO. 94867

EXIST. CURVE CURVE15
 PI STA. = 375+37.32
 $\Delta = 24^\circ 51' 00''$ (RT)
 $D = 2^\circ 59' 59''$
 $R = 1,910.10'$
 $T = 420.84'$
 $L = 828.44'$
 $E = 45.81'$
 $e = \text{-----}$
 $T.R. = \text{-----}$
 $S.E. \text{ RUN} = \text{-----}$
 P.C. STA. = 371+16.48
 P.T. STA. = 379+44.92

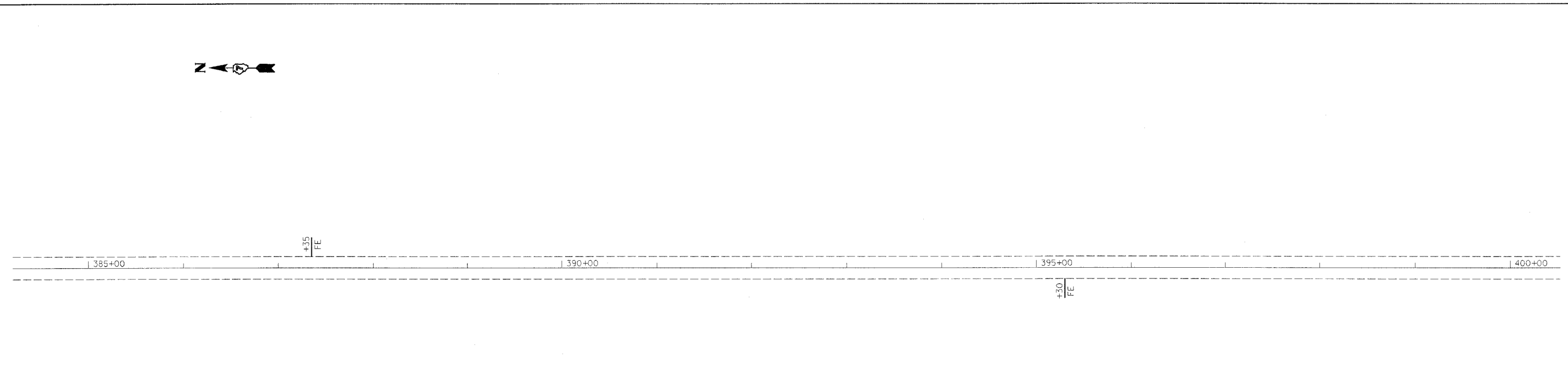
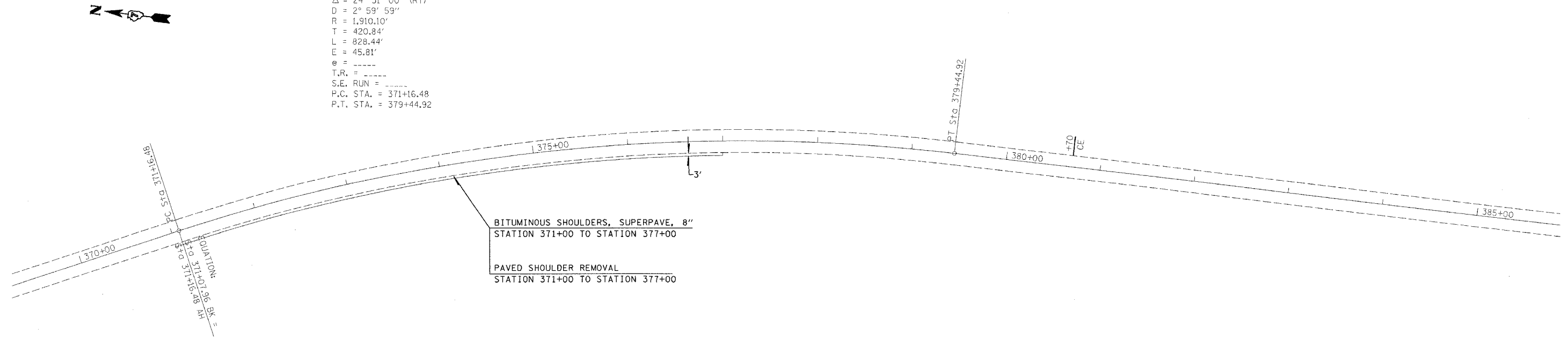

REVISIONS	
NAME	DATE

ILLINOIS DEPARTMENT OF TRANSPORTATION
**STA. 370 + 00
 TO
 STA. 400 + 00**
 SCALE: VERT. _____
 HORIZ. _____
 DATE _____
 DRAWN BY _____
 CHECKED BY _____

district
 3/3/2006
 c:\projects\94867\d05503ps.dgn
 PS 13

FAP RTE.	SECTION	COUNTY	TOTAL SHEETS	SHEET NO.
116	121RS-3 122RS-4	JASPER	31	25
FED. ROAD DIST. NO. 7		ILLINOIS	FED. AID PROJECT NO.	

CONTRACT NO. 94867

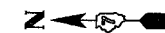
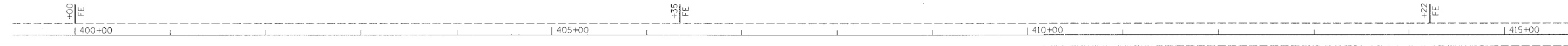

REVISIONS	
NAME	DATE

ILLINOIS DEPARTMENT OF TRANSPORTATION

**STA. 400 + 00
 TO
 STA. 430 + 00**

SCALE: VERT. _____
 HORIZ. _____

DATE _____ DRAWN BY _____
 CHECKED BY _____

district
 3/3/2006
 c:\projects\94867\d05503ps.dgn
 PS 14

FAP No.	SECTION	COUNTY	TOTAL SHEETS	SHEET NO.
116	121RS-3 122RS-4	JASPER	31	26
FED. ROAD DIST. NO. 1	ILLINOIS	FED. AID PROJECT NO.		

CONTRACT NO. 94867

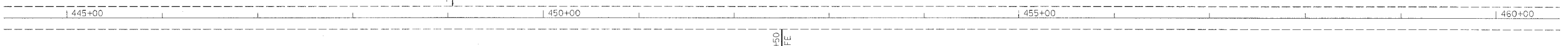

REVISIONS	
NAME	DATE

ILLINOIS DEPARTMENT OF TRANSPORTATION
**STA. 430 + 00
 TO
 STA. 460 + 00**
 SCALE: VERT. _____
 DATE _____
 DRAWN BY _____
 CHECKED BY _____

district
 3/3/2006
 ci:\projects\94867\d\05503pa.dgn
 PS 15

FAP RTE.	SECTION	COUNTY	TOTAL SHEETS	SHEET NO.
116	121RS-3 122RS-4	JASPER	31	27
FED. ROAD DIST. NO. 7		ILLINOIS	FED. AID PROJECT NO.	

CONTRACT NO. 94867

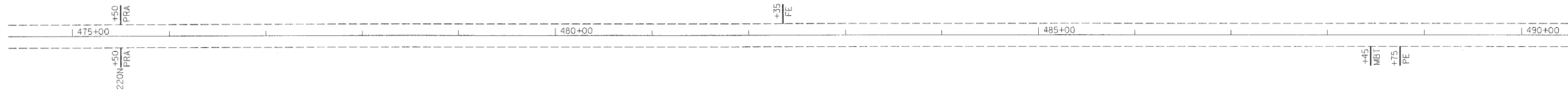
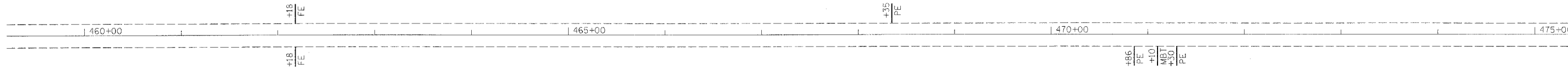

REVISIONS	
NAME	DATE

ILLINOIS DEPARTMENT OF TRANSPORTATION
**STA. 460 + 00
 TO
 STA. 490 + 00**
 SCALE: VERT. _____
 DATE _____
 DRAWN BY _____
 CHECKED BY _____

district
 3/3/2006
 c:\projects\94867\d05503ps.dgn
 PS 16

FAP SITE	SECTION	COUNTY	TOTAL SHEETS	SHEET NO.
116	121RS-3 122RS-4	JASPER	31	28
FED. ROAD DIST. NO. 7	ILLINOIS	FED. AID PROJECT NO.		

CONTRACT NO. 94867

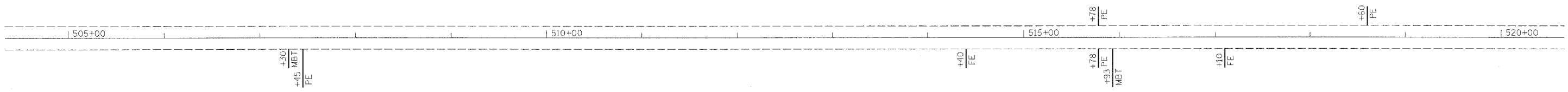

REVISIONS	
NAME	DATE

ILLINOIS DEPARTMENT OF TRANSPORTATION
**STA. 490 + 00
 TO
 STA. 520 + 00**
 SCALE: VERT. DRAWN BY
 HORIZ. CHECKED BY
 DATE

district
 3/3/2006
 c:\projects\94867\d05503pa.dgn
 PS 17

FAP ATE	SECTION	COUNTY	TOTAL SHEETS	SHEET NO.
116	121RS-3 122RS-4	JASPER	31	29
FED. ROAD DIST. NO. 7		ILLINOIS	FED. AID PROJECT NO.	

CONTRACT NO. 94867

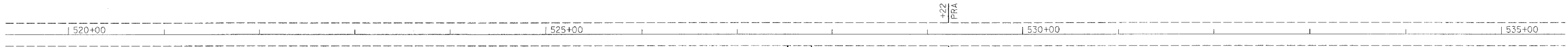

REVISIONS	
NAME	DATE

ILLINOIS DEPARTMENT OF TRANSPORTATION

**STA. 520 + 00
 TO
 STA. 550 + 00**

SCALE: VERT. DRAWN BY
 HORIZ. CHECKED BY
 DATE

district
 3/3/2006
 c:\projects\94867\d\05503pa.dgn
 PS 18

FAP NO.	SECTION	COUNTY	TOTAL SHEETS	SHEET NO.
116	121RS-3 122RS-4	JASPER	31	30

CONTRACT NO. 94867

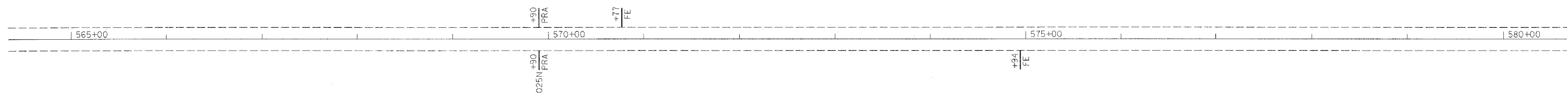
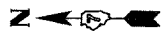
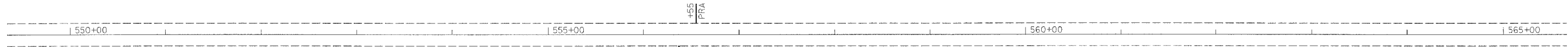

REVISIONS	
NAME	DATE

ILLINOIS DEPARTMENT OF TRANSPORTATION

**STA. 550 + 00
 TO
 STA. 580 + 00**

SCALE: VERT. _____
 HORIZ. _____

DATE _____ DRAWN BY _____
 CHECKED BY _____

district
 3/3/2006
 c:\projects\94867\05503pa.dgn
 PS 19

FAP SITE	SECTION	COUNTY	TOTAL SHEETS	SHEET NO.
116	121RS-3 122RS-4	JASPER	31	31
FED. ROAD DIST. NO. 1		ILLINOIS	FED. AID PROJECT NO.	

CONTRACT NO. 94867

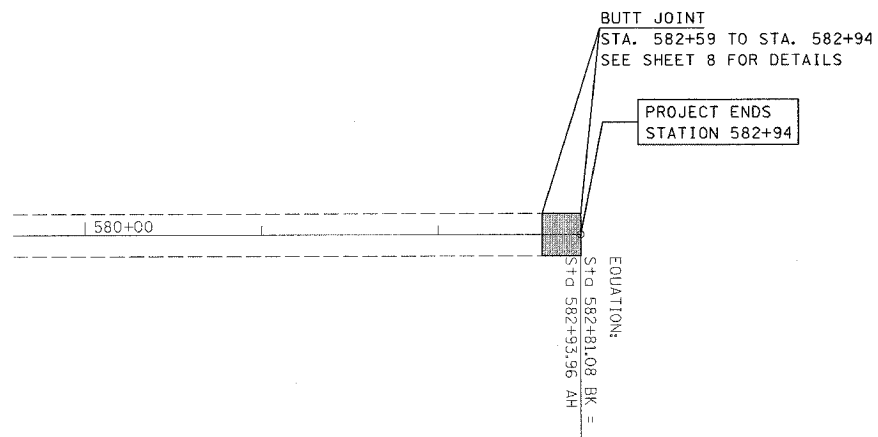

REVISIONS	
NAME	DATE

ILLINOIS DEPARTMENT OF TRANSPORTATION

**STA. 580 + 00
 TO
 STA. 582 + 94**

SCALE: VERT. _____
 HORIZ. _____

DATE _____ DRAWN BY _____
 CHECKED BY _____