

F.A.U. RTE.	SECTION	COUNTY	TOTAL SHEETS	SHEET NO.
8361	05-00083-08-SF	EFFINGHAM	40	8
STA. 620+00.00		TO STA. 628+00.00		
FED. ROAD DIST. NO. 1		ILLINOIS	FED. AID PROJECT	

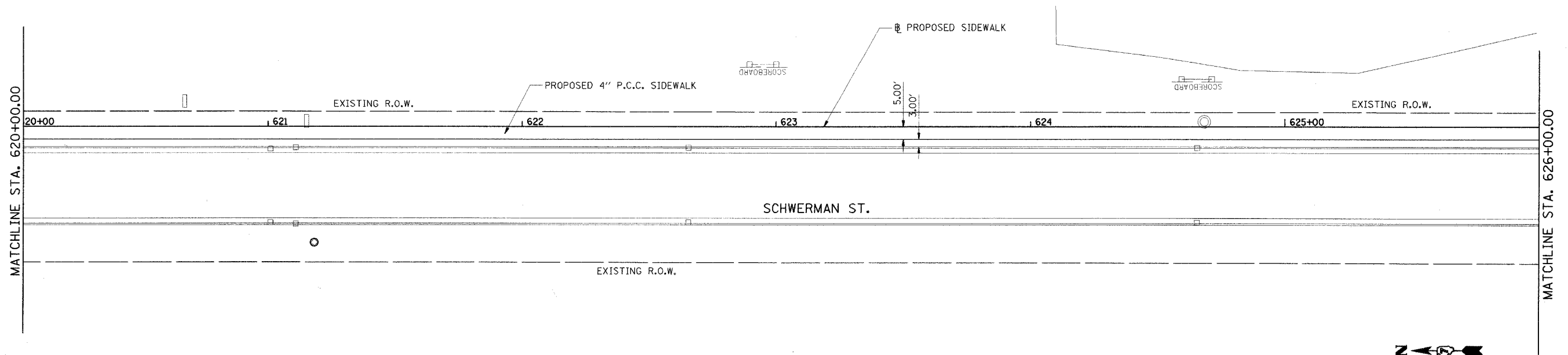

HANSON
 Hanson Professional Services, Inc.
 1525 South Sixth Street
 Springfield, Illinois 62703-2886
 Offices Nationwide

PROP. CURVE SWMAIN-7 PI STA. = 626+85.59 $\Delta = 7^\circ 51' 45''$ (LT) $D = 5^\circ 53' 22''$ $R = 972.87'$ $T = 66.86'$ $L = 133.50'$ $E = 2.29'$ $\theta = \text{-----}$ T.R. = ----- S.E. RUN = ----- P.C. STA = 626+18.73 P.T. STA = 627+52.23	PROP. CURVE SWMAIN-8 PI STA. = 628+08.75 $\Delta = 31^\circ 55' 03''$ (LT) $D = 28^\circ 59' 27''$ $R = 197.63'$ $T = 56.52'$ $L = 110.09'$ $E = 7.92'$ $\theta = \text{-----}$ T.R. = ----- S.E. RUN = ----- P.C. STA = 627+52.23 P.T. STA = 628+62.23
---	---

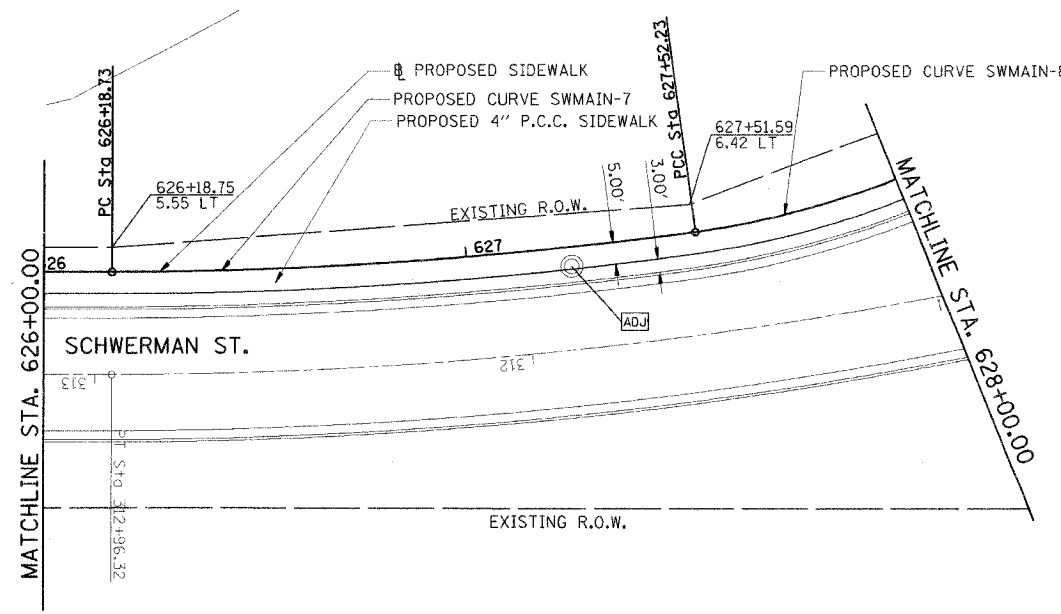

DATE	03/24/06
PLT	JAP
CHK	JTB
APP	JTB
DES	JTB
ENG	JTB
REV	JTB
DATE	03/24/06
PLT	JAP
CHK	JTB
APP	JTB
DES	JTB
ENG	JTB
REV	JTB

REVISIONS	
NAME	DATE

ILLINOIS DEPARTMENT OF TRANSPORTATION

**PROPOSED SIDEWALK PLAN
 SCHWERMANN ST.**

SCALE: VERT. 1"=20'
 HORIZ. 1"=20'
 DATE 03/24/06

DRAWN BY JAP
 CHECKED BY JTB