

F.A.I. RTE.	SECTION	COUNTY	TOTAL SHEETS	SHEET NO.
57	*	WILLIAMSON	60	34
STA. _____		TO STA. _____		
FED. ROAD DIST. NO. _____ ILLINOIS FED. AID PROJECT				
* EX1-(4,4-1,5,6,6-2) R-1				

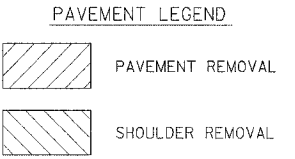
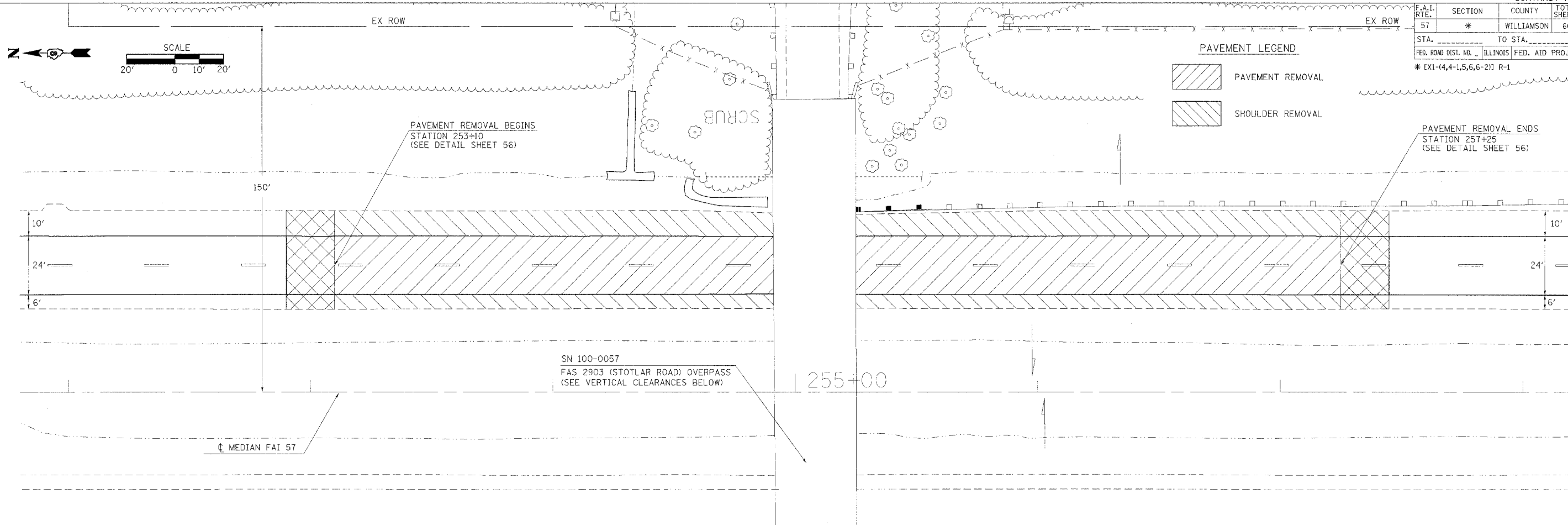

REVISIONS
 NO. DATE BY
 1 10/1/00 [unclear]
 2 10/1/00 [unclear]
 3 10/1/00 [unclear]
 4 10/1/00 [unclear]
 5 10/1/00 [unclear]
 6 10/1/00 [unclear]
 7 10/1/00 [unclear]
 8 10/1/00 [unclear]
 9 10/1/00 [unclear]
 10 10/1/00 [unclear]
 11 10/1/00 [unclear]
 12 10/1/00 [unclear]
 13 10/1/00 [unclear]
 14 10/1/00 [unclear]
 15 10/1/00 [unclear]
 16 10/1/00 [unclear]
 17 10/1/00 [unclear]
 18 10/1/00 [unclear]
 19 10/1/00 [unclear]
 20 10/1/00 [unclear]
 21 10/1/00 [unclear]
 22 10/1/00 [unclear]
 23 10/1/00 [unclear]
 24 10/1/00 [unclear]
 25 10/1/00 [unclear]
 26 10/1/00 [unclear]
 27 10/1/00 [unclear]
 28 10/1/00 [unclear]
 29 10/1/00 [unclear]
 30 10/1/00 [unclear]
 31 10/1/00 [unclear]
 32 10/1/00 [unclear]
 33 10/1/00 [unclear]
 34 10/1/00 [unclear]
 35 10/1/00 [unclear]
 36 10/1/00 [unclear]
 37 10/1/00 [unclear]
 38 10/1/00 [unclear]
 39 10/1/00 [unclear]
 40 10/1/00 [unclear]
 41 10/1/00 [unclear]
 42 10/1/00 [unclear]
 43 10/1/00 [unclear]
 44 10/1/00 [unclear]
 45 10/1/00 [unclear]
 46 10/1/00 [unclear]
 47 10/1/00 [unclear]
 48 10/1/00 [unclear]
 49 10/1/00 [unclear]
 50 10/1/00 [unclear]
 51 10/1/00 [unclear]
 52 10/1/00 [unclear]
 53 10/1/00 [unclear]
 54 10/1/00 [unclear]
 55 10/1/00 [unclear]
 56 10/1/00 [unclear]
 57 10/1/00 [unclear]
 58 10/1/00 [unclear]
 59 10/1/00 [unclear]
 60 10/1/00 [unclear]

VERTICAL CLEARANCES FOR STOTLAR ROAD OVERPASS

STATION	EXISTING LOW STEEL ELEVATION	EXISTING CENTERLINE PAVEMENT ELEVATION	PROPOSED CENTERLINE PAVEMENT ELEVATION	PROPOSED VERTICAL CLEARANCE FEET
254+92.29 NB	439.31	422.50	422.50	16.81
255+22.57 NB	439.33	422.64	422.65	16.68

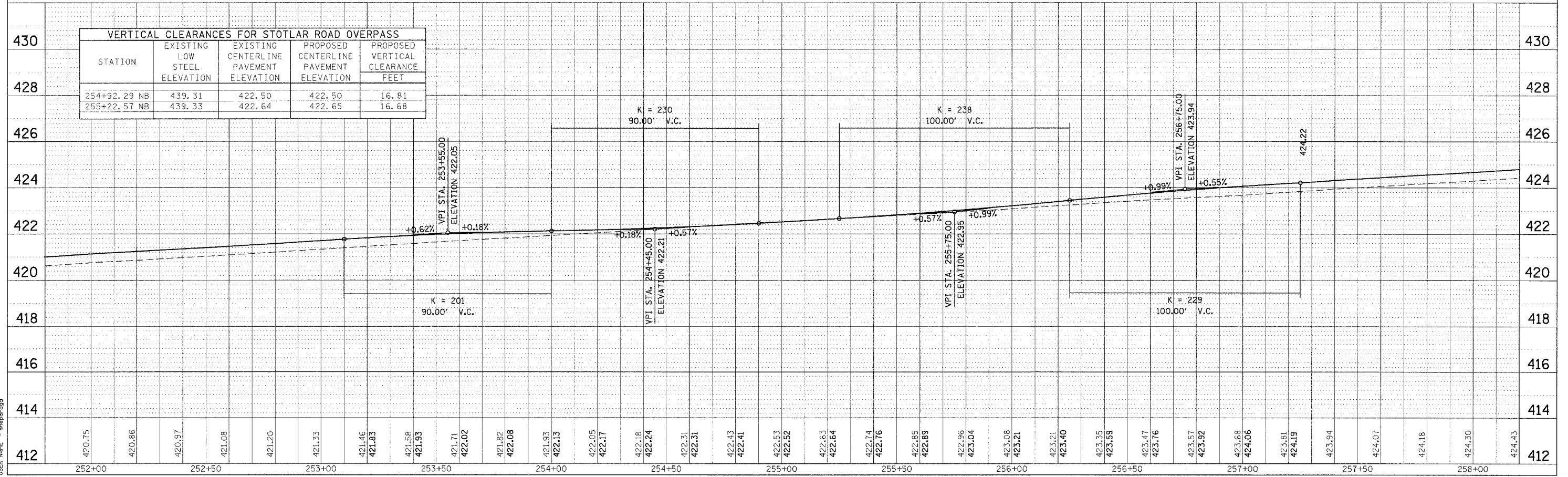

PROFILE REVISIONS
 NO. DATE BY
 1 10/1/00 [unclear]
 2 10/1/00 [unclear]
 3 10/1/00 [unclear]
 4 10/1/00 [unclear]
 5 10/1/00 [unclear]
 6 10/1/00 [unclear]
 7 10/1/00 [unclear]
 8 10/1/00 [unclear]
 9 10/1/00 [unclear]
 10 10/1/00 [unclear]
 11 10/1/00 [unclear]
 12 10/1/00 [unclear]
 13 10/1/00 [unclear]
 14 10/1/00 [unclear]
 15 10/1/00 [unclear]
 16 10/1/00 [unclear]
 17 10/1/00 [unclear]
 18 10/1/00 [unclear]
 19 10/1/00 [unclear]
 20 10/1/00 [unclear]
 21 10/1/00 [unclear]
 22 10/1/00 [unclear]
 23 10/1/00 [unclear]
 24 10/1/00 [unclear]
 25 10/1/00 [unclear]
 26 10/1/00 [unclear]
 27 10/1/00 [unclear]
 28 10/1/00 [unclear]
 29 10/1/00 [unclear]
 30 10/1/00 [unclear]
 31 10/1/00 [unclear]
 32 10/1/00 [unclear]
 33 10/1/00 [unclear]
 34 10/1/00 [unclear]
 35 10/1/00 [unclear]
 36 10/1/00 [unclear]
 37 10/1/00 [unclear]
 38 10/1/00 [unclear]
 39 10/1/00 [unclear]
 40 10/1/00 [unclear]
 41 10/1/00 [unclear]
 42 10/1/00 [unclear]
 43 10/1/00 [unclear]
 44 10/1/00 [unclear]
 45 10/1/00 [unclear]
 46 10/1/00 [unclear]
 47 10/1/00 [unclear]
 48 10/1/00 [unclear]
 49 10/1/00 [unclear]
 50 10/1/00 [unclear]
 51 10/1/00 [unclear]
 52 10/1/00 [unclear]
 53 10/1/00 [unclear]
 54 10/1/00 [unclear]
 55 10/1/00 [unclear]
 56 10/1/00 [unclear]
 57 10/1/00 [unclear]
 58 10/1/00 [unclear]
 59 10/1/00 [unclear]
 60 10/1/00 [unclear]

PLOT DATE = 3/30/2005
 PLOT SCALE = 20.0000" = 1.0000'
 USER NAME = shepa-dgd