

F.A.P. RTE.	SECTION	COUNTY	TOTAL SHEETS	SHEET NO.
853	(7,8)RS-3	HAMILTON	16	1

STATE OF ILLINOIS  
 DEPARTMENT OF TRANSPORTATION  
 DIVISION OF HIGHWAYS  
**PROPOSED  
 HIGHWAY PLANS**

FOR INDEX OF SHEETS, SEE SHEET NO. 2

BRIDGE OMISSIONS

STA 333+40.00 TO STA 334+14.00  
 STA 399+35.00 TO STA 400+11.00  
 STA 700+92.00 TO STA 699+28.00

STATION EQUATIONS

STA 313+68.80 BK = STA 313+70.40 AH  
 STA 327+82.40 BK = STA 327+84.30 AH  
 STA 361+94.70 BK = STA 361+95.30 AH  
 STA 379+62.50 BK = STA 379+63.20 AH  
 STA 408+24.80 BK = STA 408+25.20 AH  
 STA 578+85.40 BK = STA 748+80.00 AH (DIST. 9 SURVEY)

ADT (2003) 1812

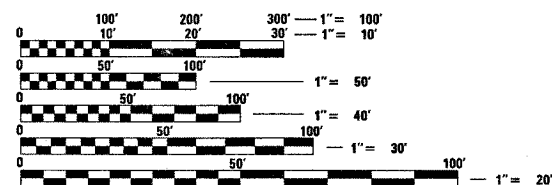

FULL SIZE PLANS HAVE BEEN PREPARED USING STANDARD ENGINEERING SCALES. REDUCED SIZED PLANS WILL NOT CONFORM TO STANDARD SCALES. IN MAKING MEASUREMENTS ON REDUCED PLANS, THE ABOVE SCALES MAY BE USED.

J.U.L.I.E.  
 JOINT UTILITY LOCATION INFORMATION FOR EXCAVATION  
 1-800-892-0123

FAP 853  
 SEC. (7, 8)RS-3  
 FRANKLIN COUNTY  
 ENDS  
 STA. 655+23.00

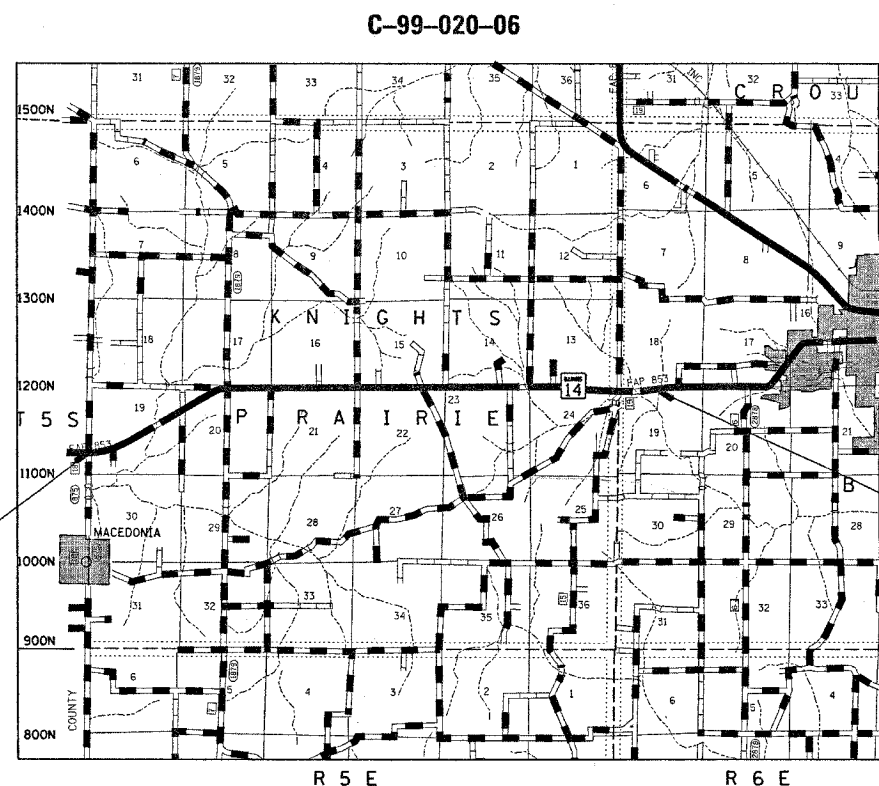

FAP 853  
 SEC. (7, 8)RS-3  
 HAMILTON COUNTY  
 BEGINS  
 STA. 301+50.00

GROSS LENGTH = 37087.2 FEET = 7.02 MILES  
 NET LENGTH = 36773.2 FEET = 6.96 MILES

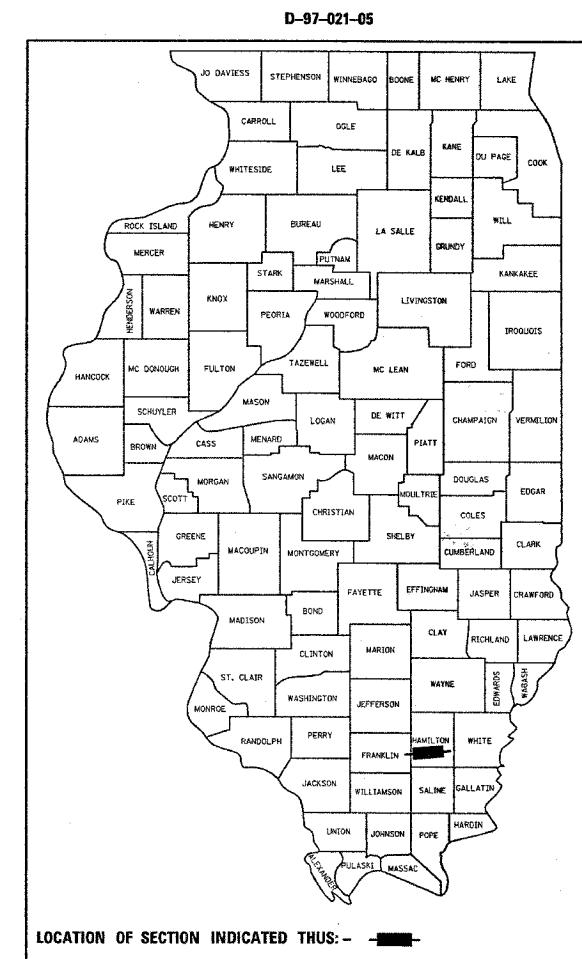

STATE OF ILLINOIS  
 DEPARTMENT OF TRANSPORTATION  
 DIVISION OF HIGHWAYS

SUBMITTED March 27, 2006

Chris H. Reed  
 DEPUTY DIRECTOR OF HIGHWAYS, REGION ENGINEER

May 12, 2006  
Mike Hine  
 ENGINEER OF DESIGN AND ENVIRONMENT

May 12, 2006  
Milton R. Sess  
 DIRECTOR OF HIGHWAYS, CHIEF ENGINEER

**PRINTED BY THE AUTHORITY  
 OF THE STATE OF ILLINOIS**

PROJECT ENGINEER : MARK DAUGHERTY  
 SQUAD LEADER : KRISTI SANDSCHAFER  
 DESIGNER: BROCK HANCOCK  
 TELEPHONE : 217/342-3951 EX 313  
 koester@gl  
 3/27/2006  
 c:\projects\74093d\d02105pa.dgn

CONTRACT NO. 98955				
F.A.P. RTE.	SECTION	COUNTY	TOTAL SHEETS	SHEET NO.
853	(7,BRS-3	HAMILTON	16	2
STA.		TO STA.		
FED. ROAD DIST. NO.	ILLINOIS	FED. AID PROJECT		

### GENERAL NOTES

THIS PROJECT IS LOCATED ON ILLINOIS ROUTE 14 IN HAMILTON COUNTY, BEGINNING APPROXIMATELY 2.6 MILES SOUTH OF MCLEANSBORO AND EXTENDING APPROXIMATELY 7 MILES TO THE FRANKLIN COUNTY LINE. THE WORK INCLUDED IN THIS SECTION CONSISTS OF MILLING, RESURFACING, AND OTHER WORK NECESSARY TO COMPLETE THIS SECTION.

THE CONTRACTOR SHALL PROVIDE INTERNET ACCESS TO THE BITUMINOUS PLANT QUALITY CONTROL LAB SO THAT BITUMINOUS PLANT REPORTS CAN BE E-MAILED TO THE DISTRICT HEADQUARTERS. THIS WORK WILL NOT BE PAID FOR SEPARATELY BUT SHALL BE INCLUDED IN THE UNIT PRICES FOR OTHER ITEMS IN THE CONTRACT.

BITUMINOUS MATERIALS (PRIME COAT) SHALL BE EITHER RC-70 OR SS-1HP.

THE COST OF REMOVAL OF THE TEMPORARY RAMP SHALL BE INCLUDED IN THE UNIT PRICE FOR TEMPORARY RAMP.

SHORT TERM PAVEMENT MARKING ON THE MILLED SURFACE SHALL BE PAINT. ALL OTHER SHORT TERM PAVEMENT MARKINGS SHALL BE TAPE.

THE MATERIAL USED FOR AGGREGATE SHOULDERS, TYPE B SHALL BE CRUSHED STONE, CRUSHED CONCRETE OR RAP.

THE MATERIAL USED FOR AGGREGATE SURFACE COURSE, TYPE B SHALL BE CRUSHED STONE OR CRUSHED CONCRETE.

THE TOTAL QUANTITY OF PAINT PAVEMENT MARKING - LINE 4" CONSISTS OF 26,720 FEET OF YELLOW AND 72,588 FEET OF WHITE.

THE TOTAL QUANTITY OF RAISED REFLECTIVE PAVEMENT MARKERS CONSISTS OF 460 TWO-WAY AMBER MARKERS.

THE FOLLOWING MIXTURE REQUIREMENTS ARE APPLICABLE FOR THIS PROJECT:

MIXTURE USE(S): SURFACE COURSE  
AC/PG: PG 64-22  
RAP%: (MAX) 10%  
DESIGN AIR VOIDS: 4.0% @ NDESIGN = 90  
MIXTURE COMPOSITION: IL-9.5 OR IL-12.5  
(GRADATION)  
FRICTION AGGREGATE: MIXTURE C

MIXTURE USE(S): INCIDENTAL BITUMINOUS SURFACING  
AC/PG: PG 64-22  
RAP%: (MAX) 10%  
DESIGN AIR VOIDS: 4.0% @ NDESIGN = 90  
MIXTURE COMPOSITION: IL-9.5 OR IL-12.5  
(GRADATION)  
FRICTION AGGREGATE: MIXTURE C

THE FOLLOWING RATES OF APPLICATION HAVE BEEN USED IN THE CALCULATING PLAN QUANTITIES:

AGGREGATE SURFACE COURSE	2.05 TONS/CU YD
AGGREGATE SHOULDERS	2.05 TONS/CU YD
BITUMINOUS MATERIALS (PRIME COAT)	0.10 GAL/SQ YD
AGGREGATE (PRIME COAT)	4 LBS/SQ YD
BITUMINOUS CONCRETE	2.016 TON/CU YD

### INDEX OF SHEETS

SHEET NO	TITLE
1	COVER SHEET
2	GENERAL NOTES, INDEX OF SHEETS, LIST OF STANDARDS
3	SUMMARY OF QUANTITIES
4	TYPICAL SECTIONS
5	MILLING DETAILS
6	PAVING SCHEDULE
7	ENTRANCE SCHEDULE
8-14	PLAN SHEETS
15-16	PAVEMENT MARKING DETAILS

THE FOLLOWING STANDARDS ARE A PART OF THESE PLANS AND ARE INCLUDED FOLLOWING SHEET NUMBER 16:

000001-04	STANDARD SYMBOLS, ABBREVIATIONS AND PATTERNS
001006	DECIMAL OF AN INCH AND OF A FOOT
406201	MAILBOX TURNOUT
442201-01	CLASS C AND D PATCHES
701006-02	OFF-ROAD OPERATIONS, 2L, 2W, 4.5 M (15') TO 600 MM (24") FROM PAVEMENT EDGE
701011-01	OFF-ROAD MOVING OPERATIONS, 2L, 2W, DAY ONLY
701301-02	LANE CLOSURE, 2L, 2W, SHORT TIME OPERATIONS
701306-01	LANE CLOSURE, 2L, 2W, SLOW MOVING OPERATIONS DAY ONLY, FOR SPEEDS >= 45 MPH
701311-02	LANE CLOSURE, 2L, 2W, MOVING OPERATIONS-DAY ONLY
702001-06	TRAFFIC CONTROL DEVICES
780001-01	TYPICAL PAVEMENT MARKINGS
781001-02	TYPICAL APPLICATIONS RAISED REFLECTIVE PAVEMENT MARKERS

REVISIONS	
NAME	DATE

ILLINOIS DEPARTMENT OF TRANSPORTATION

## GENERAL NOTES AND INDEX OF SHEETS

SCALE: VERT.  
DATE: HORIZ.

DRAWN BY  
CHECKED BY

F.A.P. RTE.	SECTION	COUNTY	TOTAL SHEETS	SHEET NO.
853	(7,8)RS-3	HAMILTON	16	3
STA.		TO STA.		
FED. ROAD DIST. NO.	ILLINOIS FED. AID PROJECT			

SUMMARY OF QUANTITIES			TOTAL QUANTITIES	CONSTRUCTION TYPE CODE		
CODE NO	ITEM	UNIT		1000 80% FED. / 20% STATE		
40200800	AGGREGATE SURFACE COURSE, TYPE B	TON	218	218		
40600100	BITUMINOUS MATERIALS (PRIME COAT)	GALLON	10624	10624		
40600300	AGGREGATE (PRIME COAT)	TON	213	213		
40600895	CONSTRUCTING TEST STRIP	EACH	1	1		
40600980	BITUMINOUS SURFACE REMOVAL - BUTT JOINT	SQ YD	696	696		
40600990	TEMPORARY RAMP	SQ YD	143	143		
44000030	BITUMINOUS SURFACE REMOVAL (VARIABLE DEPTH)	SQ YD	106234	106234		
48101200	AGGREGATE SHOULDERS, TYPE B	TON	2012	2012		
67000500	ENGINEER'S FIELD OFFICE, TYPE B	CAL MO	3	3		
67100100	MOBILIZATION	L SUM	1	1		
70100460	TRAFFIC CONTROL AND PROTECTION, STANDARD 701306	L SUM	1	1		
70300100	SHORT-TERM PAVEMENT MARKING	FOOT	7355	7355		
70300220	TEMPORARY PAVEMENT MARKING - LINE 4"	FOOT	99308	99308		
70301000	WORK ZONE PAVEMENT MARKING REMOVAL	SQ FT	1214	1214		
78001110	PAINT PAVEMENT MARKING - LINE 4"	FOOT	99308	99308		
78100100	RAISED REFLECTIVE PAVEMENT MARKER	EACH	460	460		
X4066418	BITUMINOUS CONCRETE SURFACE COURSE, SUPERPAVE, MIX "C", N90	TON	8924	8924		
XX005223	INCIDENTAL BITUMINOUS SURFACING, SUPERPAVE, N90	TON	95	95		

\* \* \*

\* SPECIALTY ITEMS

REVISIONS	
NAME	DATE

ILLINOIS DEPARTMENT OF TRANSPORTATION

**SUMMARY OF QUANTITIES**

SCALE: VERT. / HORIZ. / DATE

DRAWN BY / CHECKED BY

koestergl  
3/27/2006  
c:\projects\74093d\02105pa.dgn

CONTRACT NO. 98955				
F.A.P. RTE.	SECTION	COUNTY	TOTAL SHEETS	SHEET NO.
853	(7,BIRS-3	HAMILTON	16	4
STA.		TO STA.		
FED. ROAD DIST. NO.	ILLINOIS	FED. AID PROJECT		

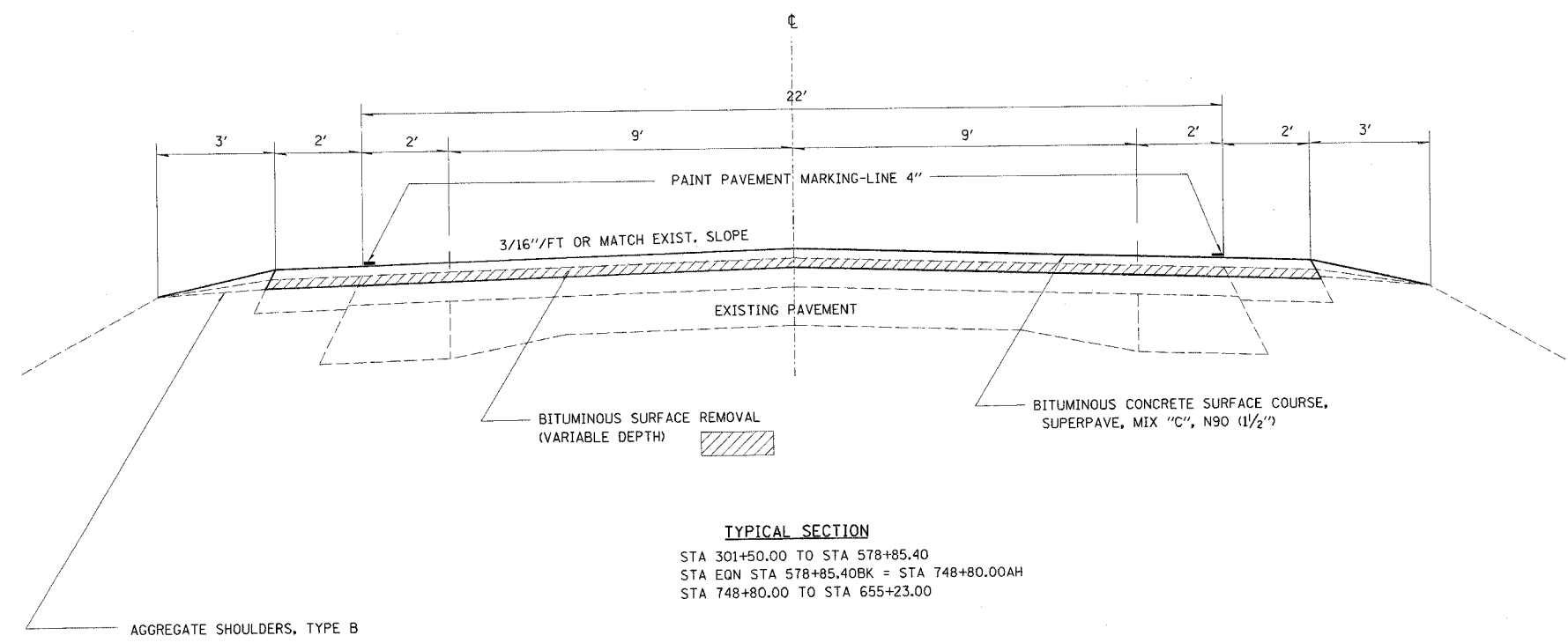

**TYPICAL SECTION**  
 STA 301+50.00 TO STA 578+85.40  
 STA EQN STA 578+85.40BK = STA 748+80.00AH  
 STA 748+80.00 TO STA 655+23.00

PLOT DATE = 3/27/2006  
 PLOT SCALE = 100,00000 / IN.  
 USER NAME = koestergl

REVISIONS	
NAME	DATE

ILLINOIS DEPARTMENT OF TRANSPORTATION

**TYPICALS**

SCALE: VERT.  
 HORIZ.  
 DATE

DRAWN BY  
 CHECKED BY

F.A.P. RTE.	SECTION	COUNTY	TOTAL SHEETS	SHEET NO.
853	(7,8)RS-3	HAMILTON	16	5
STA.	TO STA.			
FED. ROAD DIST. NO.	ILLINOIS FED. AID PROJECT			

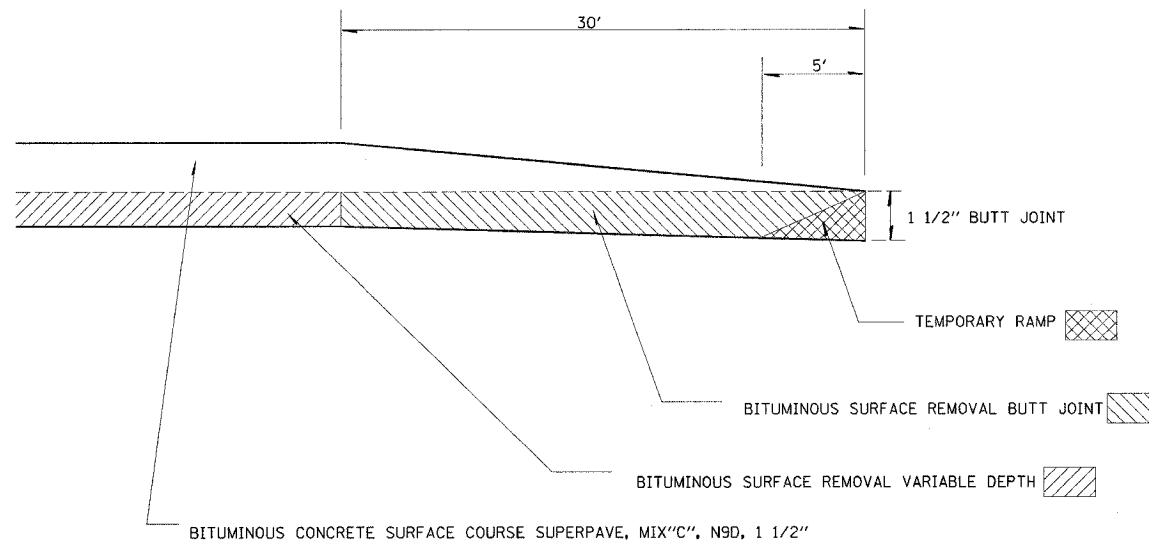

**BUTT JOINT DETAIL**

- STA 301+20 TO STA 301+50
- STA 333+10 TO STA 333+40
- STA 333+84 TO STA 334+14
- STA 399+35 TO STA 399+65
- STA 399+81 TO STA 400+11
- STA 700+92 TO STA 700+62
- STA 699+58 TO STA 699+28
- STA 655+53 TO STA 655+23

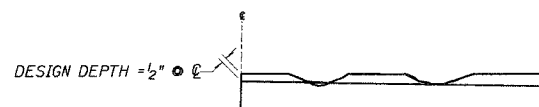

**NOTES:**

1. MILLING SHALL BE DONE TO ATTAIN A 3/16" /' SLOPE IN CROWN SECTIONS
2. EXISTING S.E. AND S.E. TRANSITIONS SHALL BE MAINTAINED UNLESS OTHERWISE SHOWN ON THE PLANS.
3. MILLING TO THE BOTTOM OF WHEEL RUTS SHALL NOT BE NECESSARY UNLESS REQUIRED TO OBTAIN SLOPE OR THE DESIGN DEPTH AT CENTERLINE.
4. THE AVERAGE DEPTH OF MILLING IS ESTIMATED TO BE 1/2" BUT MAY VARY IN ISOLATED LOCATIONS.

BITUMINOUS SURFACE REMOVAL (VARIABLE DEPTH) DETAIL

REVISIONS	
NAME	DATE

ILLINOIS DEPARTMENT OF TRANSPORTATION

**MILLING DETAILS**

SCALE: VERT. / HORIZ.  
DATE / DRAWN BY / CHECKED BY

PLOT DATE = 3/27/2006  
 FILE NAME = c:\projects\74903d\482285p.dgn  
 PLOT SCALE = 1/8" = 1' IN.  
 USER NAME = konstergl

F.A.P. RTE.	SECTION	COUNTY	TOTAL SHEETS	SHEET NO.
853	(7,8)RS-3	HAMILTON	16	6
STA.	TO STA.			
FED. ROAD DIST. NO.	ILLINOIS FED. AID PROJECT			

PAVING SCHEDULE

STATION TO STATION	LENGTH	EXISTING PAVEMENT WIDTH	AREA	BITUMINOUS MATERIALS (PRIME COAT)	AGGREGATE (PRIME COAT)	BITUMINOUS CONCRETE SURFACE COURSE, SUPERPAVE, MIX "C", N90	BITUMINOUS SURFACE REMOVAL - BUTT JOINT	BITUMINOUS SURFACE REMOVAL (VARIABLE DEPTH)	SHORT-TERM PAVEMENT MARKING	TEMPORARY PAVEMENT MARKING - LINE 4"	WORK ZONE PAVEMENT MARKING REMOVAL	PAINT PAVEMENT MARKING - LINE 4"	RAISED REFLECTIVE PAVEMENT MARKER	AGGREGATE SHOULDERS, TYPE B	TEMPORARY RAMP
	LIN FT	FEET	SQ YD	GALLON	TON	TON	SQ YD	SQ YD	LIN FT	LIN FT	SQ FT	LIN FT	EACH	TON	SQ YD
STA. 301+50.00 TO 313+68.60	1218.6	26	3520.4	352	7.1	296	87	3521	244	4823	40	4823	15	68	14
STA. EQ. 313+68.60BK=313+70.40AH															
STA. 313+70.40 TO 327+82.40	1412	26	4079.1	408	8.2	343		4079	282	3914	47	3914	17	80	
STA. EQ. 327+82.40BK=327+84.30AH															
STA. 327+84.30 TO 333+40.00	555.7	26	1605.4	160	3.3	135	174	1606	111	2059	18	2059	7	32	19
STA. 333+40.00 TO 334+14.00	BRIDGE OMISSION														
STA. 334+14.00 TO 361+94.70	2780.7	26	8033.1	803	16.1	675		8033	556	7735	92	7735	35	148	19
STA. EQ. 361+94.70BK=361+95.30AH															
STA. 361+95.30 TO 379+62.50	1767.2	26	5105.2	511	10.3	429		5105	353	3976	58	3976	22	101	
STA. EQ. 379+62.50BK=379+63.20AH															
STA. 379+63.20 TO 399+35.00	1971.8	26	5696.3	570	11.4	478	174	5696	395	6071	65	6071	25	108	19
STA. 399+35.00 TO 400+11.00	BRIDGE OMISSION														
STA. 400+11.00 TO 408+24.80	813.8	26	2351.0	235	4.8	197		2351	163	2442	27	2442	10	44	19
STA. EQ. 408+24.80BK=408+25.20AH															
STA. 408+25.20 TO 578+85.40	17060.2	26	49285.0	4929	98.6	4140	261	49285	3412	44090	563	44090	214	946	
STA. EQ. 578+85.40BK=748+80.00AH															
STA. 748+80.00 TO 700+92.00	4788	26	13832.0	1383	27.7	1162		13832	958	10527	158	10527	60	253	20
STA. 700+92.00 TO 699+28.00	BRIDGE OMISSION														
STA. 699+28.00 TO 655+23.00	4405	26	12725.6	1273	25.5	1069		12726	881	13671	146	13671	55	232	33
TOTAL	37087			10624	213	8924	696	106234	7355	99308	1214	99308	460	2012	143

PLOT DATE = 9/27/2006  
 FILE NAME = c:\pav\pca\98955\748955a\82105pca.dwg  
 PLOT SCALE = 1/8"=1'-0" / IN.  
 USER NAME = hesterj

REVISIONS	
NAME	DATE

ILLINOIS DEPARTMENT OF TRANSPORTATION

**PAVING SCHEDULE**

SCALE: VERT. \_\_\_\_\_  
 HORIZ. \_\_\_\_\_

DATE \_\_\_\_\_ DRAWN BY \_\_\_\_\_  
 CHECKED BY \_\_\_\_\_

c:\projects\74093\rd02105pa.dgn  
koester\gl\DATE  
REBS

RTL	SECTION	COUNTY	TOTAL SHEETS	SHEET NO.
853	(7,8)RS-3	HAMILTON	16	7
FED. ROAD DIST. NO. 7		ILLINOIS		FED. AID PROJECT NO.

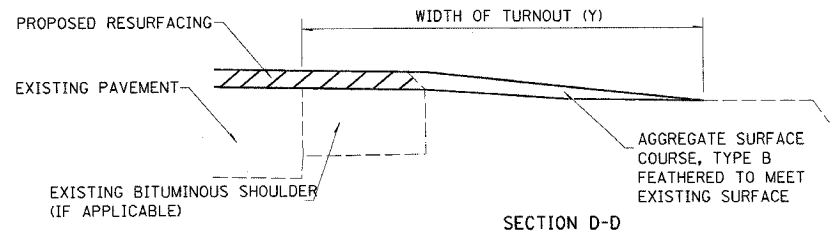
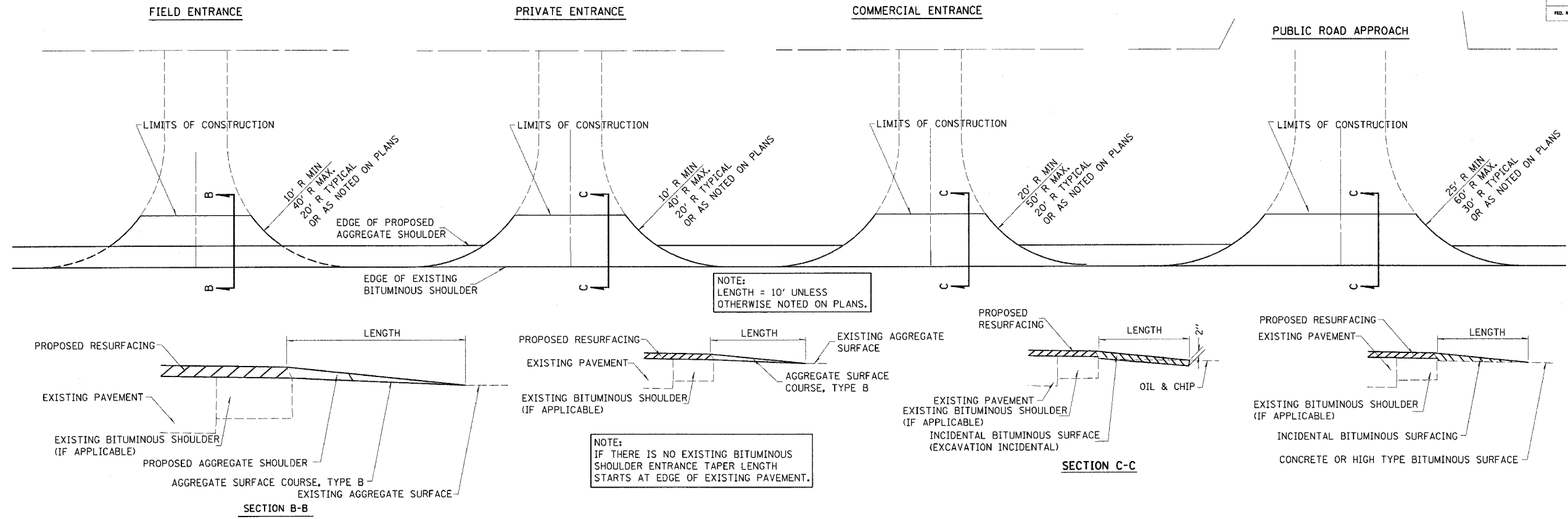

SIDE	STATION	TYPE	INCIDENTAL BITUMINOUS SURFACING*		AGGREGATE SURFACE COURSE, TYPE B
			TON	TON	
LT	301+50	PE		3.2	
LT	301+98	PE		8.2	
RT	302+71	PE	2.1		
LT	310+83	PE		3.8	
RT	315+38	FE		1.6	
RT	318+52	PE		7.9	
LT	319+80	PE		3.9	
LT	326+73	PE		3.2	
RT	327+68	FE		1.6	
LT	335+18	PE	2.8		
LT	342+50	PRA	5.8		
RT	342+50	PRA	4.0		
LT	342+83	PE		3.3	
LT	345+62	FE		1.6	
RT	353+11	PE		4.3	
LT	353+99	FE		1.6	
RT	355+05	FE		1.6	
LT	359+51	FE		1.6	
RT	367+33	FE		1.6	
LT	374+76	PE		2.3	
RT	379+83	PE		1.6	
LT	380+59	FE		1.1	
RT	380+59	PRA	2.2		
RT	381+61	PE		1.6	
LT	385+16	FE		1.6	
RT	386+36	PE		1.6	
RT	386+87	PE		1.2	
LT	387+02	FE		1.6	
RT	389+25	PE		1.6	
RT	390+21	PE		1.6	
LT	391+48	PE		1.6	
RT	391+80	PE		1.6	
LT	392+43	PE		1.6	
RT	393+08	PE		1.6	
RT	396+23	PRA	2.5		
LT	395+25	FE		1.6	
LT	397+32	FE		1.6	
RT	405+65	FE		1.6	
LT	408+89	PRA	2.5		
RT	409+30	PE		2.4	
LT	409+85	PE		1.6	
LT	410+99	PE		1.6	
RT	411+98	PE		1.4	
RT	413+69	PRA	2.1		
LT	415+36	PE		1.6	
LT	416+82	PE		1.6	
RT	416+85	PE		1.6	
LT	418+24	PE		3.4	
RT	420+67	PE	1.6		
LT	421+73	PE		1.7	
LT	425+88	FE		1.6	
LT	430+70	FE		1.6	
RT	430+95	CE		2.4	
LT	431+55	PE		2.4	
LT	432+08	PE		1.6	
LT	433+23	FE		2.1	
LT	437+19	FE		2.0	
RT	440+40	FE		2.1	
LT	440+61	PE		1.6	
RT	445+85	PRA	3.2		
LT	445+95	FE		1.6	
RT	451+30	FE		1.6	
LT	454+03	FE		1.6	
LT	456+39	CE		1.6	
RT	459+37	PE	1.6		
LT	462+05	PRA	3.5		
RT	462+15	PRA	2.7		
RT	464+76	FE		1.6	
RT	466+92	PE		1.6	
LT	469+37	PE		3.6	
RT	471+37	CE		3.6	
RT	472+72	PE		3.6	
LT	473+93	FE		3.6	
LT	476+06	CE	1.6		
RT	484+90	FE		1.6	
RT	485+71	PE		1.6	
RT	486+27	PE		1.6	
LT	486+41	PE		1.6	
LT	489+37	PE	1.6		
LT	491+58	FE		1.3	
RT	492+80	FE		1.6	
LT	492+87	PE		1.6	
LT	495+58	PE		1.6	
LT	496+11	PE		1.6	
LT	498+06	PE		1.6	
LT	499+22	PRA	2.2		
RT	499+22	PRA	2.2		
RT	500+75	PE	1.7		
LT	504+35	PE		1.6	
RT	509+73	PE		1.6	
LT	510+03	CE		2.0	
LT	510+65	PE		1.6	
RT	512+15	FE		1.2	
RT	519+15	FE		1.6	
LT	519+18	PE		1.6	
RT	523+87	PE		1.6	
RT	525+85	PRA	2.1		
LT	527+39	PE		1.6	
LT	528+32	PE		1.6	
LT	534+83	PE		1.6	
LT	537+55	PE	1.6		
LY	538+98	FE		1.6	
LT	540+23	PE		2.1	
RT	543+11	FE		1.2	
RT	548+11	PE		1.8	
RT	548+72	PE		1.6	
LT	553+38	PRA	2.1		
LT	564+11	PE		1.6	
RT	572+12	PE		1.6	
LT	577+83	FE		1.5	
LT	748+80	PRA	6.3		
RT	748+80	PRA	6.3		
RT	747+20	PE		7.2	
RT	734+08	FE		1.6	
LT	733+43	FE		1.6	
RT	718+59	PRA	1.8		
LT	718+53	PRA	2.1		
LT	717+41	CE	1.3		
RT	717+16	PE		1.5	
LT	716+71	CE	1.9		
LT	715+98	PE	1.7		
LT	704+03	FE		1.6	
RT	703+21	PE	1.6		
RT	702+95	FE		1.6	
RT	696+34	FE		1.6	
LT	688+23	FE		1.6	
LT	674+27	FE		1.6	
RT	673+80	FE		1.6	
LT	670+93	PRA	1.9		
RT	669+63	FE		1.6	
LT	669+18	PE		1.9	
RT	664+53	PE	1.6		
LT	663+08	PE		1.7	
RT	662+64	FE		1.3	
RT	661+78	PE		1.3	
RT	660+93	PE		1.6	
LT	660+23	PE		1.6	
RT	658+73	PE		1.6	
RT	658+33	PE		1.6	
RT	655+73	CE	11.1		
RT	655+28	PRA	3.8		
LT	655+23	PRA	3.8		
TOTALS			95	218	

FE - FIELD ENTRANCE  
PE - PRIVATE ENTRANCE  
CE - COMMERCIAL ENTRANCE  
PRA - PUBLIC ROAD APPROACH  
MBT - MAILBOX TURNOUT

\*BITUMINOUS MATERIALS AND AGGREGATE (PRIME COAT) FOR ENTRANCES AND PUBLIC ROAD APPROACHES SHALL BE CONSIDERED INCIDENTAL TO INCIDENTAL BITUMINOUS SURFACING AS NOTED IN THE SPECIAL PROVISIONS

koestergl  
3/27/2006  
c:\projects\74093d\02105pa.dgn

CONTRACT NO. 98955

F.A.P. RTE.	SECTION	COUNTY	TOTAL SHEETS	SHEET NO.
853	(7,8)RS-3	HAMILTON	16	8
STA.	TO STA.			
FED. ROAD DIST. NO.	ILLINOIS	FED. AID PROJECT		

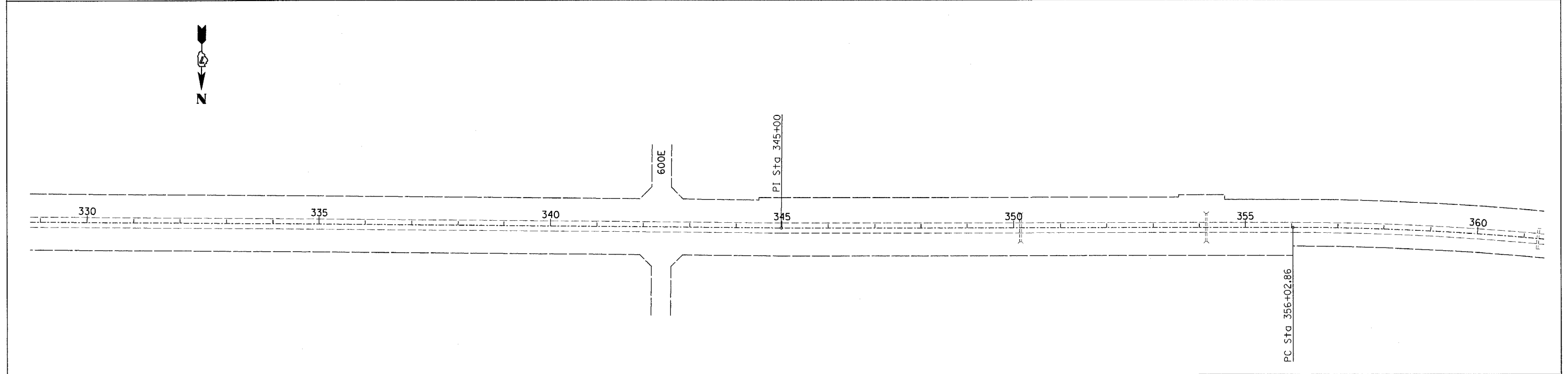
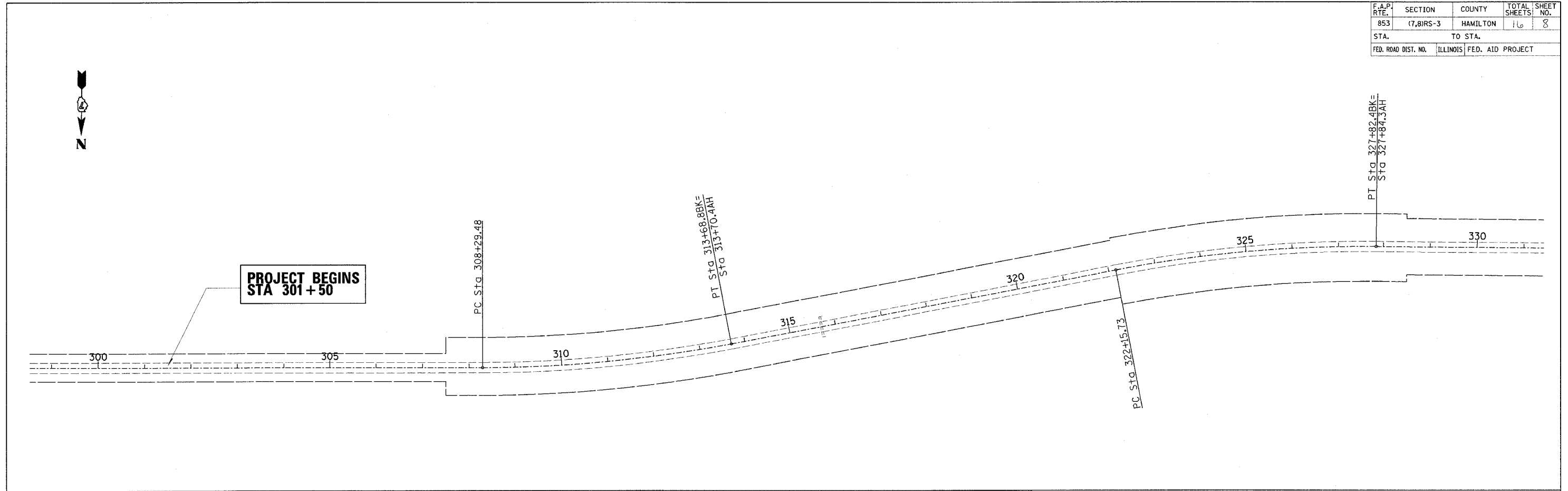

PLOT DATE = 3/27/2006  
FILE NAME = c:\projects\74093d\02105pa.dgn  
PLOT SCALE = 100.0000 / IN.  
USER NAME = koestergl

REVISIONS	
NAME	DATE

ILLINOIS DEPARTMENT OF TRANSPORTATION  
**STA 300+00 TO STA 360+00**  
SCALE: VERT. DATE  
HORIZ. DRAWN BY  
CHECKED BY



koester.q1  
3/27/2006  
c:\projects\74093d\02105pa.dgn

PLOT DATE = 3/27/2006  
PLOT SCALE = 100.0000 / IN.  
USER NAME = koester.q1

CONTRACT NO. 98955				
F.A.P. RTE.	SECTION	COUNTY	TOTAL SHEETS	SHEET NO.
853	(7,8)RS-3	HAMILTON	16	9
STA.		TO STA.		
FED. ROAD DIST. NO.	ILLINOIS	FED. AID PROJECT		

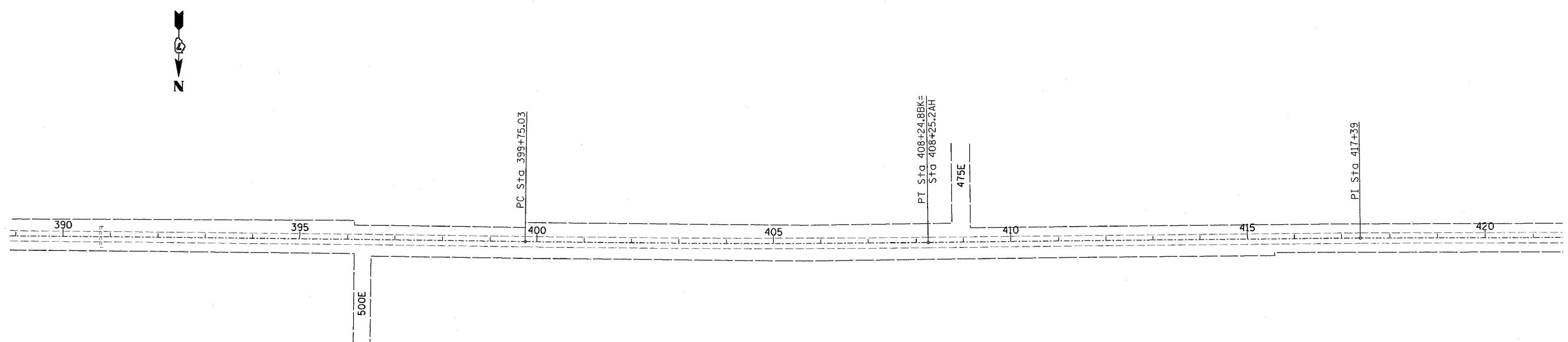
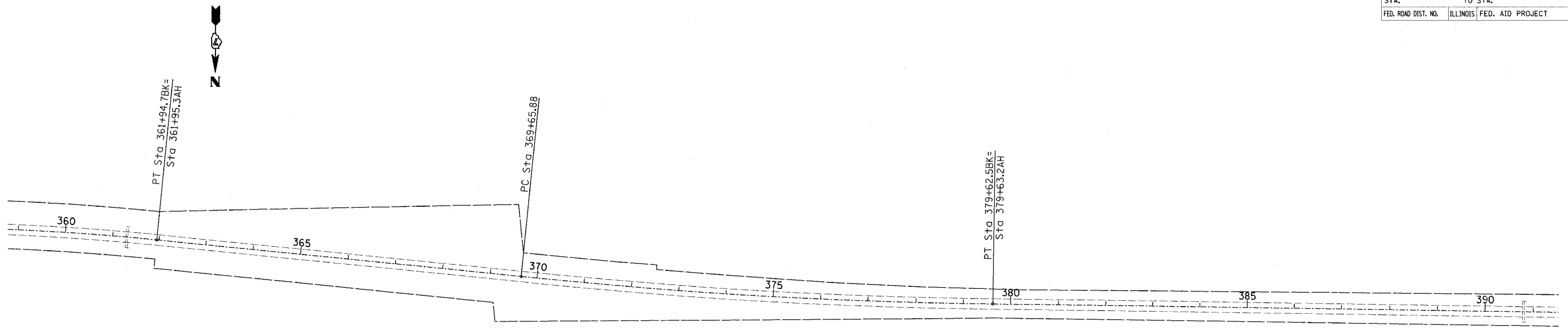

REVISIONS	
NAME	DATE

ILLINOIS DEPARTMENT OF TRANSPORTATION  
**STA 360+00 TO STA 420+00**  
SCALE: VERT. \_\_\_\_\_  
          HORIZ. \_\_\_\_\_  
DATE \_\_\_\_\_ DRAWN BY \_\_\_\_\_  
                  CHECKED BY \_\_\_\_\_

koestergl  
3/27/2006  
c:\projects\74093d\02105pa.dgn

CONTRACT NO. 98955

F.A.P. RTE.	SECTION	COUNTY	TOTAL SHEETS	SHEET NO.
853	(7,8)RS-3	HAMILTON	16	10
STA.	TO STA.			
FED. ROAD DIST. NO.	ILLINOIS FED. AID PROJECT			

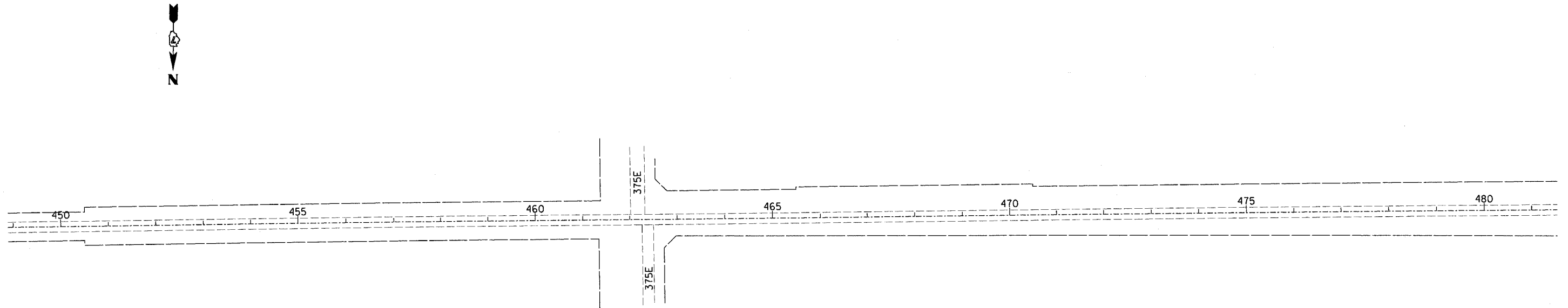
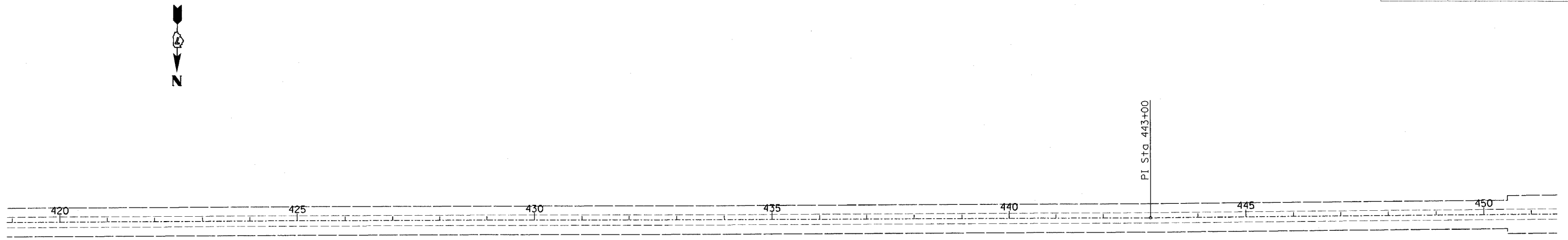

PLOT DATE = 3/27/2006  
FILE NAME = c:\projects\74093d\02105pa.dgn  
PLOT SCALE = 1/8"=100'-0" / IN.  
USER NAME = koestergl

REVISIONS	
NAME	DATE

ILLINOIS DEPARTMENT OF TRANSPORTATION  
**STA 420+00 TO STA 480+00**  
SCALE: VERT. \_\_\_\_\_  
HORIZ. \_\_\_\_\_  
DATE \_\_\_\_\_ DRAWN BY \_\_\_\_\_  
CHECKED BY \_\_\_\_\_

koestergl  
 3/27/2006  
 c:\projects\74093d\02105pa.dgn

CONTRACT NO. 98955

F.A.P. RTE.	SECTION	COUNTY	TOTAL SHEETS	SHEET NO.
853	(7,8)RS-3	HAMILTON	16	11
STA.		TO STA.		
FED. ROAD DIST. NO.		ILLINOIS	FED. AID PROJECT	

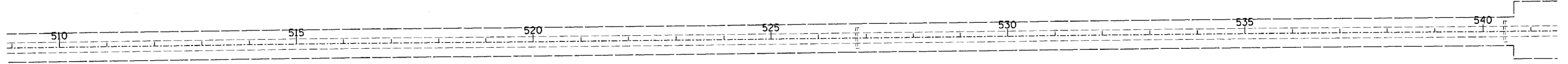
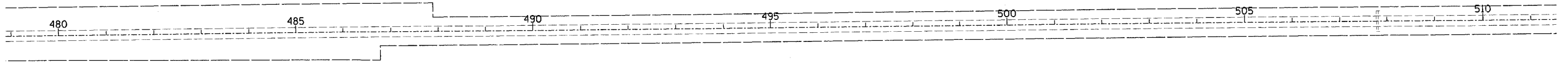

PLOT DATE = 3/27/2006  
 FILE NAME = c:\projects\74093d\02105pa.dgn  
 PLOT SCALE = 1/8"=1'-0"  
 USER NAME = koestergl

REVISIONS	
NAME	DATE

ILLINOIS DEPARTMENT OF TRANSPORTATION  
**STA 480+00 TO STA 540+00**  
 SCALE: VERT. \_\_\_\_\_  
 HORIZ. \_\_\_\_\_  
 DATE \_\_\_\_\_  
 DRAWN BY \_\_\_\_\_  
 CHECKED BY \_\_\_\_\_

koester.q1  
3/27/2006  
c:\projects\74093d\02105p.dgn

CONTRACT NO. 98955				
F.A.P. RTE.	SECTION	COUNTY	TOTAL SHEETS	SHEET NO.
853	(7,B)RS-3	HAMILTON	16	12
STA.		TO STA.		
FED. ROAD DIST. NO.	ILLINOIS	FED. AID PROJECT		

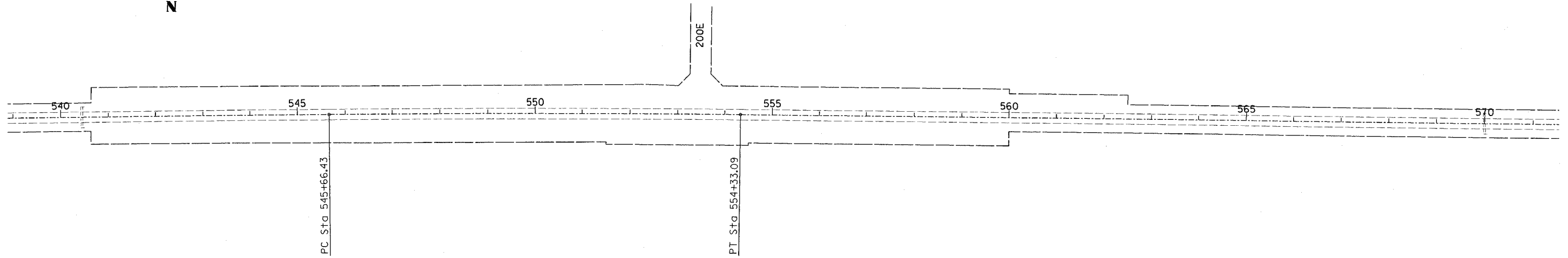

PLOT DATE = 3/27/2006  
FILE NAME = c:\projects\74093d\02105p.dgn  
PLOT SCALE = 1/8"=1'-0"  
USER NAME = koester.q1

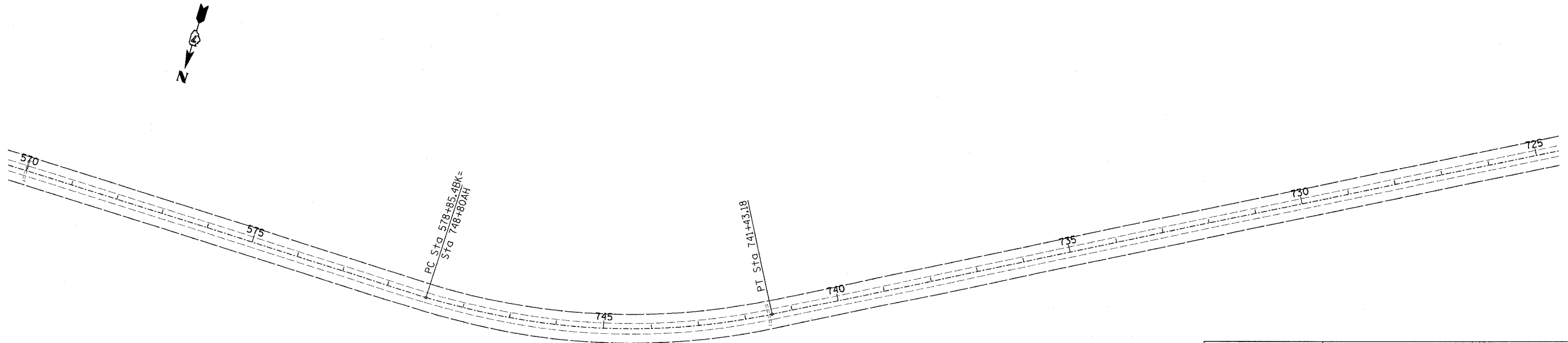

REVISIONS	
NAME	DATE

ILLINOIS DEPARTMENT OF TRANSPORTATION  
**STA 540+00 TO STA 725+00**  
SCALE: VERT.      DRAWN BY  
          HORIZ.      CHECKED BY  
DATE

koester.dgn  
 3/27/2006  
 c:\projects\74093d\02105pa.dgn

PLOT DATE = 3/27/2006  
 FILE NAME = c:\projects\74093d\02105pa.dgn  
 PLOT SCALE = 100.0000' / IN.  
 USER NAME = koester.dgn

CONTRACT NO. 98955

F.A.P. RTE.	SECTION	COUNTY	TOTAL SHEETS	SHEET NO.
853	(7,8)RS-3	HAMILTON	16	13
STA.		TO STA.		
FED. ROAD DIST. NO.	ILLINOIS	FED. AID PROJECT		

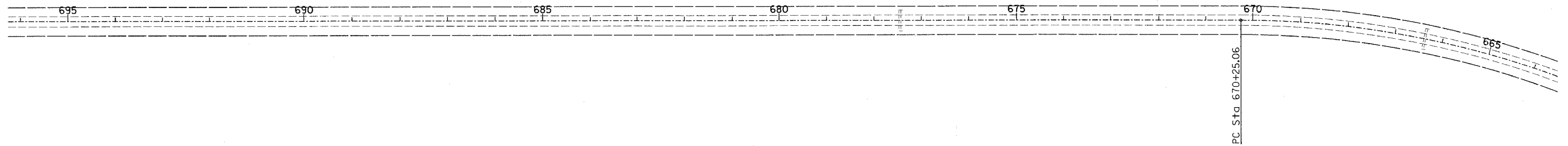

REVISIONS	
NAME	DATE

ILLINOIS DEPARTMENT OF TRANSPORTATION  
**STA 725+00 TO STA 665+00**  
 SCALE: VERT.  
 HORIZ.  
 DATE  
 DRAWN BY  
 CHECKED BY

koestergl  
 3/27/2006  
 c:\projects\74093d\02105p.dgn

PLOT DATE = 3/27/2006  
 FILE NAME = c:\projects\74093d\02105p.dgn  
 PLOT SCALE = 1/8"=1'-0" / IN.  
 USER NAME = koestergl

CONTRACT NO. 98955

F.A.P. RTE.	SECTION	COUNTY	TOTAL SHEETS	SHEET NO.
853	(7,8)RS-3	HAMILTON	16	14
STA.		TO STA.		
FED. ROAD DIST. NO.	ILLINOIS	FED. AID PROJECT		

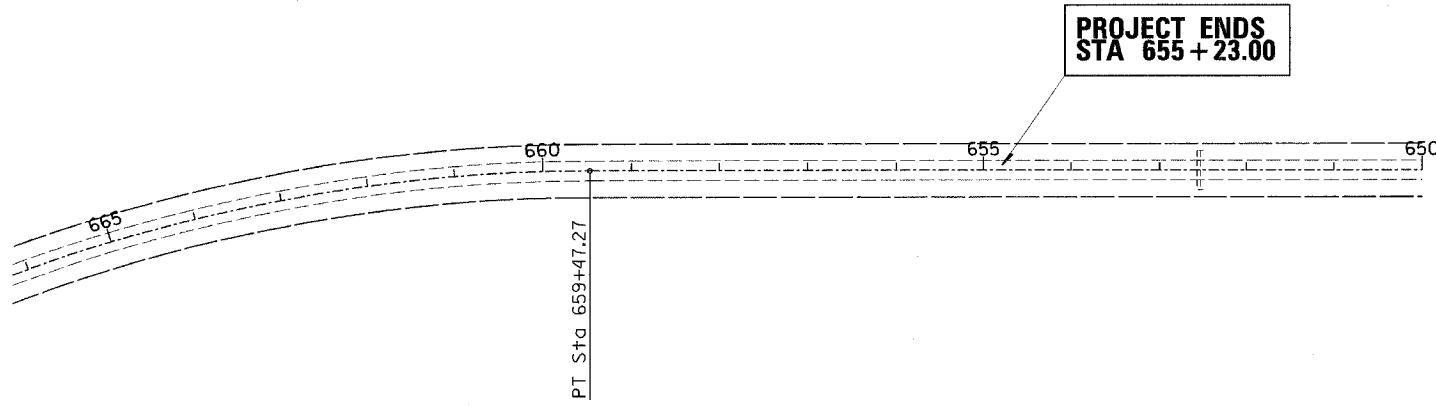

REVISIONS	
NAME	DATE

ILLINOIS DEPARTMENT OF TRANSPORTATION  
**STA 665+00 TO STA 650+00**  
 SCALE: VERT. DATE  
 HORIZ. DRAWN BY  
 CHECKED BY

1 2 3 4 5 6 7 8 9 3/27/2006  
 10 11 12 13 14 15 16 17 18 c:\projects\74093d\02105pa.dgn  
 19 20 21 22 23 24 25 26 MMO REV: 05-06-96  
 27 28 29 30 31 32 33 34 35  
 36 37 38 39 40 41 42 43 44 45  
 46 47 48 49 50 51 52 53 54  
 55 56 57 58 59 60 61 62 63  
 EPMD

c:\projects\74093d\02105pa.dgn  
 koester.gi=" DATE

CONTRACT NO. 98955

ATE	SECTION	COUNTY	TOTAL SHEETS	SHEET NO.
853	(7,8)RS-3	HAMILTON	16	15
FED. ROAD DIST. NO. 7		ILLINOIS	FED. AID PROJECT NO.	

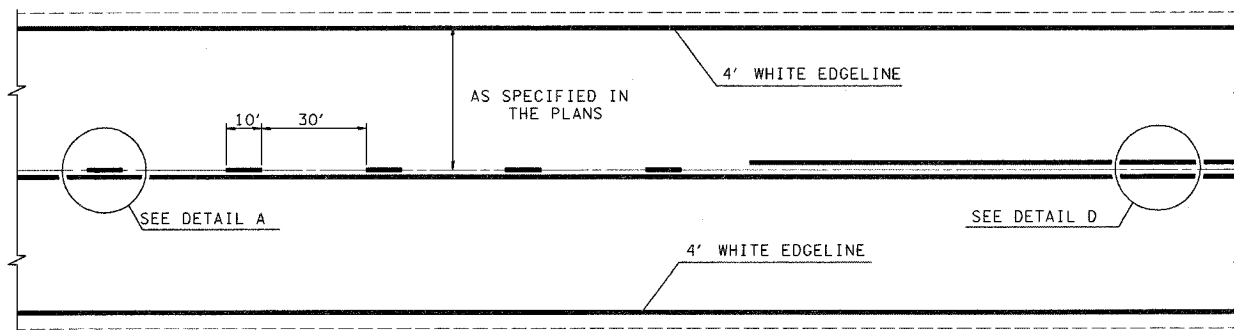

TYPICAL CENTERLINE, NO PASSING ZONE LINE (NPZ) & EDGELINE MARKINGS  
 2-LANE PAVEMENT

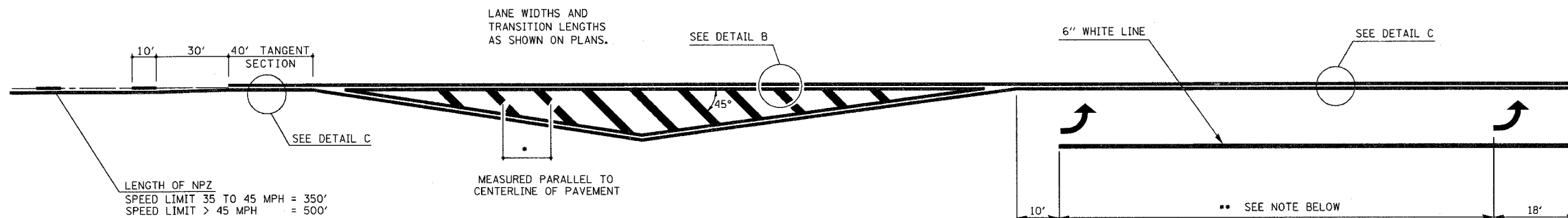

LENGTH OF NPZ  
 SPEED LIMIT 35 TO 45 MPH = 350'  
 SPEED LIMIT > 45 MPH = 500'

\*DIAGONAL SPACING  
 SPEED LIMIT < 30 MPH = 15'  
 SPEED LIMIT 30 TO 45 MPH = 20'  
 SPEED LIMIT > 45 MPH = 30'

\*\* PLACE THE FIRST ARROW EVEN WITH THE BEGINNING OF THE TURN BAY.  
 PLACE ANOTHER ARROW 18' BACK FROM THE STOP BAR, IF REQUIRED.  
 ADD ADDITIONAL ARROWS TO MAINTAIN A MAXIMUM OF 80' SPACING.

NOTES:

1. OMIT EDGELINE THRU SIDE ROADS.
2. TAPER RATES, LANE WIDTHS, AND STORAGE LENGTHS AS SHOWN ON THE PLANS.
3. WHEN MEDIANS ARE PRESENT, PLACE A SINGLE YELLOW STRIPE AROUND ITS PERIMETER.

NOT TO SCALE

ILLINOIS DEPARTMENT OF TRANSPORTATION

TYPICAL APPLICATION OF PAVEMENT MARKINGS  
 SHEET 1 OF 2

SCALE: VERT. DATE  
 HORIZ. DATE  
 DRAWN BY  
 ISSUED: 05-06-96 CHECKED BY

REVISIONS	
NAME	DATE
MMO	12-99
DRM	08-04

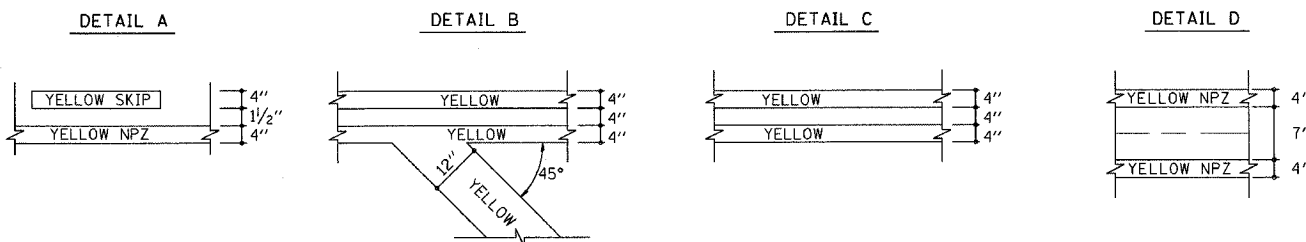

1 2 3 4 5 6 7 8 9 3/27/2006  
 11 12 13 14 15 16 17 18  
 19 20 21 22 23 24 25 26  
 27 28 29 30 31 32 33 34  
 35 36 37 38 39 40 41 42 43 44 45  
 46 47 48 49 50 51 52 53 54  
 55 56 57 58 59 60 61 62 63

c:\projects\74093cd\02105pa.dgn  
 Koester\j... DATE

CONTRACT NO. 98955

ATE	SECTION	COUNTY	TOTAL SHEETS	SHEET NO.
853	(7,8)RS-3	HAMILTON	16	16
FED. ROAD DIST. NO. 7		ILLINOIS	FED. AID PROJECT NO.	

•• PLACE THE FIRST ARROW EVEN WITH THE BEGINNING OF THE TURN BAY.  
 PLACE ANOTHER ARROW 18' BACK FROM THE STOP BAR, IF REQUIRED.  
 ADD ADDITIONAL ARROWS TO MAINTAIN A MAXIMUM OF 80' SPACING.

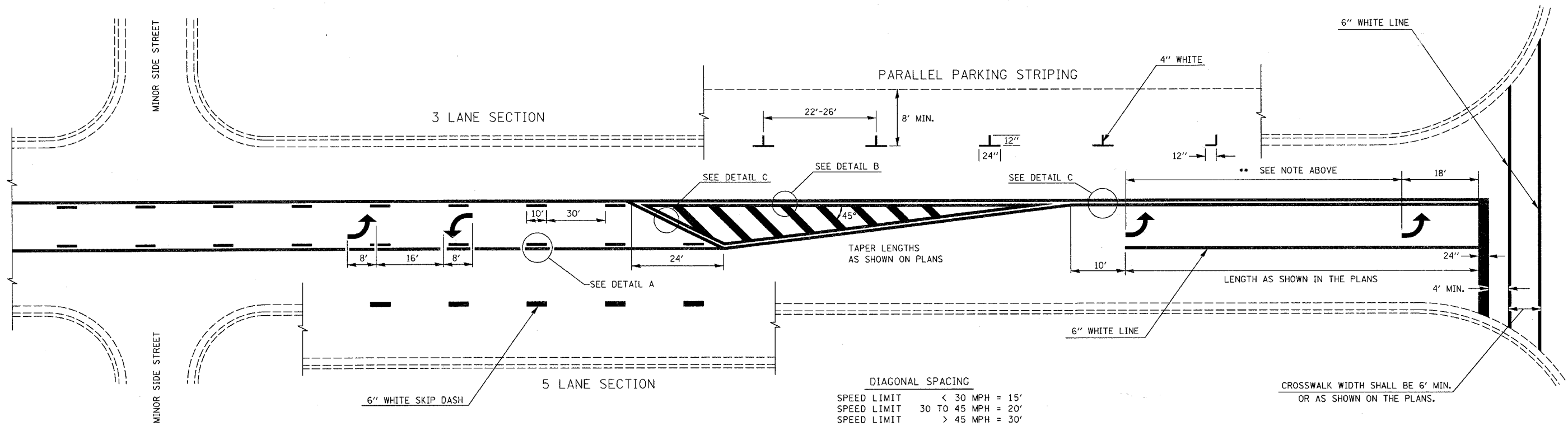

DIAGONAL SPACING

SPEED LIMIT	< 30 MPH	= 15'
SPEED LIMIT	30 TO 45 MPH	= 20'
SPEED LIMIT	> 45 MPH	= 30'

CROSSWALK WIDTH SHALL BE 6' MIN.  
 OR AS SHOWN ON THE PLANS.

TYPICAL BI-DIRECTIONAL TURN LANE MARKINGS  
 (SHOWING TRANSITION TO EXCLUSIVE LEFT TURN LANE)

- NOTES:
1. NO LESS THAN 2 ARROWS SHALL BE USED.
  2. TAPER RATES, LANE WIDTHS, AND STORAGE LENGTHS AS SHOWN ON THE PLANS.
  3. AVOID PLACING BI-DIRECTIONAL ARROWS IN INTERSECTIONS.
  4. BI-DIRECTIONAL ARROWS SHALL BE SPACED A MAXIMUM OF 250'.

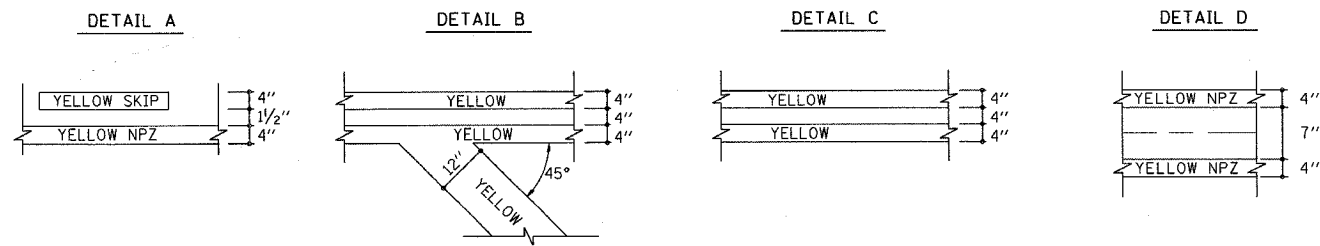

NOT TO SCALE

REVISIONS	
NAME	DATE
MMO	12-99
DRM	08-04

ILLINOIS DEPARTMENT OF TRANSPORTATION  
**TYPICAL APPLICATION OF PAVEMENT MARKINGS**  
**SHEET 2 OF 2**

SCALE: VERT. DATE  
 HORIZ. DRAWN BY  
 CHECKED BY