

REVISIONS		
NUMBER	BY	DATE

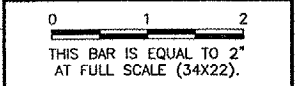

**AURORA MUNICIPAL AIRPORT
 AURORA, ILLINOIS
 CONSTRUCT RUNWAY 33 ILS,
 RELOCATE RUNWAY 9 LOCALIZER**

**RUNWAY 33 MALSR STORMWATER
 POLLUTION PREVENTION PLAN -
 SHEET 1**

© Copyright CMT, Inc.
CMT
 CRAWFORD, MURPHY & TILLY, INC.
 CONSULTING ENGINEERS
 License No. 184-000613

DESIGN BY:	CAL
DRAWN BY:	JRO
CHECKED BY:	CAL
APPROVED BY:	
DATE:	05/12/06
JOB No:	04285-04
ILLINOIS PROJECT: ARR-3468	
A.I.P. PROJECT: 3-17-0003-B31	
FINAL SUBMITTAL	
SHEET 10 OF 67 SHEETS	

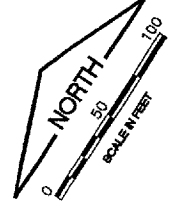
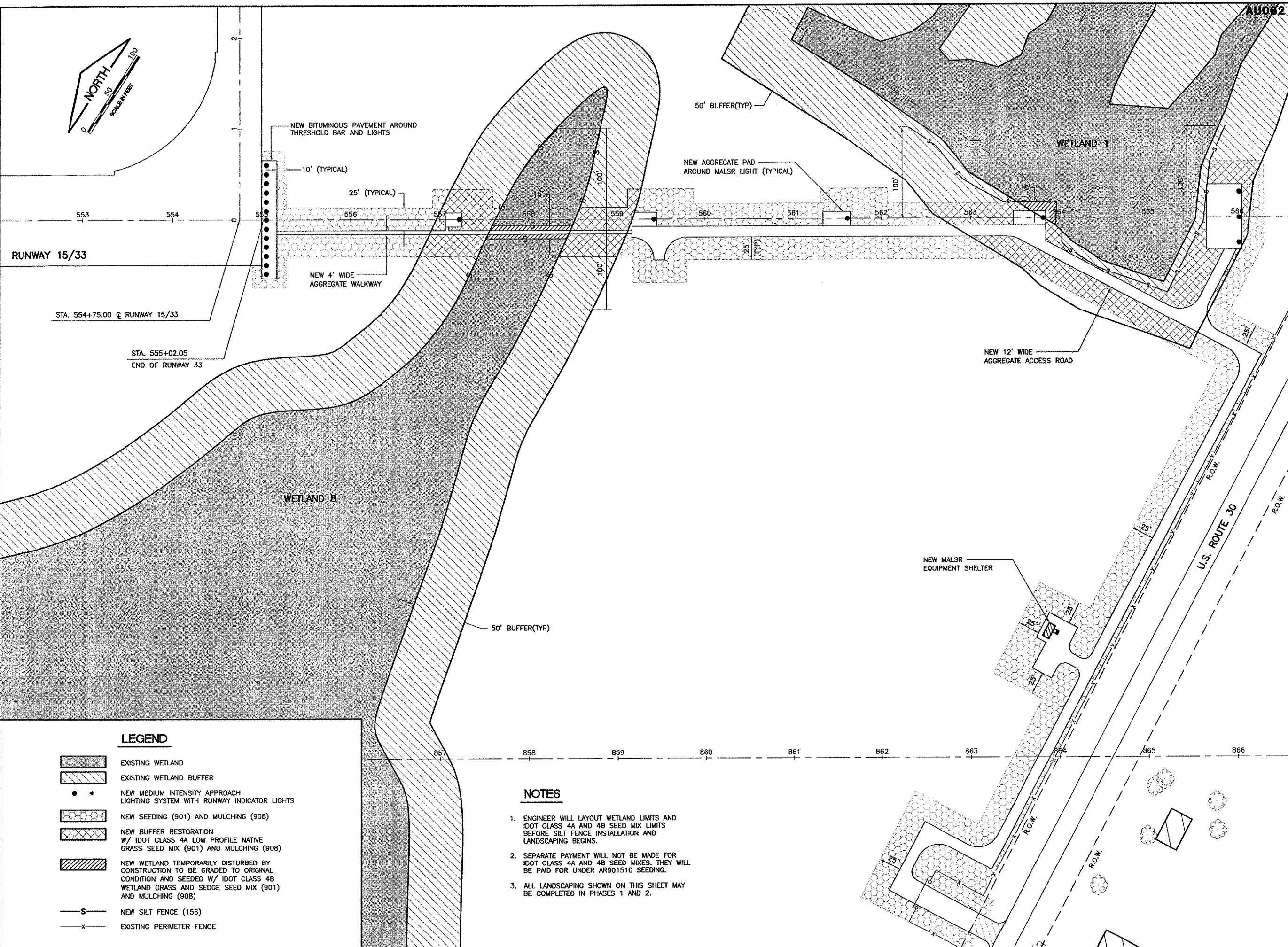

LEGEND

- EXISTING WETLAND
- EXISTING WETLAND BUFFER
- NEW MEDIUM INTENSITY APPROACH LIGHTING SYSTEM WITH RUNWAY INDICATOR LIGHTS
- NEW SEEDING (901) AND MULCHING (908)
- NEW BUFFER RESTORATION W/ IDOT CLASS 4A LOW PROFILE NATIVE GRASS SEED MIX (901) AND MULCHING (908)
- NEW WETLAND TEMPORARILY DISTURBED BY CONSTRUCTION TO BE GRADED TO ORIGINAL CONDITION AND SEEDED W/ IDOT CLASS 4B WETLAND GRASS AND SEDGE SEED MIX (901) AND MULCHING (908)
- NEW SILT FENCE (156)
- EXISTING PERIMETER FENCE

NOTES

1. ENGINEER WILL LAYOUT WETLAND LIMITS AND IDOT CLASS 4A AND 4B SEED MIX LIMITS BEFORE SILT FENCE INSTALLATION AND LANDSCAPING BEGINS.
2. SEPARATE PAYMENT WILL NOT BE MADE FOR IDOT CLASS 4A AND 4B SEED MIXES. THEY WILL BE PAID FOR UNDER AR901510 SEEDING.
3. ALL LANDSCAPING SHOWN ON THIS SHEET MAY BE COMPLETED IN PHASES 1 AND 2.