

TYPICAL EAR DETAIL
"NOT TO SCALE"

- LEGEND**
- PROPOSED CONCRETE PAVEMENT
 - EXISTING PAVEMENT
 - PAVEMENT AREA TO BE REINFORCED WITH WIRE MESH 6"x6" (W5xW5)
 - CONSTRUCTION JOINT WITH DOWELS - TYPE D
 - LONGITUDINAL CONTRACTION JOINT WITH TIE BARS - TYPE G HINGED
 - TRANSVERSE CONTRACTION JOINT WITH DOWELS - TYPE F
 - TRANSVERSE CONTRACTION JOINT WITHOUT DOWELS - TYPE H
 - THICKENED EDGE EXPANSION JOINT - TYPE B
 - THICKENED EDGE EXPANSION JOINT - TYPE E
 - DOWELED EXPANSION JOINT - TYPE A
- NOTE:**
DIMENSIONING OF PROPOSED TRANSVERSE JOINTS ARE APPROXIMATE, BUT THE PROPOSED TRANSVERSE JOINTS WILL BE ALIGNED WITH THE EXISTING TRANSVERSE JOINT.

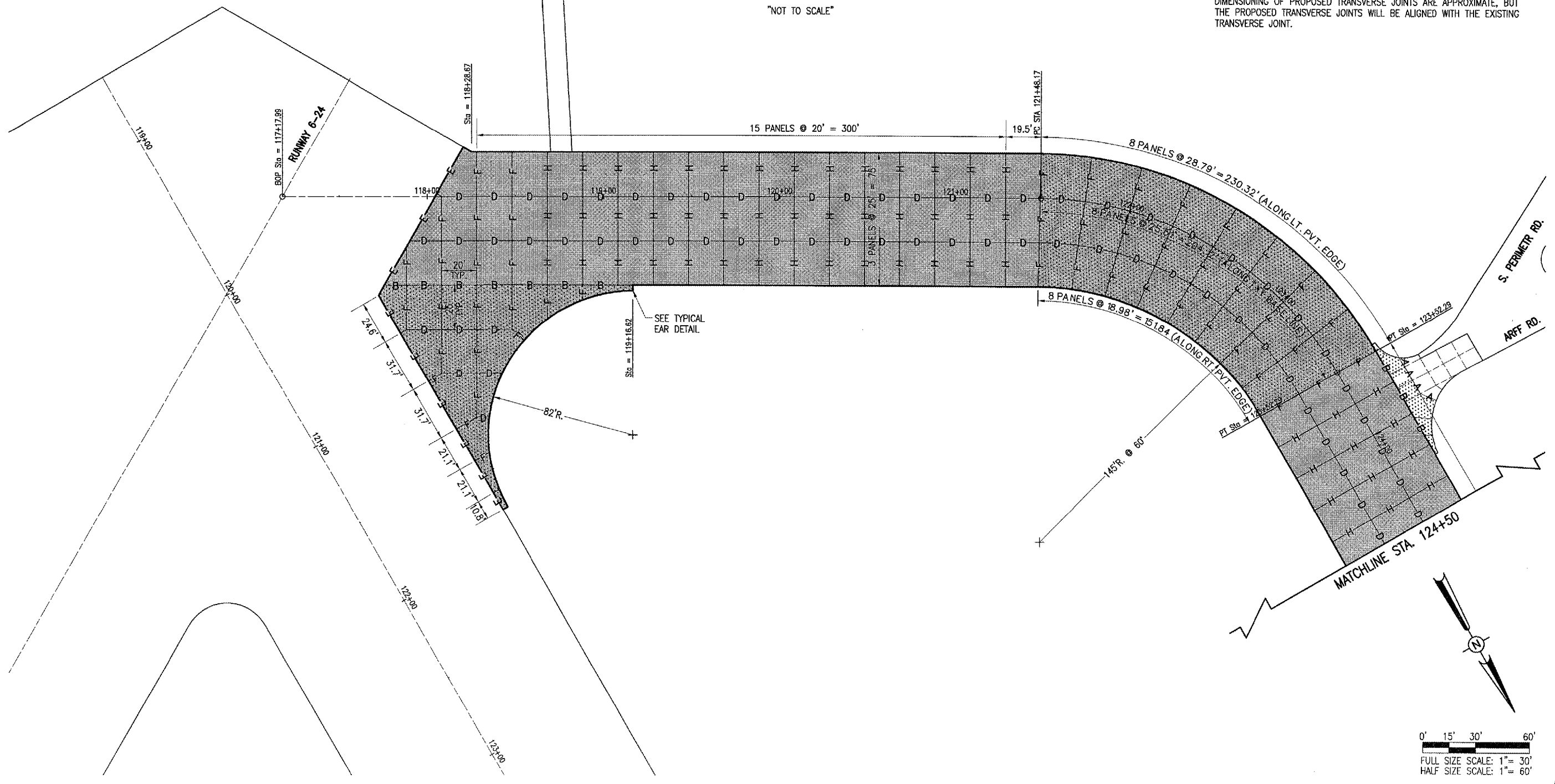

APR 27, 2006 11:02 PM RAW
I:\AIRPORTS\DECATUR\802-06TAXY\AIRPORT\SHEETS\R-161JUNT.DWG - Sheet 13

DATE	REVISION	BY

DECATUR, ILLINOIS
A.I.P. PROJ.: 3-17-00
IL PROJ.: DEC-3588

802-06TAXY.DWG	03/08/06
R-161JUNT.DWG	03/08/06
1"=30'	03/08/06
03/08/06	03/31/06

HANSON
Hanson Professional Services Inc.
1525 South Sixth Street
Springfield, Illinois 62705-2886
Offices Nationwide

TAXIWAY "C"
RECONSTRUCTION
PROPOSED JOINTING PLAN
STA. 118+04.56 TO STA. 124+50