

MALSR ROADS NOTE

UPON UNDERCUTTING THE UNCLASSIFIED EXCAVATION FOR THE PROPOSED ROAD BEDS, THE CONTRACTOR WILL FOLLOW THE UNCLASSIFIED EXCAVATION SUPPLEMENTAL SPECIFICATIONS TO PROVIDE A FIRM AND STABLE BASE PRIOR TO THE PLACEMENT OF ANY CRUSHED AGGREGATE. NO COMPACTION TEST WILL BE REQUIRED FOR THE EARTH SUB-BASE OR THE CRUSHED AGGREGATE. BOTH SURFACES WILL BE SMOOTH DRUM ROLLED TO THE SATISFACTION OF THE RESIDENT ENGINEER.

THE CRUSHED AGGREGATE FOR THESE ROADS WILL NOT REQUIRE A PUG-MILL. HOWEVER, IF AT THE TIME THE AGGREGATES ARE WEIGHED THEY CONTAIN MORE THAN SIX (6) PERCENT OF ABSORBED AND FREE MOISTURE BY WEIGHT, A DEDUCTION FOR THE MOISTURE IN EXCESS OF THIS AMOUNT SHALL BE MADE IN DETERMINING THE PAY QUANTITY.

DK050

APR 13, 2006 3:53 PM CAH I:\AIRPORTS\DEKALB\803-05TXXA\AIRPORT\SHEETS\RWY -2\R-101SIT.DWG

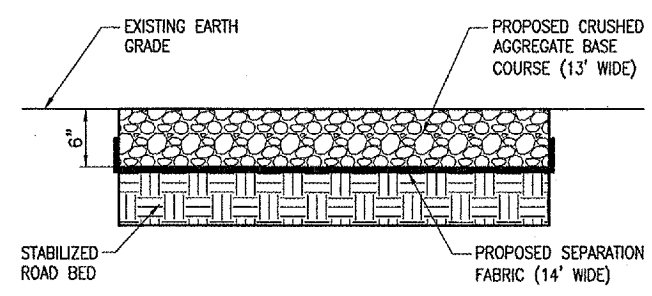
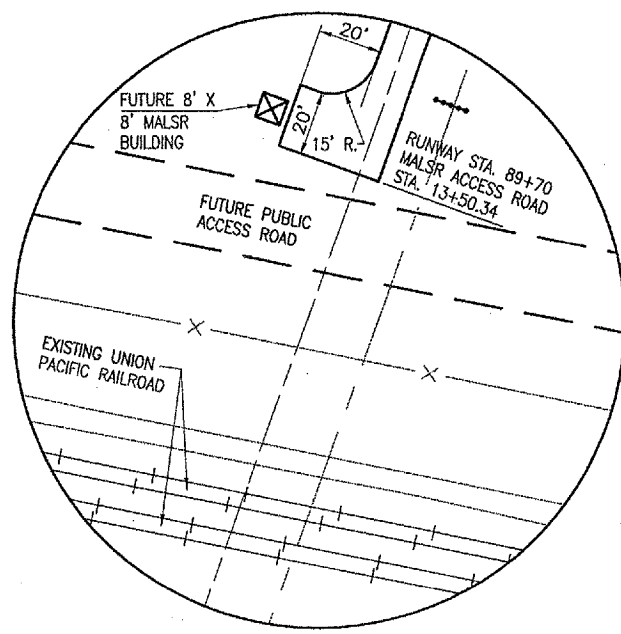
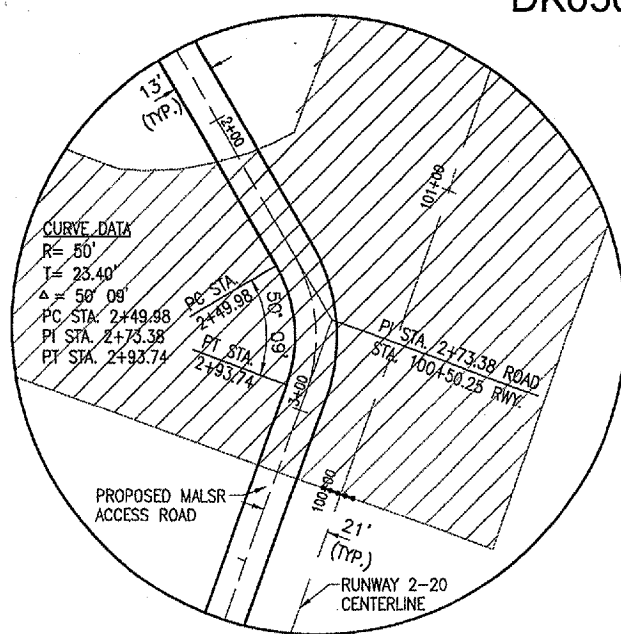
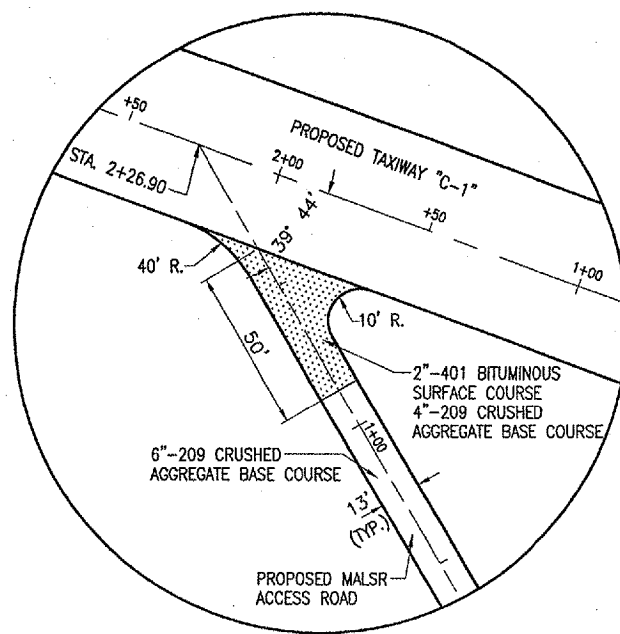
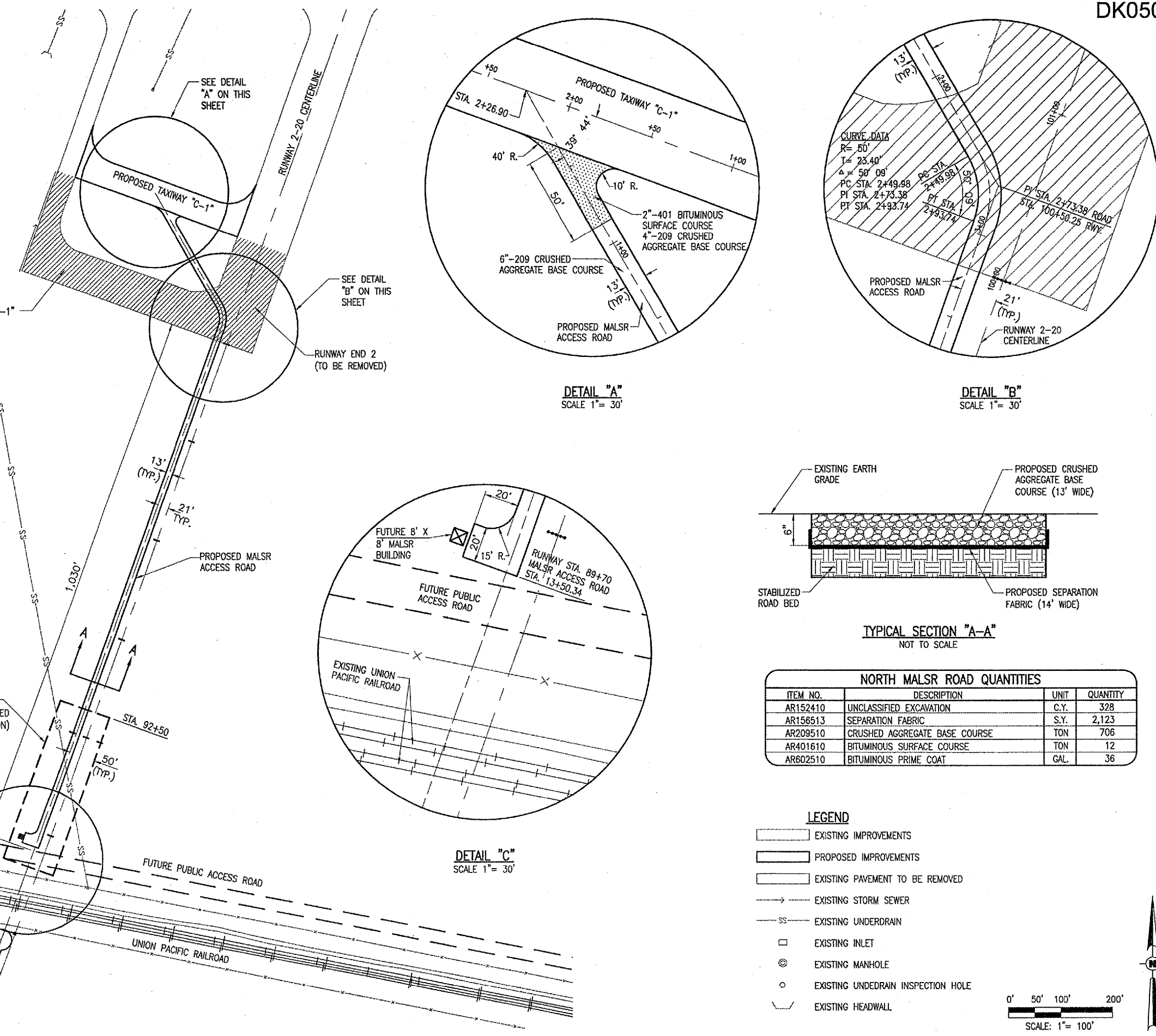

NORTH MALSR ROAD QUANTITIES			
ITEM NO.	DESCRIPTION	UNIT	QUANTITY
AR152410	UNCLASSIFIED EXCAVATION	C.Y.	328
AR156513	SEPARATION FABRIC	S.Y.	2,123
AR209510	CRUSHED AGGREGATE BASE COURSE	TON	706
AR401610	BITUMINOUS SURFACE COURSE	TON	12
AR602510	BITUMINOUS PRIME COAT	GAL.	36

- LEGEND**
- EXISTING IMPROVEMENTS
 - PROPOSED IMPROVEMENTS
 - EXISTING PAVEMENT TO BE REMOVED
 - EXISTING STORM SEWER
 - EXISTING UNDERDRAIN
 - EXISTING INLET
 - EXISTING MANHOLE
 - EXISTING UNDERAIN INSPECTION HOLE
 - EXISTING HEADWALL

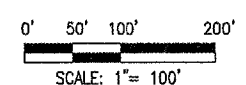

<p>FILE PROJECT NO. 80305TXXAD_0800 FILENAME R-101SIT.DWG SCALE 1" = 100' DATE 01/06/04</p>	<p>LAYOUT KDM 01/06/04 DRAWN BAK 01/06/04 REVIEWED CAH 02/22/06</p>	<p>DTMAX DEKALB TAYLOR MUNICIPAL AIRPORT</p>	<p>BY REVISION DATE</p>
<p>HANSON Hanson Professional Services Inc. 1525 South Sixth Street Springfield, Illinois 62769-2886 Offices Nationwide</p>		<p>REMOVE AND REGRADE RUNWAY END 2 PROPOSED MALSR ROAD (NORTH)</p>	<p>IL PROJ.: 3-17-0139-B42 IL PROJ.: DKB-3448</p>
<p>35 35 of 224 sheets</p>			