



HANSON PROFESSIONAL SERVICES INC.

815 Commerce Drive, Suite 200
Oak Brook, Illinois 60523
Telephone: 630.990.3800
Fax: 630.990.3801



JOLIET REGIONAL PORT DISTRICT

1 Hangar Road
Romeoville, Illinois 60446
Telephone: 815.638.9497
Fax: 815.838.9524

CONSTRUCT RUNWAY 2-20
DRAINAGE CULVERTS AND
IMPROVEMENTS

AIP PROJECT NO. 3-17-0140-B40
IDA PROJECT NO. LOT-3596

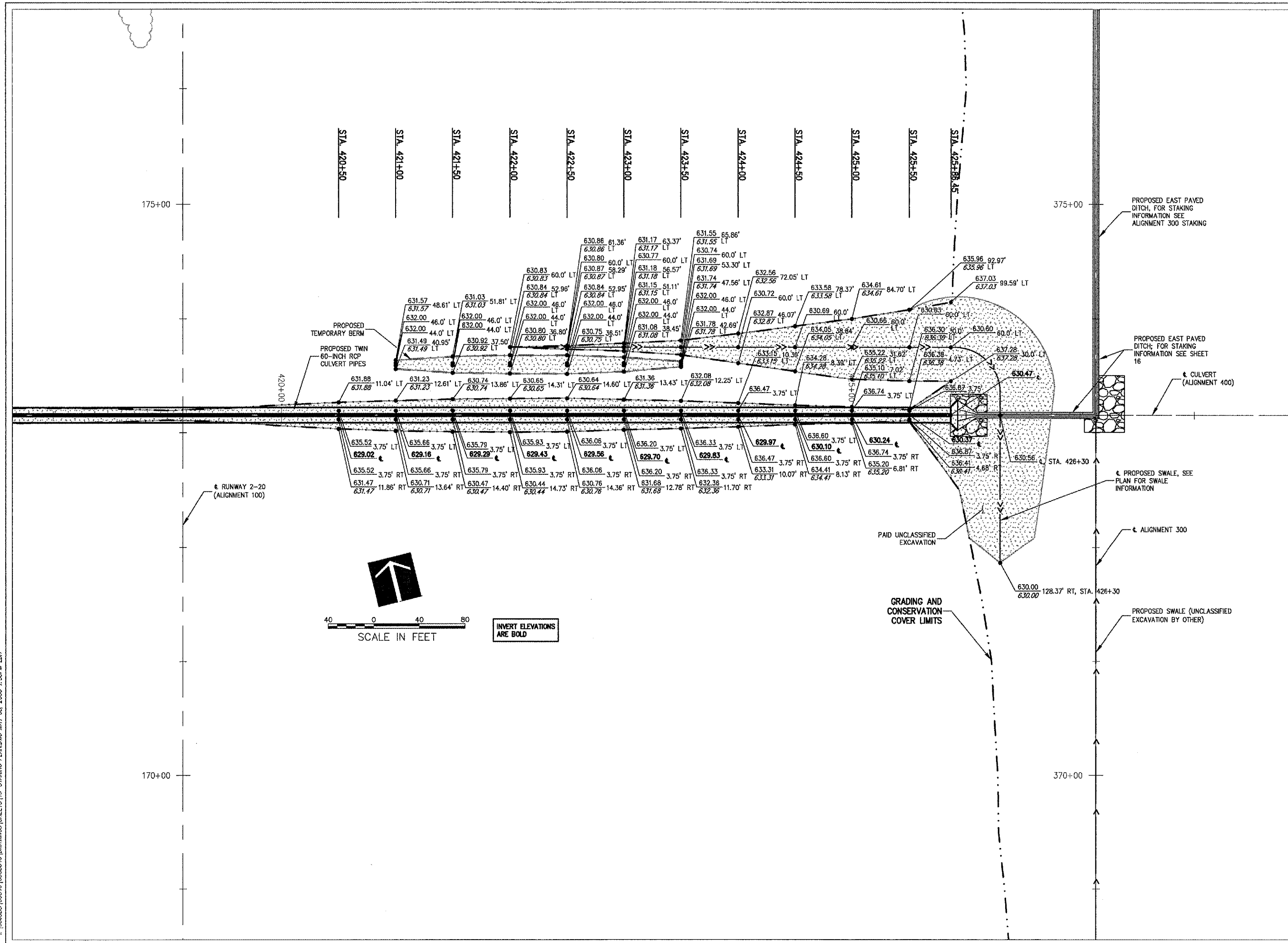

PROPOSED EAST PAVED
DITCH, FOR STAKING
INFORMATION SEE
ALIGNMENT 300 STAKING

PROPOSED EAST PAVED
DITCH, FOR STAKING
INFORMATION SEE SHEET
16

CULVERT
(ALIGNMENT 400)

PROPOSED SWALE, SEE
PLAN FOR SWALE
INFORMATION

ALIGNMENT 300

PROPOSED SWALE (UNCLASSIFIED
EXCAVATION BY OTHER)

PAID UNCLASSIFIED
EXCAVATION

GRADING AND
CONSERVATION
COVER LIMITS

175+00

375+00

170+00

370+00

SCALE IN FEET
0 40 80

INVERT ELEVATIONS
ARE BOLD

No.	Drawing Issue Description	Date	By

Date
MAY 5, 2006

Sheet Title
**STAKING PLAN
ALIGNMENT 400
STA 421+00 TO STA 428+00
AND BASIN 5
IMPROVEMENTS**

840-05C8046
Project Number
LDH 10/06/05
Layout By Date
LDH 10/06/05
Designed By Date
RME 05/05/06
Reviewed By Date
LDH
Drawn By

P:\05C085\05C8046\DRAWINGS\DRAININGS\SHEETS\15-STAKING PLAN\LDH MAY 05, 2006 1:53PM LDH