

STATE OF ILLINOIS
DEPARTMENT OF TRANSPORTATION

F.A.U. RTE.	SECTION	COUNTY	TOTAL SHEETS	SHEET NO.
1587	(3096A,3097&3098)RS-5	COOK	38	1
FED. ROAD DIST. NO.	ILLINOIS	CONTRACT NO. 62C58		

FOR INDEX OF SHEETS, SEE SHEET NO. 2

PROPOSED HIGHWAY PLANS

F.A.U. 1587 (MCCARTHY RD.)
LOCATION 1: CASS ST. TO BARTON DR.
LOCATION 2: IL 171 (ARCHER AVE.) TO US 45 (96TH AVE.)
SECTION (3096A,3097&3098)RS-5
RESURFACING (3P)
COOK COUNTY
C-91-365-16
PROJECT: STP-1587(008)

THE IMPROVEMENT IS LOCATED WITHIN
THE VILLAGES OF LEMONT AND PALOS PARK

TRAFFIC DATA

2014 ADT - 15,600
POSTED SPEED LIMIT - 40 MPH TO 55 MPH

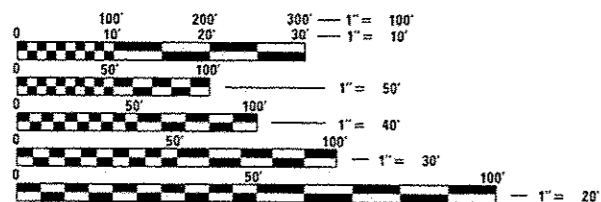
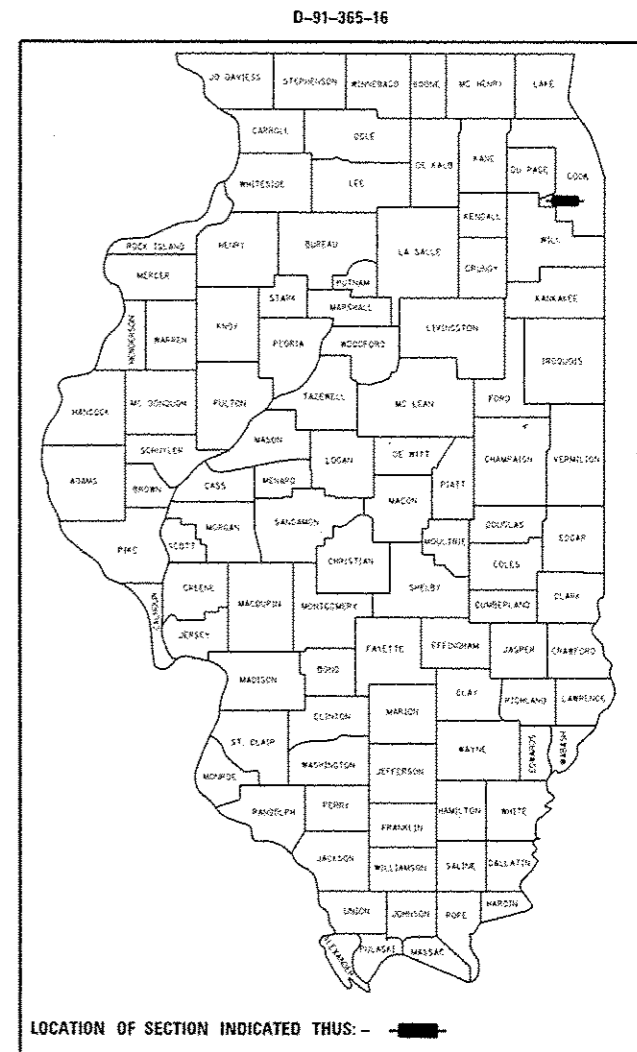

FULL SIZE PLANS HAVE BEEN PREPARED USING STANDARD ENGINEERING SCALES. REDUCED SIZED PLANS WILL NOT CONFORM TO STANDARD SCALES. IN MAKING MEASUREMENTS ON REDUCED PLANS, THE ABOVE SCALES MAY BE USED.

J.U.L.I.E.
JOINT UTILITY LOCATION INFORMATION FOR EXCAVATION
1-800-892-0123
OR 811

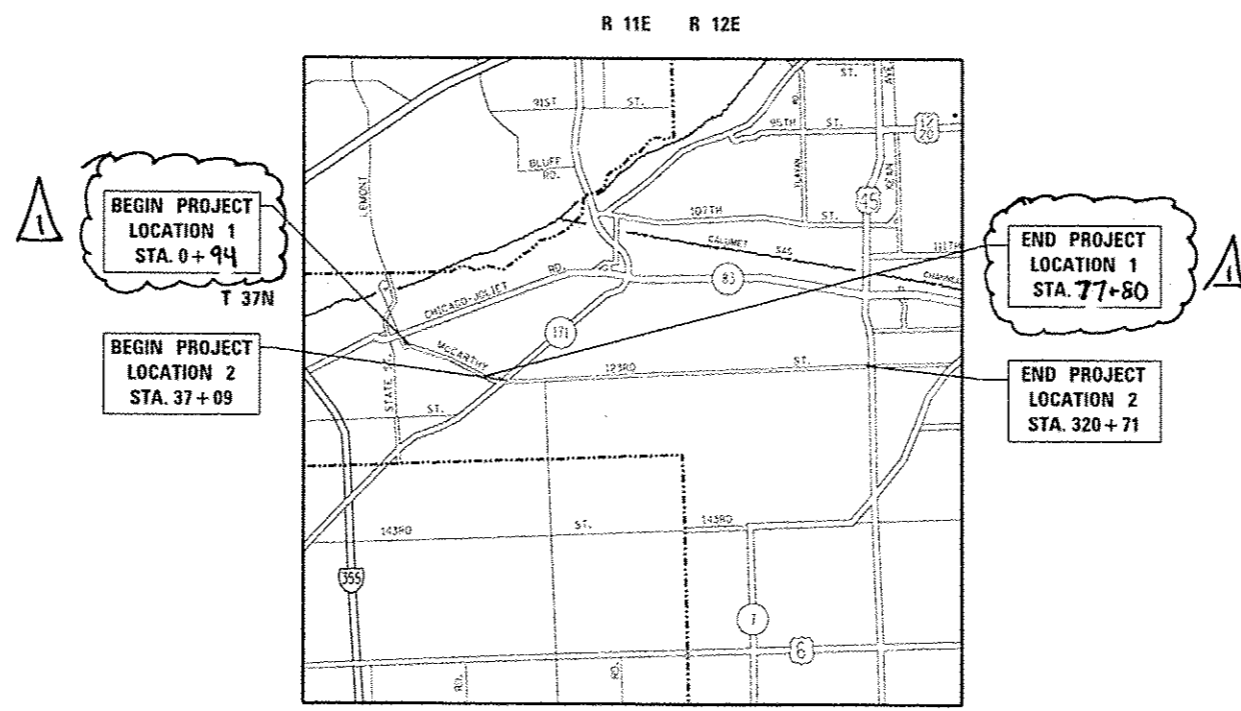

LEMONT & PALOS TOWNSHIPS

PROJECT ENGINEER: JENPAI CHANG (847) 705-4432
PROJECT MANAGER: KEN ENG (847) 702-4247

CONTRACT NO. 62C58

GROSS LENGTH OF PROJECT = 36,045 FT = 6.83 MI.
NET LENGTH OF PROJECT = 36,045 FT = 6.83 MI.

STATE OF ILLINOIS
DEPARTMENT OF TRANSPORTATION

SUBMITTED *April 7 2017*
Anthony J. DeB...
REGIONAL ENGINEER

May 12 2017
Maureen M. Addis
ENGINEER OF DESIGN AND ENVIRONMENT

May 12 2017
Frankie...
DIRECTOR OF PROGRAM DEVELOPMENT

PRINTED BY THE AUTHORITY
OF THE STATE OF ILLINOIS

REV 6-7-17

URBAN

URBAN

SUMMARY OF QUANTITIES			CONSTRUCTION TYPE CODE		
CODE NO	ITEM	UNIT	TOTAL QUANTITIES	80/20 (FED/STATE) ROADWAY LOC 1 0005	80/20 (FED/STATE) ROADWAY LOC 2 0005
40600290	BITUMINOUS MATERIALS (TACK COAT)	POUND	88481	18940	69541
40600400	MIXTURE FOR CRACKS, JOINTS, AND FLANGEWAYS	TON	190	42	148
40600827	POLYMERIZED LEVELING BINDER (MACHINE METHOD), IL-4, 75, N50	TON	5446	1191	4255
40600982	HOT-MIX ASPHALT SURFACE REMOVAL - BUTT JOINT	SQ YD	1318	259	1059
40601005	HOT-MIX ASPHALT REPLACEMENT OVER PATCHES	TON	3623	656	2967
40603340	HOT-MIX ASPHALT SURFACE COURSE, MIX "D", N70	TON	1118	2453	8665
42001300	PROTECTIVE COAT	SQ YD	908	250	658
44000155	HOT MIX ASPHALT SURFACE REMOVAL, 1 1/2"	SQ YD	335	335	
44000158	HOT-MIX ASPHALT SURFACE REMOVAL, 2 1/4"	SQ YD	126931	28813	98118
44002224	HOT-MIX ASPHALT REMOVAL OVER PATCHES, 6"	SQ YD	13132	2536	10596
44201753	CLASS D PATCHES, TYPE II, 9 INCH	SQ YD	452	167	285
44201757	CLASS D PATCHES, TYPE III, 9 INCH	SQ YD	97	42	55
44201759	CLASS D PATCHES, TYPE IV, 9 INCH	SQ YD	8564	74	8490

SUMMARY OF QUANTITIES			CONSTRUCTION TYPE CODE		
CODE NO	ITEM	UNIT	TOTAL QUANTITIES	80/20 (FED/STATE) ROADWAY LOC 1 0005	80/20 (FED/STATE) ROADWAY LOC 2 0005
48101202	AGGREGATE SHOULDERS, TYPE B	CU YD	750	200	550
60300105	FRAMES AND GRATES TO BE ADJUSTED	EACH	17	7	10
60300305	FRAMES AND LIDS TO BE ADJUSTED	EACH	10	8	2
63000001	STEEL PLATE BEAM GUARDRAIL, TYPE A, 6 FOOT POSTS	FOOT	450	250	200
63100167	TRAFFIC BARRIER TERMINAL, TYPE I (SPECIAL) TANGENT	EACH	6	3	3
63200310	GUARDRAIL REMOVAL	FOOT	435	235	200
67100100	MOBILIZATION	LSUM	1	0.5	0.5
70100450	TRAFFIC CONTROL AND PROTECTION, STANDARD 701201	LSUM	1	0.5	0.5
70100460	TRAFFIC CONTROL AND PROTECTION, STANDARD 701306	LSUM	1	0.5	0.5
70102620	TRAFFIC CONTROL AND PROTECTION, STANDARD 701501	LSUM	1	0.5	0.5
70300100	SHORT TERM PAVEMENT MARKING	FOOT	18524	2516	16008
70300150	SHORT TERM PAVEMENT MARKING REMOVAL	SQ FT	7014	1678	5336
70300210	TEMPORARY PAVEMENT MARKING LETTERS AND SYMBOLS	SQ FT	999	271	728

*SPECIALTY ITEMS

DESIGNED	REVISOR
DRAWN	REVISION
CHECKED	REVISION
DATE	REVISION

STATE OF ILLINOIS DEPARTMENT OF TRANSPORTATION

SUMMARY OF QUANTITIES

F.A.U. RITE	SECTION	COUNTY	TOTAL SHEET NO.
1587	(3096A,3097&3098RS-5	COOK	38 3
			CONTRACT NO. 62C58

SCALE: SHEET NO. OF SHEETS STA. TO STA.

REV 6-7-17

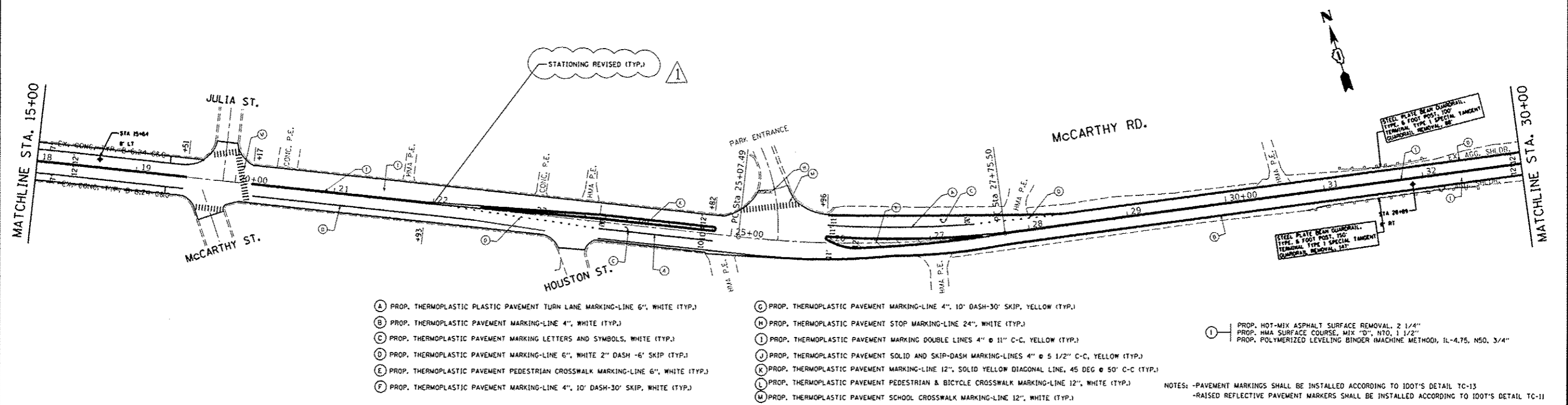
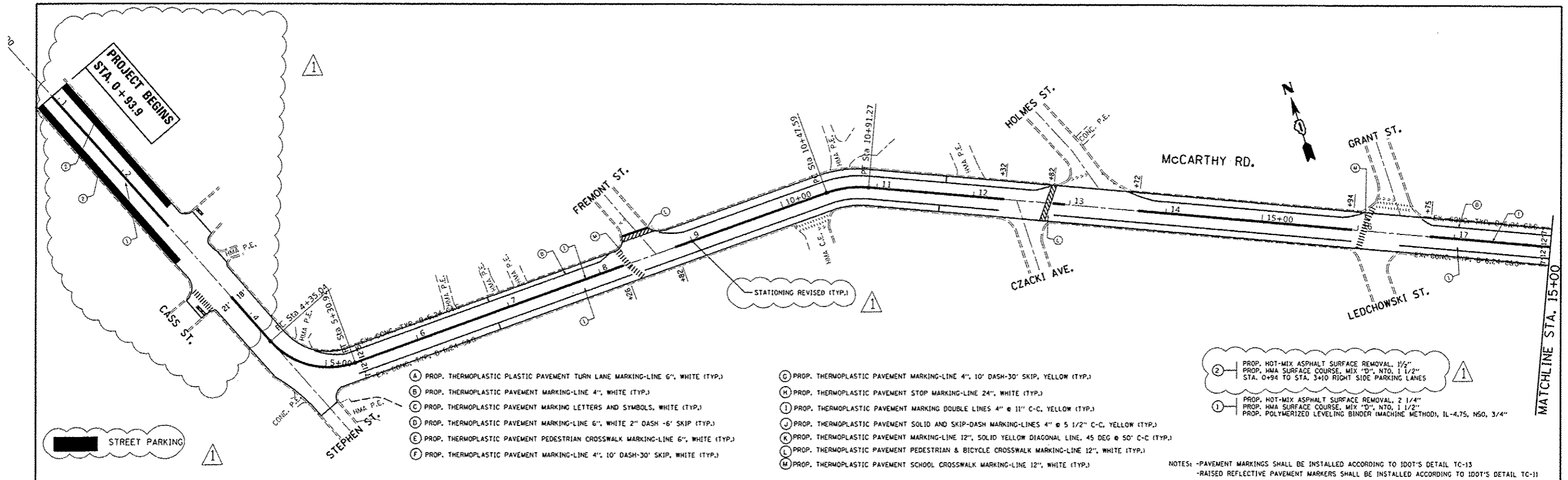

FILE NAME: c:\pwork\p1dot\qurashya\10249653\1016-shr-plan.dgn	USER NAME: qurashya	DESIGNED: -	REVISED: - 5/25/2017	STATE OF ILLINOIS DEPARTMENT OF TRANSPORTATION	ROADWAY PLAN MCCARTHY RD. (STEPHEN ST. TO BARTON DR.)		F.A.U. RTE.: 1507	SECTION: (3096A,3097&3098)RS-5	COUNTY: COOK	TOTAL SHEETS: 38	SHEET NO.: 8	
Default	PLOT SCALE: 1/8"=1'-0"	CHECKED: -	REVISED: -		SCALE: 1"=50'	SHEET OF SHEETS: STA. 0+73.2 TO STA. 15+00	ILLINOIS FED. AID PROJECT		CONTRACT NO. 62C58			
	PLOT DATE: 5/25/2017	DATE: -	REVISED: -									

REV 6-7-17

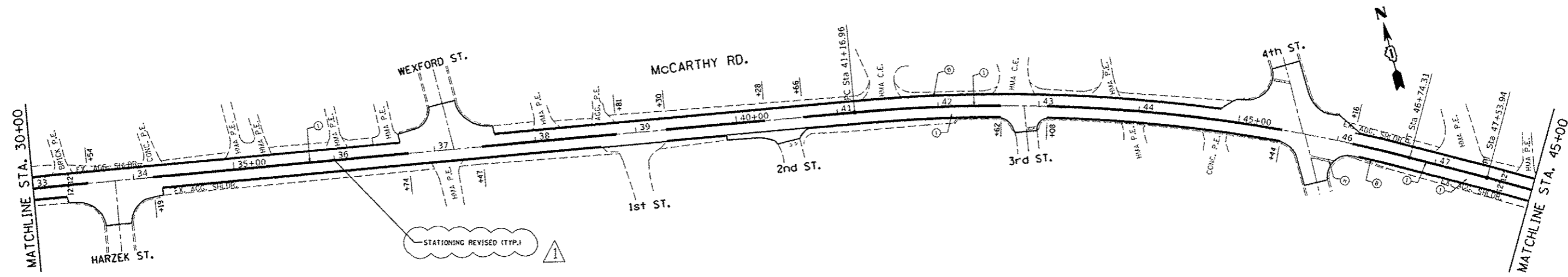

- (A) PROP. THERMOPLASTIC PLASTIC PAVEMENT TURN LANE MARKING-LINE 6", WHITE (TYP.)
- (B) PROP. THERMOPLASTIC PAVEMENT MARKING-LINE 4", WHITE (TYP.)
- (C) PROP. THERMOPLASTIC PAVEMENT MARKING LETTERS AND SYMBOLS, WHITE (TYP.)
- (D) PROP. THERMOPLASTIC PAVEMENT MARKING-LINE 6", WHITE 2" DASH -6' SKIP (TYP.)
- (E) PROP. THERMOPLASTIC PAVEMENT PEDESTRIAN CROSSWALK MARKING-LINE 6", WHITE (TYP.)
- (F) PROP. THERMOPLASTIC PAVEMENT MARKING-LINE 4", 10' DASH-30' SKIP, WHITE (TYP.)
- (G) PROP. THERMOPLASTIC PAVEMENT MARKING-LINE 4", 10' DASH-30' SKIP, YELLOW (TYP.)
- (H) PROP. THERMOPLASTIC PAVEMENT STOP MARKING-LINE 24", WHITE (TYP.)
- (I) PROP. THERMOPLASTIC PAVEMENT MARKING DOUBLE LINES 4" @ 11" C-C, YELLOW (TYP.)
- (J) PROP. THERMOPLASTIC PAVEMENT SOLID AND SKIP-DASH MARKING-LINES 4" @ 5 1/2" C-C, YELLOW (TYP.)
- (K) PROP. THERMOPLASTIC PAVEMENT MARKING-LINE 12", SOLID YELLOW DIAGONAL LINE, 45 DEG @ 50' C-C (TYP.)
- (L) PROP. THERMOPLASTIC PAVEMENT PEDESTRIAN & BICYCLE CROSSWALK MARKING-LINE 12", WHITE (TYP.)
- (M) PROP. THERMOPLASTIC PAVEMENT SCHOOL CROSSWALK MARKING-LINE 12", WHITE (TYP.)

(I) PROP. HOT-MIX ASPHALT SURFACE REMOVAL, 2 1/4"
 PROP. HMA SURFACE COURSE, MIX "D", N70, 1 1/2"
 PROP. POLYMERIZED LEVELING BINDER (MACHINE METHOD), IL-4.75, N50, 3/4"

NOTES: -PAVEMENT MARKINGS SHALL BE INSTALLED ACCORDING TO IDOT'S DETAIL TC-13
 -RAISED REFLECTIVE PAVEMENT MARKERS SHALL BE INSTALLED ACCORDING TO IDOT'S DETAIL TC-11

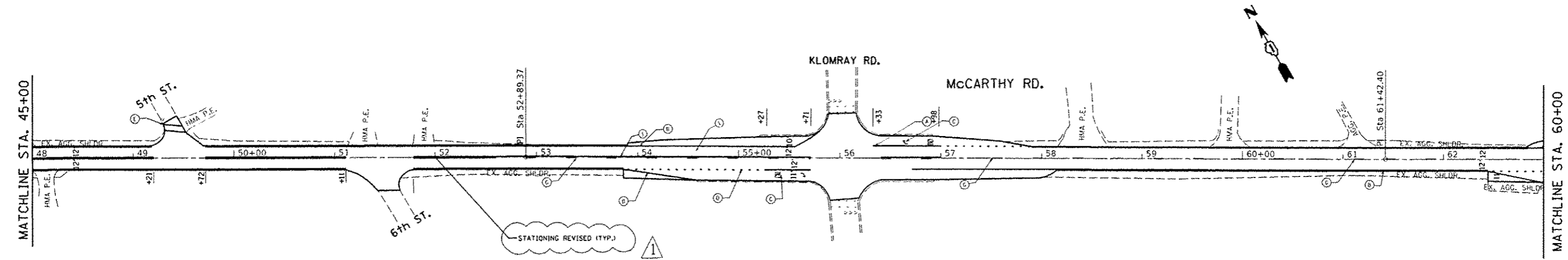

- (A) PROP. THERMOPLASTIC PLASTIC PAVEMENT TURN LANE MARKING-LINE 6", WHITE (TYP.)
- (B) PROP. THERMOPLASTIC PAVEMENT MARKING-LINE 4", WHITE (TYP.)
- (C) PROP. THERMOPLASTIC PAVEMENT MARKING LETTERS AND SYMBOLS, WHITE (TYP.)
- (D) PROP. THERMOPLASTIC PAVEMENT MARKING-LINE 6", WHITE 2" DASH -6' SKIP (TYP.)
- (E) PROP. THERMOPLASTIC PAVEMENT PEDESTRIAN CROSSWALK MARKING-LINE 6", WHITE (TYP.)
- (F) PROP. THERMOPLASTIC PAVEMENT MARKING-LINE 4", 10' DASH-30' SKIP, WHITE (TYP.)
- (G) PROP. THERMOPLASTIC PAVEMENT MARKING-LINE 4", 10' DASH-30' SKIP, YELLOW (TYP.)
- (H) PROP. THERMOPLASTIC PAVEMENT STOP MARKING-LINE 24", WHITE (TYP.)
- (I) PROP. THERMOPLASTIC PAVEMENT MARKING DOUBLE LINES 4" @ 11" C-C, YELLOW (TYP.)
- (J) PROP. THERMOPLASTIC PAVEMENT SOLID AND SKIP-DASH MARKING-LINES 4" @ 5 1/2" C-C, YELLOW (TYP.)
- (K) PROP. THERMOPLASTIC PAVEMENT MARKING-LINE 12", SOLID YELLOW DIAGONAL LINE, 45 DEG @ 50' C-C (TYP.)
- (L) PROP. THERMOPLASTIC PAVEMENT PEDESTRIAN & BICYCLE CROSSWALK MARKING-LINE 12", WHITE (TYP.)
- (M) PROP. THERMOPLASTIC PAVEMENT SCHOOL CROSSWALK MARKING-LINE 12", WHITE (TYP.)

(I) PROP. HOT-MIX ASPHALT SURFACE REMOVAL, 2 1/4"
 PROP. HMA SURFACE COURSE, MIX "D", N70, 1 1/2"
 PROP. POLYMERIZED LEVELING BINDER (MACHINE METHOD), IL-4.75, N50, 3/4"

NOTES: -PAVEMENT MARKINGS SHALL BE INSTALLED ACCORDING TO IDOT'S DETAIL TC-13
 -RAISED REFLECTIVE PAVEMENT MARKERS SHALL BE INSTALLED ACCORDING TO IDOT'S DETAIL TC-11

FILE NAME: c:\pwork\p1dot\qureshig\0496453\013	USER NAME: qureshig	DESIGNED: -	REVISED: -	STATE OF ILLINOIS DEPARTMENT OF TRANSPORTATION	ROADWAY PLAN MCCARTHY RD. (STEPHEN ST. TO BARTON DR.)			F.A.J. RTE.: 1587	SECTION: (3096A,3097&3098)RS-5	COUNTY: COOK	TOTAL SHEETS: 39	SHEET NO.: 9
Default	416-shk.p1on.dgn	DRAWN: -	REVISED: -		SCALE: 1"=50'	SHEET OF SHEETS	STA. 30+00 TO STA. 60+00	CONTRACT NO. 62C58 ILLINOIS FED. AID PROJECT				
	PL01 SCALE: 100,0000 7/ in.	CHECKED: -	REVISED: -									
	PL01 DATE: 5/25/2017	DATE: -	REVISED: -									

REV 6-7-17

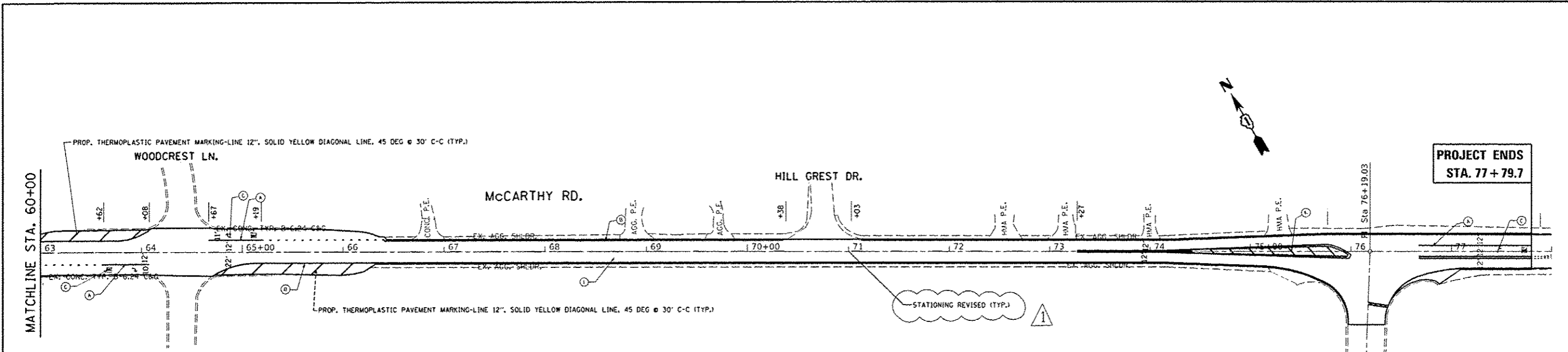

- (A) PROP. THERMOPLASTIC PLASTIC PAVEMENT TURN LANE MARKING-LINE 6", WHITE (TYP.)
- (B) PROP. THERMOPLASTIC PAVEMENT MARKING-LINE 4", WHITE (TYP.)
- (C) PROP. THERMOPLASTIC PAVEMENT MARKING LETTERS AND SYMBOLS, WHITE (TYP.)
- (D) PROP. THERMOPLASTIC PAVEMENT MARKING-LINE 6", WHITE 2" DASH -6' SKIP (TYP.)
- (E) PROP. THERMOPLASTIC PAVEMENT PEDESTRIAN CROSSWALK MARKING-LINE 6", WHITE (TYP.)
- (F) PROP. THERMOPLASTIC PAVEMENT MARKING-LINE 4", 10' DASH-30' SKIP, WHITE (TYP.)

- (G) PROP. THERMOPLASTIC PAVEMENT MARKING-LINE 4", 10' DASH-30' SKIP, YELLOW (TYP.)
- (H) PROP. THERMOPLASTIC PAVEMENT STOP MARKING-LINE 24", WHITE (TYP.)
- (I) PROP. THERMOPLASTIC PAVEMENT MARKING DOUBLE LINES 4" @ 11" C-C, YELLOW (TYP.)
- (J) PROP. THERMOPLASTIC PAVEMENT SOLID AND SKIP-DASH MARKING-LINES 4" @ 5 1/2" C-C, YELLOW (TYP.)
- (K) PROP. THERMOPLASTIC PAVEMENT MARKING-LINE 12", SOLID YELLOW DIAGONAL LINE, 45 DEG @ 50' C-C (TYP.)
- (L) PROP. THERMOPLASTIC PAVEMENT PEDESTRIAN & BICYCLE CROSSWALK MARKING-LINE 12", WHITE (TYP.)
- (M) PROP. THERMOPLASTIC PAVEMENT SCHOOL CROSSWALK MARKING-LINE 12", WHITE (TYP.)

- (1) PROP. HOT-MIX ASPHALT SURFACE REMOVAL, 2 1/4"
PROP. HMA SURFACE COURSE, MIX "D", N70, 1 1/2"
PROP. POLYMERIZED LEVELING BINDER (MACHINE METHOD), IL-4.75, N50, 3/4"

NOTES: -PAVEMENT MARKINGS SHALL BE INSTALLED ACCORDING TO IDOT'S DETAIL TC-13
-RAISED REFLECTIVE PAVEMENT MARKERS SHALL BE INSTALLED ACCORDING TO IDOT'S DETAIL TC-11

FILE NAME c:\p\work\p\work\10495953\1013	USER NAME qreshya	DESIGNED -	REVISED -	STATE OF ILLINOIS DEPARTMENT OF TRANSPORTATION	ROADWAY PLAN MCCARTHY RD. (STEPHEN ST. TO BARTON DR.)	F.A.U. RTE.	SECTION	COUNTY	TOTAL SHEETS	SHEET NO.
	PLOT SCALE 1/8" = 1' / in.	CHECKED -	REVISED -			1587	(3096A,3097&3098)RS-5	COOK	38	10
Default	PLOT DATE 5/25/2017	DATE -	REVISED -	SCALE: 1"=50'		SHEET OF SHEETS		STA. 60+00 TO STA. 71+16.9		CONTRACT NO. 62C58

REV 6-7-17