

FOR INDEX OF SHEETS, SEE SHEET NO. 2

RT. 3 (STATE ST. TO POOL DR.)
 2015 ADT = 4,250 (ACTUAL)
 2017 ADT = 4,300 (ESTIMATED)
 2037 ADT = 5,000 (ESTIMATED)
 SU = 1.9%
 MU = 22.9%

RT. 3 (POOL DR. TO COLE PLACE RD.)
 2015 ADT = 2,900 (ACTUAL)
 2017 ADT = 2,950 (ESTIMATED)
 2037 ADT = 3,400 (ESTIMATED)
 SU = 4.8%
 MU = 14.7%

RT. 3 (COLE PLACE RD. TO MARY'S RIVER)
 2015 ADT = 2,150 (ACTUAL)
 2017 ADT = 2,200 (ESTIMATED)
 2037 ADT = 2,500 (ESTIMATED)
 SU = 10.0%
 MU = 19.8%

RT. 3 (MARY'S RIVER TO END OF PROJECT)
 2015 ADT = 2,850 (ACTUAL)
 2017 ADT = 2,900 (ESTIMATED)
 2037 ADT = 3,300 (ESTIMATED)
 SU = 11.4%
 MU = 23.7%

RT. 3/RT. 150 (OPDYKE ST. TO E. STACY ST.)
 2015 ADT = 3,900 (ACTUAL)
 2017 ADT = 3,950 (ESTIMATED)
 2037 ADT = 4,500 (ESTIMATED)
 SU = 2.1%
 MU = 21.2%

RT. 150 (E. STACY ST. TO MURPHYSBORO RD.)
 2015 ADT = 7,000 (ACTUAL)
 2017 ADT = 7,100 (ESTIMATED)
 2037 ADT = 8,200 (ESTIMATED)
 SU = 5.7%
 MU = 15.0%

RT. 150 (MURPHYSBORO RD. TO END OF PROJECT)
 2015 ADT = 9,000 (ACTUAL)
 2017 ADT = 9,100 (ESTIMATED)
 2037 ADT = 10,500 (ESTIMATED)
 SU = 4.7%
 MU = 12.2%

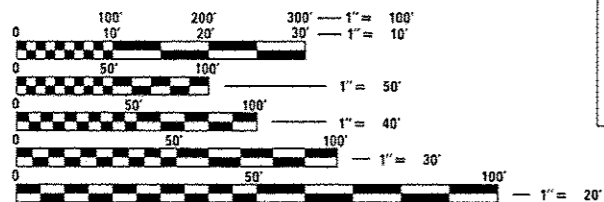

FULL SIZE PLANS HAVE BEEN PREPARED USING STANDARD ENGINEERING SCALES. REDUCED SIZED PLANS WILL NOT CONFORM TO STANDARD SCALES. IN MAKING MEASUREMENTS ON REDUCED PLANS, THE ABOVE SCALES MAY BE USED.

J.U.I.E.
 JOINT UTILITY LOCATION INFORMATION FOR EXCAVATION
 1-800-892-0123
 OR 811

PROJECT ENGINEER: TIM PADGETT (618) 346-3325
 PROJECT MANAGER: JOSHUA VERDUN (618) 346-3196

CONTRACT NO. 76K51

STATE OF ILLINOIS
 DEPARTMENT OF TRANSPORTATION

PROPOSED
 HIGHWAY PLANS

FAP ROUTE 312/861A (IL 31L 150)
 SECTION (75,119,121)PP-1, (119,110)PP-1
 PATCHING
 RANDOLPH COUNTY

C-98-042-17

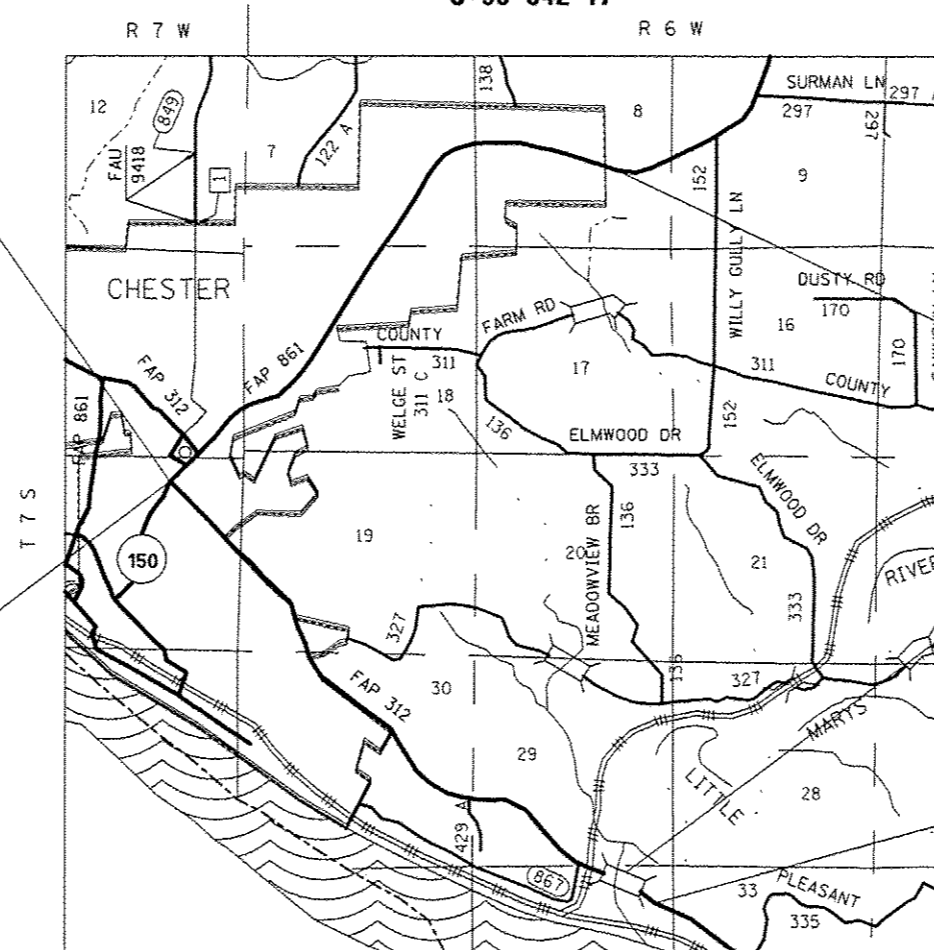

BEGIN PROJECT IL 150
 MP 0.00
 LATITUDE: 37.9121
 LONGITUDE: -89.8235

BEGIN PROJECT IL 3
 MP 0.00
 LATITUDE: 37.9121
 LONGITUDE: -89.8235



END PROJECT IL 150
 MP 2.94
 LATITUDE: 37.9351
 LONGITUDE: -89.7879

BRIDGE OMISSION
 SN 079-0011
 MP 2.91 TO M.P. 2.98

END PROJECT IL 3
 MP 3.08
 LATITUDE: 37.8835
 LONGITUDE: -89.7827

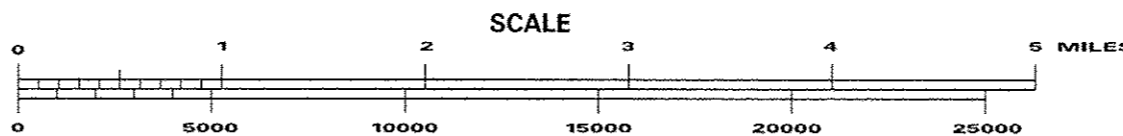

GROSS LENGTH = 31,786 FT. = 6.02 MILES
 NET LENGTH = 31,420 FT. = 5.95 MILES

F.A.P. RTE.	SECTION	COUNTY	TOTAL SHEETS	SHEET NO.
312/861A	(75,119,121)PP-1, (119,110)PP-1	RANDOLPH	12	1
		ILLINOIS	CONTRACT NO. 76K51	

D-98-075-17

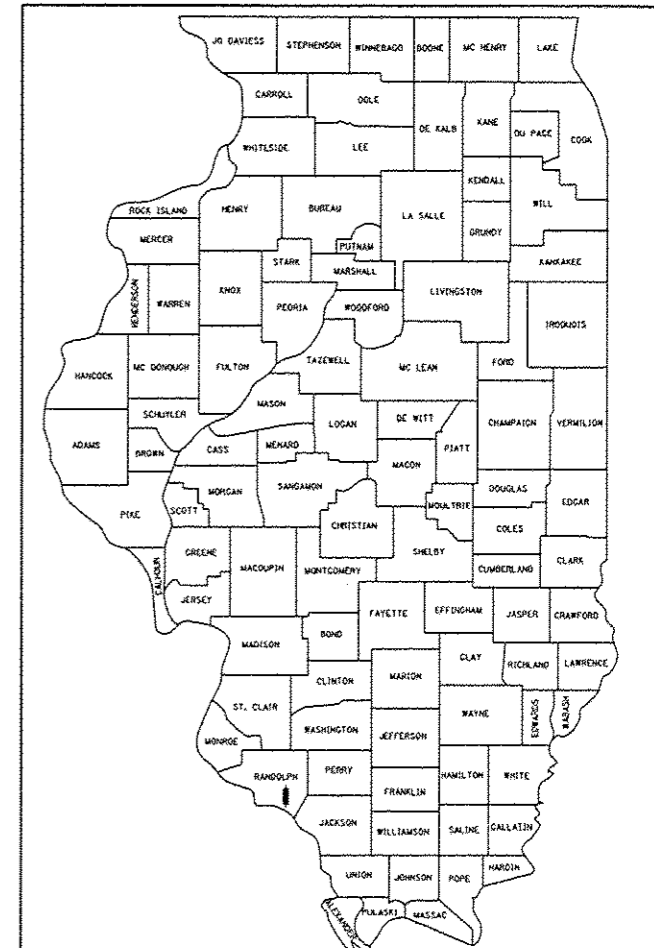

LOCATION OF SECTION INDICATED THUS: - [black rectangle] -

STATE OF ILLINOIS
 DEPARTMENT OF TRANSPORTATION

SUBMITTED *March 17, 2017*

Jeffrey Z. Kangas
 REGIONAL ENGINEER

May 12, 2017
Katherine M. Addis, P.E.
 ENGINEER OF DESIGN AND ENVIRONMENT

May 12, 2017
Tracie A. [Signature]
 DIRECTOR OF PROGRAM DEVELOPMENT

PRINTED BY THE AUTHORITY
 OF THE STATE OF ILLINOIS

INDEX OF SHEETS

- 1 COVER SHEET
- 2 INDEX OF SHEETS, HIGHWAY STANDARDS, GENERAL NOTES, & COMMITMENTS
- 3-4 SUMMARY OF QUANTITIES
- 5-8 TYPICAL SECTIONS
- 9-10 SCHEDULE OF QUANTITIES
- 11-12 SURVEY MONUMENTS

HIGHWAY STANDARDS

- 000001-06 STANDARD SYMBOLS, ABBREVIATIONS, AND PATTERNS
- 001001-02 AREAS OF REINFORCEMENT BARS
- 001006 DECIMAL OF AN INCH AND OF A FOOT
- 420701-03 PAVEMENT WELDED WIRE REINFORCEMENT
- 442101-07 CLASS B PATCHES
- 701201-04 LANE CLOSURE, 2L, 2W, DAY ONLY, FOR SPEEDS ≥ 45 MPH
- 701206-03 LANE CLOSURE, 2L, 2W, NIGHT ONLY, FOR SPEEDS ≥ 45 MPH
- 701301-04 LANE CLOSURE, 2L, 2W, SHORT TIME OPERATIONS
- 701336-06 LANE CLOSURE, 2L, 2W, WORK AREAS IN SERIES FOR SPEEDS ≥ 45 MPH
- 701501-06 URBAN LANE CLOSURE, 2L, 2W, UNDIVIDED
- 701901-06 TRAFFIC CONTROL DEVICES
- 780001-05 TYPICAL PAVEMENT MARKINGS
- 781001-04 TYPICAL APPLICATIONS RAISED REFLECTIVE PAVEMENT MARKERS

GENERAL NOTES

- ① ILLINOIS STATE LAW REQUIRES A 48-HOUR NOTICE BE GIVEN TO ALL UTILITIES WITHIN THE PROJECT AREA BEFORE DIGGING. FIELD MARKING OF FACILITIES MAY BE OBTAINED BY CONTACTING J.U.L.I.E. OR, FOR NON-MEMBERS, THE UTILITY COMPANY DIRECTLY. AGENCIES KNOWN TO HAVE FACILITIES IN THE AREA ARE AS FOLLOWS:

	ABOVE GROUND	BELOW GROUND
• AMEREN ILLINOIS (GAS & ELECTRIC)	x	x
• CITY OF CHESTER (WATER, SANITARY, & GAS)		x
• CLEARWAVE COMMUNICATIONS (COMMUNICATIONS)	x	x
• FRONTIER COMMUNICATIONS (COMMUNICATIONS)	x	x
• NEWWAVE COMMUNICATIONS (COMMUNICATIONS)	x	x
• PERMIAN EXPRESS PARTNERS (PIPELINE)		x
• WINDSTREAM KDL, INC. (COMMUNICATIONS)	x	x

MEMBERS OF J.U.L.I.E. CALL TOLL FREE (800) 892-0123 OR 811 AND ARE INDICATED BY •. NON-J.U.L.I.E. MEMBERS MUST BE NOTIFIED INDIVIDUALLY.

- ② THE CONTRACTOR AND THE ENGINEER SHALL BE AWARE THAT NO SURVEY WAS PERFORMED FOR THIS PROJECT. THE STATIONING, TOPOGRAPHY, AND QUANTITIES SHOWN IN THE PLANS WERE CREATED USING MICROFILM AND FIELD MEASUREMENTS. ALL SHALL BE ASSUMED TO BE APPROXIMATE. THE CONTRACTOR SHALL VERIFY DIMENSIONS AND CONDITIONS IN THE FIELD PRIOR TO CONSTRUCTION AND ORDERING OF MATERIALS.
- ③ FLAGGERS SHALL BE REQUIRED AT ALL TIMES DURING PATCHING OPERATIONS.
- ④ THE PROPOSED PAVEMENT MARKING SHALL MATCH THE LOCATIONS OF THE EXISTING PAVEMENT MARKING, AS DIRECTED BY THE ENGINEER.
- ⑤ LONGITUDINAL DIMENSIONS MAY BE ADJUSTED TO FIT FIELD CONDITIONS. THE LATERAL PLACEMENT OF THE FLAGGER MAY BE VARIED FROM THAT SHOWN.
- ⑥ A QUANTITY OF 1000 POUNDS FOR HIGH-DENSITY EXPANDING POLYURETHANE FOAM HAS BEEN INCLUDED AS PART OF THE CONTRACT. THE PRIME CONTRACTOR SHALL WORK WITH THE HIGH-DENSITY EXPANDING POLYURETHANE FOAM SUBCONTRACTOR AND THE ENGINEER TO DETERMINE THE MOST OPTIMAL SEQUENCE OF WORK. THE ASSUMED SEQUENCE OF WORK IS REMOVAL AND REPLACEMENT OF THE PATCH AND SUBGRADE, FOLLOWED BY FOAM INJECTION BENEATH THE NEW PATCH.
- ⑦ CONTACT KNIGHT HAWK COAL 48 HOURS PRIOR TO THE COMMENCEMENT OF WORK. CONTACT JOSHUA CARTER AT OFFICE: (618) 426-3662 CELL: (618) 967-4117.
- ⑧ THERE SHALL BE NO LANE CLOSURES WITHIN THE CITY LIMITS OF CHESTER FROM SEPTEMBER 8, 2017 TO SEPTEMBER 10, 2017.

COMMITMENTS

NONE

FILE NAME =	USER NAME = verdunjl	DESIGNED -	REVISED -	STATE OF ILLINOIS DEPARTMENT OF TRANSPORTATION	INDEX OF SHEETS, HIGHWAY STANDARDS, GENERAL NOTES, & COMMITMENTS	F.A.P. RTE.	SECTION	COUNTY	TOTAL SHEETS	SHEET NO.	
pw:\11\084EBIDINTEG.illinois.gov\PIDOT\Documents\IDOT Offices\District 8\Projects\D876\DRAWING\DATA\ADSheets\D876K51-sht-gennote		CHECKED -	REVISED -			312/861A	(75,119,121)PP-1, (119,110)PP-1	RANDOLPH	12	2	
Default	PLOT SCALE = 100.0000' / 1in.	DATE -	REVISED -			CONTRACT NO. 76K51					
	PLOT DATE = 3/17/2017					ILLINOIS FED. AID PROJECT					
					SCALE:	SHEET 1 OF 1 SHEETS		STA.		TO STA.	

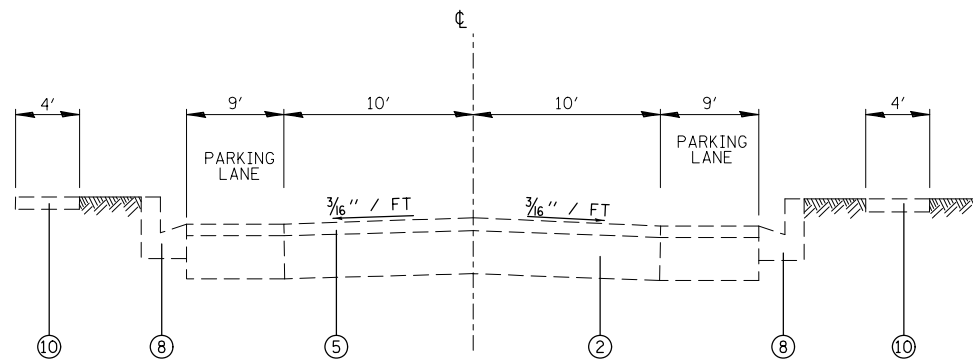

IL 150 TYPICAL SECTION
M.P. 0.0 TO M.P. 0.12
(IL 3 TO STACEY)

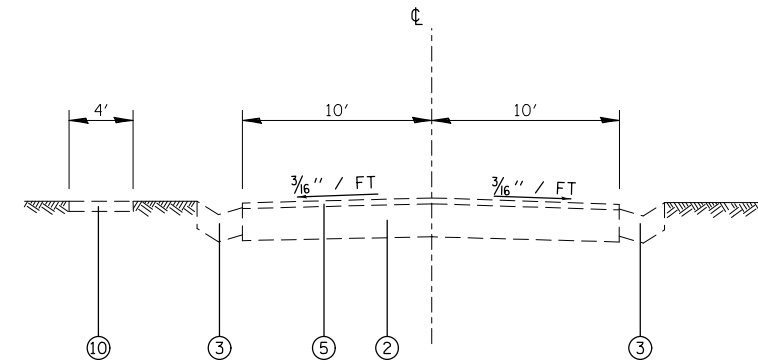

IL 150 TYPICAL SECTION
M.P. 0.41 TO M.P. 0.78
(HACKER TO E. STATE ST.)

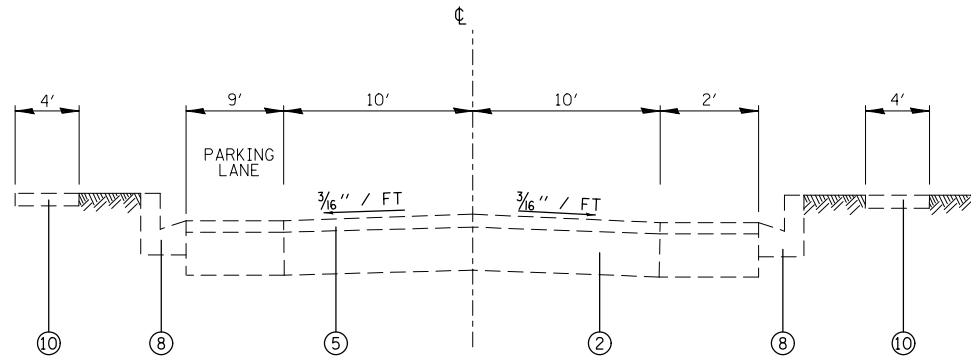

IL 150 TYPICAL SECTION
M.P. 0.12 TO M.P. 0.20
(STACEY TO HOLMES)

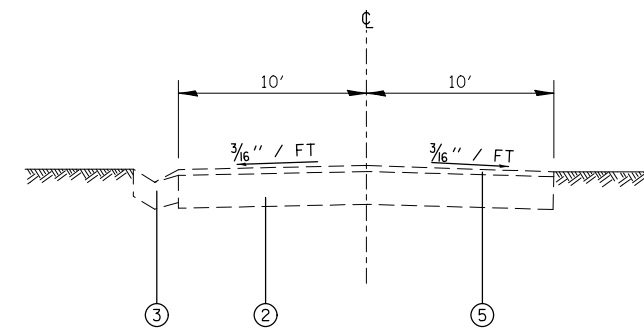

IL 150 TYPICAL SECTION
M.P. 0.78 TO M.P. 0.86
(EAST STATE ST. TO SWANSWICK ST.)

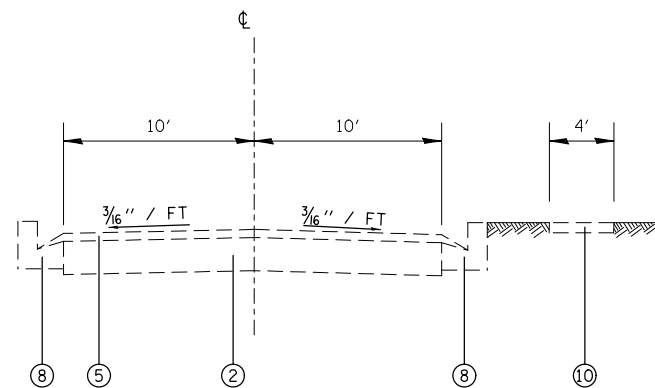

IL 150 TYPICAL SECTION
M.P. 0.20 TO M.P. 0.41
(HOLMES TO HACKER)

LEGEND

- 1 EXISTING LIME MODIFIED SOIL
- 2 EXISTING PCC PAVEMENT
- 3 EXISTING CONCRETE GUTTER, TYPE B
- 4 EXISTING STRIP REFLECTIVE CRACK CONTROL
- 5 EXISTING HOT-MIX ASPHALT SURFACE, VARIABLE DEPTH
- 6 EXISTING HOT-MIX ASPHALT SHOULDER
- 7 EXISTING PCC BASE COURSE WIDENING
- 8 EXISTING CURB
- 9 EXISTING AGGREGATE SHOULDER
- 10 EXISTING SIDEWALK

FILE NAME =	USER NAME = verdunjl	DESIGNED -	REVISED -
pw:\IL084EBIDINTEG.illinois.gov\PIWIDOT\Documents\IDOT Offices\District 8\Projects\0875\Drawings\AD\Sheets\0875-1-sh-typical.dwg		CHECKED -	REVISED -
Default	PLOT DATE = 3/17/2017	DATE -	REVISED -

STATE OF ILLINOIS
DEPARTMENT OF TRANSPORTATION

TYPICAL SECTIONS			
SCALE:	SHEET 1	OF 4 SHEETS	STA. TO STA.

F.A.P. RTE.	SECTION	COUNTY	TOTAL SHEETS	SHEET NO.
312/861A	(75,119,121)PP-1, (119,110)PP-1	RANDOLPH	12	5
CONTRACT NO. 76K51			ILLINOIS FED. AID PROJECT	

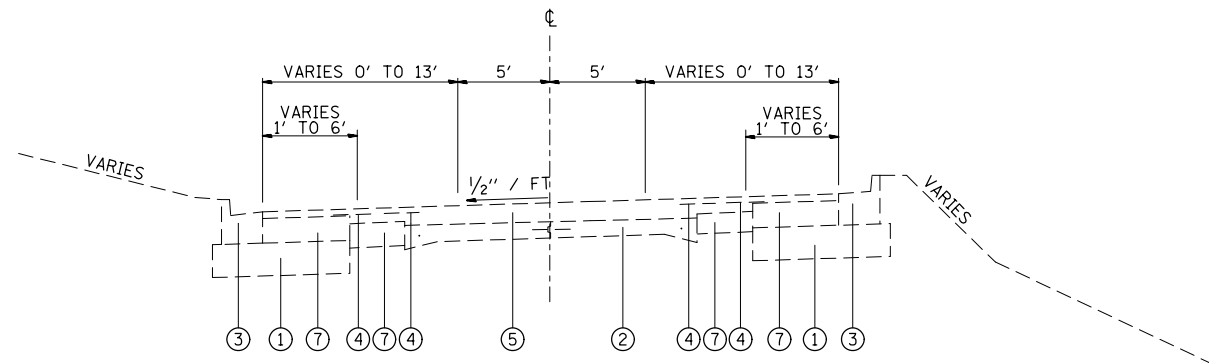

IL 150 CURB AND GUTTER SECTION - SUPERELEVATED
M.P. 0.86 TO M.P. 0.92

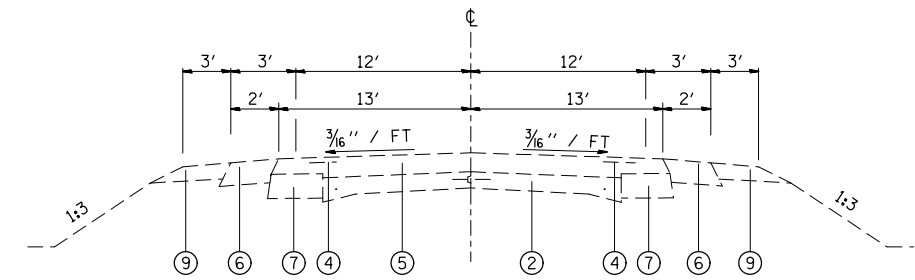

IL 150 TANGENT SECTION
M.P. 0.95 TO M.P. 1.29
M.P. 1.54 TO M.P. 2.02
M.P. 2.26 TO M.P. 2.37
M.P. 2.60 TO M.P. 2.80
(SEE GUTTER SECTION)

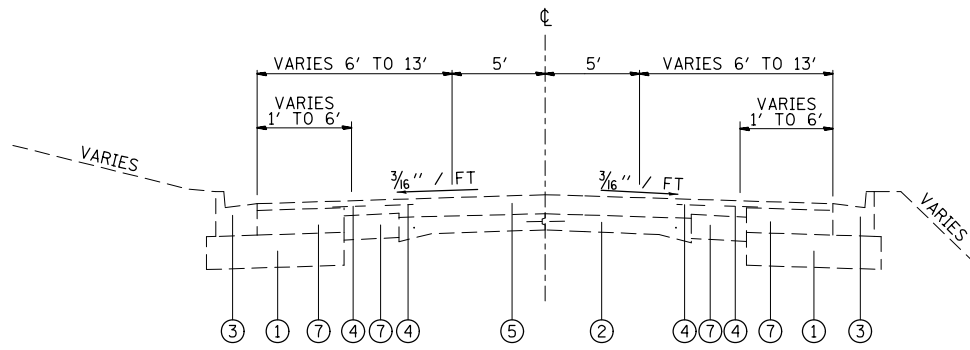

IL 150 CURB AND GUTTER SECTION - TANGENT
M.P. 0.92 TO M.P. 0.95
M.P. 1.29 TO M.P. 1.54

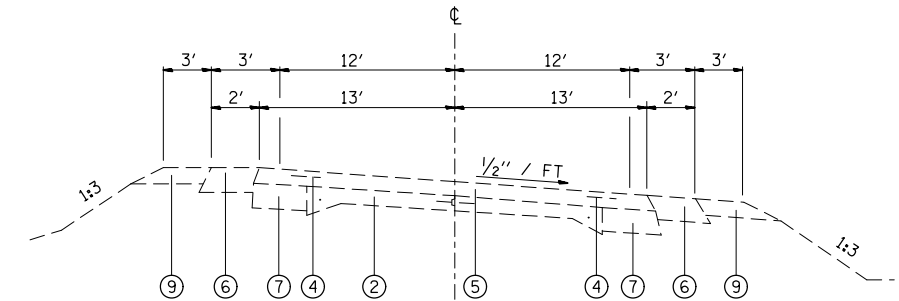

IL 150 SUPERELEVATED SECTION
M.P. 2.02 TO M.P. 2.26
M.P. 2.37 TO M.P. 2.60
(SEE GUTTER SECTION)

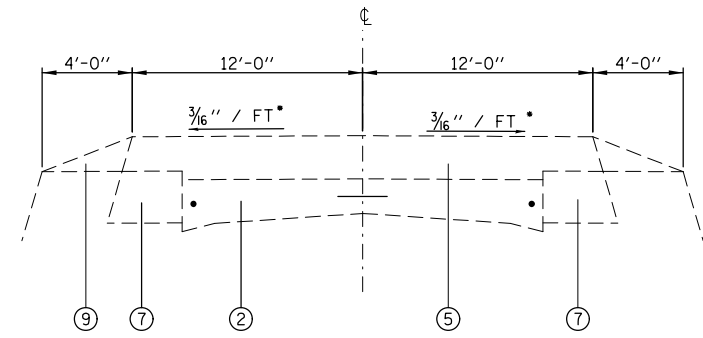

IL 150 TYPICAL SECTION
M.P. 2.80 TO M.P. 2.94
*SLOPE EQUALS 3/16" / FT EXCEPT WHERE SUPERELEVATIONS EXIST.

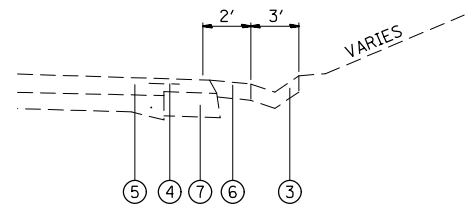

IL 150 GUTTER SECTION
M.P. 1.16 TO M.P. 1.23 LT.
M.P. 1.68 TO M.P. 1.75 LT.
M.P. 1.92 TO M.P. 1.96 LT.
M.P. 2.31 TO M.P. 2.49 RT.
M.P. 2.51 TO M.P. 2.63 LT.

LEGEND

- 1 EXISTING LIME MODIFIED SOIL
- 2 EXISTING PCC PAVEMENT
- 3 EXISTING CONCRETE GUTTER, TYPE B
- 4 EXISTING STRIP REFLECTIVE CRACK CONTROL
- 5 EXISTING HOT-MIX ASPHALT SURFACE, VARIABLE DEPTH
- 6 EXISTING HOT-MIX ASPHALT SHOULDER
- 7 EXISTING PCC BASE COURSE WIDENING
- 8 EXISTING CURB
- 9 EXISTING AGGREGATE SHOULDER
- 10 EXISTING SIDEWALK

FILE NAME =	USER NAME = verdunjl	DESIGNED -	REVISED -
pw:\IL\084EBIDINTEG\illinois.gov\PIDOT\Documents\IDOT Offices\District 8\Projects\0875\Drawings\AD\Sheets\0875-1-sh-typical		CHECKED -	REVISED -
Default	PLOT DATE = 3/17/2017	DATE -	REVISED -

STATE OF ILLINOIS
DEPARTMENT OF TRANSPORTATION

TYPICAL SECTIONS			
SCALE:	SHEET 2	OF 4 SHEETS	STA. TO STA.

F.A.P. RTE.	SECTION	COUNTY	TOTAL SHEETS	SHEET NO.
312/861A	(75,119,121)PP-1, (119,110)PP-1	RANDOLPH	12	6
				CONTRACT NO. 76K51
ILLINOIS FED. AID PROJECT				

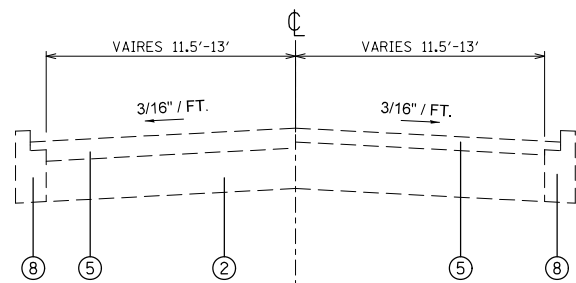

IL 3 TANGENT SECTION
M.P. 0.00 TO M.P. 0.30
(IL 150 TO FREDERICK ST.)

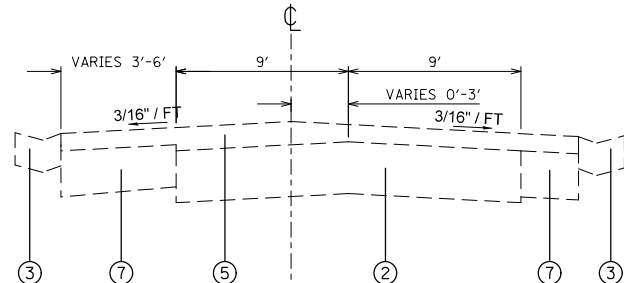

IL 3 TANGENT SECTION
M.P. 0.44 TO M.P. 0.49

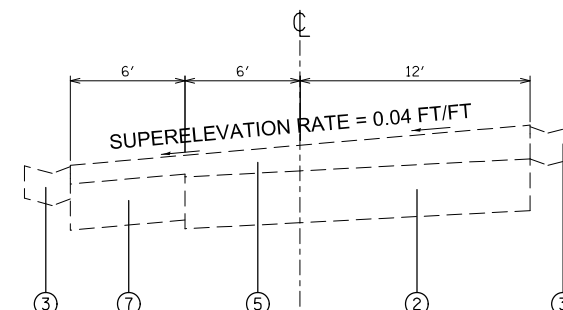

IL 3 SUPERELEVATION SECTION
M.P. 0.70 TO M.P. 0.92

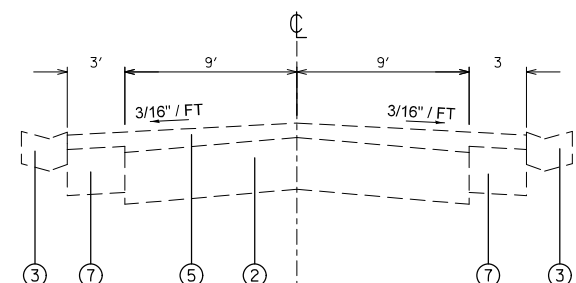

IL 3 TANGENT SECTION
M.P. 0.30 TO M.P. 0.38
(FREDERICK ST. TO CROSBY ST.)

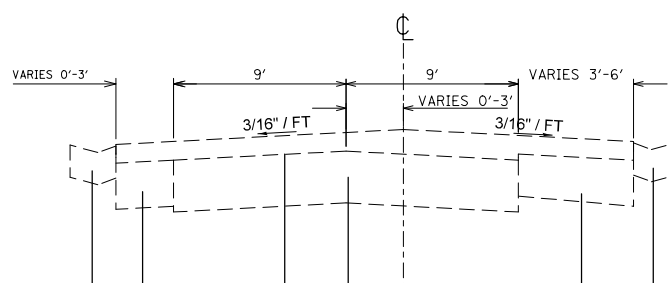

IL 3 TANGENT SECTION
M.P. 0.49 TO M.P. 0.53

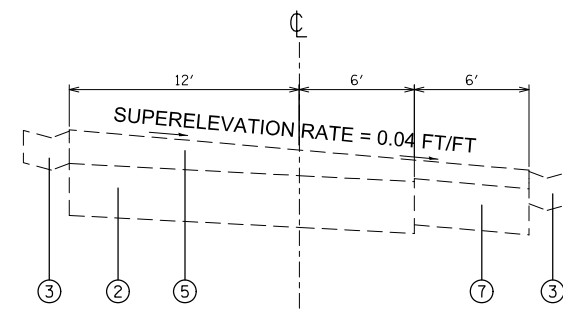

IL 3 SUPERELEVATION SECTION
M.P. 1.12 TO M.P. 1.17

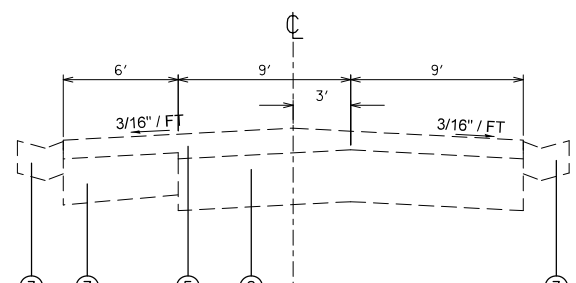

IL 3 TANGENT SECTION
M.P. 0.38 (CROSBY ST.) TO M.P. 0.44

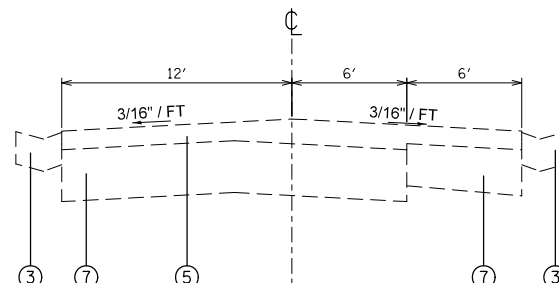

IL 3 TANGENT SECTION
M.P. 0.53 TO M.P. 0.70
M.P. 0.92 TO M.P. 1.12

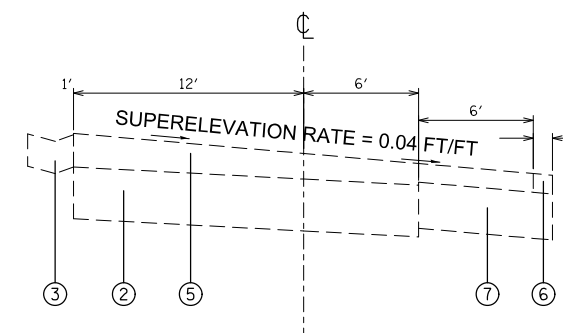

IL 3 SUPERELEVATION SECTION
M.P. 1.17 TO M.P. 1.21

LEGEND

- 1 EXISTING LIME MODIFIED SOIL
- 2 EXISTING PCC PAVEMENT
- 3 EXISTING CONCRETE GUTTER, TYPE B
- 4 EXISTING STRIP REFLECTIVE CRACK CONTROL
- 5 EXISTING HOT-MIX ASPHALT SURFACE, VARIABLE DEPTH
- 6 EXISTING HOT-MIX ASPHALT SHOULDER
- 7 EXISTING PCC BASE COURSE WIDENING
- 8 EXISTING CURB
- 9 EXISTING AGGREGATE SHOULDER
- 10 EXISTING SIDEWALK

FILE NAME =	USER NAME = verdunjl	DESIGNED -	REVISED -
pw:\IL\084EBIDINTEG\illinois.gov\PWIDOT\Documents\IDOT Offices\District 8\Projects\0875\Drawings\LEADsheets\0875-1-sh-typical		DRAWN -	REVISED -
Default	PLOT SCALE = 100.0000' / in.	CHECKED -	REVISED -
	PLOT DATE = 3/17/2017	DATE -	REVISED -

STATE OF ILLINOIS
DEPARTMENT OF TRANSPORTATION

TYPICAL SECTIONS			
SCALE:	SHEET 3	OF 4 SHEETS	STA. TO STA.

F.A.P. RTE.	SECTION	COUNTY	TOTAL SHEETS	SHEET NO.
312/861A	(75,119,121)PP-1, (119,110)PP-1	RANDOLPH	12	7
CONTRACT NO. 76K51				
ILLINOIS FED. AID PROJECT				

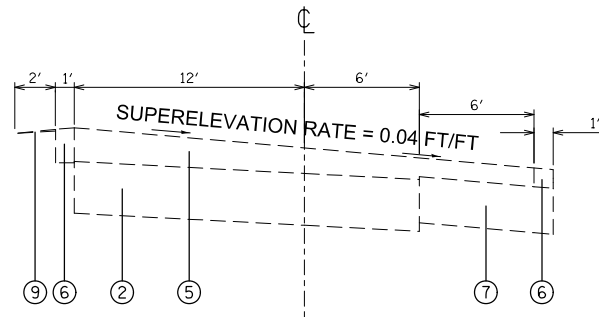

IL 3 SUPERELEVATION SECTION
M.P. 1.21 TO M.P. 1.30 (RIVERVIEW DR.)

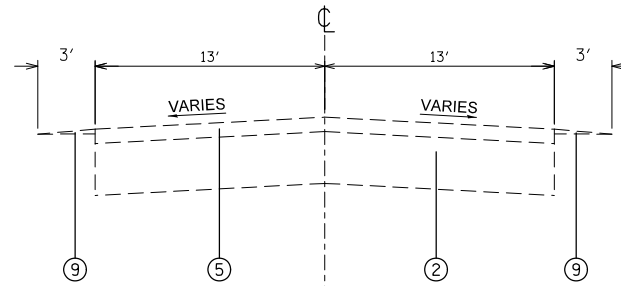

IL 3 TYPICAL SECTION
M.P. 1.51 TO M.P. 1.56
M.P. 1.75 TO M.P. 1.93
M.P. 2.00 TO M.P. 2.07
M.P. 2.15 TO M.P. 2.31

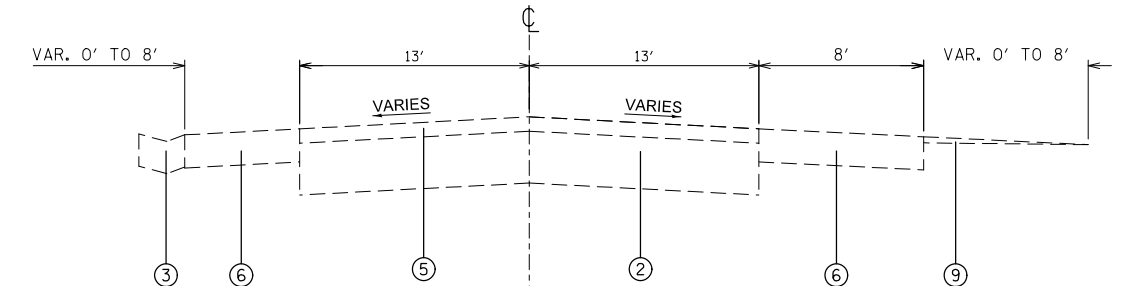

IL 3 TYPICAL SECTION
M.P. 2.83 TO M.P. 2.91

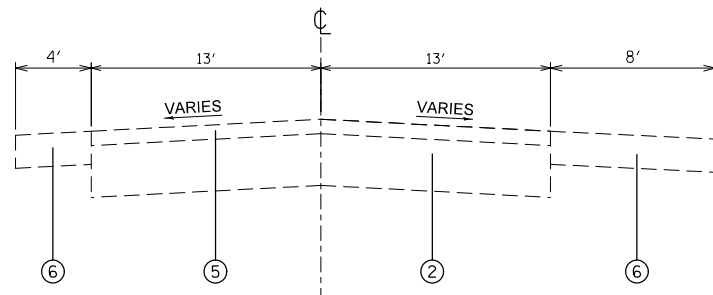

IL 3 TYPICAL SECTION
M.P. 1.30 (RIVERVIEW DR.) TO M.P. 1.40

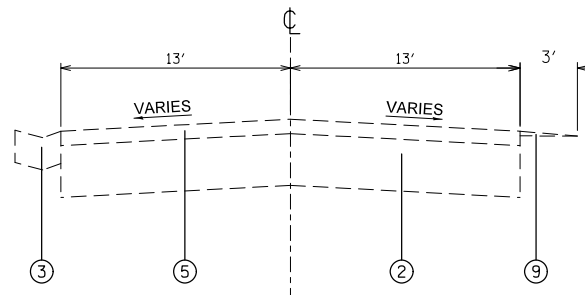

IL 3 TYPICAL SECTION
M.P. 2.07 TO M.P. 2.15

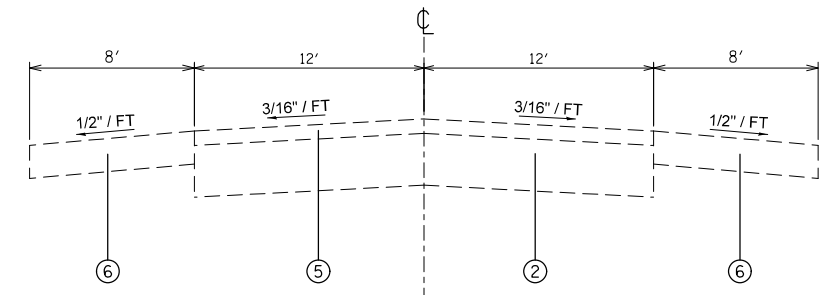

IL 3 TYPICAL SECTION
M.P. 2.98 TO M.P. 3.00

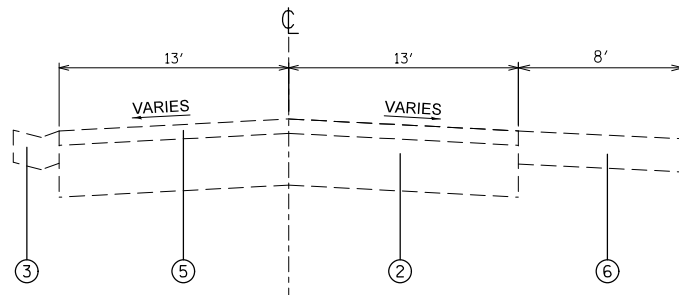

IL 3 TYPICAL SECTION
M.P. 1.40 TO M.P. 1.43

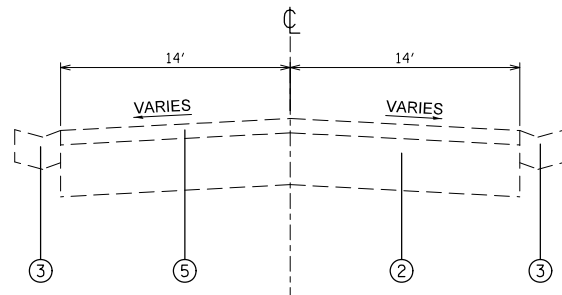

IL 3 TYPICAL SECTION
M.P. 2.31 TO M.P. 2.83

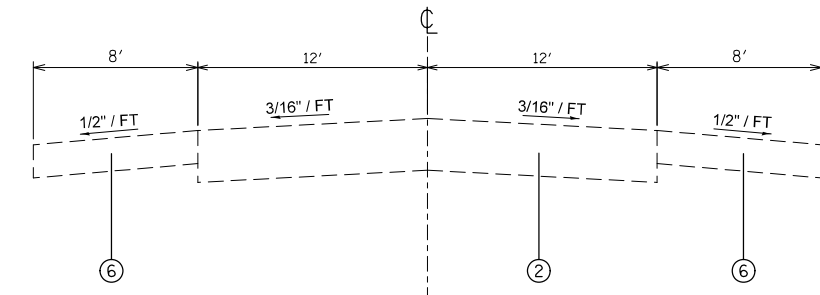

IL 3 TYPICAL SECTION
M.P. 3.00 TO M.P. 3.08

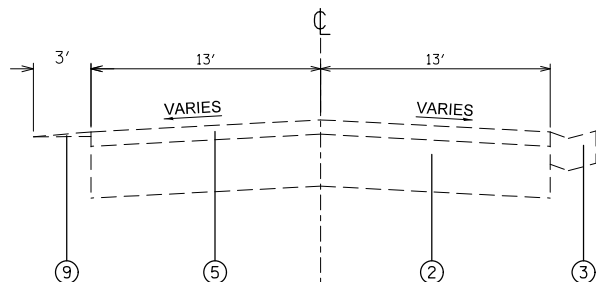

IL 3 TYPICAL SECTION
M.P. 1.43 TO M.P. 1.51
M.P. 1.56 TO M.P. 1.75
M.P. 1.93 TO M.P. 2.00

- LEGEND
- 1 EXISTING LIME MODIFIED SOIL
 - 2 EXISTING PCC PAVEMENT
 - 3 EXISTING CONCRETE GUTTER, TYPE B
 - 4 EXISTING STRIP REFLECTIVE CRACK CONTROL
 - 5 EXISTING HOT-MIX ASPHALT SURFACE, VARIABLE DEPTH
 - 6 EXISTING HOT-MIX ASPHALT SHOULDER
 - 7 EXISTING PCC BASE COURSE WIDENING
 - 8 EXISTING CURB
 - 9 EXISTING AGGREGATE SHOULDER
 - 10 EXISTING SIDEWALK

FILE NAME =	USER NAME = verdunjl	DESIGNED -	REVISED -
pw:\IL\084EBIDINTEG\illinois.gov\PIDOT\Documents\IDOT Offices\District 8\Projects\0875\Drawings\LEADsheets\D876K51-sht-typical		CHECKED -	REVISED -
Default	PLOT SCALE = 100.0000' / in.	DATE -	REVISED -
	PLOT DATE = 3/17/2017		

STATE OF ILLINOIS
DEPARTMENT OF TRANSPORTATION

TYPICAL SECTIONS

SCALE: SHEET 4 OF 4 SHEETS STA. TO STA.

F.A.P. RTE.	SECTION	COUNTY	TOTAL SHEETS	SHEET NO.
312/861A	(75,119,121)PP-1, (119,110)PP-1	RANDOLPH	12	8
CONTRACT NO. 76K51			ILLINOIS FED. AID PROJECT	

CLASS B PATCHING SCHEDULE

IL 3 FROM INTERSECTION WITH STATE ST. (M.P. 0.00) SOUTH TO THE JOINT 0.1 MILE PAST SOUTH END OF THE BRIDGE OVER MARY'S RIVER (SN 079-0011) (M.P. 3.08)

LOCATION	LANE	LENGTH	LANE WIDTH	CLASS B PATCH, SPECIAL, TYPE IV, 8"	CLASS B PATCH, SPECIAL, TYPE II, 12"	CLASS B PATCH, SPECIAL, TYPE III, 12"	CLASS B PATCH, SPECIAL, TYPE IV, 12"	DOWEL BARS, 1 1/2"	TIE BARS	WELDED WIRE REINF.	SAWCUT	SUBBASE GRANULAR MATERIAL, TYPE B, 6"	FOAM, EXPANDING POLYURETHANE HIGH-DENSITY
		(FT)	(FT)	(SQ YD)	(SQ YD)	(SQ YD)	(SQ YD)	(EACH)	(EACH)	(SQ YD)	(FT)	(SQ YD)	(POUND)
0.038	SB	15.0	12.0				20.0	20		20.0	66.0	20.0	
0.111	SB	30.0	12.0				40.0	20	28	40.0	96.0	40.0	1000.0
0.129	SB	60.0	12.0				80.0	20	58	80.0	156.0	80.0	
0.158	SB	40.0	12.0				53.3	20	38	53.3	116.0	53.3	
0.277	SB	60.0	12.0				80.0	20	58	80.0	156.0	80.0	
1.506	SB	100.0	13.0				144.4	22	98	144.4	239.0	144.4	
1.561	SB	120.0	13.0				173.3	22	118	173.3	279.0	173.3	
1.652	SB	10.0	13.0		14.4			22			59.0	14.4	
1.734	SB	40.0	13.0				57.8	22	38	57.8	119.0	57.8	
1.794	SB	80.0	13.0				115.6	22	39	115.6	119.0	115.6	
1.838	SB	15.0	13.0			21.7		22		21.7	69.0	21.7	
1.861	SB	10.0	13.0		14.4			22			59.0	14.4	
2.454	SB	20.0	14.0				31.1	24	18	31.1	82.0	31.1	
2.568	SB	30.0	14.0				46.7	24	28	46.7	102.0	46.7	
2.626	SB	40.0	14.0				62.2	24	38	62.2	122.0	62.2	
2.826	SB	80.0	14.0				124.4	24	78	124.4	202.0	124.4	
3.002	SB	25.0	12.0	33.3				20	12	33.3	86.0	33.3	
IL 150 FROM E. STACY ST. (M.P. 0.00) EAST TO EAST OF UNION SCHOOL RD. (M.P. 2.94)													
0.210	WB	150.0	12.0				200.0	20	148	200.0	336.0	200.0	
0.219	WB	30.0	12.0				40.0	20	28	40.0	96.0	40.0	
0.236	WB	150.0	12.0				200.0	20	148	200.0	336.0	200.0	
0.281	WB	125.0	12.0				166.7	20	123	166.7	286.0	166.7	
0.351	WB	30.0	12.0				40.0	20	28	40.0	96.0	40.0	
2.741	WB	60.0	12.0				80.0	20	29	80.0	156.0	80.0	
SUBTOTAL:				33.3	43.3	41.7	1944.4	604	1247	2019.4	3854.0	2062.8	1000.0
ANTICIPATED FAILURES (15%):				5.0	6.5	6.3	291.7	91	188	302.9	578.1	309.4	
TOTAL:				38	50	48	2236	695	1435	2322	4432	2372	1000

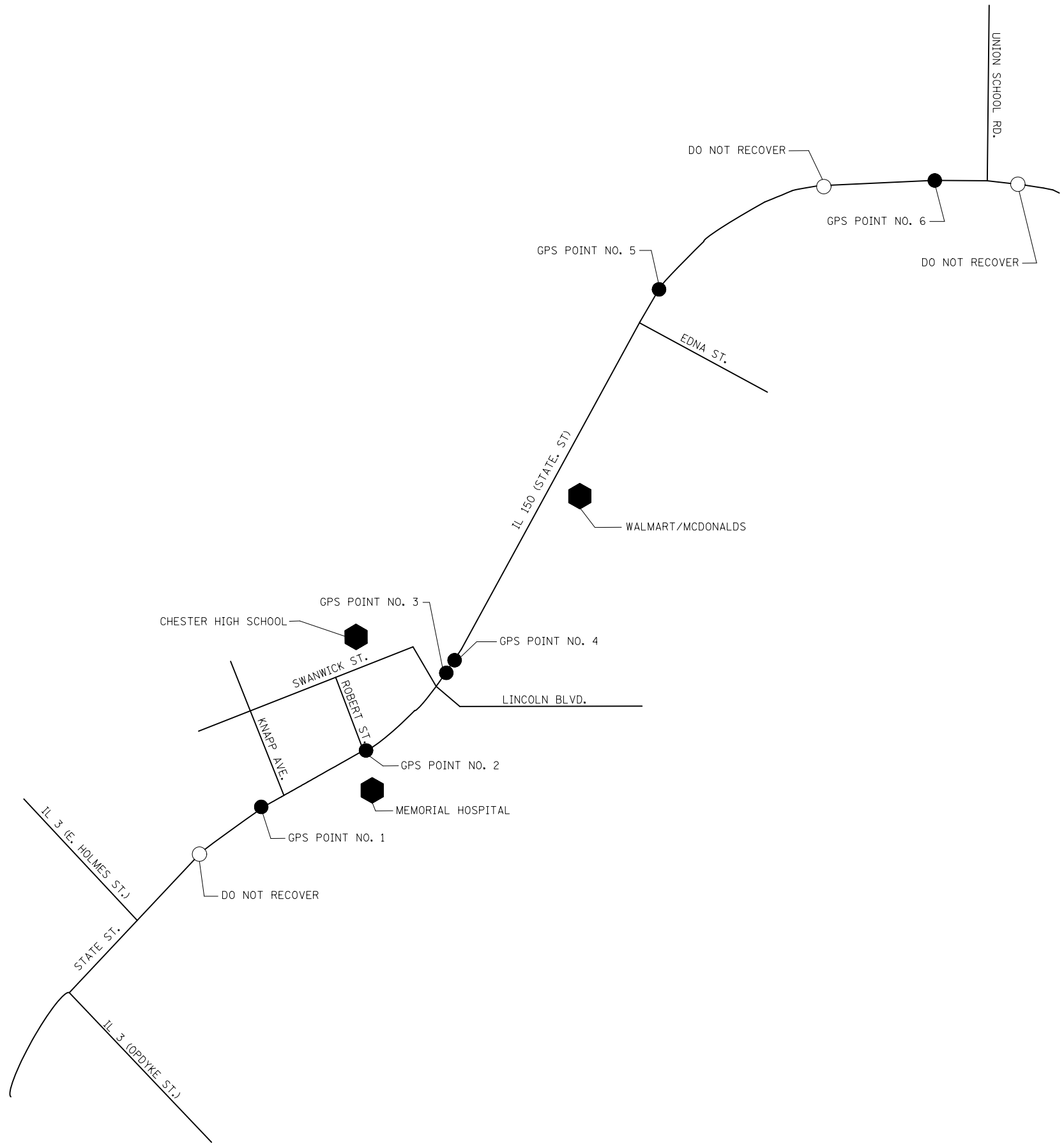

• NOT TO SCALE

FILE NAME =	USER NAME = verdunjl	DESIGNED -	REVISED -
pw:\IL084EBIDINTEG\illinois.gov\PIDOT\Documents\DOT Offices\District 8\Projects\0875\KBR\Drawings\CADsheets\D876K51-sht-schedule.dwg		DRAWN -	REVISED -
Default	PLOT SCALE = 100.0000' / in.	CHECKED -	REVISED -
	PLOT DATE = 3/17/2017	DATE -	REVISED -

**STATE OF ILLINOIS
DEPARTMENT OF TRANSPORTATION**

SURVEY MONUMENTS

SCALE: SHEET 1 OF 2 SHEETS STA. TO STA.

F.A.P. RTE.	SECTION	COUNTY	TOTAL SHEETS	SHEET NO.
312/861A	(75,119,121)PP-1, (119,110)PP-1	RANDOLPH	12	11
CONTRACT NO. 76K51			ILLINOIS FED. AID PROJECT	

FOUND IDOT DISK
 N 455,503.583
 E 2,397,655.303

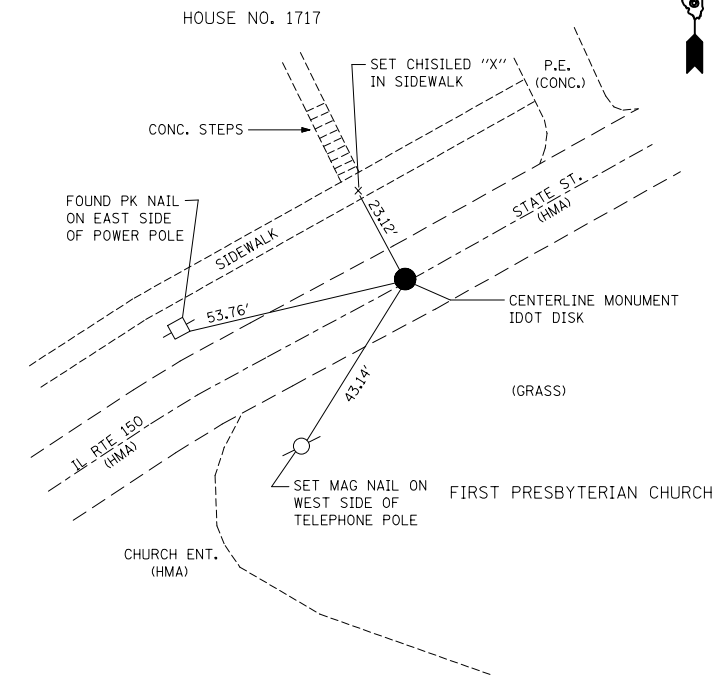

* ALL MEASUREMENTS ARE PULLED DIRECT
 ** NOT TO SCALE

1 CENTERLINE MONUMENT (IL 150)

FOUND IDOT DISK
 N 455,823.303
 E 2,398,519.970

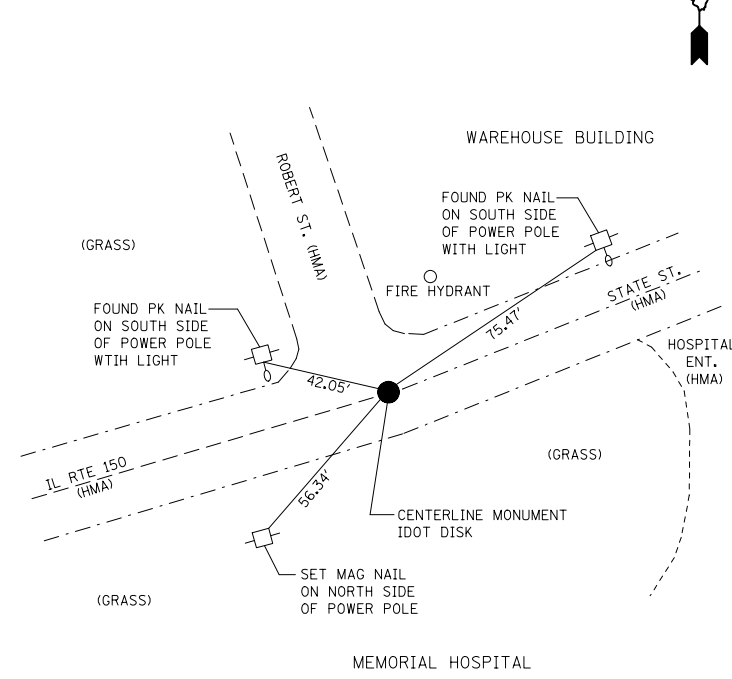

* ALL MEASUREMENTS ARE PULLED DIRECT
 ** NOT TO SCALE

2 CENTERLINE MONUMENT (IL 150)

FOUND IDOT DISK IN TURN LANE
 N 456,504.998
 E 2,399,176.747

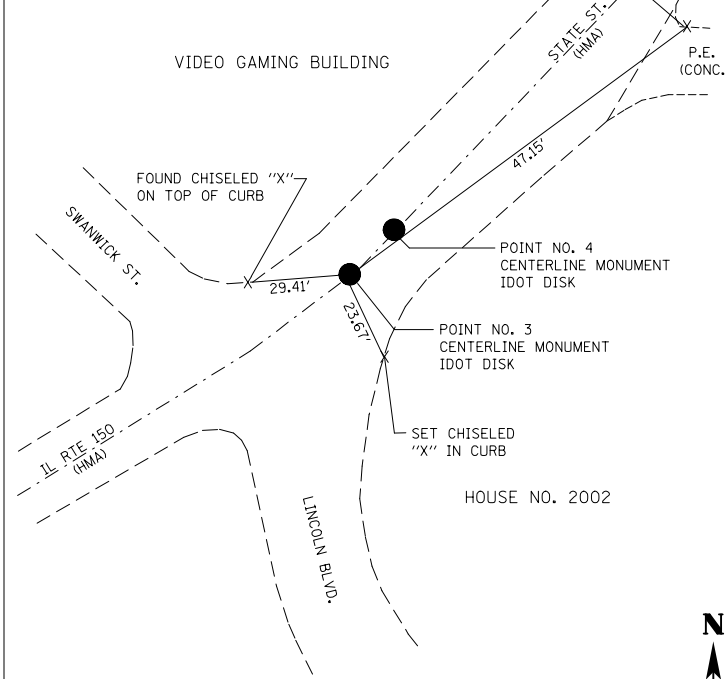

* ALL MEASUREMENTS ARE PULLED DIRECT
 ** NOT TO SCALE
 *** POINT 3 TO POINT 4 = 3.52'

3 CENTERLINE MONUMENT (IL 150)

FOUND IDOT DISK IN TURN LANE
 N 456,507.983
 E 2,399,178.616

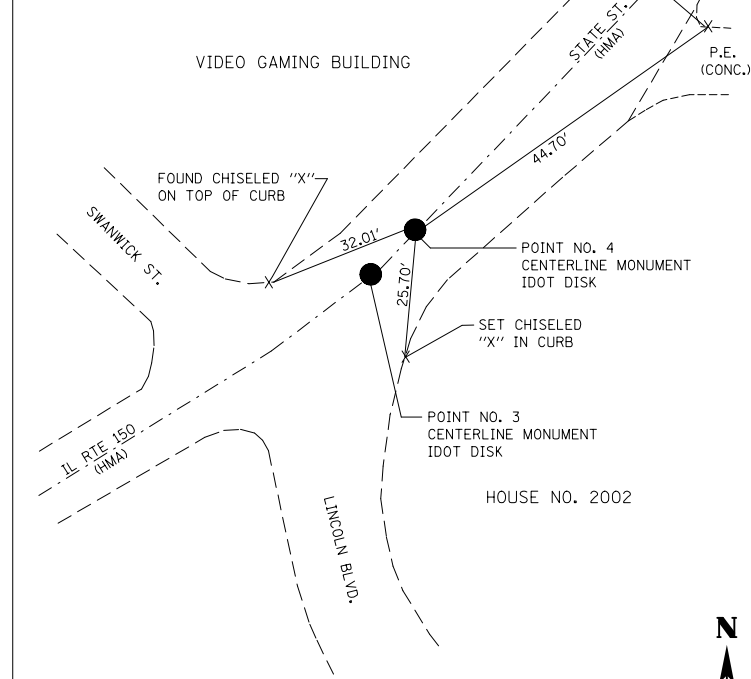

* ALL MEASUREMENTS ARE PULLED DIRECT
 ** NOT TO SCALE
 *** POINT 3 TO POINT 4 = 3.52'

4 CENTERLINE MONUMENT (IL 150)

FOUND IDOT DISK
 N 461,739.986
 E 2,402,554.313

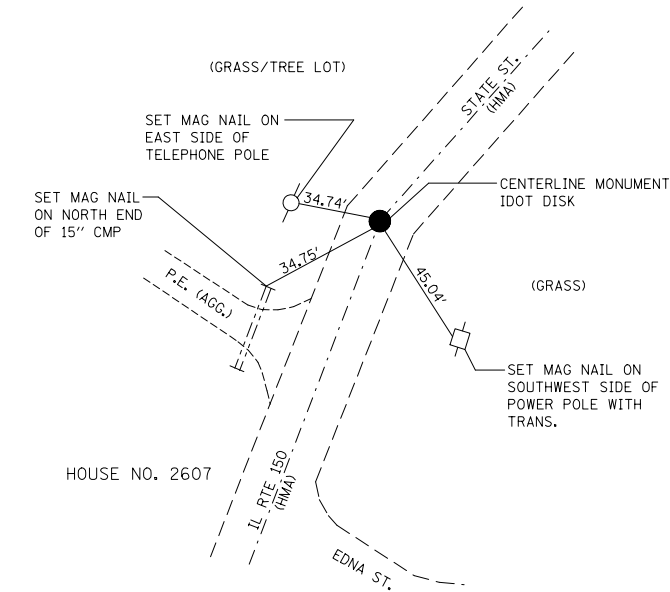

* ALL MEASUREMENTS ARE PULLED DIRECT
 ** NOT TO SCALE

5 CENTERLINE MONUMENT (IL 150)

FOUND IDOT DISK
 N 462,318.190
 E 2,404,162.384

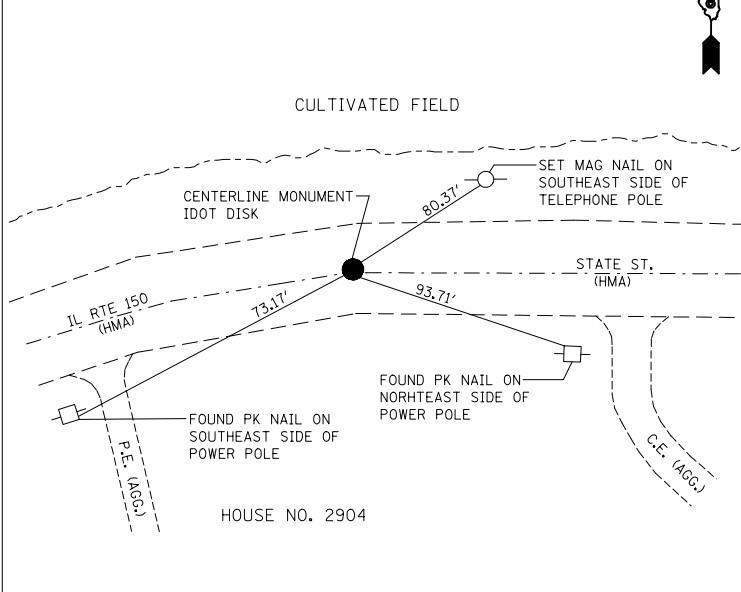

* ALL MEASUREMENTS ARE PULLED DIRECT
 ** NOT TO SCALE

6 CENTERLINE MONUMENT (IL 150)

COORDINATE/DATUM
 NAD 83 (2011) EPOCH 2010.00
 SPC-ILLINOIS COORDINATE SYSTEM, WEST ZONE 1202
 GEOID MODEL: GEOID 12A
 TRIMBLE VRS NOW US NETWORK

FILE NAME =	USER NAME = verdunjl	DESIGNED -	REVISED -	STATE OF ILLINOIS DEPARTMENT OF TRANSPORTATION	SURVEY MONUMENTS	F.A.P. RTE.	SECTION	COUNTY	TOTAL SHEETS	SHEET NO.
pw:\IL\084EBIDINTEG\Illinois.gov\PIDOT Documents\IDOT Offices\District 8\Projects\0875\KAD\Drawings\0875-KAD-001-1-11-17.dwg		CHECKED -	REVISED -			312/861A	(75,119,121)PP-1, (119,110)PP-1	RANDOLPH	12	12
Default		DATE -	REVISED -			CONTRACT NO. 76K51			ILLINOIS FED. AID PROJECT	

SCALE: SHEET 2 OF 2 SHEETS STA. TO STA.