

STATE OF ILLINOIS
DEPARTMENT OF TRANSPORTATION

F.A.P. RTE.	SECTION	COUNTY	TOTAL SHEETS	SHEET NO.
330	15RS-5 & 16RS-4	KANKAKEE	23	1
		ILLINOIS	CONTRACT NO. 66B01	

INDEX OF SHEETS

- 1 COVER SHEET
- 2 GENERAL NOTES & COMMITMENTS
- 3-6 SUMMARY OF QUANTITIES
- 7 TYPICAL SECTIONS
- 8-9 SCHEDULES
- 10 LAYOUT MAP SURVEY MONUMENTS
- 11-12 ADA RAMP DETAILS
- 13-15 DETECTOR LOOP DETAILS
- 16-21 PAVEMENT MARKING DETAILS
- 22-23 MISCELLANEOUS DETAILS

PROPOSED HIGHWAY PLANS

FAP ROUTE 330 (US 45/52)
SECTION 15RS-5 & 16RS-4
PROJECT NHPP-0330(079)
3P MILLING AND RESURFACING
KANKAKEE COUNTY

LIST OF ILLINOIS DOT HIGHWAY STANDARDS

000001-06	STANDARD SYMBOLS, ABBREVIATIONS AND PATTERNS
001006	DECIMAL OF AN INCH AND OF A FOOT
424001-09	PERPENDICULAR CURB RAMPS FOR SIDEWALKS
424006-02	DIAGONAL CURB RAMPS FOR SIDEWALKS
424011-03	CORNER PARALLEL CURB RAMPS FOR SIDEWALKS
424021-03	DEPRESSED CORNER FOR SIDEWALKS
424031-01	MEDIAN PEDESTRIAN CROSSINGS
606001-06	CONCRETE CURB TYPE B AND COMBINATION CONCRETE CURB AND GUTTER
667101-02	PERMANENT SURVEY MARKERS
701001-02	OFF-ROAD OPERATIONS 2L, 2W, MORE THAN 15' (4.5 m) AWAY
701006-05	OFF-ROAD OPERATIONS 2L, 2W, 15' (4.5 m) TO 24' (600 mm) FROM PAVEMENT EDGE
701011-04	OFF-ROAD MOVING OPERATIONS 2L, 2W, DAY ONLY
701201-04	LANE CLOSURE, 2L, 2W, DAY ONLY, FOR SPEEDS ≥ 45 MPH
701301-04	LANE CLOSURE, 2L, 2W, SHORT TIME OPERATIONS
701306-03	LANE CLOSURE, 2L, 2W, SLOW MOVING OPERATIONS DAY ONLY, FOR SPEEDS ≥ 45 MPH
701311-03	LANE CLOSURE, 2L, 2W, MOVING OPERATIONS - DAY ONLY
701801-06	SIDEWALK, CORNER OR CROSSWALK CLOSURE
701901-06	TRAFFIC CONTROL DEVICES
780001-05	TYPICAL PAVEMENT MARKINGS
781001-04	TYPICAL APPLICATIONS RAISED REFLECTIVE PAVEMENT MARKERS
782001-01	PRISMATIC CURB REFLECTORS
886001-01	DETECTOR LOOP INSTALLATIONS
886006-01	TYPICAL LAYOUT FOR DETECTION LOOPS

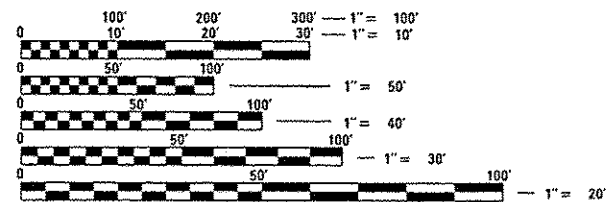

FULL SIZE PLANS HAVE BEEN PREPARED USING STANDARD ENGINEERING SCALES. REDUCED SIZED PLANS WILL NOT CONFORM TO STANDARD SCALES. IN MAKING MEASUREMENTS ON REDUCED PLANS, THE ABOVE SCALES MAY BE USED.

J.U.L.I.E.
JOINT UTILITY LOCATION INFORMATION FOR EXCAVATION
1-800-892-0123
OR 811

PROJECT ENGINEER: JOE KANNEL, P.E.
UNIT CHIEF: MICHELE LINDEMANN, P.E.
DISTRICT 3 NO. (815) 434-6131
CONTRACT NO. 66B01

GROSS LENGTH = 21,963.00 FT. = 4.160 MILE
NET LENGTH = 18,971.57 FT. = 3.593 MILE

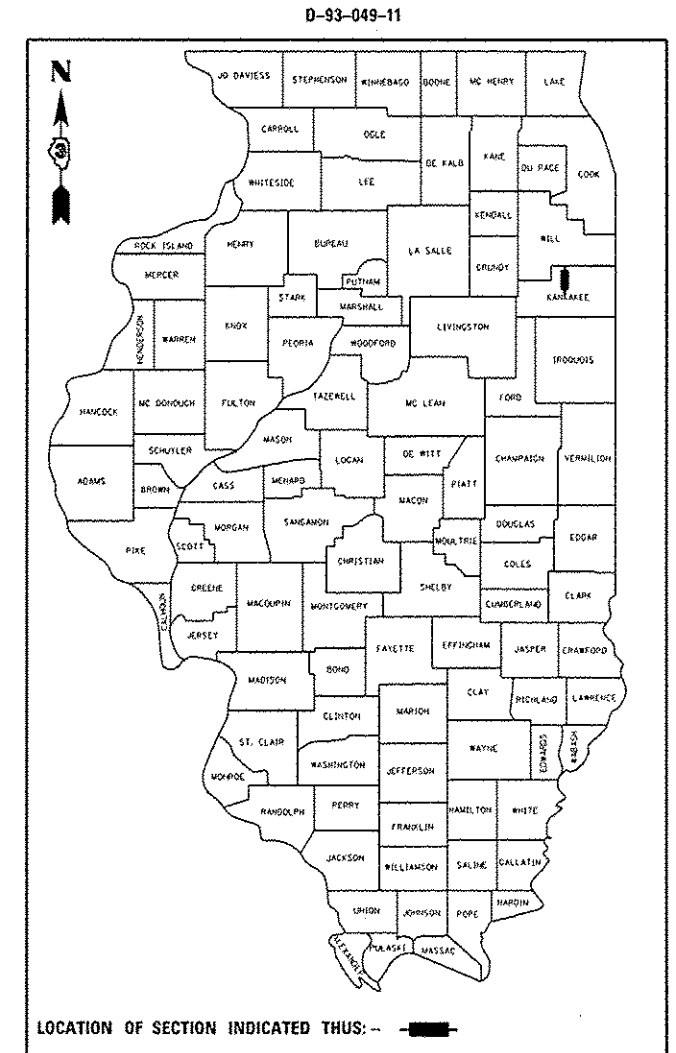
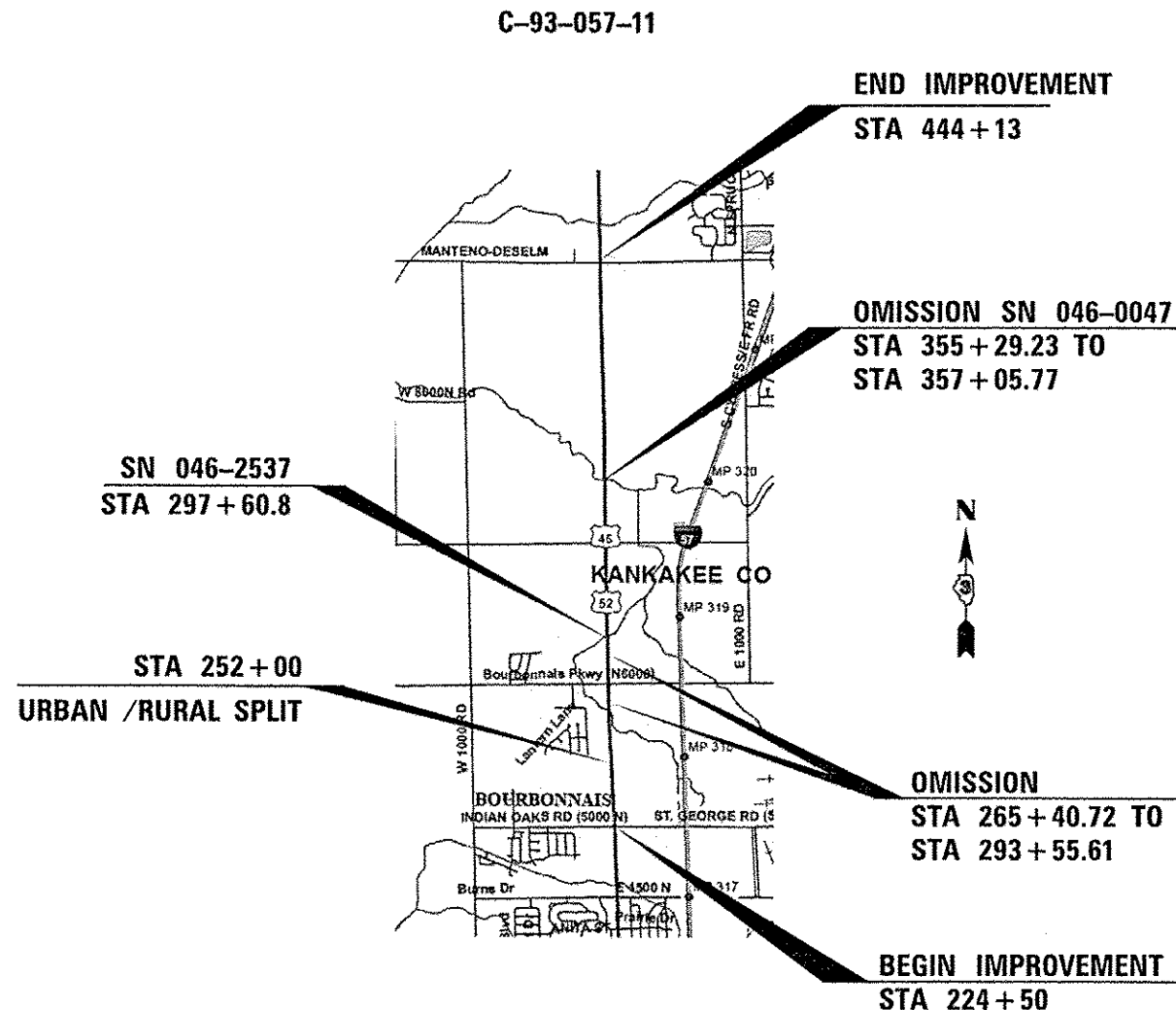

FUNCTIONAL CLASSIFICATION:
OTHER PRINCIPAL ARTERIAL (URBAN)
2015 ADT = 8,400
P.V = 79.5% S.U. = 13.4% M.U. = 7.1%

STATE OF ILLINOIS
DEPARTMENT OF TRANSPORTATION

SUBMITTED 03/17 2017
Kevin Marshall (WED) REGIONAL ENGINEER
May 12 2017
Marjorie M. Addis, P.E. ENGINEER OF DESIGN AND ENVIRONMENT
May 12 2017
[Signature] DIRECTOR OF PROGRAM DEVELOPMENT

**PRINTED BY THE AUTHORITY
OF THE STATE OF ILLINOIS**

GENERAL NOTES

THE THICKNESS OF HMA SHOWN ON THE PLANS IS THE NOMINAL THICKNESS. DEVIATIONS FROM THE NOMINAL THICKNESS WILL BE PERMITTED WHEN SUCH DEVIATIONS OCCUR DUE TO IRREGULARITIES IN THE EXISTING SURFACE OR BASE ON WHICH THE HMA IS PLACED.

THE HMA SURFACE OF ALL MAILBOX TURNOUTS, PRIVATE ENTRANCES, COMMERCIAL ENTRANCES, AND SIDE ROADS SHALL BE MADE NEATLY, IN A WORKMANLIKE MANNER, AND SHALL ACCURATELY CONFORM TO THE SHAPES AND DIMENSIONS SHOWN ON THE PLAN DETAILS. IF REQUIRED BY THE ENGINEER, THE CONTRACTOR SHALL SAW CUT THE HMA SURFACE TO CONFORM TO THE SHAPES AND DIMENSIONS SHOWN ON THE PLAN DETAILS. THIS WORK WILL BE INCLUDED IN THE COST OF THE HMA SURFACE.

THE ENGINEER WILL BE THE SOLE JUDGE CONCERNING CURING TIME FOR THE VARIOUS HMA LIFTS.

SEEDING WILL NOT BE PERMITTED AT ANY TIME WHEN THE GROUND IS FROZEN, WET, OR IN AN UNTILLABLE CONDITION. LOCATIONS TO BE SEEDED WILL BE DETERMINED BY THE ENGINEER.

ALL EXCAVATED MATERIAL, WHICH INCLUDES DIGGING OR GRADING OF ANY SOIL OR FILL MATERIAL, WITH THE EXCEPTION OF AGGREGATE FILLS, MUST BE INCORPORATED WITHIN THE IDOT RIGHT OF WAY DUE TO ENVIRONMENTAL DOCUMENTATION REQUIREMENTS.

DETECTABLE WARNING SURFACES SHALL EXTEND 2.0 FT MINIMUM IN THE DIRECTION OF PEDESTRIAN TRAVEL. AT CURB RAMPS AND BLENDED TRANSITIONS, DETECTABLE WARNING SURFACES SHALL EXTEND THE FULL WIDTH OF THE RAMP RUN (EXCLUDING ANY FLARES) OR BLENDED TRANSITIONS. SOME DETECTABLE WARNING PRODUCTS REQUIRE A CONCRETE BORDER FOR PROPER INSTALLATION. THE CONCRETE BORDER SHALL NOT EXCEED 2 INCHES.

ALL ELEVATIONS REFERRING TO U.S.G.S. MEAN SEA LEVEL DATUM.

ANY REFERENCE TO A STANDARD IN THESE PLANS SHALL BE INTERPRETED TO MEAN THE EDITION AS INDICATED BY THE SUBNUMBER SHOWN IN THE LIST OF STANDARDS OR THE COPY INCLUDED IN THESE PLANS.

THE FOLLOWING RATES OF APPLICATION HAVE BEEN USED IN CALCULATING PLAN QUANTITIES:

GRANULAR MATERIALS	2.05	TONS / CU YD
HMA RESURFACING	112	LBS / SQ YD / IN
SHORT TERM PAVEMENT MARKING	10	FT / 100 FT OF APPLICATION
MIX FOR CRACKS, JTS & FLGWYS	0.0003	TONS / SQ YD
LEVEL BINDER (HAND METHOD)	0.0005	TONS / SQ YD

THE CONTRACTOR SHALL CONTACT JULIE AT LEAST 48 HOURS PRIOR TO EXCAVATION TO DETERMINE WHICH UTILITIES ARE IN THE AREA.

HMA MIXTURE REQUIREMENT TABLE

LOCATION(S):	ENTIRE PROJECT	ENTIRE PROJECT	ENTIRE PROJECT
MIXTURE USE(S):	HMA SURFACE	HMA LEVEL BINDER	HMA INCIDENTAL
BINDER GRADE (PG):	PG 64-22	PG 64-22	PG 64-22
DESIGN AIR VOIDS:	4.0% @ N70	4.0% @ N70	4.0% @ N50
MIXTURE COMPOSITION: (MIXTURE GRADATION)	IL 9.5	IL 9.5FG	IL 9.5
FRICTION AGGREGATE:	MIXTURE D		
MIXTURE WEIGHT:	112.0 LB/SY/IN	112.0 LB/SY/IN	112.0 LB/SY/IN
QUALITY MANAGEMENT PROGRAM:	OCP	OCP	OCPA
SUBLOT SIZE:	1000	1000	NA
DENSITY TEST METHOD:	CORES	GROWTH CURVE	SATISFACTION OF ENGINEER

COMMITMENTS

STATE OF ILLINOIS
DEPARTMENT OF TRANSPORTATION
DISTRICT THREE
AS BUILT INFORMATION

SUPERVISING CONSTRUCTION FIELD ENGINEER

RESIDENT ENGINEER / TECHNICIAN

START & END DATES
OF CONSTRUCTION:

INSPECTORS:

STATE OF ILLINOIS
DEPARTMENT OF TRANSPORTATION
DISTRICT THREE

PREPARED BY: Tom Beavil
DISTRICT STUDIES & PLANS ENGINEER

DATE: 3-20-17

EXAMINED BY: [Signature]
DISTRICT CONSTRUCTION ENGINEER

Michael A. Short
DISTRICT MATERIALS ENGINEER

[Signature]
DISTRICT OPERATIONS ENGINEER

STATE OF ILLINOIS
DEPARTMENT OF TRANSPORTATION

GENERAL NOTES

FILE NAME	USER NAME	DESIGNED	REVISED	STATE OF ILLINOIS DEPARTMENT OF TRANSPORTATION	GENERAL NOTES	F.A.P. RTE.	SECTION	COUNTY	TOTAL SHEETS	SHEET NO.	
c:\pwork\pwork\dot\corcoran\m\0250223\066801-sht-cover.dgn	corcoran	DRAWN	REVISED			330	15RS-5 & 16RS-4	KANKAKEE	23	2	
PLOT SCALE	CHECKED	REVIS	REVIS			CONTRACT NO. 66801					
PLOT DATE	DATE	REVIS	REVIS			ILLINOIS FED. AID PROJECT					
SCALE:	SHEET	OF	SHEETS	STA.	TO STA.						

CODE NO.	ITEM	UNIT	TOTAL QUANTITY	CONSTRUCTION CODE	
				80% FEDERAL 20% STATE	
				ROADWAY 0005 URBAN	ROADWAY 0005 RURAL
40600290	BITUMINOUS MATERIALS (TACK COAT)	POUND	40142	7229	32913
40600400	MIXTURE FOR CRACKS, JOINTS, AND FLANGEWAYS	TON	17	3	14
40600537	LEVELING BINDER (HAND METHOD), IL-9.5FG, N70	TON	29	5	24
40600637	LEVELING BINDER (MACHINE METHOD), IL-9.5FG, N70	TON	2444	442	2002
40600990	TEMPORARY RAMP	SQ YD	389	106	283
40603340	HOT-MIX ASPHALT SURFACE COURSE, MIX "D", N70	TON	5002	902	4100
40800050	INCIDENTAL HOT-MIX ASPHALT SURFACING	TON	106	16	90
42400100	PORTLAND CEMENT CONCRETE SIDEWALK 4 INCH	SQ FT	203	203	
42400800	DETECTABLE WARNINGS	SQ FT	21	21	
44000155	HOT-MIX ASPHALT SURFACE REMOVAL, 1 1/2"	SQ YD	1258	185	1073
44000158	HOT-MIX ASPHALT SURFACE REMOVAL, 2 1/4"	SQ YD	58175	10516	47659
44000500	COMBINATION CURB AND GUTTER REMOVAL	FOOT	41	41	
44000600	SIDEWALK REMOVAL	SQ FT	203	203	
48101200	AGGREGATE SHOULDERS, TYPE B	TON	10997	2489	8508

14

△ SPECIALTY ITEMS

FILE NAME =	USER NAME = ee-cooranlm	DESIGNED -	REVISED -	STATE OF ILLINOIS DEPARTMENT OF TRANSPORTATION	SUMMARY OF QUANTITIES				F.A.P. RTE.	SECTION	COUNTY	TOTAL SHEETS	SHEET NO.
Documents\DOT Offices\District 3\Projects\036	Drawn Data\03688801-shs-S00.dgn	DRAWN	REVISED -		330	15RS-5 & 16 RS-4	KANKAKEE	23	3				
PLOT SCALE = 1/8" = 1' in.	CHECKED -	REVISED -	SCALE:		SHEET NO.	OF	SHEETS	STA.	TO STA.	ILLINOIS FED. AID PROJECT			
PLOT DATE = 3/28/2017	DATE -	REVISED -											

CODE NO.	ITEM	UNIT	TOTAL QUANTITY	CONSTRUCTION CODE	
				80% FEDERAL 20% STATE	
				ROADWAY 0005 URBAN	ROADWAY 0005 RURAL
60603800	COMBINATION CONCRETE CURB AND GUTTER, TYPE B-6.12	FOOT	41	41	
66700205	PERMANENT SURVEY MARKERS, TYPE I	EACH	5	1	4
67000400	ENGINEER'S FIELD OFFICE, TYPE A	CAL MO	2	0.25	1.75
67100100	MOBILIZATION	LSUM	1	0.25	0.75
70100450	TRAFFIC CONTROL AND PROTECTION, STANDARD 701201	LSUM	1	0.25	0.75
70100460	TRAFFIC CONTROL AND PROTECTION, STANDARD 701306	LSUM	1	0.25	0.75
70102642	TRAFFIC CONTROL AND PROTECTION, STANDARD 701801	EACH	2	2	
70300100	SHORT TERM PAVEMENT MARKING	FOOT	8613	2601	6012
70300150	SHORT TERM PAVEMENT MARKING REMOVAL	SO FT	957	289	668
70300210	TEMPORARY PAVEMENT MARKING LETTERS AND SYMBOLS	SO FT	251	131	120
70300220	TEMPORARY PAVEMENT MARKING - LINE 4"	FOOT	46207	8539	37668
70300240	TEMPORARY PAVEMENT MARKING - LINE 6"	FOOT	4567	783	3784
70300250	TEMPORARY PAVEMENT MARKING - LINE 8"	FOOT	1578	377	1201
70300260	TEMPORARY PAVEMENT MARKING - LINE 12"	FOOT	795	300	495

14

Δ SPECIALTY ITEMS

FILE NAME :	USER NAME :	DESIGNED :	REVISED :	STATE OF ILLINOIS DEPARTMENT OF TRANSPORTATION	SUMMARY OF QUANTITIES	F.A.P. RTE.	SECTION	COUNTY	TOTAL SHEETS	SHEET NO.	
Documents\DOT Offices\District 3\Projects\036\EDRAWING\0366801-shi-500.dgn	EDRAWING	REVISED	REVISED			330	15RS-5 & 16 RS-4	KANKAKEE	23	4	
PLOT SCALE * 1/8" = 1' in.	CHECKED	REVISED	REVISED			CONTRACT NO. 66B01		ILLINOIS FED. AID PROJECT			
PLOT DATE * 3/22/2017	DATE	REVISED	REVISED			SCALE:	SHEET NO.	OF	SHEETS	STA.	TO STA.

CODE NO.	ITEM	UNIT	TOTAL QUANTITY	CONSTRUCTION CODE		
				80% FEDERAL 20% STATE		
				ROADWAY 0005 URBAN	ROADWAY 0005 RURAL	
	70300280	TEMPORARY PAVEMENT MARKING - LINE 24"	FOOT	278	138	140
Δ	78000100	THERMOPLASTIC PAVEMENT MARKING - LETTERS AND SYMBOLS	SO FT	251	131	120
Δ	78000200	THERMOPLASTIC PAVEMENT MARKING - LINE 4"	FOOT	10935	4044	6891
Δ	78000400	THERMOPLASTIC PAVEMENT MARKING - LINE 6"	FOOT	284	284	0
Δ	78000500	THERMOPLASTIC PAVEMENT MARKING - LINE 8"	FOOT	1578	377	1201
Δ	78000600	THERMOPLASTIC PAVEMENT MARKING - LINE 12"	FOOT	795	300	495
Δ	78000650	THERMOPLASTIC PAVEMENT MARKING - LINE 24"	FOOT	278	138	140
Δ	78001110	PAINT PAVEMENT MARKING - LINE 4"	FOOT	70543	8990	61553
Δ	78001130	PAINT PAVEMENT MARKING - LINE 6"	FOOT	8566	998	7568
Δ	78100100	RAISED REFLECTIVE PAVEMENT MARKER	EACH	342	77	265
Δ	78200020	CURB REFLECTORS	EACH	47	11	36
	78300200	RAISED REFLECTIVE PAVEMENT MARKER REMOVAL	EACH	342	77	265
Δ	88600100	DETECTOR LOOP, TYPE I	FOOT	1504	1504	0
	X0327980	PAVEMENT MARKING REMOVAL - WATER BLASTING	SO FT	20340	4196	16144

Δ SPECIALTY ITEMS

FILE NAME =	USER NAME =	DESIGNED =	REVISED =	STATE OF ILLINOIS DEPARTMENT OF TRANSPORTATION	SUMMARY OF QUANTITIES			F.A.P. RTE.	SECTION	COUNTY	TOTAL SHEETS	SHEET NO.
p:\L\046BID\INTEG.illinois.gov\FW\DOT\Documents\DOT Offices\District 3\Projects\036	00000000	00000000	00000000					330	ISRS-5 & 16 RS-4	KANKAKEE	23	5
PLT SCALE = 1/8" = 1' / in.	CHECKED =	REVISED =	REVISED =		SCALE: SHEET NO. OF SHEETS STA. TO STA.			CONTRACT NO. 66B01				
PLOT DATE = 3/20/2017	DATE =	REVISED =	REVISED =		ILLINOIS FED. AID PROJECT							

11/17/17

CODE NO.	ITEM	UNIT	TOTAL QUANTITY	CONSTRUCTION CODE	
				80% FEDERAL 20% STATE	
				ROADWAY 0005 URBAN	ROADWAY 0005 RURAL
Δ X7830076	GROOVING FOR RECESSED PAVEMENT MARKING 9"	FOOT	1117	377	740
Δ X7830090	GROOVING FOR RECESSED PAVEMENT MARKING 25"	FOOT	278	138	140
Δ X8860100	LOOP DETECTOR TESTING	EACH	1	1	
Z0030850	TEMPORARY INFORMATION SIGNING	SO FT	42	21	21
Z0034105	MATERIAL TRANSFER DEVICE	TON	7446	1344	6102
X3200003	HOT-MIX ASPHALT SURFACE REMOVAL - LONGITUDINAL JOINTS	SO YD	1370	216	1154

6 Δ SPECIALTY ITEMS

FILE NAME =	USER NAME = ccorranlm	DESIGNED -	REVISED -	STATE OF ILLINOIS DEPARTMENT OF TRANSPORTATION	SUMMARY OF QUANTITIES				F.A.P. RTE.	SECTION	COUNTY	TOTAL SHEET SHEETS	SHEET NO.
p:\L284EB\INTEG.illinois.gov\PI\DOT\Docu	ments\DOT Offices\District 3\Projects\036	DRAWN	REVISED		330	15RS-5 & 16 RS-4	KANKAKEE	23	6				
		CHECKED -	REVISED -		CONTRACT NO. 66B01								
		DATE -	REVISED -		SCALE:	SHEET NO.	OF	SHEETS	STA.	TO STA.	ILLINOIS FED. AID PROJECT		

REV

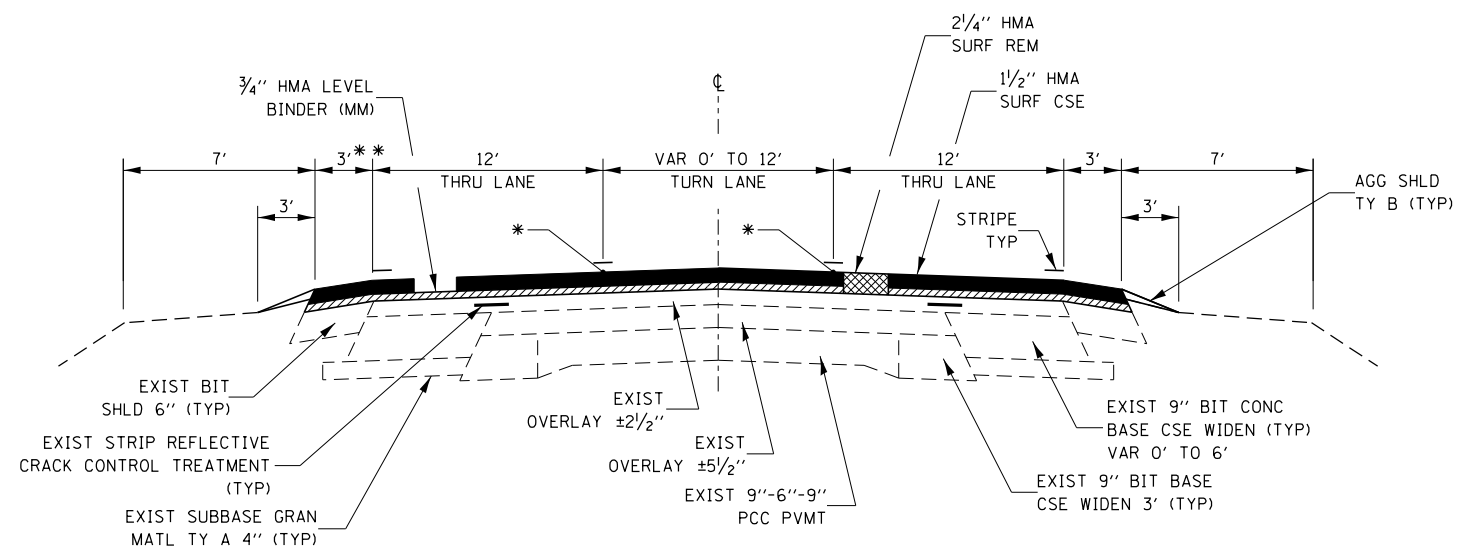

TYPICAL SECTION

STA 224+50 TO STA 232+02

**** NOTES:**

1. BITUMINOUS SHOULDER
10' ADJACENT TO CORNER RADII
AND 4' AROUND CORNER RADII
2. 12' RT TURN LANE ON SOUTH LEG OF
ST. GEORGE ROAD INTERSECTION

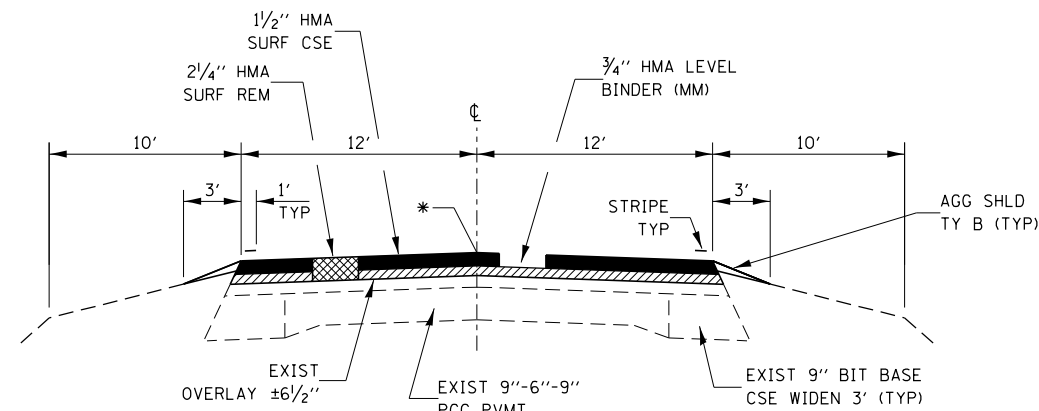

TYPICAL SECTION

STA 232+02 TO STA 256+40.72
STA 293+55.61 TO 431+53
(OMISSION STA 256+40.72 TO STA 293+55.61)

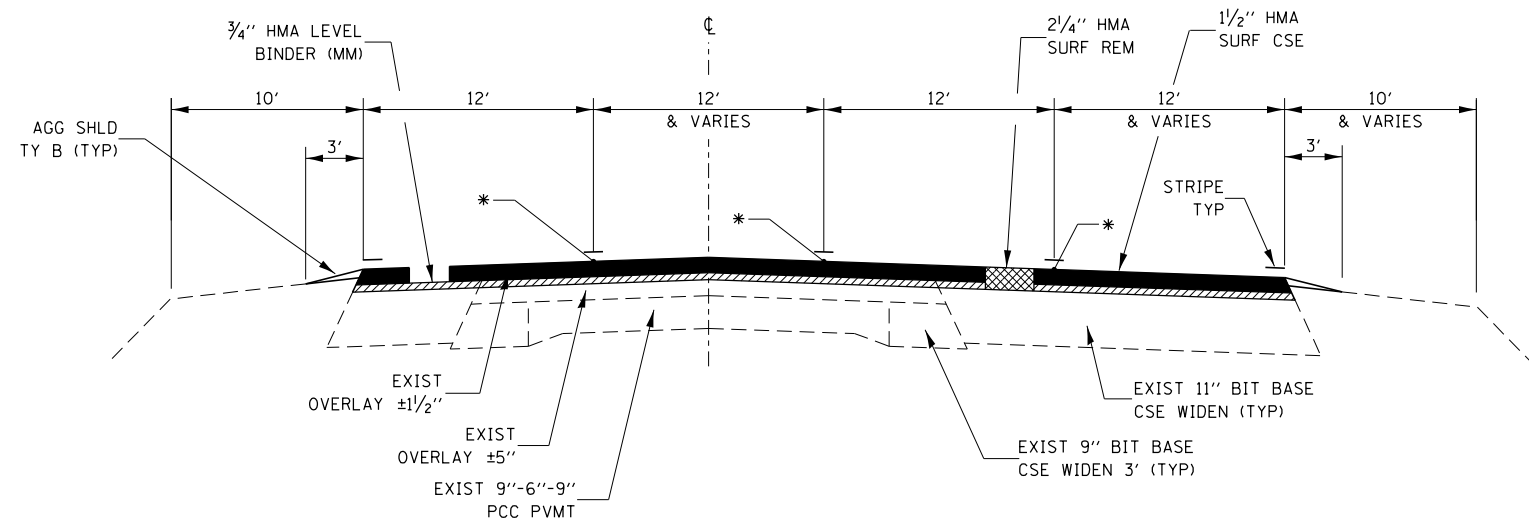

TYPICAL SECTION

STA 431+53 TO STA 433+87
STA 438+78 TO STA 444+13

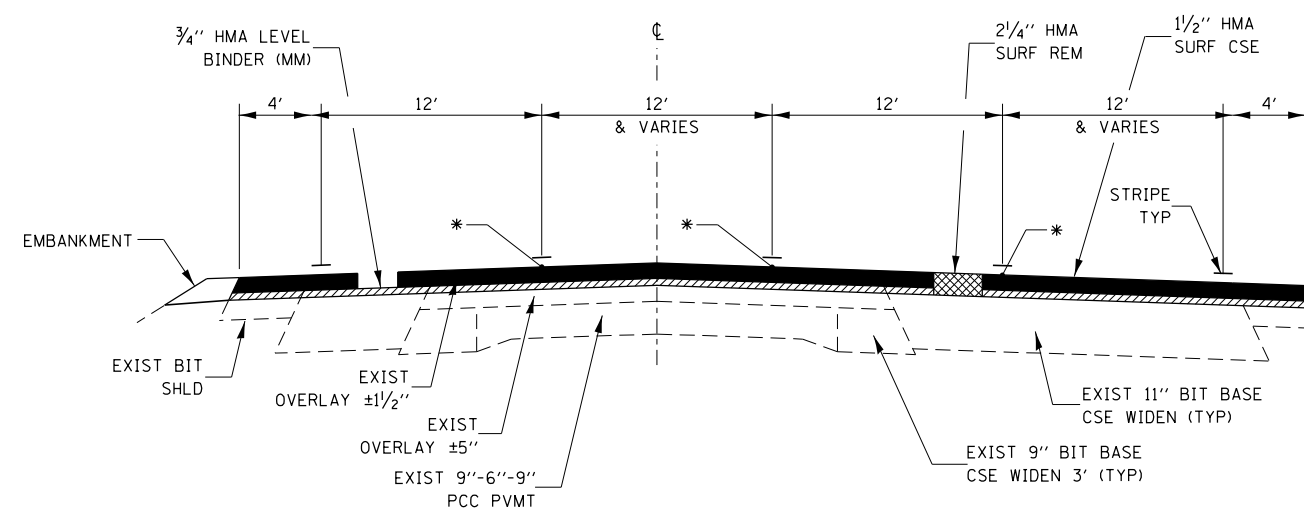

TYPICAL SECTION

STA 433+87 TO STA 438+78

* JOINT TRIMMING AT LONGITUDINAL JOINTS BETWEEN TRAVEL LANES -
SEE SPECIAL PROVISION FOR CONSTRUCTION SEQUENCE FOR JOINT TRIMMING

FILE NAME =	USER NAME = corcoranm	DESIGNED -	REVISED -
p:\11\084EBID\INTEG\illinois.gov\PWIDOT\Documents\IDOT Offices\District 3\Projects\0366801\0366801-sht-typical.dgn		CHECKED -	REVISED -
		DATE -	REVISED -

**STATE OF ILLINOIS
DEPARTMENT OF TRANSPORTATION**

TYPICAL SECTIONS

SCALE: SHEET OF SHEETS STA. TO STA.

F.A.P. RTE.	SECTION	COUNTY	TOTAL SHEETS	SHEET NO.
330	15RS-5 & 16RS-4	KANKAKEE	23	7
CONTRACT NO. 66B01				
ILLINOIS FED. AID PROJECT				

MAINLINE SCHEDULE											
LOCATION	LENGTH	PVMT AREA	HMA SURF CSE	HMA LEVEL BINDER (MM)	HMA SURF REM 2 1/4"	HMA SURF REM LONG JT	BIT MAT (TACK COAT)	MIX FOR CRACKS, JOINTS & FLGWYS	LEVEL BINDER (HM)	TEMP RAMP	AGG SHLD
STA TO STA	FOOT	SQ YD	TON	TON	SQ YD	SQ YD	LB	TON	TON	SQ YD	TON
URBAN:											
224+50 TO 227+22.2	272.2	2809.4	262.3	129.0	3071.0	52.0	2085	0.9	1.5	90	
227+22.2 TO 229+02	179.8	719.2	78.7	38.5	916.8	20	623	0.3	0.5		133
229+02 TO 232+02	300	1000	103.6	50.4	1200.0	33	817	0.4	0.6		308
232+02 TO 252+00	1998	5328	456.9	223.8	5328.0	111	3621	1.6	2.7		2048
URBAN SUBTOTAL			901.5	441.7	10515.8	216	7146	3.2	5.3	90	2489
RURAL:											
252+00 TO 265+40.72	1340.72	3575.3	306.5	150.2	3575.3	74	2430	1.1	1.8		
OMISSION 265+40.72 TO 293+55.61											
293+55.61 TO 355+29.23	6173.62	16463	1411.7	691.4	16463.0	343	11190	4.9	8.2		
OMISSION 355+29.23 TO 357+05.77											
357+05.77 TO 431+53.39	7447.62	19860.3	1703.0	834.1	19860.3	414	13499	6.0	9.9		7634
431+53.39 TO 434+53.39	300	1000	86.8	42.0	1000.0	33	682	0.3	0.5		308
434+53.39 TO 436+33	179.61	838.2	72.9	35.2	838.2	30	573	0.3	0.4		184
436+33 TO 444+13	780	4608.1	519.3	248.7	5922.0	260	4056	1.8	3.0	112	382
RURAL SUBTOTAL			4100.2	2001.6	47658.8	1154	32430	14.3	23.8	112	8508
PROJECT TOTAL	18971.57	56201.5	5001.7	2443.3	58174.6	1370	39576	17.5	29.1	202	10997

SIDE ROAD AND ENTRANCE SCHEDULE						
LOCATION	DESCRIPTION	SURFACE	HMA SURF REM 1-1/2"	TEMP RAMP	BIT MATLS (TACK CT)	INC HMA SURF
STA			SOYD	SOYD	LBS	TON
242+16, RT	MARION DR	HMA	185	16	83	15.5
URBAN TOTAL			185	16	83	15.5
332+50, RT	7000 N RD	HMA	193	13	87	16.2
332+50, LT	7000 N RD	HMA	245	12	110	20.6
360+21, RT	PE	HMA/AGG	44		20	3.7
364+15, RT	PE	HMA/AGG	63		28	5.3
366+15, RT	CE	HMA	73	28	33	6.1
396+35, RT	CE	HMA	122	44	55	10.2
402+84, LT	CE	HMA/AGG	54		24	4.5
424+80, LT	PE W/MBTO	HMA/AGG	106		48	8.9
439+50, RT	CE	HMA	173	74	78	14.5
RURAL TOTAL			1073	171	483	90.0
PROJECT TOTAL			1258	187	566	105.5

SIDEWALK SCHEDULE FOR NEW RAMP INSTALLATION					
LOCATION	PCC SIDEWALK 4"	DETECTABLE WARNINGS	COMB CC&G TYPE B-6.12	SIDEWALK REMOVAL	COMB C&G REMOVAL
	SQ FT	SQ FT	FT	SQ FT	FT
ST.GEORGE					
SE QUAD	57	11	16	57	16
NE QUAD	146	10	25	146	25
TOTALS	203	21	41	203	41

PAVEMENT MARKING																		
STA TO STA	LENGTH FOOT	THERMOPLASTIC PAVEMENT MARKING LINE									PAINT PAVEMENT MARKING - LINE			GROOVING FOR RECESSED PAVEMENT MARKING		CURB REFLECTORS EACH	RAISED REFL PAVEMENT MARKERS EACH	RAISED REFL PAVEMENT MARK REM EACH
		4 INCH		6 INCH		8 INCH	12 INCH		24 INCH	LETTERS & SYMBOLS SQ FT	4 INCH		6 INCH	9 INCH	25 INCH			
		WHITE	YELLOW	WHITE	YELLOW	WHITE	WHITE	YELLOW	WHITE		WHITE	YELLOW	YELLOW					
URBAN:																		
224+23.9 TO 232+02.27	778.37	1724	2320	264	20	377	145	155	138	131				377	138	11	52	52
232+02.27 TO 252+00	1997.73										7990	1000	998				25	25
SUBTOTAL		1724	2320	264	20	377	145	155	138	131	7990	1000	998	377	138	11	77	77
URBAN SUBTOTAL		4044		284		377	300		138	131	8990		998	377	138	11	77	77
RURAL:																		
252+00 TO 265+40.72	1340.72										5362		670				17	17
OMISSION 265+40.72 TO 293+55.61																		
293+55.61 TO 431+53.39	13797.78										55191	1000	6898				172	172
431+53.39 TO 444+13	1259.61	2527	4364	0	0	1201	215	280	140	120				740	140	36	76	76
SUBTOTAL		2527	4364	0	0	1201	215	280	140	120	60553	1000	7568	740	140	36	265	265
RURAL SUBTOTAL		6891		0		1201	495		140	120	61553		7568	740	140	36	265	265
TOTAL		10935		284		1578	795		278	251	70543		8566	1117	278	47	342	342

NOTES:
ADDITIONAL QUANTITY HAS BEEN INCLUDED TO ALLOW FOR TWO SEPARATE APPLICATIONS OF PAINT PAVEMENT MARKING LINE

TEMPORARY PAVEMENT MARKING													
STA TO STA	LENGTH FOOT	TEMPORARY PAVEMENT MARKING LINE									PVMT MARK REM WATER BLAST SQ FT	SHORT TERM PVMT MARK FOOT	SHORT TERM PVMT MARK REM SQ FT
		4 INCH		6 INCH		8 INCH	12 INCH		24 INCH	LETTERS & SYMBOLS SQ FT			
		WHITE	YELLOW	WHITE	YELLOW	WHITE	WHITE	YELLOW	WHITE				
URBAN:													
224+23.9 TO 232+02.27	778.37	1724	2320	264	20	377	145	155	138	131	2448	2001	222
232+02.27 TO 252+00	1997.73	3995	500		499						1748	600	67
SUBTOTAL		5719	2820	264	519	377	145	155	138	131	4196	2601	289
URBAN SUBTOTAL		8539		783		377	300		138	131	4196	2601	289
RURAL:													
252+00 TO 265+40.72	1340.72	2681			335						1061	402	45
OMISSION 265+40.72 TO 293+55.61													
293+55.61 TO 431+53.39	13797.78	27596	500		3449						11090	4140	460
431+53.39 TO 444+13	1259.61	2527	4364	0		1201	215	280	140	120	3993	1470	163
SUBTOTAL		32804	4864	0	3784	1201	215	280	140	120	16144	6012	668
RURAL SUBTOTAL		37668		3784		1201	495		140	120	16144	6012	668
TOTAL		46207		4567		1578	795		278	251	20340	8613	957

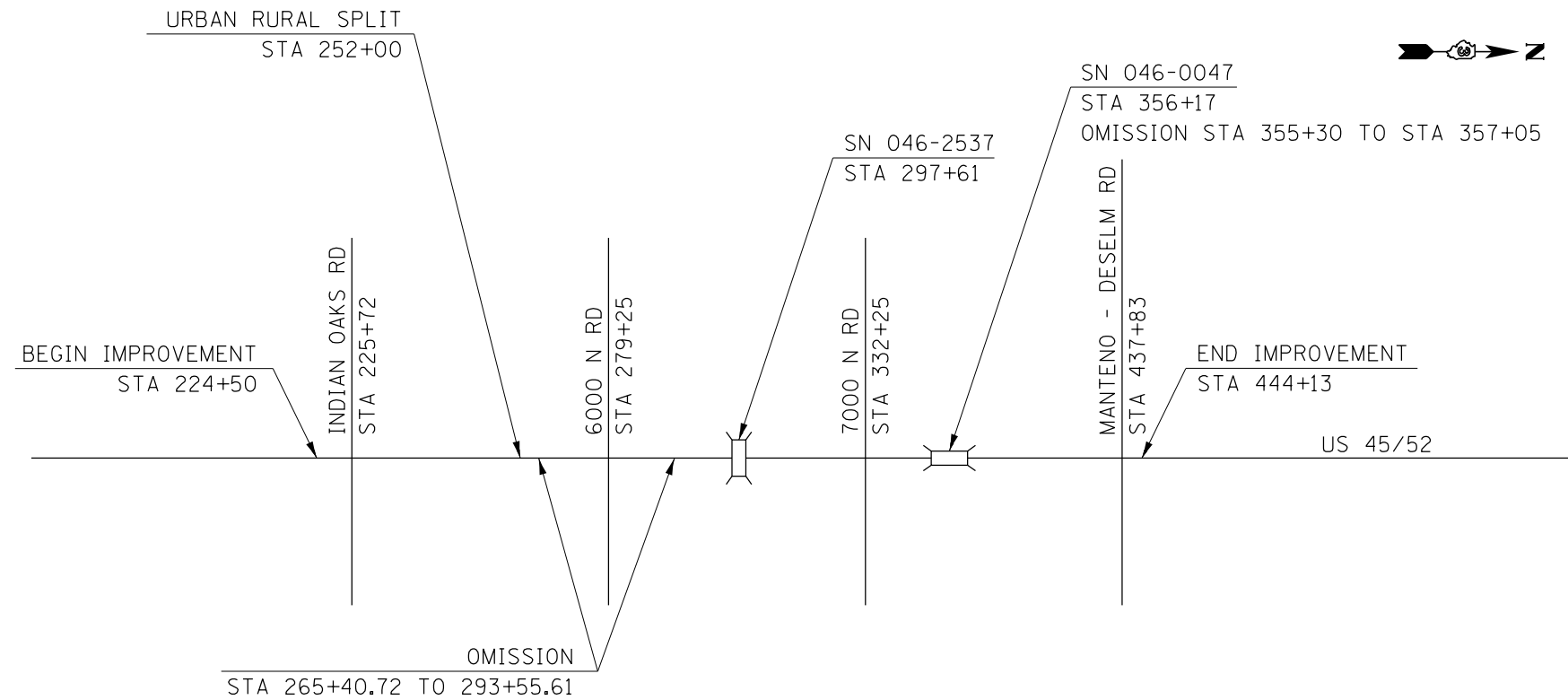

PERMANENT SURVEY MARKER SCHEDULE

INDEX NUMBER	DESCRIPTION	EXISTING MONUMENT TYPE	PROPOSED MONUMENT TYPE	MONUMENT RECORD TO BE RECORDED	RESPONSIBILITY
045200	NW CORNER SECTION 8 T31N R12E 3RD PM	PLAQUE	TYPE 1	YES	1
-	W QTR CORNER SECTION 5 T31N R12 E 3RD PM	-	TYPE 1	YES	1
4552094	W QTR CORNER SECTION 32 T32N R12E 3RD PM	-	TYPE 1	YES	1
4552095	NW CORNER SECTION 32 T32N R12E 3RD PM	IRON ROD	TYPE 1	YES	1
4552100	NW CORNER SECTIN 20 T32N R12E 3RD PM	MAG NAIL	TYPE 1	YES	1

LISTED MONUMENT LOCATIONS AND EXISTING TIES HAVE BEEN RECORDED BY GPS. PRE CONSTRUCTION TIES BY THE R.E. ARE NOT REQUIRED. THE R.E. MUST TIE AND BRING TO THE ATTENTION OF THE PLATS AND PLANS MANAGER ANY ADDITIONAL UNLISTED MONUMENTS FOUND. UPON COMPLETION OF PAVING, THE R.E. WILL INFORM THE PLATS AND PLANS MANAGER TO HAVE AN IDOT LAND SURVEYOR STAKE THE LOCATIONS FOR TYPE 1 CORING. THE EXISTING MONUMENT RECORD TIES ARE OUTDATED. NEW MONUMENT RECORDS WILL BE FILED BY IDOT PLATS AND PLANS SECTION.

RESPONSIBILITY:

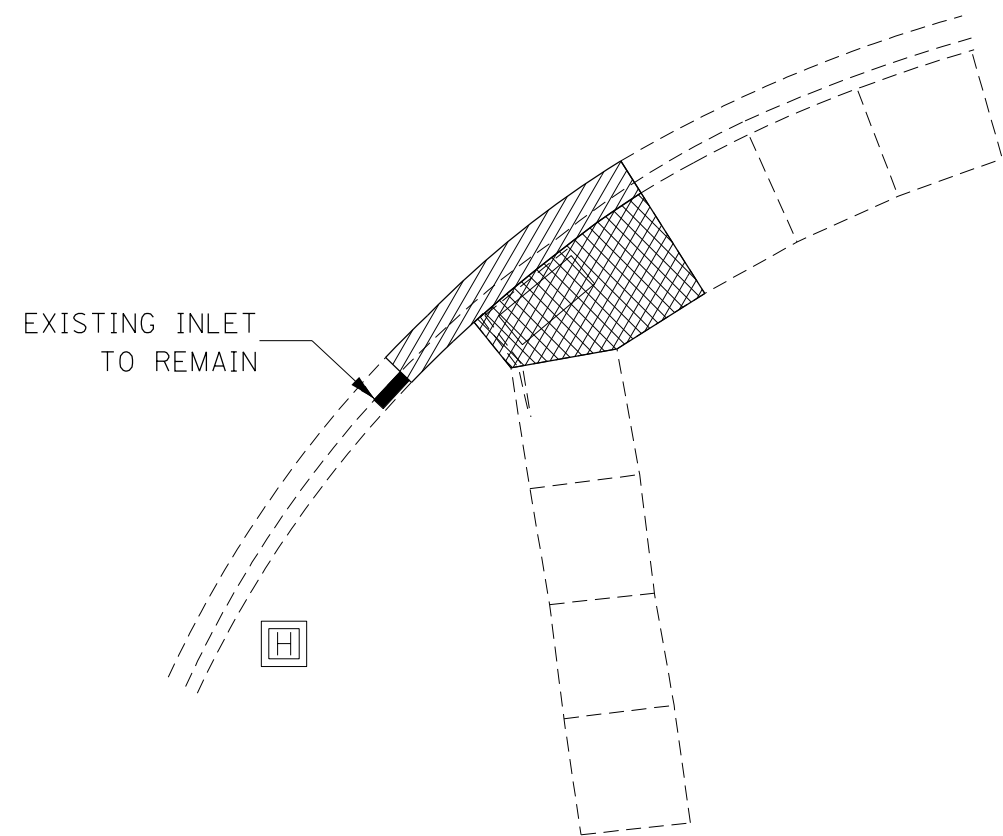
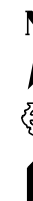

- 1) RESIDENT TO RE-ESTABLISH MONUMENT (PAY ITEM REQUIRED. PERMANENT SURVEY MARKER, TYPE 1)
- 2) PLATS AND PLANS TO RE-ESTABLISH MONUMENT

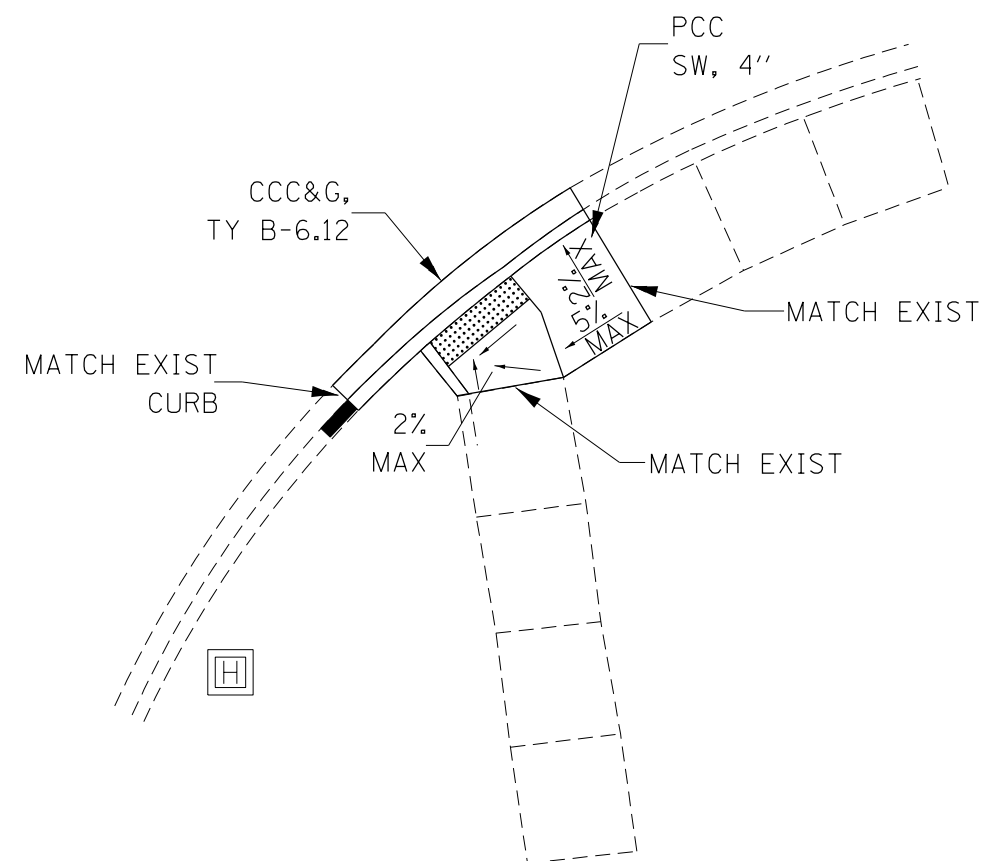

EXISTING SE QUADRANT

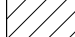

PROPOSED SE QUADRANT

-  DETECTABLE WARNINGS
-  SIDEWALK REMOVAL
-  CCC&G REMOVAL

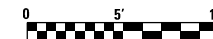

FILE NAME =	USER NAME = corcoranlm	DESIGNED -	REVISED -
p:\11\084EBIDINTEG.illinois.gov\PWIDOT\Documents\DOT Offices\District 3\Projects\0366801\B366801-sht-details.DGN		DRAWN -	REVISED -
Default	PLOT SCALE = 10.0000' / in.	CHECKED -	REVISED -
	PLOT DATE = 3/20/2017	DATE -	REVISED -

**STATE OF ILLINOIS
DEPARTMENT OF TRANSPORTATION**

**ADA RAMP DETAILS
ST GEORGE RD SOUTHEAST QUADRANT**

SCALE: SHEET OF SHEETS STA. TO STA.

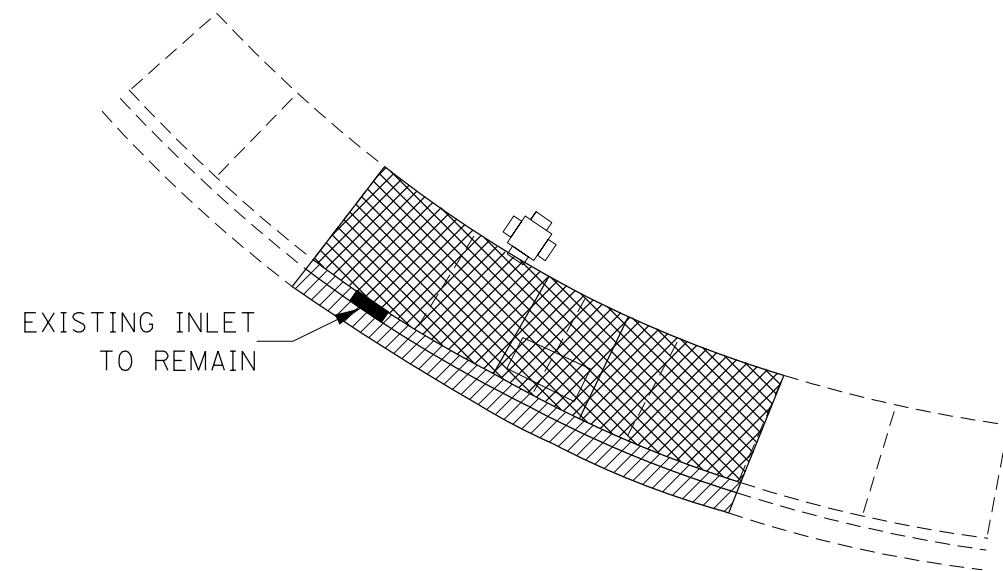

F.A.P. RTE.	SECTION	COUNTY	TOTAL SHEETS	SHEET NO.
330	15RS-5 & 16RS-4	KANKAKEE	23	11
CONTRACT NO. 66B01				
ILLINOIS FED. AID PROJECT				

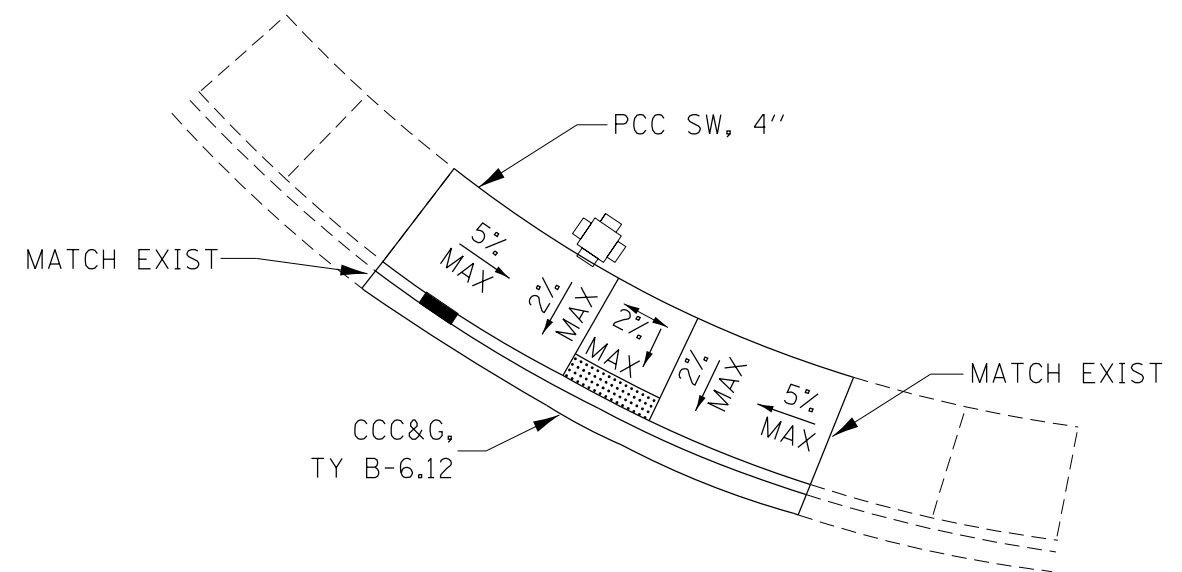

EXISTING NE QUADRANT



PROPOSED NE QUADRANT

-  DETECTABLE WARNINGS
-  SIDEWALK REMOVAL
-  CCC&G REMOVAL

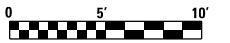

FILE NAME =	USER NAME = corcoranim	DESIGNED -	REVISED -
p:\11\084EBIDINTEG.illinois.gov\PIWIDOT\Documents\IDOT Offices\District 3\Projects\0366801\B366801-sht-details.DGN		DRAWN -	REVISED -
Default	PLOT SCALE = 10.0000' / in.	CHECKED -	REVISED -
	PLOT DATE = 3/20/2017	DATE -	REVISED -

**STATE OF ILLINOIS
DEPARTMENT OF TRANSPORTATION**

**ADA RAMP DETAILS
ST GEORGE RD NORTHEAST QUADRANT**

SCALE: SHEET OF SHEETS STA. TO STA.

F.A.P. RTE.	SECTION	COUNTY	TOTAL SHEETS	SHEET NO.
330	15RS-5 & 16RS-4	KANKAKEE	23	12
CONTRACT NO. 66B01				
ILLINOIS FED. AID PROJECT				

DETECTOR LOOP REPLACEMENT AT INDIAN OAKS		
	DETECTOR LOOP TYPE I	DETECTOR LOOP TESTING
SOUTH LEG	285	
WEST LEG	401	
NORTH LEG	261	
EAST LEG	557	
TOTAL	1504	1

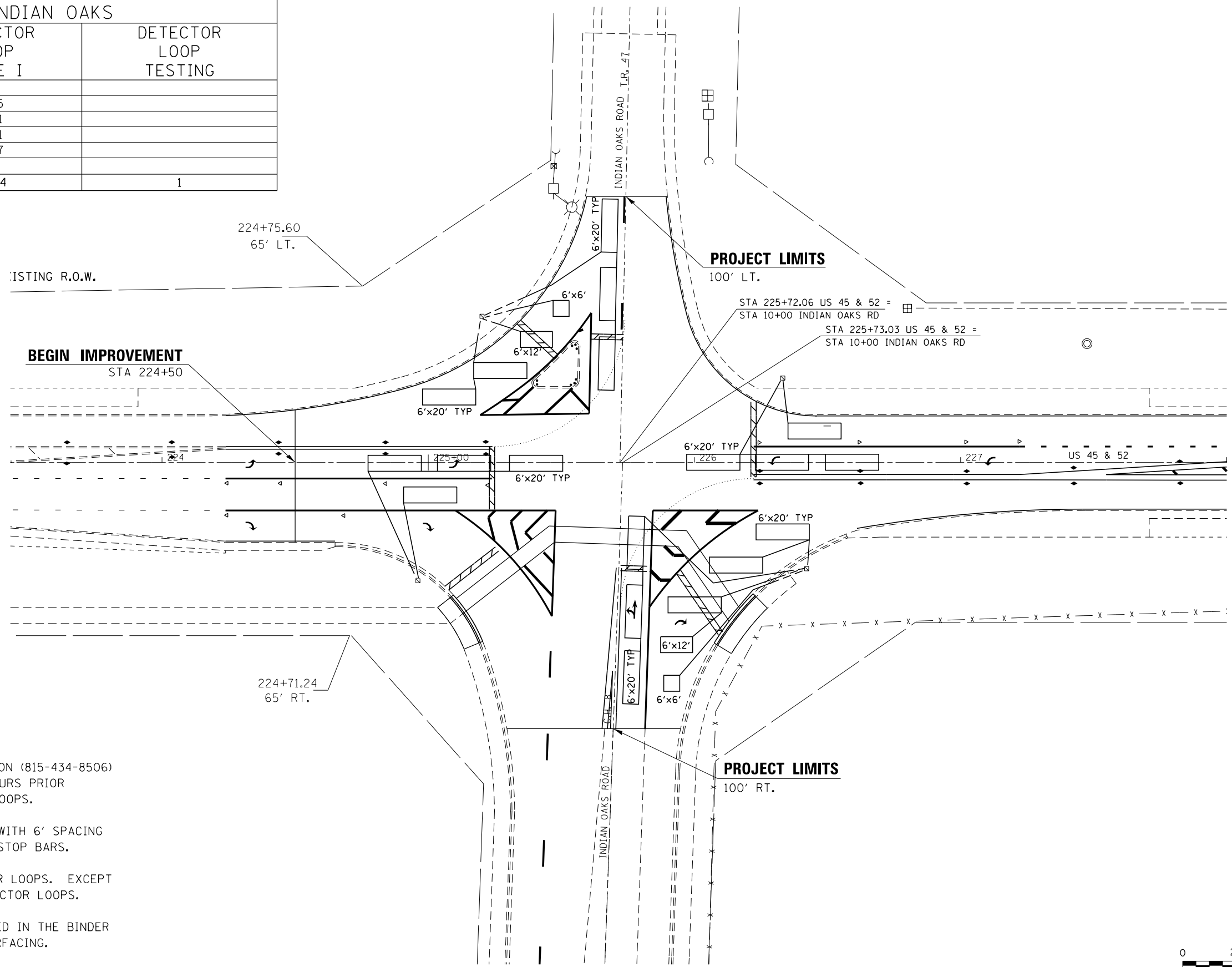

1. THE DEPARTMENT OF TRANSPORTATION (815-434-8506) SHALL BE NOTIFIED AT LEAST 72 HOURS PRIOR TO THE LAYOUT OF THE DETECTOR LOOPS.
2. 6' x 20' TYPICAL DETECTOR LOOPS WITH 6' SPACING 10' FROM PROJECTED EDGE LINE OR STOP BARS.
3. 4 TURNS REQUIRED ON ALL DETECTOR LOOPS. EXCEPT 6 TURNS FOR ADVANCE 6' x 6' DETECTOR LOOPS.
4. DETECTOR LOOPS SHALL BE INSTALLED IN THE BINDER OR MILLED SURFACE PRIOR TO RESURFACING.
5. SAW CUT EXISTING LOOPS TO BE ABANDONED.



FILE NAME =	USER NAME = corcoranlm	DESIGNED -	REVISED -	STATE OF ILLINOIS DEPARTMENT OF TRANSPORTATION	DETECTOR LOOPS DETAILS	F.A.P. RTE.	SECTION	COUNTY	TOTAL SHEETS	SHEET NO.
pw:\IL\084EBIDINTEG\illinois.gov\PWIDOT\Documents\DOT Offices\District 3\Projects\0366801\Drawings\0366801-sht-pmk.dgn		CHECKED -	REVISED -			330	15RS-5 & 16RS-4	KANKAKEE	23	13
Default	PLOT SCALE = 40.0000' / in.	DATE -	REVISED -			CONTRACT NO. 66B01				
	PLOT DATE = 3/20/2017					ILLINOIS FED. AID PROJECT				

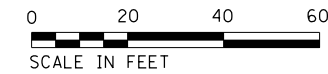
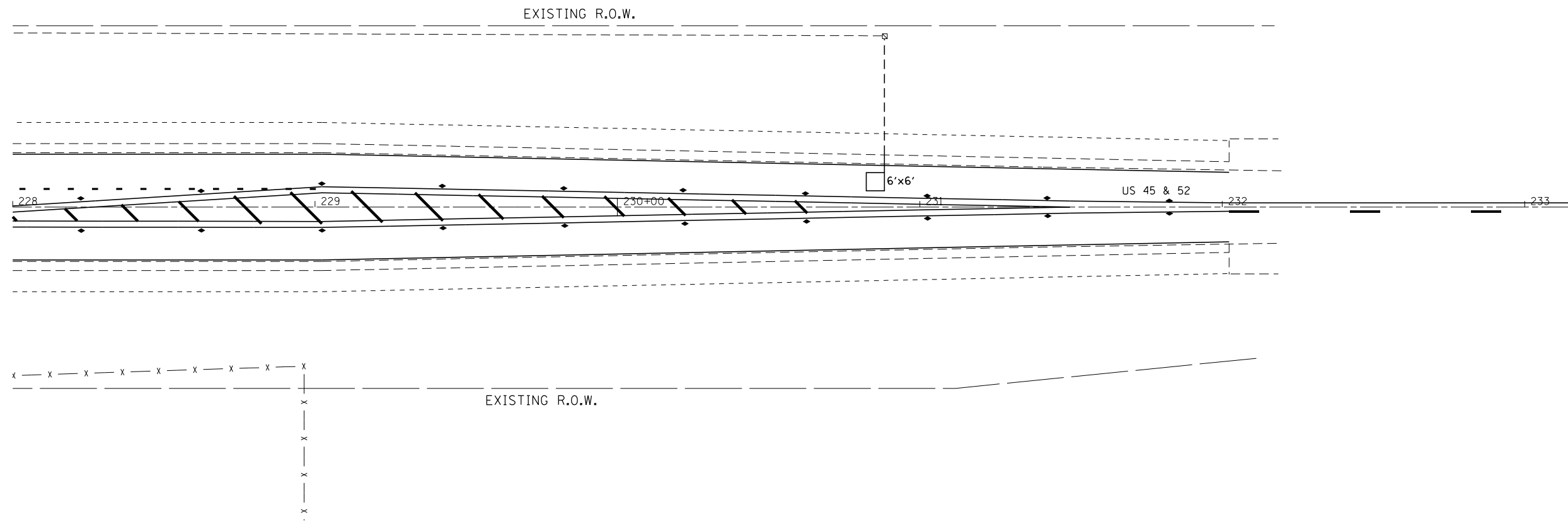

FILE NAME =	USER NAME = corcoranlm	DESIGNED -	REVISED -
p:\11\084EBIDINTEG.illinois.gov\PIWIDOT\Documents\IDOT Offices\District 3\Projects\0366801\B366801-sht-pmk.dgn		DRAWN -	REVISED -
Default	PLOT SCALE = 40.0000' / in.	CHECKED -	REVISED -
	PLOT DATE = 3/20/2017	DATE -	REVISED -

**STATE OF ILLINOIS
DEPARTMENT OF TRANSPORTATION**

DETECTOR LOOPS DETAILS

SCALE: SHEET OF SHEETS STA. TO STA.

F.A.P. RTE.	SECTION	COUNTY	TOTAL SHEETS	SHEET NO.
330	15RS-5 & 16RS-4	KANKAKEE	23	14
CONTRACT NO. 66B01				
ILLINOIS FED. AID PROJECT				

ST GEORGE ROAD

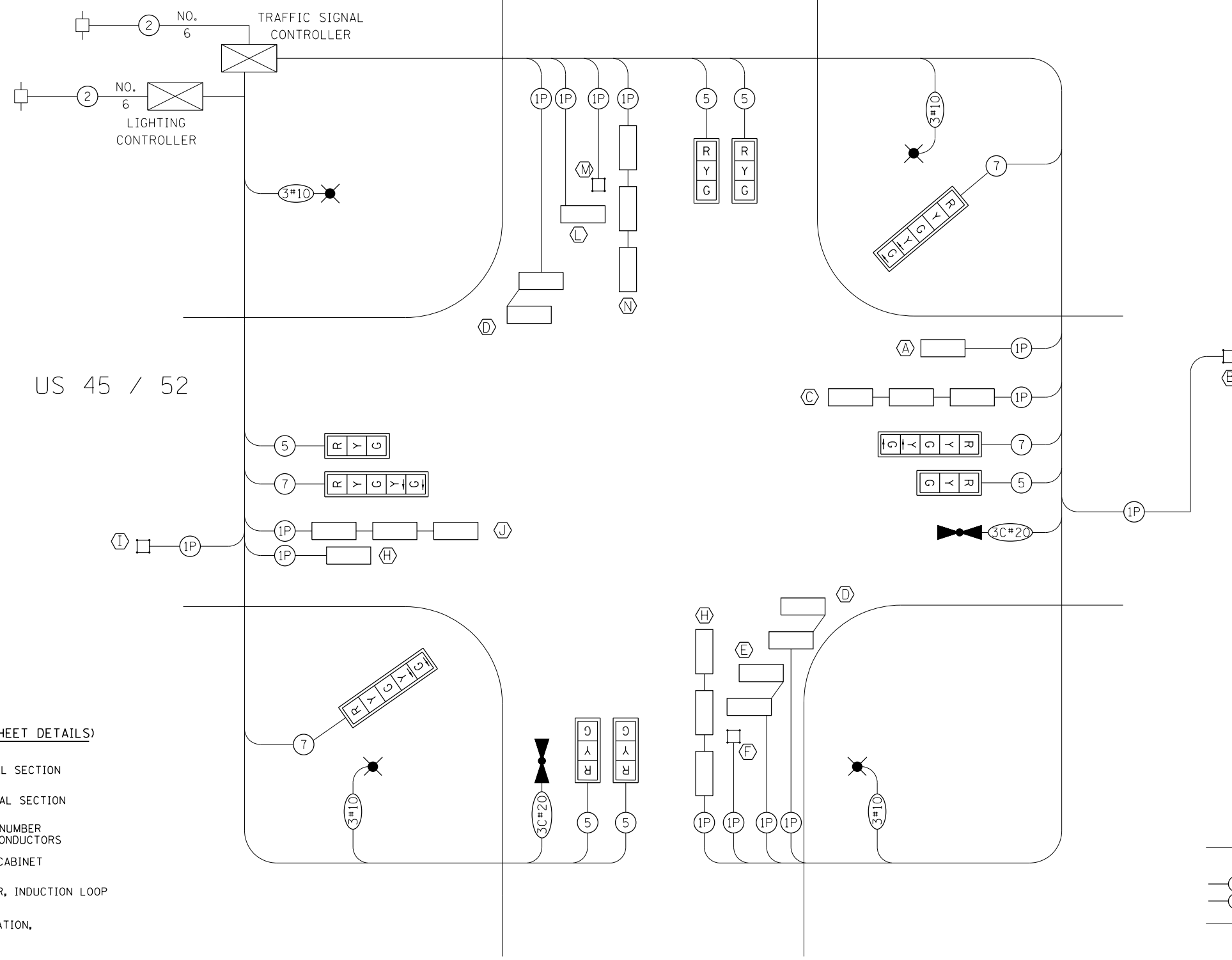

US 45 / 52

TRAFFIC SIGNALS LEGEND (SHEET DETAILS)

- 8" TRAFFIC SIGNAL SECTION
- 12" TRAFFIC SIGNAL SECTION
- PROPOSED CABLE NUMBER
• = NUMBER OF CONDUCTORS
- EX. CONTROLLER CABINET
- VEHICLE DETECTOR, INDUCTION LOOP
- SERVICE INSTALLATION, EXISTING
- DUAL-INDICATION SIGNAL SECTION
- SIGNAL FACE WITH BACKPLATE
"P" INDICATES OPTICAL PROGRAMMING.

PHASE DESIGNATION DIAGRAM
NOT TO SCALE

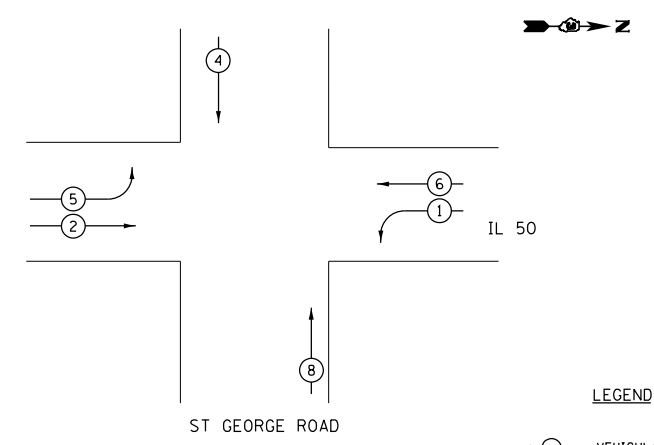

- LEGEND
- VEHICULAR MOVEMENT
 - NUMBER REFERS TO ASSOCIATED PHASE

FILE NAME =	USER NAME = corcoranm	DESIGNED -	REVISED -
p:\1\1084EBIDINTEG\illinois.gov\PWIDOT\Documents\IDOT Offices\District 3\Projects\0366801\B366801-sht-details.DGN		REVISION	REVISION
	PLOT SCALE = 100.0000' / in.	CHECKED -	REVISED -
	PLOT DATE = 3/20/2017	DATE -	REVISED -

STATE OF ILLINOIS
DEPARTMENT OF TRANSPORTATION

DETECTOR LOOP DETAILS

SCALE: SHEET OF SHEETS STA. TO STA.

F.A.P. RTE.	SECTION	COUNTY	TOTAL SHEETS	SHEET NO.
330	15RS-5 & 16RS-4	KANKAKEE	23	15
CONTRACT NO. 66B01				
ILLINOIS FED. AID PROJECT				

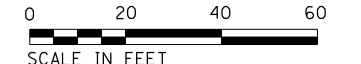
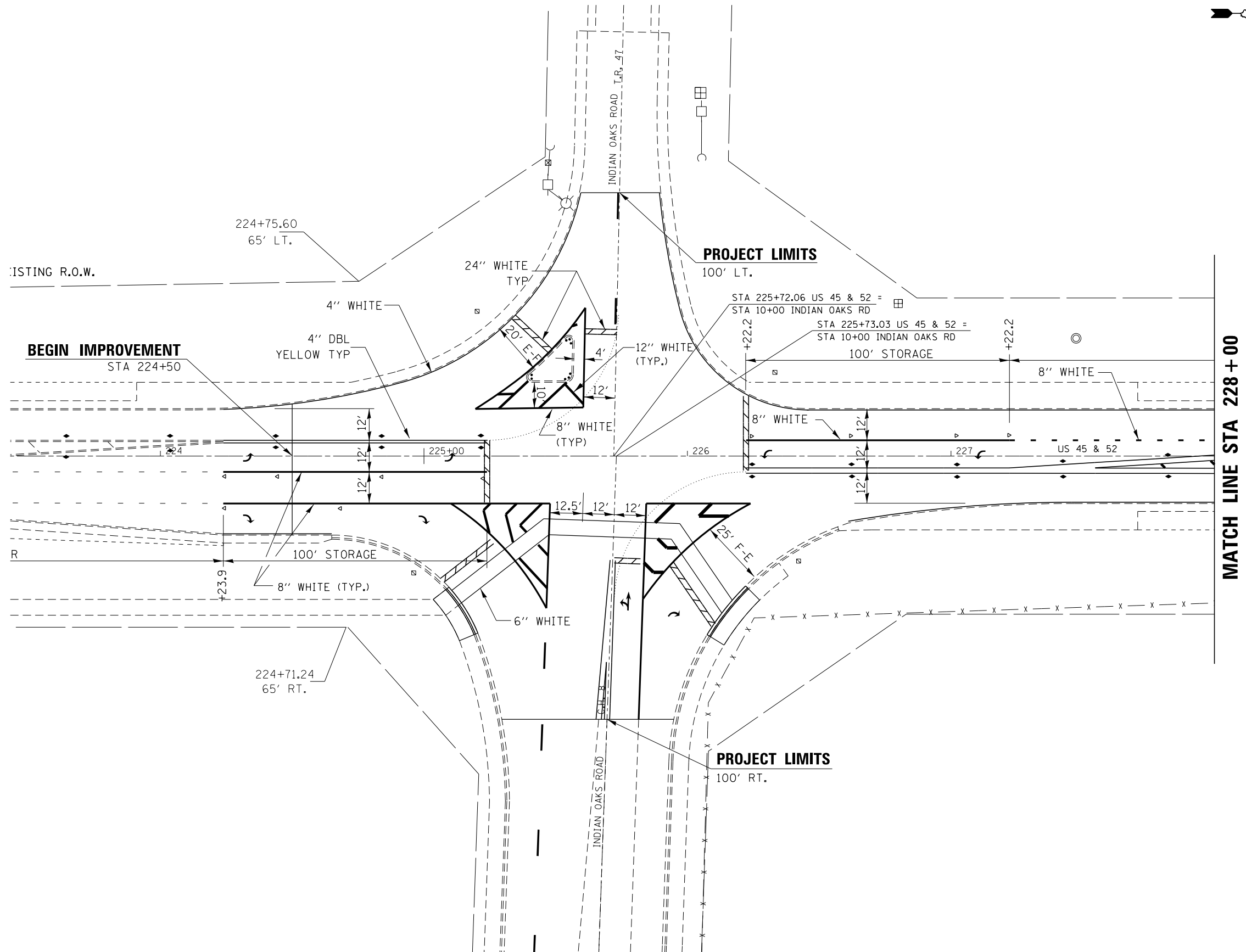

FILE NAME =	USER NAME = corcoranlm	DESIGNED -	REVISED -
p:\work\11084EBIDINTEG\illinois.gov\PI\DOT\Documents\DOT Offices\District 3\Projects\0366801\B366801-sht-pmk.dgn		DRAWN -	REVISED -
Default	PLOT SCALE = 40.0000' / in.	CHECKED -	REVISED -
	PLOT DATE = 3/20/2017	DATE -	REVISED -

**STATE OF ILLINOIS
DEPARTMENT OF TRANSPORTATION**

PAVEMENT MARKING DETAILS			
SCALE:	SHEET	OF SHEETS	STA. TO STA.

F.A.P. RTE.	SECTION	COUNTY	TOTAL SHEETS	SHEET NO.
330	15RS-5 & 16RS-4	KANKAKEE	23	16
CONTRACT NO. 66B01				
ILLINOIS FED. AID PROJECT				

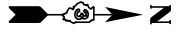

MATCH LINE STA 228 + 00

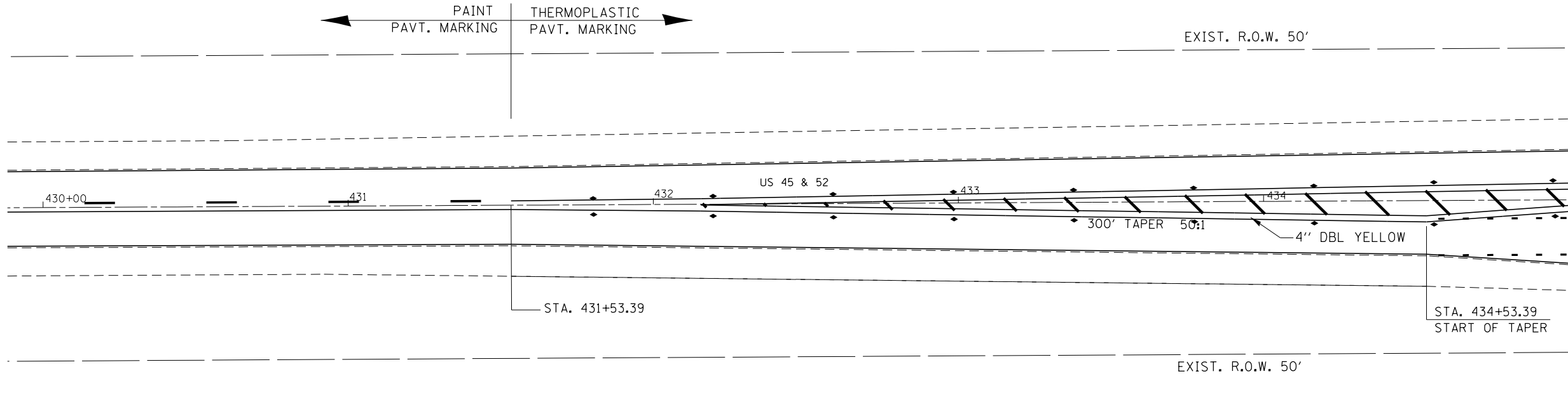
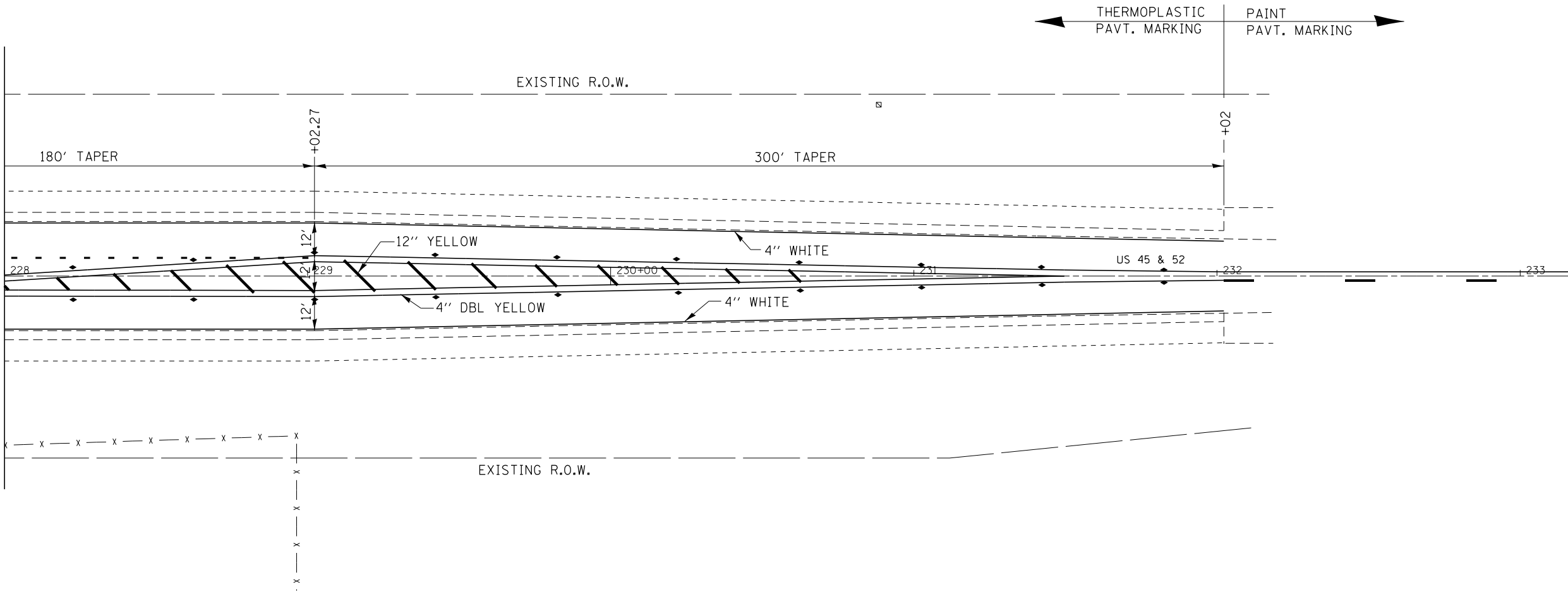

MATCH LINE STA 435 + 00



FILE NAME =	USER NAME = corcoranim	DESIGNED -	REVISED -
p:\11\084EBIDINTEG\illinois.gov\PIWIDOT\Documents\IDOT Offices\District 3\Projects\036666\Drawings\036666-19366801-sht-pmk.dgn		DRAWN -	REVISED -
Default	PLOT SCALE = 40.0000' / in.	CHECKED -	REVISED -
	PLOT DATE = 3/20/2017	DATE -	REVISED -

**STATE OF ILLINOIS
DEPARTMENT OF TRANSPORTATION**

PAVEMENT MARKING DETAILS

SCALE: SHEET OF SHEETS STA. TO STA.

F.A.P. RTE.	SECTION	COUNTY	TOTAL SHEETS	SHEET NO.
330	15RS-5 & 16RS-4	KANKAKEE	23	17
CONTRACT NO. 66B01				
ILLINOIS FED. AID PROJECT				



MATCH LINE STA 435+00

MATCH LINE STA 441+00

PROJECT LIMITS

90' LT.

STA. 437+83.05 MAINLINE =
STA. 10+00 MANTENO ROAD

PROJECT LIMITS

68' RT.

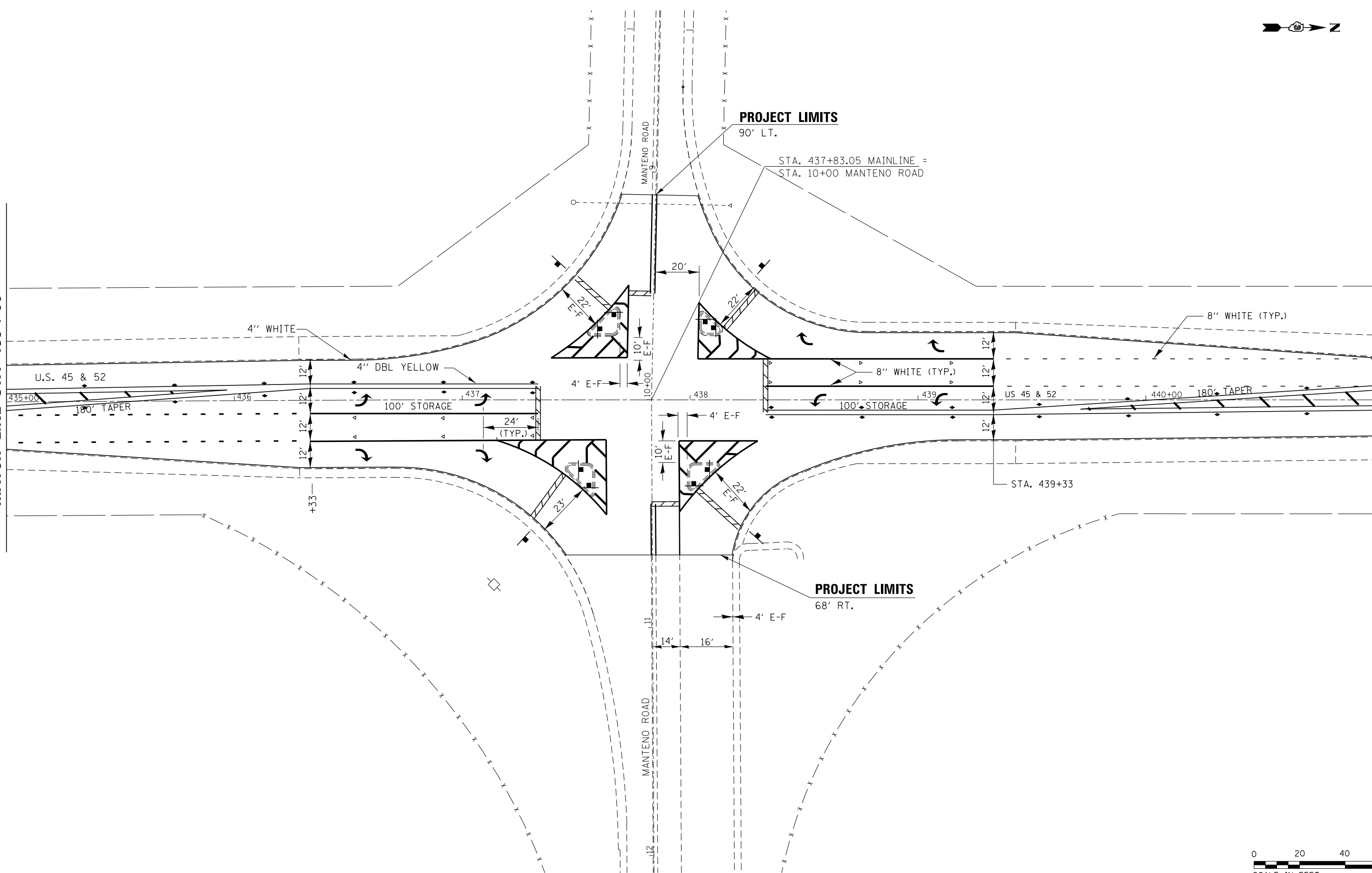

FILE NAME =	USER NAME = corcoranlm	DESIGNED -	REVISED -
p:\work\11084EBID\INTEG.illinois.gov\PI\DOT\Documents\DOT Offices\District 3\Projects\0366801\B366801-sht-pmk.dgn		REVISOR -	REVISED -
Default	PLOT SCALE = 40.0000' / in.	CHECKED -	REVISED -
	PLOT DATE = 3/20/2017	DATE -	REVISED -

**STATE OF ILLINOIS
DEPARTMENT OF TRANSPORTATION**

PAVEMENT MARKING DETAILS

SCALE: SHEET OF SHEETS STA. TO STA.

F.A.P. RTE.	SECTION	COUNTY	TOTAL SHEETS	SHEET NO.
330	15RS-5 & 16RS-4	KANKAKEE	23	18
CONTRACT NO. 66B01				
ILLINOIS FED. AID PROJECT				

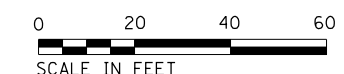
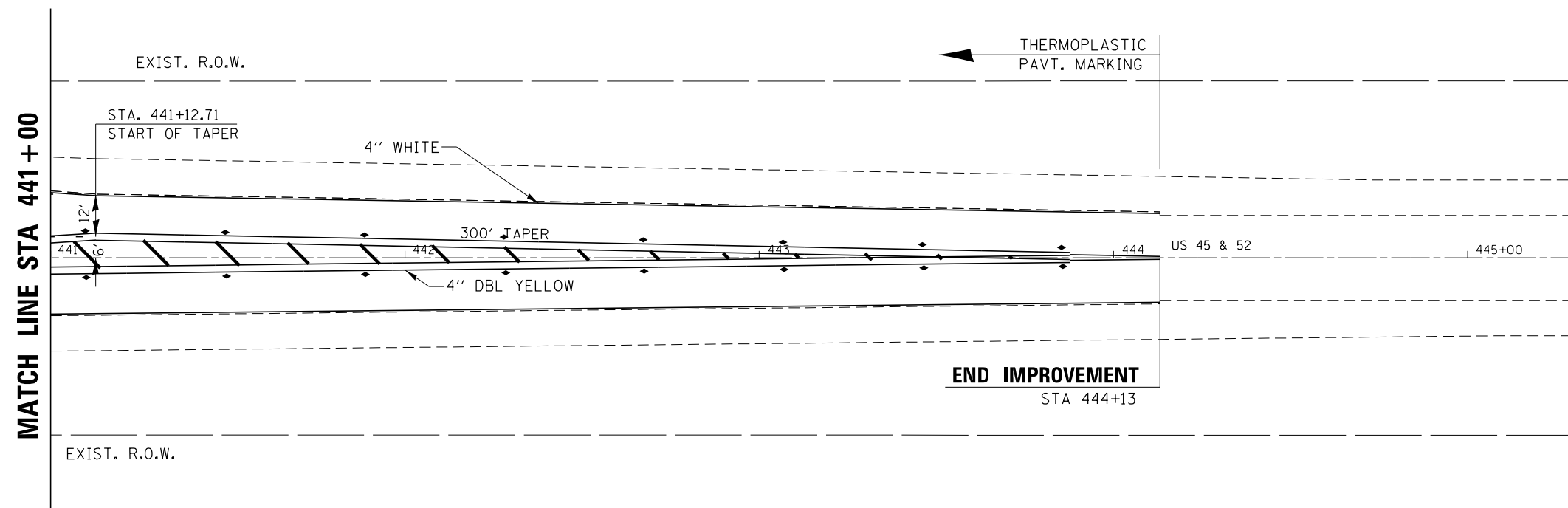

FILE NAME =	USER NAME = corcoranlm	DESIGNED -	REVISED -
p:\11\084EBIDINTEG.illinois.gov\PI\DOT\Documents\DOT Offices\District 3\Projects\036666\DRAWING\03666601-shr-pmk.dgn		CHECKED -	REVISED -
Default	PLOT DATE = 3/20/2017	DATE -	REVISED -

**STATE OF ILLINOIS
DEPARTMENT OF TRANSPORTATION**

PAVEMENT MARKING DETAILS			
SCALE:	SHEET	OF	SHEETS
	STA.		TO STA.

F.A.P. RTE.	SECTION	COUNTY	TOTAL SHEETS	SHEET NO.
330	15RS-5 & 16RS-4	KANKAKEE	23	19
CONTRACT NO. 66B01				
ILLINOIS FED. AID PROJECT				

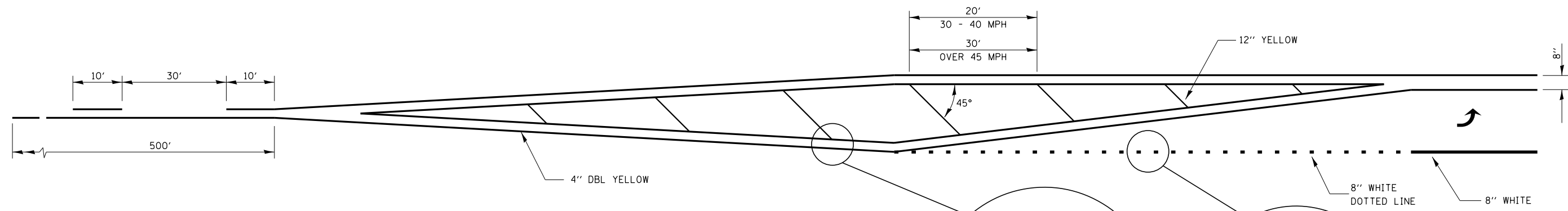

LEFT TURN LANE WITH APPROACH MEDIAN

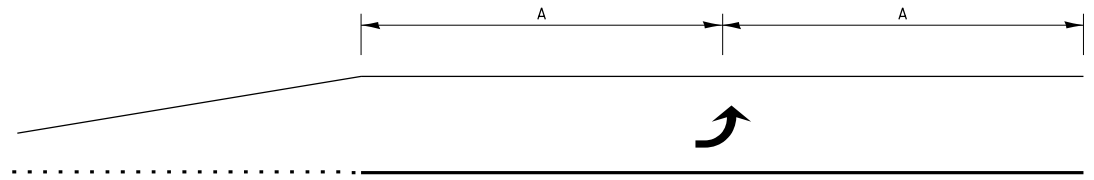
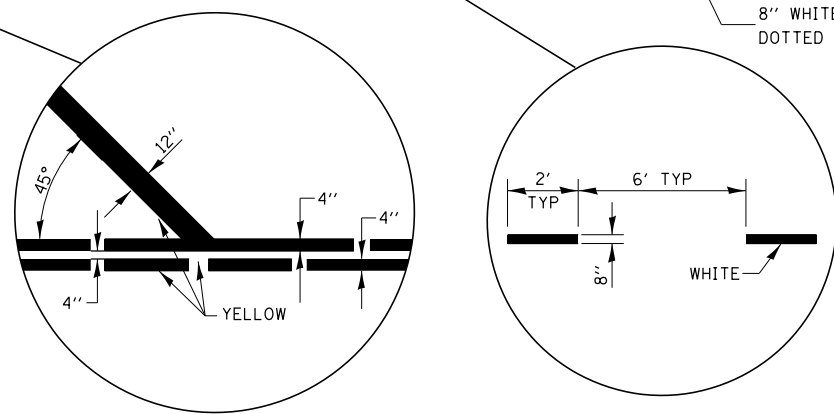

99' AND UNDER

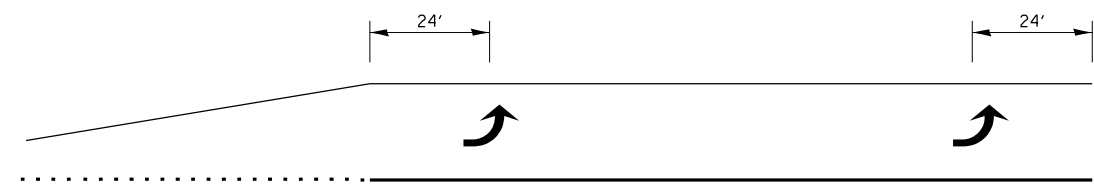

100' TO 149'

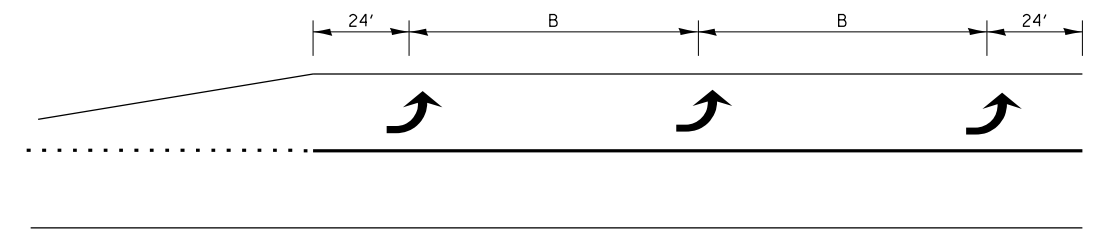

150' AND LONGER

TYPICAL PLACEMENT OF ARROWS IN TURN LANES

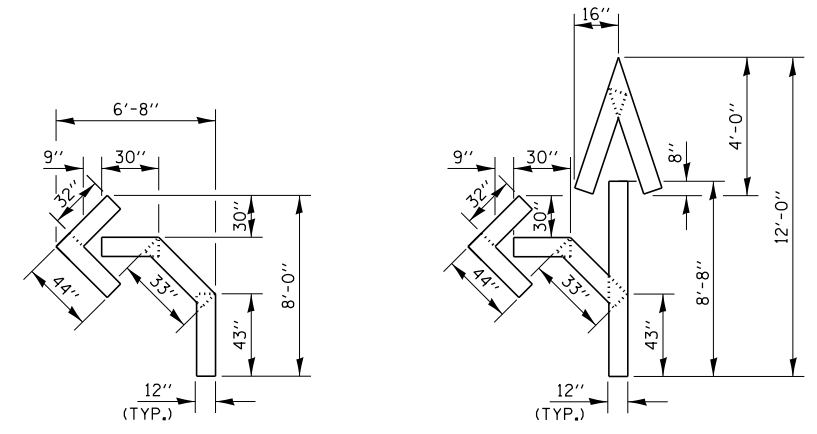

QUANTITY
12" LINE = 16 LIN FT
OR 4" LINE = 48 LIN FT

QUANTITY
12" LINE = 29 LIN FT
OR 4" LINE = 87 LIN FT

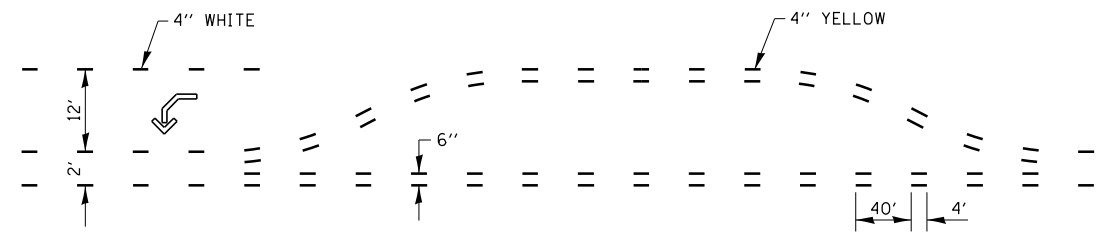

SHORT-TERM PAVEMENT MARKING FOR MEDIANS AND ARROWS

FILE NAME =	USER NAME = corcoranlm	DESIGNED -	REVISED -
p:\work\084EBID\INTEG\illinois.gov\PWIDOT\Documents\IDOT Offices\District 3\Projects\0366801\0366801-sht-details.DGN		DRAWN -	REVISED -
	PLOT SCALE = 100.0000' / in.	CHECKED -	REVISED -
	PLOT DATE = 3/20/2017	DATE -	REVISED -

**STATE OF ILLINOIS
DEPARTMENT OF TRANSPORTATION**

PAVEMENT MARKING DETAILS

SCALE: SHEET NO. OF SHEETS STA. TO STA.

F.A.P. RTE.	SECTION	COUNTY	TOTAL SHEETS	SHEET NO.
330	15RS-5 & 16RS-4	KANKAKEE	23	20
CONTRACT NO. 66B01				
ILLINOIS FED. AID PROJECT				

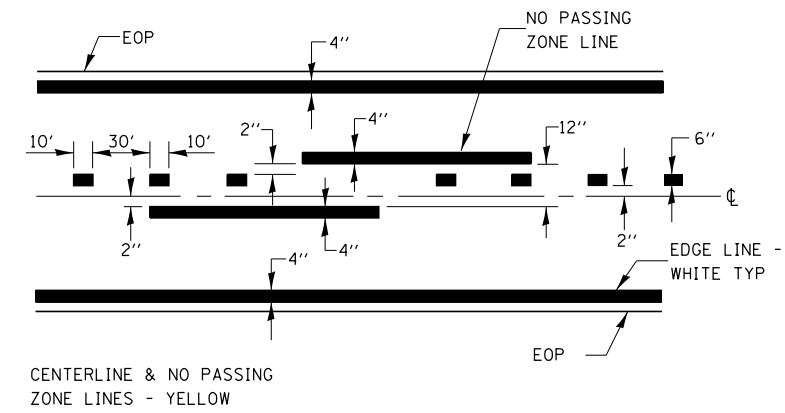

PAVEMENT MARKING

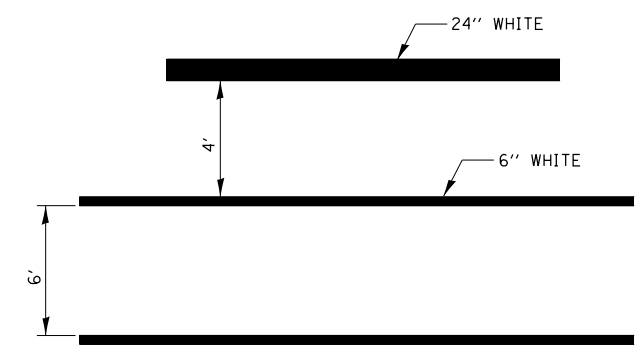

TYPICAL SPACING DETAIL FOR CROSSWALKS AND STOP BARS

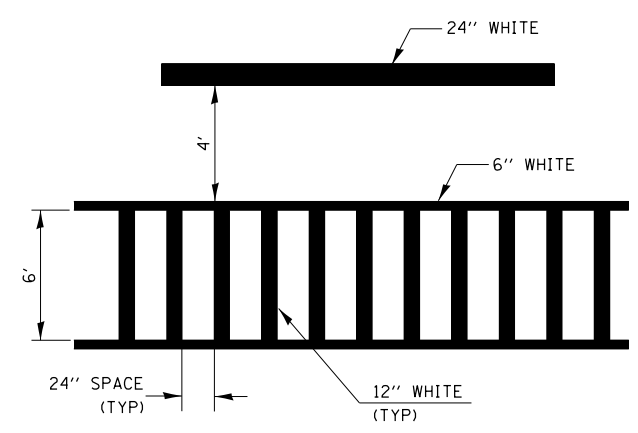

TYPICAL SPACING DETAIL FOR CROSSWALKS AND STOP BARS

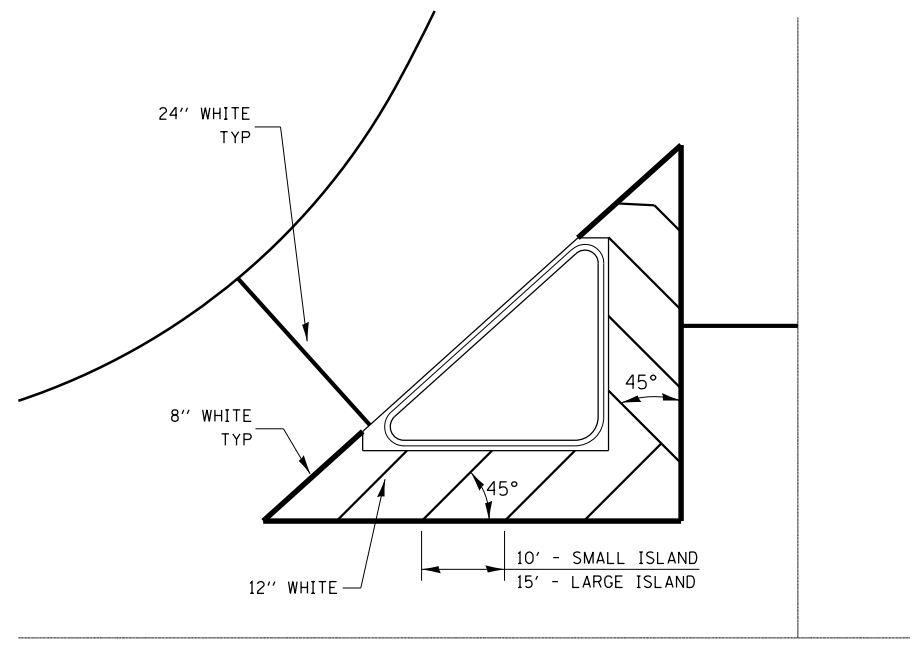

TYPICAL ISLAND

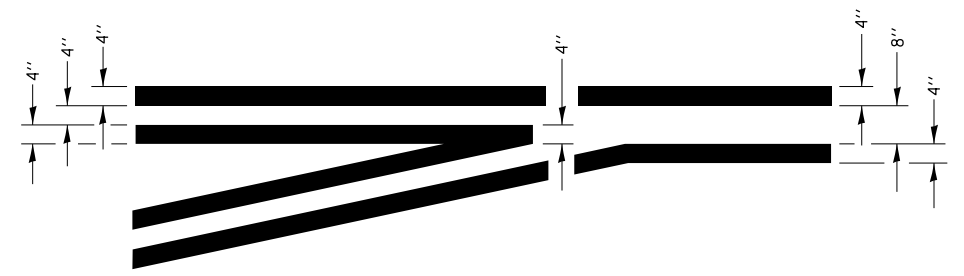

LEFT TURN LANE TYPICAL APPLICATION

FILE NAME =	USER NAME = corcoranim	DESIGNED -	REVISED -
p:\1\084EBIDINTEG.illinois.gov\PIWIDOT\Documents\IDOT Offices\District 3\Projects\0366801\B366801-sht-details.DGN		DRAWN -	REVISED -
	PLOT SCALE = 100.0000' / in.	CHECKED -	REVISED -
	PLOT DATE = 3/20/2017	DATE -	REVISED -

**STATE OF ILLINOIS
DEPARTMENT OF TRANSPORTATION**

PAVEMENT MARKING DETAILS

SCALE: SHEET OF SHEETS STA. TO STA.

F.A.P. RTE.	SECTION	COUNTY	TOTAL SHEETS	SHEET NO.
330	15RS-5 & 16RS-4	KANKAKEE	23	21
CONTRACT NO. 66B01				
ILLINOIS FED. AID PROJECT				

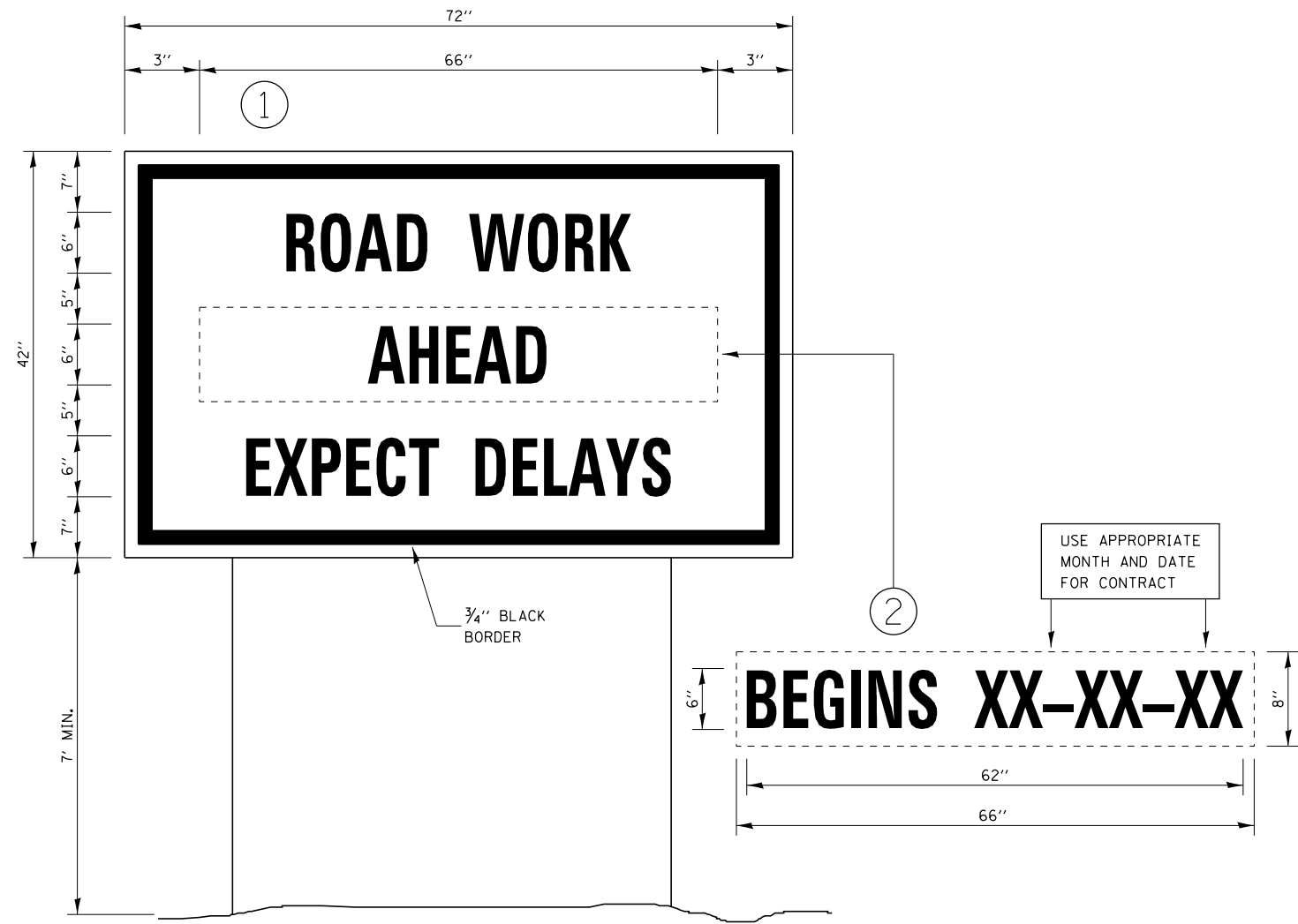

TEMPORARY INFORMATION SIGNING

NOTES:

1. USE 6" D BLACK LETTERING ON FLUORESCENT ORANGE BACKGROUND.
2. ERECT SIGNS AT LOCATIONS IN ADVANCE OF THE "ROAD CONSTRUCTION AHEAD" SIGNS AS DIRECTED BY THE ENGINEER.
3. ERECT SIGN (1) WITH INSTALLED PANEL (2) A MINIMUM OF ONE WEEK PRIOR TO THE START OF THE LANE CLOSURE.
4. REMOVE PANEL (2) ON THAT DATE.
5. SEE SPECIAL PROVISION "TEMPORARY INFORMATION SIGNING" FOR ADDITIONAL INFORMATION.
6. WILL BE PAID FOR PER SQ FT AS "TEMPORARY INFORMATION SIGNING". EACH SIGN = 21 SQ FT AND THE DATE PANEL (2) WILL NOT BE MEASURED SEPARATELY FOR PAYMENT.

FILE NAME =	USER NAME = corcoranim	DESIGNED -	REVISED -	STATE OF ILLINOIS DEPARTMENT OF TRANSPORTATION	DETAILS				F.A.P. RTE.	SECTION	COUNTY	TOTAL SHEETS	SHEET NO.	
p:\11\084EBIDINTEG.illinois.gov\PWIDOT\Documents\DOT Offices\District 3\Projects\0366801\B366801-sht-details.DGN		CHECKED -	REVISED -		SCALE:	SHEET	OF	SHEETS	STA.	TO STA.	330	15RS-5 & 16RS-4	KANKAKEE	23 22
		PLOT SCALE = 100.0000' / in.	REVISI											
		PLOT DATE = 3/20/2017	DATE -											
											ILLINOIS FED. AID PROJECT			

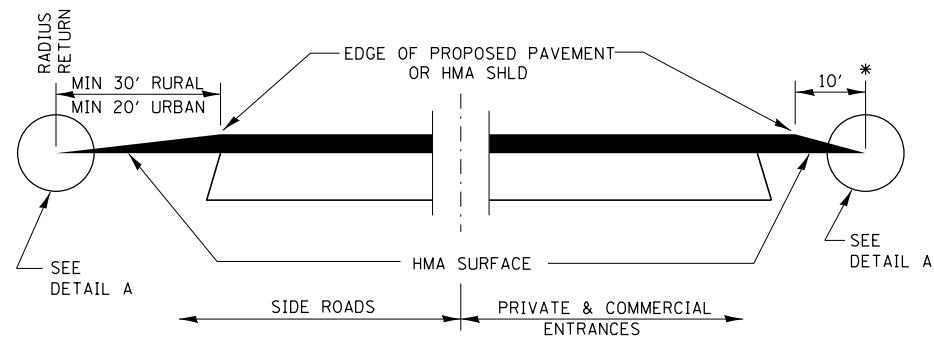

SECTION A-A
DETAILS AT ENTRANCES & SIDE ROADS

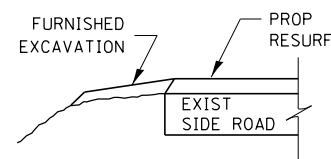

SECTION B-B

THE COST OF REMOVAL AT EXISTING HMA OR PCC LOCATIONS SHALL BE PAID FOR PER SO YD BY THE APPROPRIATE PAY ITEM. REMOVAL AT THE EXISTING AGG LOCATIONS SHALL BE INCIDENTAL TO THE HMA. A-3 LOCATIONS SHALL BE FEATHER TAPERED.

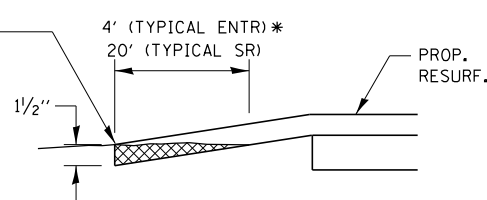

DETAIL A

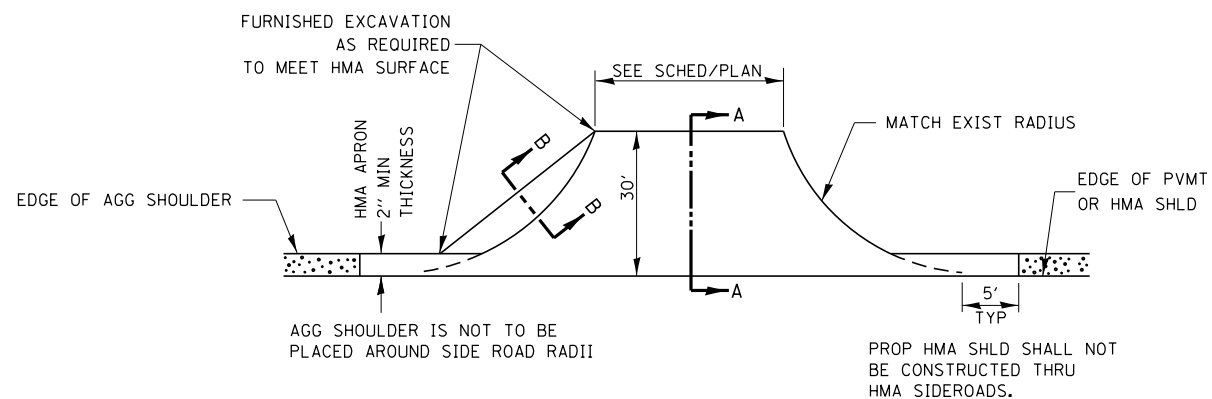

PLAN AT SIDE ROADS

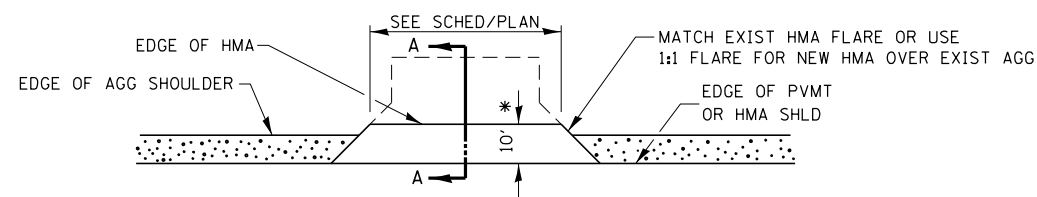

PLAN AT PRIVATE & COMMERCIAL ENTRANCES

(DO NOT RESURFACE FIELD ENTRANCES)

* PROPOSED HMA RESURFACING AT PUBLIC EDUCATIONAL FACILITY ENTRANCES SHALL BE EXTENDED TO THE RIGHT-OF-WAY LIMITS.

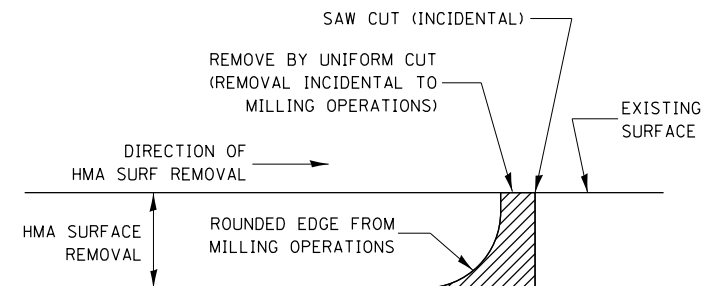

NOTE:

WHEN MILLING OPERATIONS PRODUCE A ROUNDED EDGE, THEN A SAW CUT SHALL BE USED TO MANUFACTURE A PERPENDICULAR EDGE AS SHOWN IN THE DETAIL. THE ENGINEER SHALL BE THE SOLE JUDGE CONCERNING THE USE OF THIS DETAIL.

HMA DETAIL AT BUTT JOINTS

FILE NAME =	USER NAME = corcoranm	DESIGNED -	REVISED -	STATE OF ILLINOIS DEPARTMENT OF TRANSPORTATION	DETAILS			F.A.P. RTE.	SECTION	COUNTY	TOTAL SHEETS	SHEET NO.
pw:\11\084EBIDINTEG.illinois.gov\PWIDOT\Documents\IDOT Offices\District 3\Projects\0366801\0366801-sht-details.DGN		CHECKED -	REVISED -		330	15RS-5 & 16RS-4	KANKAKEE	23	23			
PLOT SCALE = 100.0000' / 1"		DATE -	REVISED -		CONTRACT NO. 66B01							
PLOT DATE = 3/20/2017					SCALE:	SHEET NO.	OF SHEETS	STA.	TO STA.	ILLINOIS FED. AID PROJECT		