

STATE OF ILLINOIS  
DEPARTMENT OF TRANSPORTATION

F.A.P. RTE.	SECTION	COUNTY	TOTAL SHEETS	SHEET NO.
623	(31) TS	LASALLE	8	1
		ILLINOIS	CONTRACT NO. 66H45	

INDEX OF SHEETS

- 1 COVER SHEET
- 2 GENERAL NOTES
- 3-4 SUMMARY OF QUANTITIES
- 5 TRAFFIC SIGNAL INSTALLATION PLAN
- 6 CABLE PLAN AND PHASE DESIGNATION DIAGRAM
- 7 SPAN WIRE LOADING DIAGRAMS
- 8 DETAILS

LIST OF ILLINOIS DOT HIGHWAY STANDARDS

000001-06	STANDARD SYMBOLS, ABBREVIATIONS AND PATTERNS
001006	DECIMAL OF AN INCH AND OF A FOOT
701001-02	OFF-ROAD OPERATIONS 2L, 2W, MORE THAN 15' (4.5 m) AWAY
701006-05	OFF-ROAD OPERATIONS 2L, 2W, 15' (4.5 m) TO 24" (600 mm) FROM PAVEMENT EDGE
701201-04	LANE CLOSURE, 2L, 2W, DAY ONLY, FOR SPEEDS ≥ 45 MPH
701901-06	TRAFFIC CONTROL DEVICES
720001-01	SIGN PANEL MOUNTING DETAILS
720006-04	SIGN PANEL ERECTION DETAILS
857001-01	STANDARD PHASE DESIGNATION DIAGRAMS AND PHASE SEQUENCES
862001-01	UNINTERRUPTABLE POWER SUPPLY (UPS)
873001-02	TRAFFIC SIGNAL GROUNDING & BONDING
880001-01	SPAN WIRE MOUNTED SIGNALS AND FLASHING BEACON INSTALLATION

PROPOSED  
HIGHWAY PLANS

FAP ROUTE 623 (US 6)  
SECTION (31) TS

TRAFFIC SIGNAL INSTALLATION  
LASALLE COUNTY

C-93-088-17

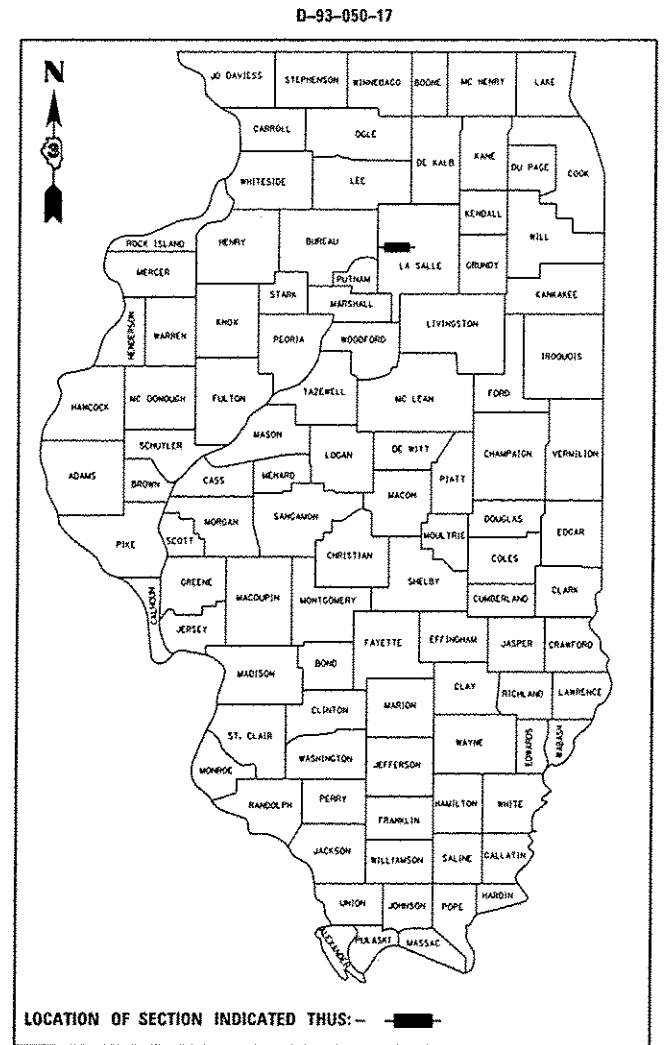

EAST LEG - MINOR ARTERIAL  
2015 ADT = 5,250  
P.V. = 88.6% S.U. = 4.3% M.U. = 7.1%

WEST LEG - OTHER ARTERIAL  
2015 ADT = 5,750  
P.V. = 78.7% S.U. = 6.5% M.U. = 14.8%

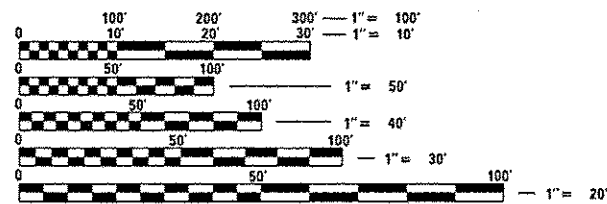

FULL SIZE PLANS HAVE BEEN PREPARED USING STANDARD ENGINEERING SCALES. REDUCED SIZED PLANS WILL NOT CONFORM TO STANDARD SCALES. IN MAKING MEASUREMENTS ON REDUCED PLANS, THE ABOVE SCALES MAY BE USED.

J.U.L.I.E.  
JOINT UTILITY LOCATION INFORMATION FOR EXCAVATION  
1-800-892-0123  
OR 811

PROJECT ENGINEER: JOE KANNEL, P.E.  
UNIT CHIEF: MARC BUDZYNSKI  
DISTRICT 3 NO. (815) 434-6131  
CONTRACT NO. 66H45

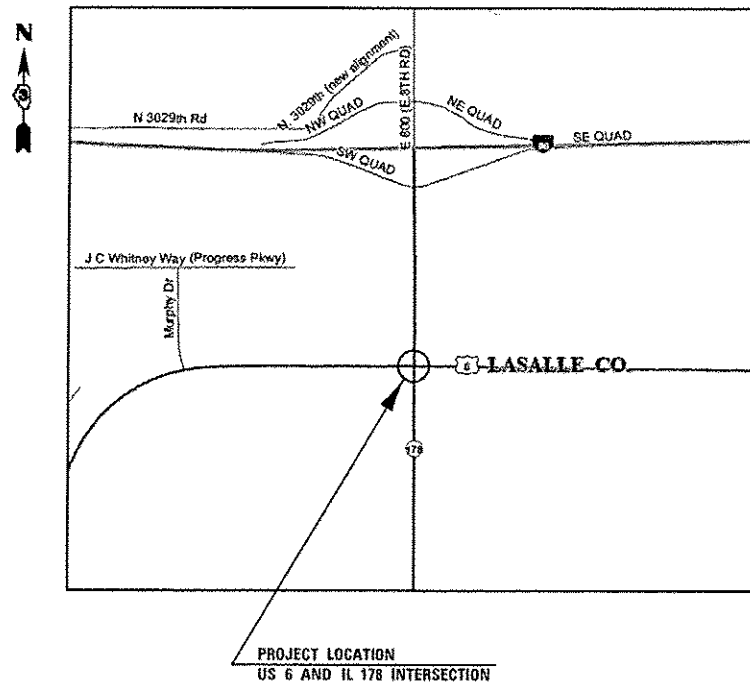

GROSS LENGTH & NET LENGTH = POINT LOCATION

STATE OF ILLINOIS  
DEPARTMENT OF TRANSPORTATION

SUBMITTED 4-20 2017

*[Signature]*  
REGIONAL ENGINEER

May 12 2017  
Maurice M. Addis P.E.  
ENGINEER OF DESIGN AND ENVIRONMENT

May 12 2017  
*[Signature]*  
DIRECTOR OF PROGRAM DEVELOPMENT

PRINTED BY THE AUTHORITY  
OF THE STATE OF ILLINOIS





CODE NO.	ITEM	UNIT	TOTAL QUANTITY	CONSTR. CODE
				TRAFFIC SIGNALS
				0021 RURAL
X1400215	REMOTE CONTROLLED VIDEO SYSTEM	EACH	1	1
X7015005	CHANGEABLE MESSAGE SIGN	CAL DA	200	200
X8570226	FULL-ACTUATED CONTROLLER AND TYPE IV CABINET, SPECIAL	EACH	1	1
X8800025	SIGNAL HEAD .LED, 1-FACE, 3-SECTION, SPAN WIRE MOUNTED	EACH	6	6
X8800041	SIGNAL HEAD .LED, 1-FACE 4-SECTION, SPAN WIRE MOUNTED	EACH	6	6
X8820010	TRAFFIC SIGNAL BACKPLATE, SPECIAL	EACH	12	12

6





DETECTION ZONE CONTINUES FOR 500'  
PAST THE STOP BAR (TYP)

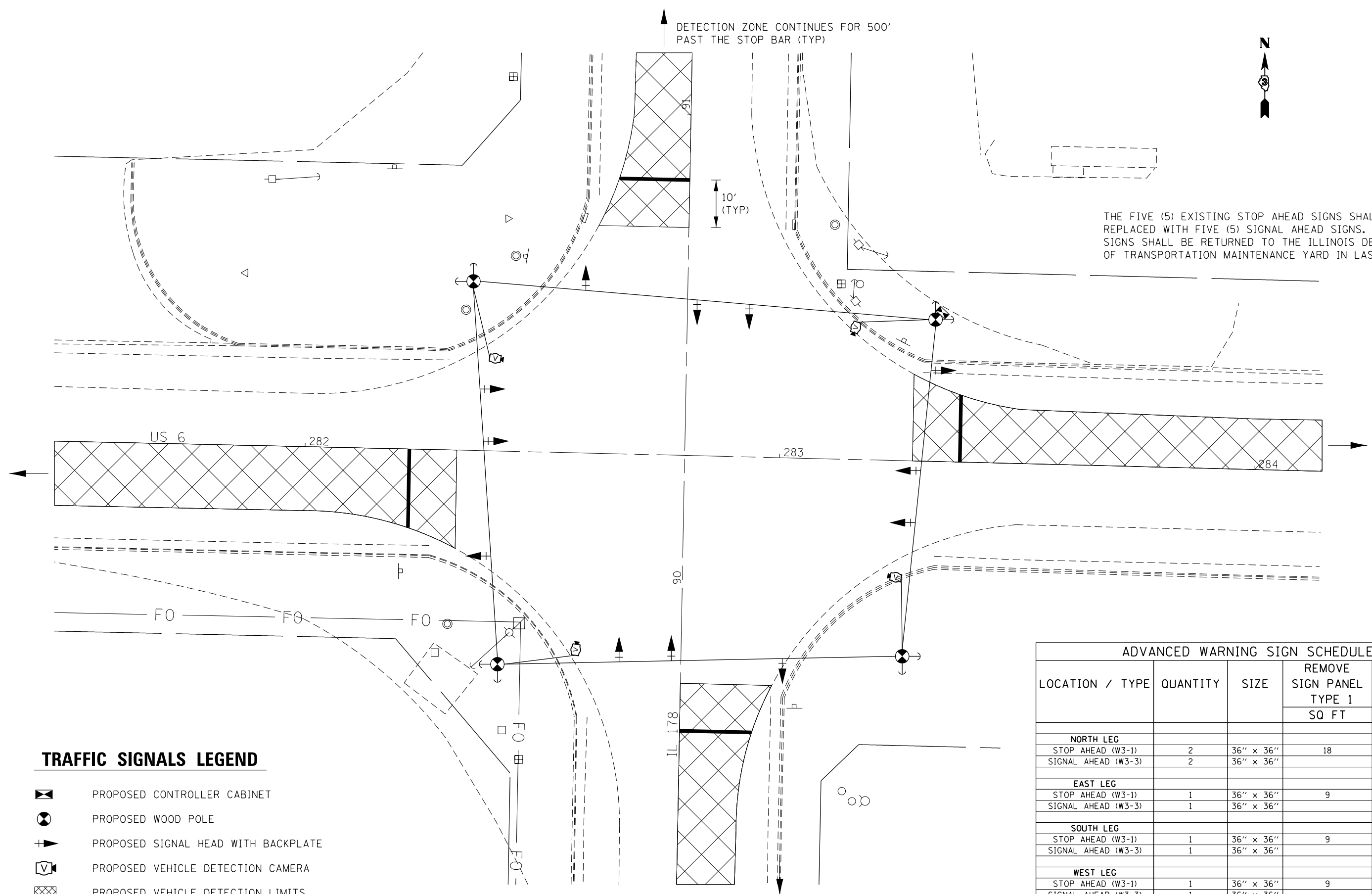

THE FIVE (5) EXISTING STOP AHEAD SIGNS SHALL BE REPLACED WITH FIVE (5) SIGNAL AHEAD SIGNS. THE REMOVED SIGNS SHALL BE RETURNED TO THE ILLINOIS DEPARTMENT OF TRANSPORTATION MAINTENANCE YARD IN LASALLE.

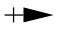

**TRAFFIC SIGNALS LEGEND**

-  PROPOSED CONTROLLER CABINET
-  PROPOSED WOOD POLE
-  PROPOSED SIGNAL HEAD WITH BACKPLATE
-  PROPOSED VEHICLE DETECTION CAMERA
-  PROPOSED VEHICLE DETECTION LIMITS

ADVANCED WARNING SIGN SCHEDULE				
LOCATION / TYPE	QUANTITY	SIZE	REMOVE SIGN PANEL	SIGN PANEL
			TYPE 1 SQ FT	TYPE 1 SQ FT
<b>NORTH LEG</b>				
STOP AHEAD (W3-1)	2	36" x 36"	18	
SIGNAL AHEAD (W3-3)	2	36" x 36"		18
<b>EAST LEG</b>				
STOP AHEAD (W3-1)	1	36" x 36"	9	
SIGNAL AHEAD (W3-3)	1	36" x 36"		9
<b>SOUTH LEG</b>				
STOP AHEAD (W3-1)	1	36" x 36"	9	
SIGNAL AHEAD (W3-3)	1	36" x 36"		9
<b>WEST LEG</b>				
STOP AHEAD (W3-1)	1	36" x 36"	9	
SIGNAL AHEAD (W3-3)	1	36" x 36"		9
<b>TOTAL</b>			<b>45</b>	<b>45</b>

### PROPOSED CONTROLLER SEQUENCE

NAME OF INTERSECTION: US 6 AND IL 178  
 CONTROLLER SPECIFIED: FULL-ACTUATED CONTROLLER, STANDARD SEQUENCE, 8 PHASE, IN TYPE IV CABINET MOUNTED ON POLE REFERRING TO STANDARD 857001, THE VEHICULAR PHASES USED ARE DESIGNATED.

NOTE: SPLIT PHASE OPERATION FOR PHASES 4 & 8

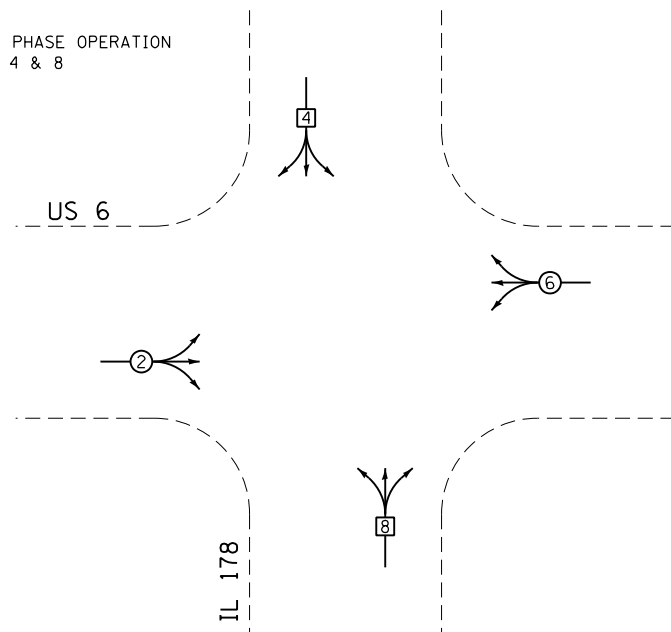

**PROPOSED PLAN**  
NOT TO SCALE

### LEGEND

- VEHICULAR MOVEMENT
- \* NUMBER REFERS TO ASSOCIATED PHASE

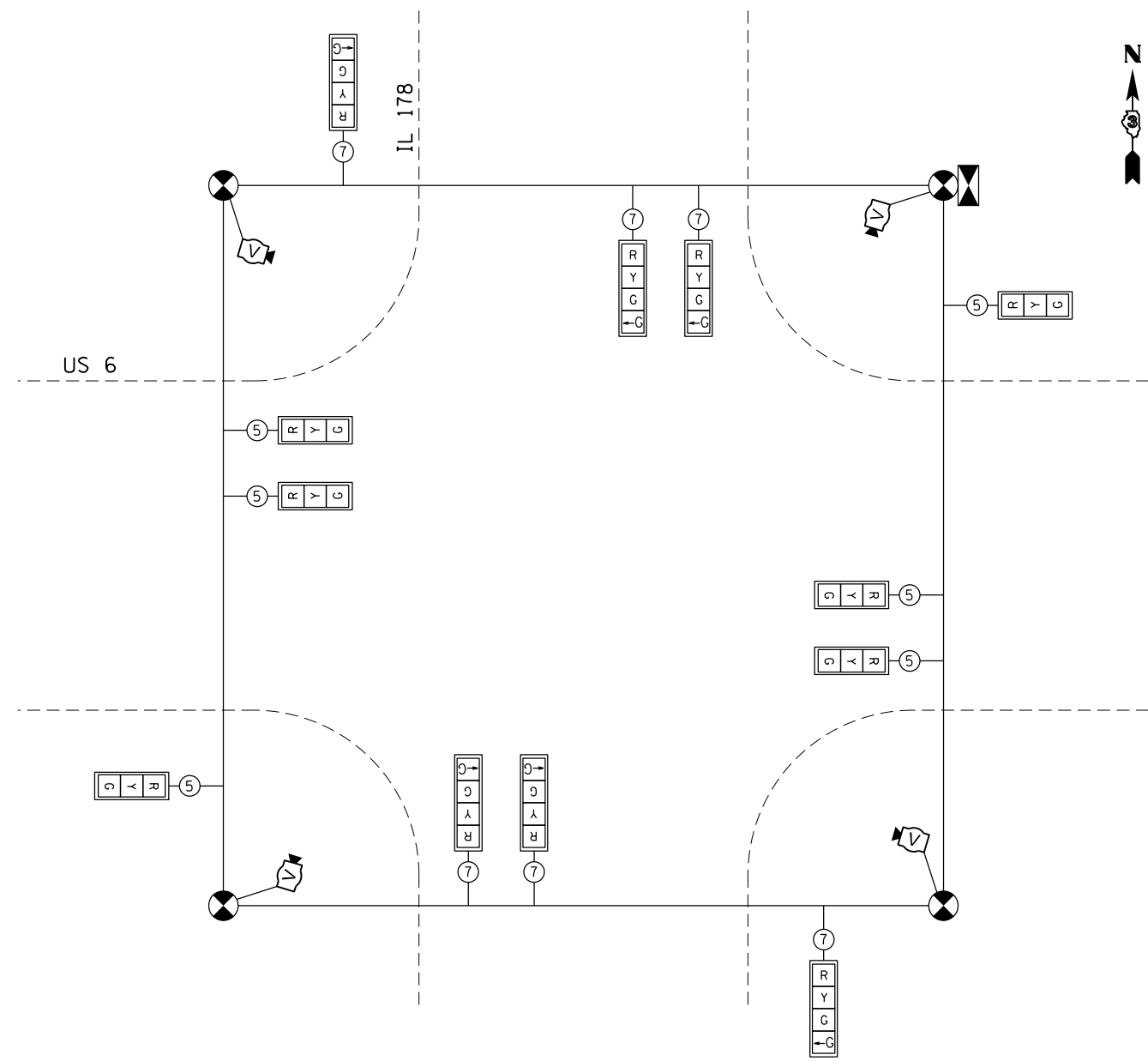

**PROPOSED CABLE PLAN**  
NOT TO SCALE

US 6 AND IL 178 ELECTRICAL LOAD CHART				
LOCATION	INDICATION/ITEM	NUMBER	WATTAGE EACH	BURN TIME (%)
US 6	RED	6	10	70
	YELLOW	6	17	5
	GREEN	6	11	25
IL 178	RED	6	10	25
	YELLOW	6	17	5
	GREEN	6	11	65
	GREEN ARROW	6	5	5
TRAFFIC SIGNAL CABINET	CONTROLLER	1	6	100
	UPS	1	50	100

### TRAFFIC SIGNALS LEGEND

- DENOTES NUMBER OF PROPOSED CONDUCTORS
- PROPOSED CONTROLLER AND CABINET
- PROPOSED WOOD POLE, CLASS 4
- VIDEO DETECTION SYSTEM
- SIGNAL SECTION 12"
- LEFT TURN GREEN
- PROPOSED TRAFFIC SIGNAL BACKPLATE

FILE NAME =	USER NAME = budzynskim	DESIGNED -	REVISED -
p:\IL\084EBID\INTEG\illinois.gov\PIWIDOT\Documents\DOT Offices\District 3\Projects\0366\Drawings\0366H45-sht-cover.dgn		CHECKED -	REVISED -
Default	PLOT DATE = 4/19/2017	DATE -	REVISED -

STATE OF ILLINOIS  
DEPARTMENT OF TRANSPORTATION

CABLE PLAN AND PHASE DESIGNATION DIAGRAM

SCALE: SHEET OF SHEETS STA. TO STA.

F.A.P. RTE.	SECTION	COUNTY	TOTAL SHEETS	SHEET NO.
623	(31) TS	LASALLE	8	6
CONTRACT NO. 66H45				
ILLINOIS FED. AID PROJECT				

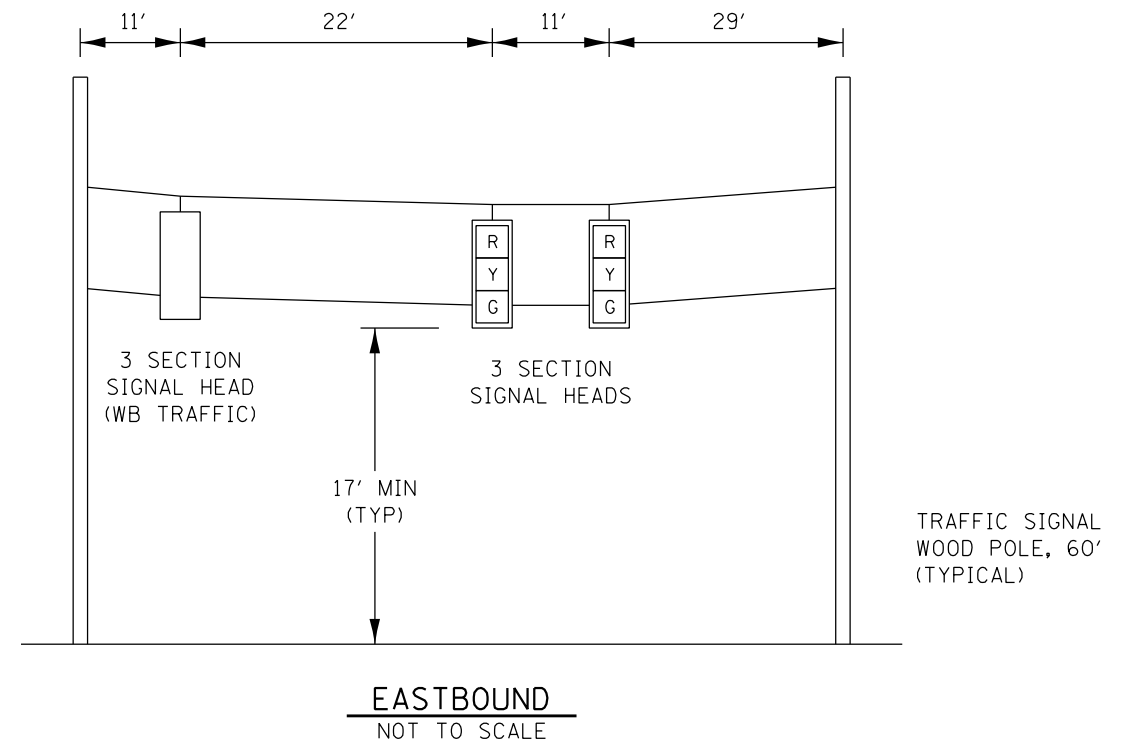
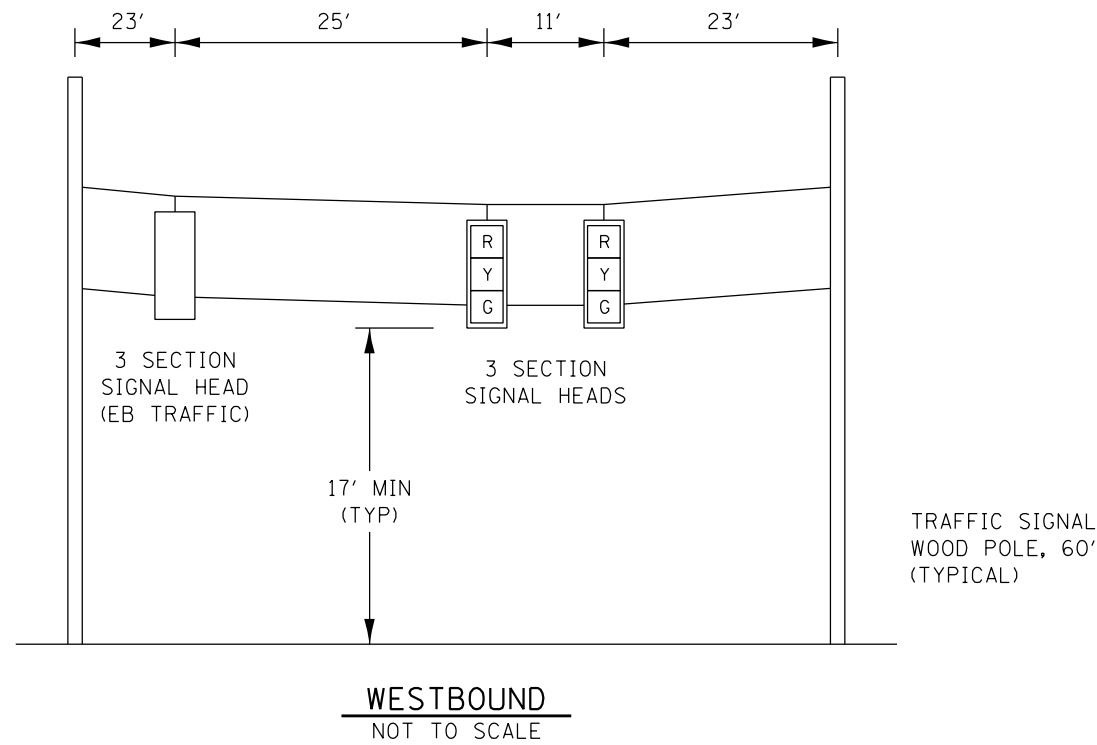
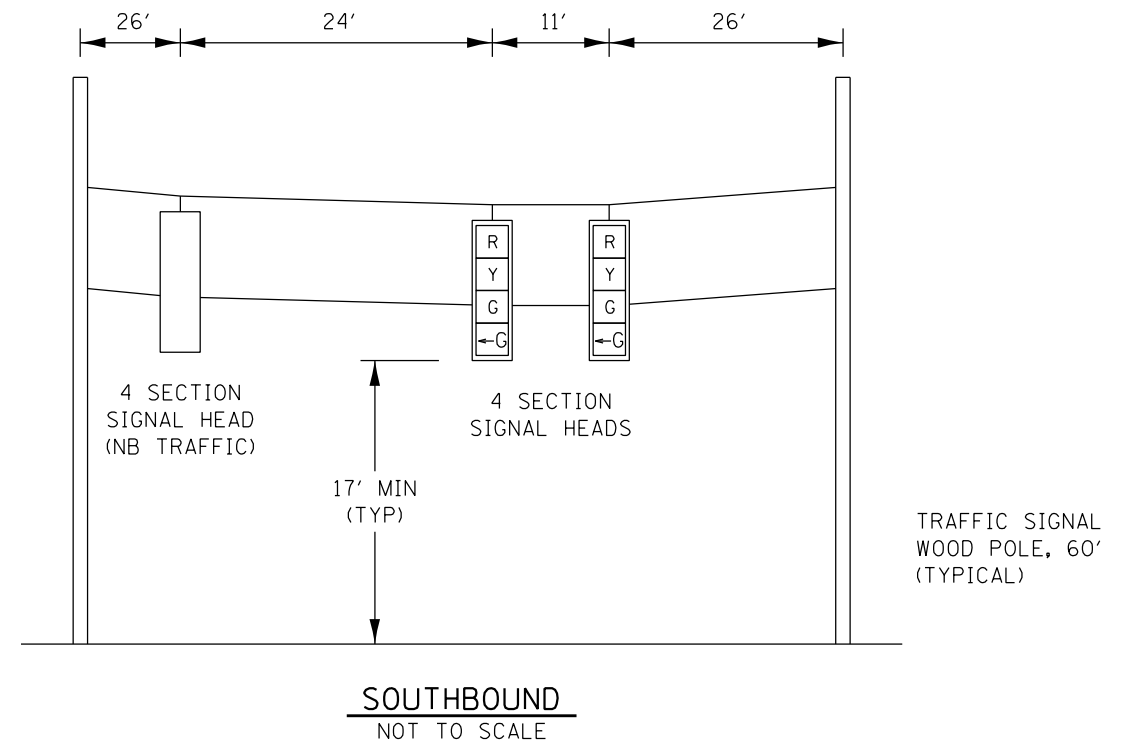
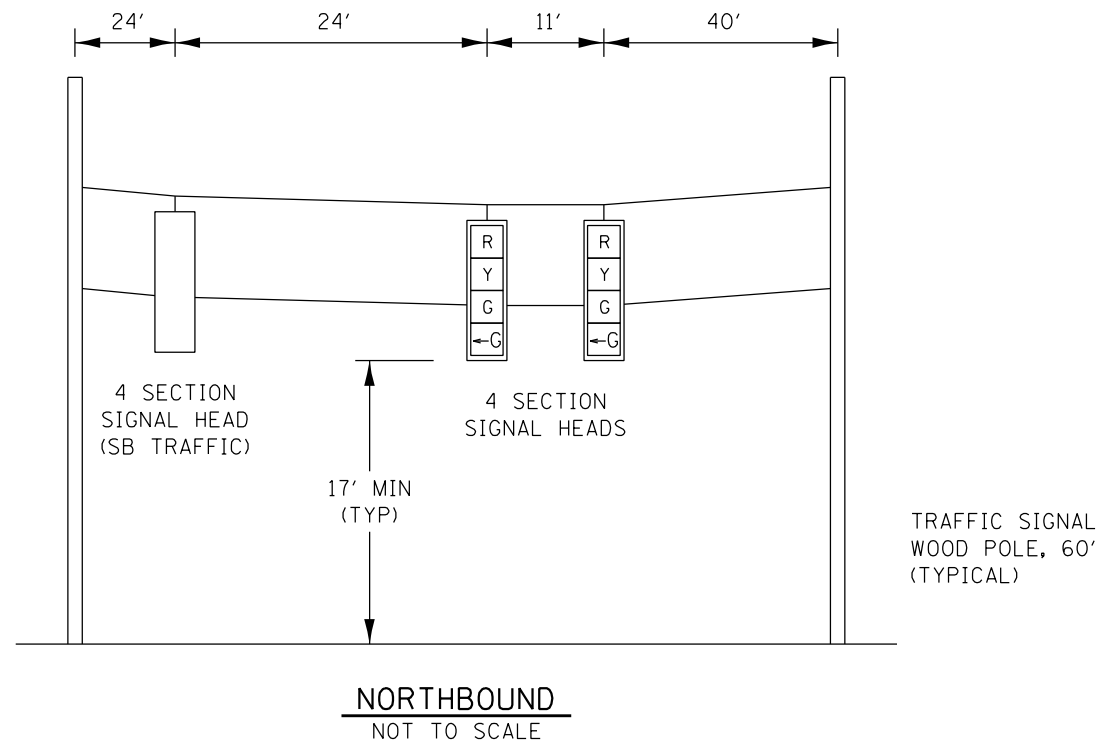

FILE NAME =	USER NAME = budzynskim	DESIGNED -	REVISED -
p:\11\084EBIDINTEG.illinois.gov\PIWIDOT\Documents\DOT Offices\District 3\Projects\0366\DRAWING\B366H45-shd-cover.dgn		CHECKED -	REVISED -
Default	PLOT DATE = 4/19/2017	DATE -	REVISED -

**STATE OF ILLINOIS  
DEPARTMENT OF TRANSPORTATION**

<b>SPAN WIRE LOADING DIAGRAMS</b>			
SCALE:	SHEET	OF	SHEETS
	STA.	TO	STA.

F.A.P. RTE.	SECTION	COUNTY	TOTAL SHEETS	SHEET NO.
623	(31) TS	LASALLE	8	7
CONTRACT NO. 66H45				
ILLINOIS FED. AID PROJECT				

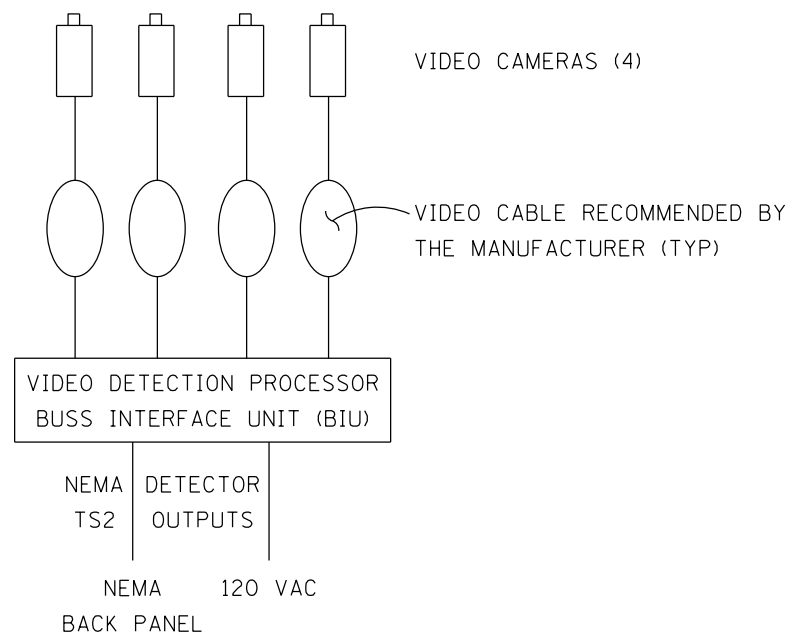

VIDEO VEHICLE DETECTION SYSTEM  
COMPONENT LAYOUT

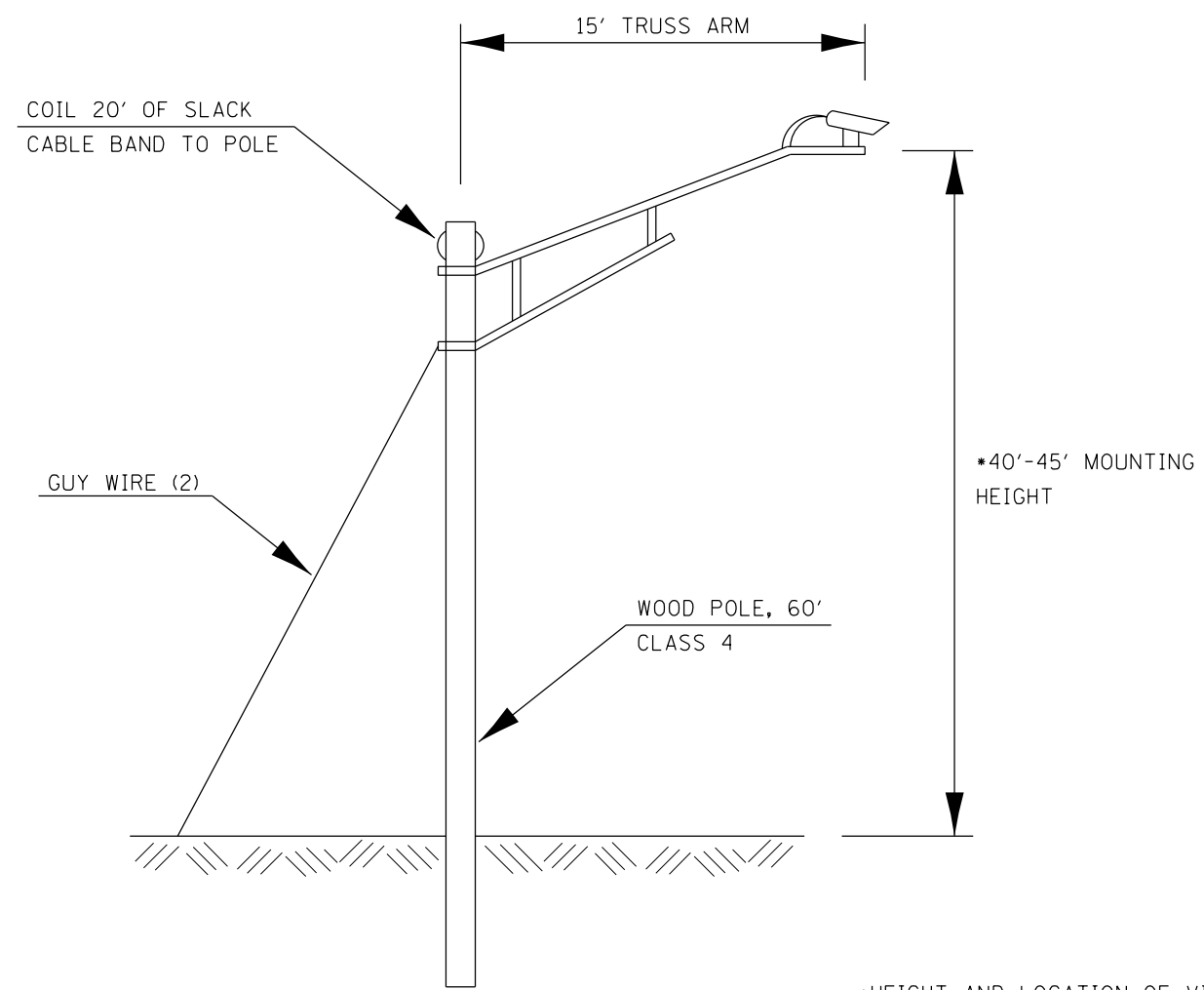

\*HEIGHT AND LOCATION OF VIDEO CAMERA SHALL BE PLACED ACCORDING TO MANUFACTURER RECOMMENDATIONS

VIDEO DETECTION CAMERA  
MOUNTING DETAIL (NTS)

FILE NAME =	USER NAME = budzynskim	DESIGNED -	REVISED -
p:\11\084EBIDINTEG.illinois.gov\PIWIDOT\Documents\DOT Offices\District 3\Projects\036645\Drawings\036645-shd-cover.dgn		CHECKED -	REVISED -
Default	PLOT DATE = 4/19/2017	DATE -	REVISED -

**STATE OF ILLINOIS  
DEPARTMENT OF TRANSPORTATION**

**DETAILS**

SCALE: SHEET OF SHEETS STA. TO STA.

F.A.P. RTE.	SECTION	COUNTY	TOTAL SHEETS	SHEET NO.
623	(31) TS	LASALLE	8	8
CONTRACT NO. 66H45				
ILLINOIS FED. AID PROJECT				