

F.A.P. RTE.	SECTION	COUNTY	TOTAL SHEETS	SHEET NO.
337	20R-5	LAKE	562	297
STA.		TO STA.		
FED. ROAD DIST. NO.		ILLINOIS	FED. AID PROJECT	
D-91-552-99		60881		

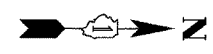
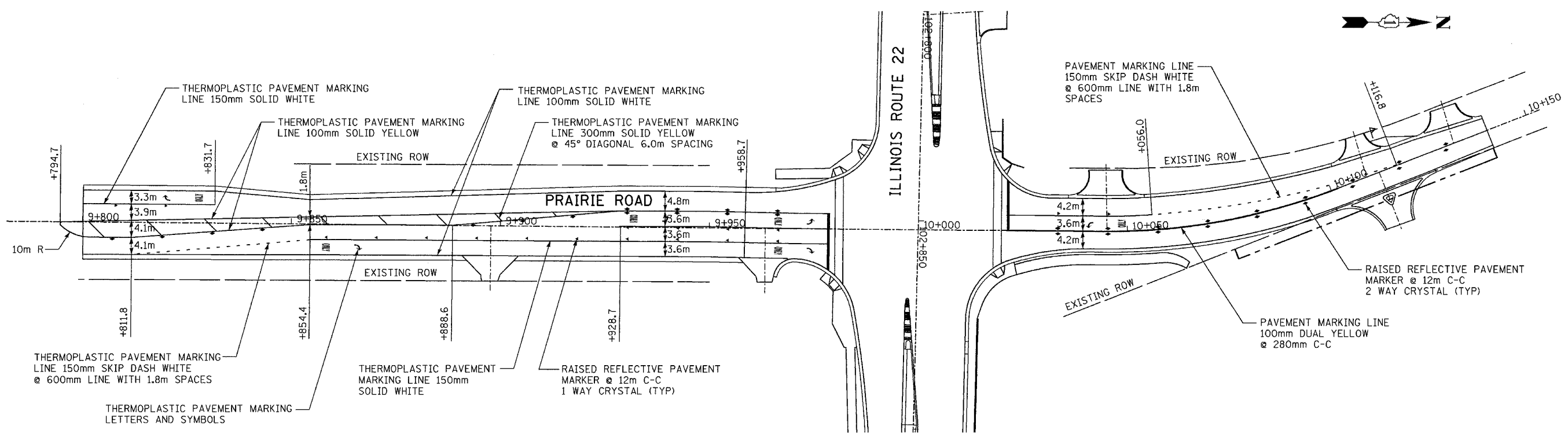
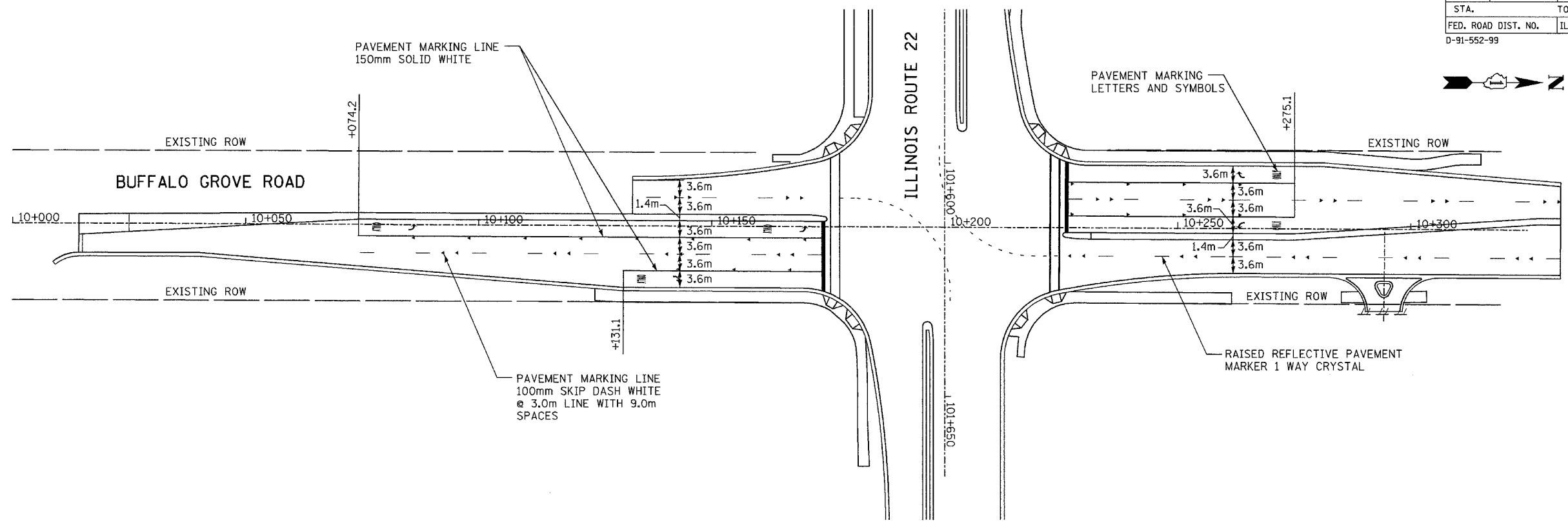

BY	DATE
FINAL SURVEY PLOTTED	
NOTE BOOK TEMPLATE	
AREAS CHECKED	
NO.	

BY	DATE
ORIGINAL SURVEY PLOTTED	
NOTE BOOK TEMPLATE	
AREAS CHECKED	
NO.	

NOTES:

1. ALL PAVEMENT MARKINGS SHALL BE POLYUREA TYPE 1 UNLESS OTHERWISE NOTED.
2. THE RESIDENT ENGINEER SHOULD CONTACT DEBBIE HANLON (847) 438-2300, AREA TRAFFIC FIELD TECHNICIAN PRIOR TO PLACING ANY PAVEMENT MARKINGS.

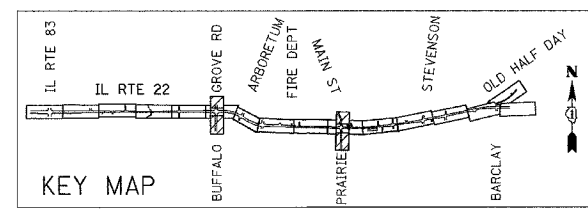

REVISIONS	
NAME	DATE

ILLINOIS DEPARTMENT OF TRANSPORTATION
 IL RTE 22 (FAP 337)
 IL RTE 83 TO US 45 / IL 21 (MILWAUKEE AVE)
 STRIPING PLAN
 BUFFALO GROVE ROAD AND PRAIRIE ROAD
 SHEET 9 OF 9
 SCALE: 1:500 DRAWN BY: AMB
 DATE: 03-22-2004 CHECKED BY: JNR