

|                     |         |          |                  |           |
|---------------------|---------|----------|------------------|-----------|
| F.A.P. RTE.         | SECTION | COUNTY   | TOTAL SHEETS     | SHEET NO. |
| 337                 | 20R-5   | LAKE     | 562              | 333       |
| STA.                |         | TO STA.  |                  |           |
| FED. ROAD DIST. NO. |         | ILLINOIS | FED. AID PROJECT |           |
| D-91-552-99         |         | 60881    |                  |           |

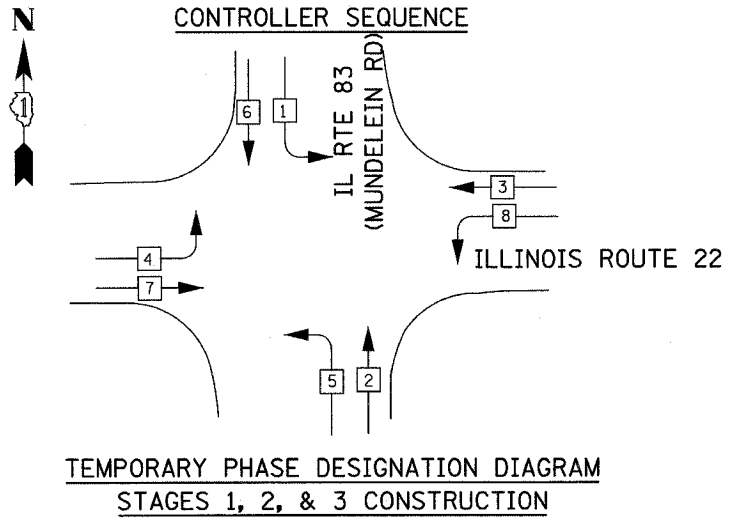

TEMPORARY PHASE DESIGNATION DIAGRAM  
STAGES 1, 2, & 3 CONSTRUCTION

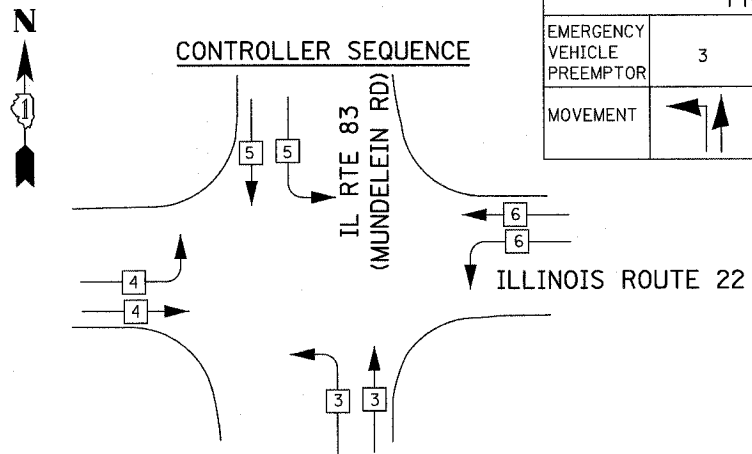

EMERGENCY VEHICLE PREEMPTION SEQUENCE  
STAGES 1, 2, & 3 CONSTRUCTION

| EMERGENCY VEHICLE PREEMPTOR | 3 | 5 | 4 | 6 |
|-----------------------------|---|---|---|---|
| MOVEMENT                    |   |   |   |   |

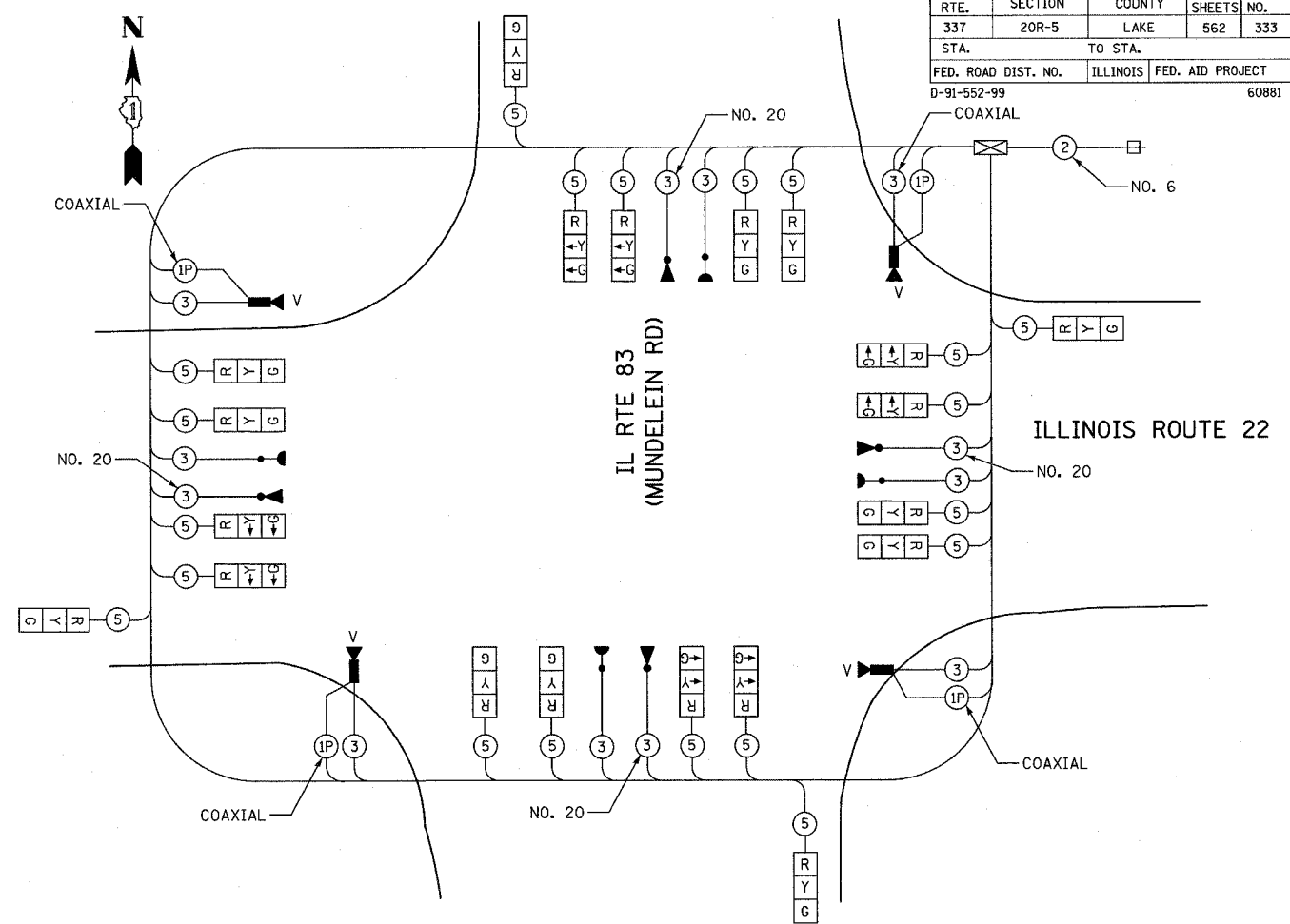
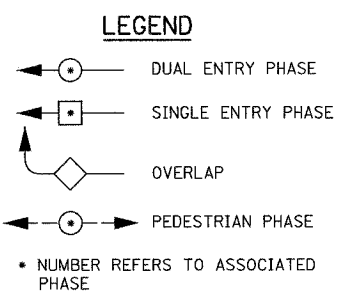

TEMPORARY SIGNALS CABLE PLAN  
STAGES 1, 2, & 3 CONSTRUCTION  
NOT TO SCALE

|                    |      |
|--------------------|------|
| ORIGINAL SURVEYED  | DATE |
| SURVEY PLOTTED     |      |
| NOTE BOOK TEMPLATE |      |
| AREAS CHECKED      |      |
| NO.                |      |

|                    |      |
|--------------------|------|
| ORIGINAL SURVEYED  | DATE |
| SURVEY PLOTTED     |      |
| NOTE BOOK TEMPLATE |      |
| AREAS CHECKED      |      |
| NO.                |      |

| TYPE             | NO. OF LAMPS | WATTAGE |     | % OPERATIONS | TOTAL WATTAGE |
|------------------|--------------|---------|-----|--------------|---------------|
|                  |              | INCAND. | LED |              |               |
| SIGNAL (RED)     | 20           | 135     | 17  | 0.50         | 1350          |
| (YELLOW)         | 20           | 135     | 25  | 0.25         | 675           |
| (GREEN)          | 20           | 135     | 15  | 0.25         | 675           |
| ARROW            | 0            | 135     | 12  | 0.10         | 0             |
| PED. SIGNAL      | 0            | 90      | 25  | 1.00         | 0             |
| CONTROLLER       | 1            | 100     | 100 | 1.00         | 100           |
| ILLUM. SIGN      |              | 252     |     | 0.05         |               |
| FLASHER          |              |         |     | 0.05         |               |
| ENERGY COSTS TO: |              |         |     | TOTAL =      | 2800          |

ILLINOIS DEPARTMENT OF TRANSPORTATION  
DIVISION OF HIGHWAY/DISTRICT 1  
201 WEST CENTER COURT/SCHAUMBURG, ILLINOIS 60196-1096

ENERGY SUPPLY: CONTACT: DOTTI PROSEN  
PHONE: (847) 816-5529  
COMPANY: COMED

THE TRAFFIC SIGNAL EQUIPMENT FOR THIS PROJECT SHALL BE "ECONOLITE" TO MATCH THE EXISTING ADJACENT SYSTEM.

TEMPORARY CABLE DIAGRAM LEGEND

- TEMPORARY TRAFFIC SIGNAL SECTION OR PEDESTRIAN SIGNAL SECTION 12" (300mm)
- TEMPORARY CONTROLLER CABINET
- TEMPORARY SERVICE INSTALLATION
- INDICATES NUMBER OF CONDUCTORS IN CABLE. ALL CONDUCTORS TO BE NUMBER 14 AWG WIRE UNLESS OTHERWISE NOTED.
- EMERGENCY VEHICLE LIGHT DETECTOR
- CONFIRMATION BEACON
- VEHICLE DETECTOR, INDUCTION LOOP
- PEDESTRIAN PUSHBUTTON DETECTOR
- 12" (300mm) PEDESTRIAN SIGNAL SECTION
- VIDEO DETECTION
- MICROWAVE VEHICLE SENSOR

| REVISIONS |      | ILLINOIS DEPARTMENT OF TRANSPORTATION<br>IL RTE 22 (FAP 337)<br>IL RTE 83 TO US 45 / IL 21 (MILWAUKEE AVE)<br>TEMPORARY CABLE PLAN AND<br>TEMPORARY PHASE<br>DESIGNATION DIAGRAM (STAGES 1,2 &3)<br>ILLINOIS ROUTE 22 AT IL 83 (MUNDELEIN ROAD)<br>SCALE: NONE<br>DATE: 03-22-2004 |
|-----------|------|--|
| NAME      | DATE |  |
|           |      | DRAWN BY: AMB<br>DESIGNED BY: AMB<br>CHECKED BY: JPS   |
|           |      |  |
|           |      |  |
|           |      |  |
|           |      |  |