

F.A.P. RTE.	SECTION	COUNTY	TOTAL SHEETS	SHEET NO.
337	20R-5	LAKE	562	372
STA.		TO STA.		
FED. ROAD DIST. NO.		ILLINOIS	FED. AID PROJECT	
D-91-552-99		60881		

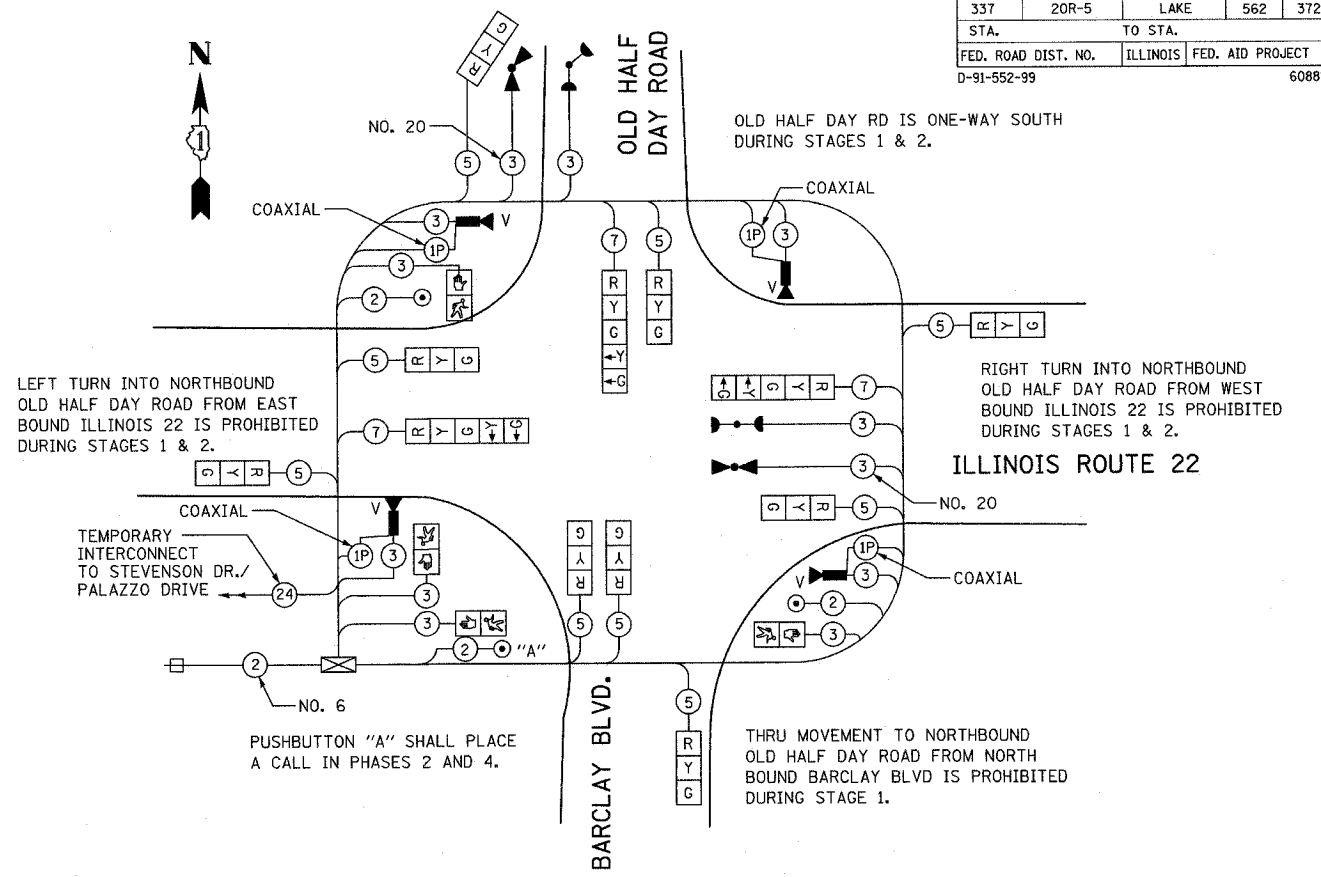
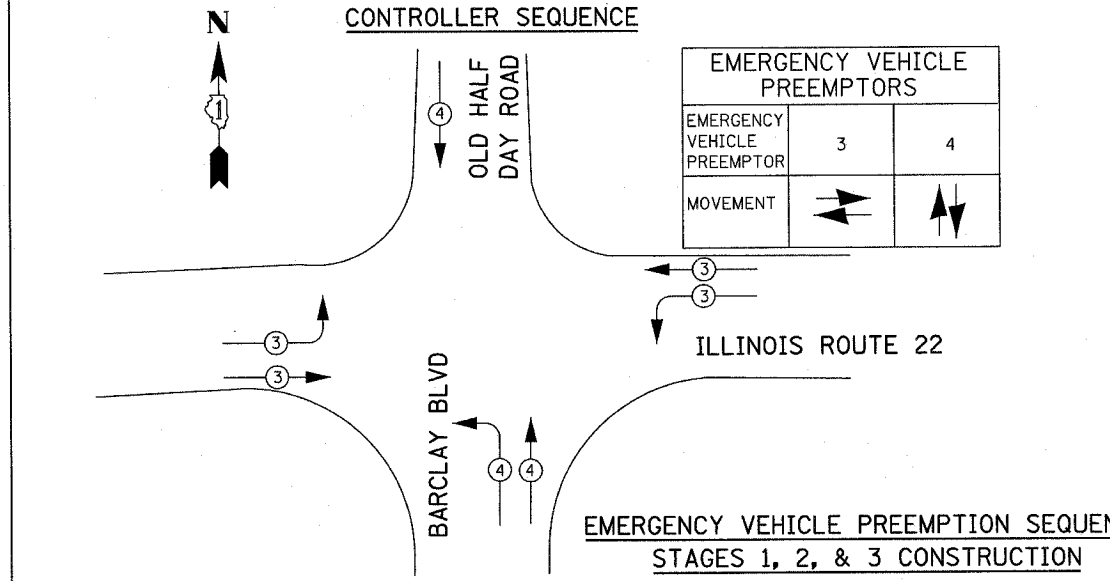
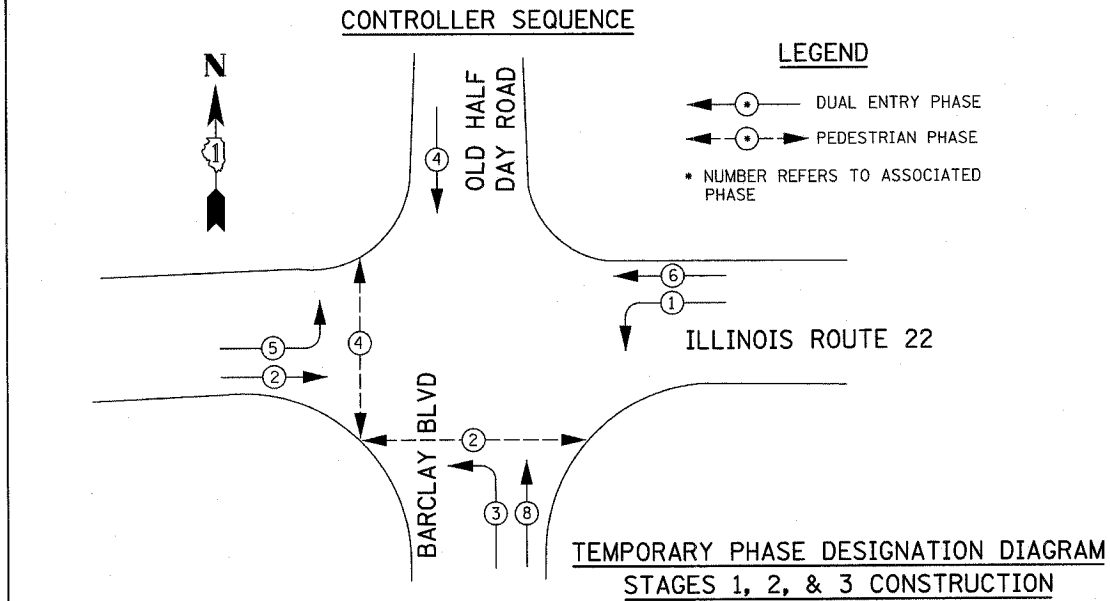

TEMPORARY SIGNALS CABLE PLAN
STAGES 1, 2, & 3 CONSTRUCTION
NOT TO SCALE

DATE	BY
FINAL SURVEY PLOTTED	
NOTE BOOK TEMPLATE	
AREAS CHECKED	
NO.	

DATE	BY
ORIGINAL SURVEY PLOTTED	
NOTE BOOK TEMPLATE	
AREAS CHECKED	
NO.	

I.D.O.T. TRAFFIC SIGNAL INSTALLATION ELECTRICAL SERVICE REQUIREMENTS					
TYPE	NO. OF LAMPS	WATTAGE		% OPERATIONS	TOTAL WATTAGE
		INCAND.	LED		
SIGNAL (RED)	12	135	17	0.50	810
(YELLOW)	12	135	25	0.25	405
(GREEN)	12	135	15	0.25	405
ARROW	6	135	12	0.10	81
PED. SIGNAL	4	90	25	1.00	360
CONTROLLER	1	100	100	1.00	100
ILLUM. SIGN		252		0.05	
FLASHER				0.05	
ENERGY COSTS TO:					TOTAL = 2161
ILLINOIS DEPARTMENT OF TRANSPORTATION DIVISION OF HIGHWAY/DISTRICT 1 201 WEST CENTER COURT/SCHAUMBURG, ILLINOIS 60196-1096					
ENERGY SUPPLY: CONTACT:		DOTTI PROSEN			
PHONE:		(847) 816-5529			
COMPANY:		COMED			

TEMPORARY CABLE DIAGRAM LEGEND

- R TEMPORARY TRAFFIC SIGNAL SECTION OR PEDESTRIAN SIGNAL SECTION 12" (300mm)
- X TEMPORARY CONTROLLER CABINET
- TEMPORARY SERVICE INSTALLATION
- ⑤ INDICATES NUMBER OF CONDUCTORS IN CABLE. ALL CONDUCTORS TO BE NUMBER 14 AWG WIRE UNLESS OTHERWISE NOTED.
- EMERGENCY VEHICLE LIGHT DETECTOR
- CONFIRMATION BEACON
- VEHICLE DETECTOR, INDUCTION LOOP
- PEDESTRIAN PUSHBUTTON DETECTOR
- 12" (300mm) PEDESTRIAN SIGNAL SECTION
- VIDEO DETECTION
- MICROWAVE VEHICLE SENSOR

REVISIONS	
NAME	DATE

ILLINOIS DEPARTMENT OF TRANSPORTATION
IL RTE 22 (FAP 337)
IL RTE 83 TO US 45 / IL 21 (MILWAUKEE AVE)
TEMPORARY CABLE PLAN AND
TEMPORARY PHASE
DESIGNATION DIAGRAM (STAGES 1,2&3)
IL RTE 22 AT BARCLAY BLVD./OLD HALF DAY RD.
SCALE: NONE
DATE: 03-22-2004

DRAWN BY: AMB
DESIGNED BY: AMB
CHECKED BY: JPS