

F.A.P. RTE.	SECTION	COUNTY	TOTAL SHEETS	SHEET NO.
337	20E-5	LAKE	502	403
STA. 102+050		TO STA. 102+395		
FED. ROAD DIST. NO.		ILLINOIS	FED. AID PROJECT	
D-91-552-99		CONTRACT #60881		

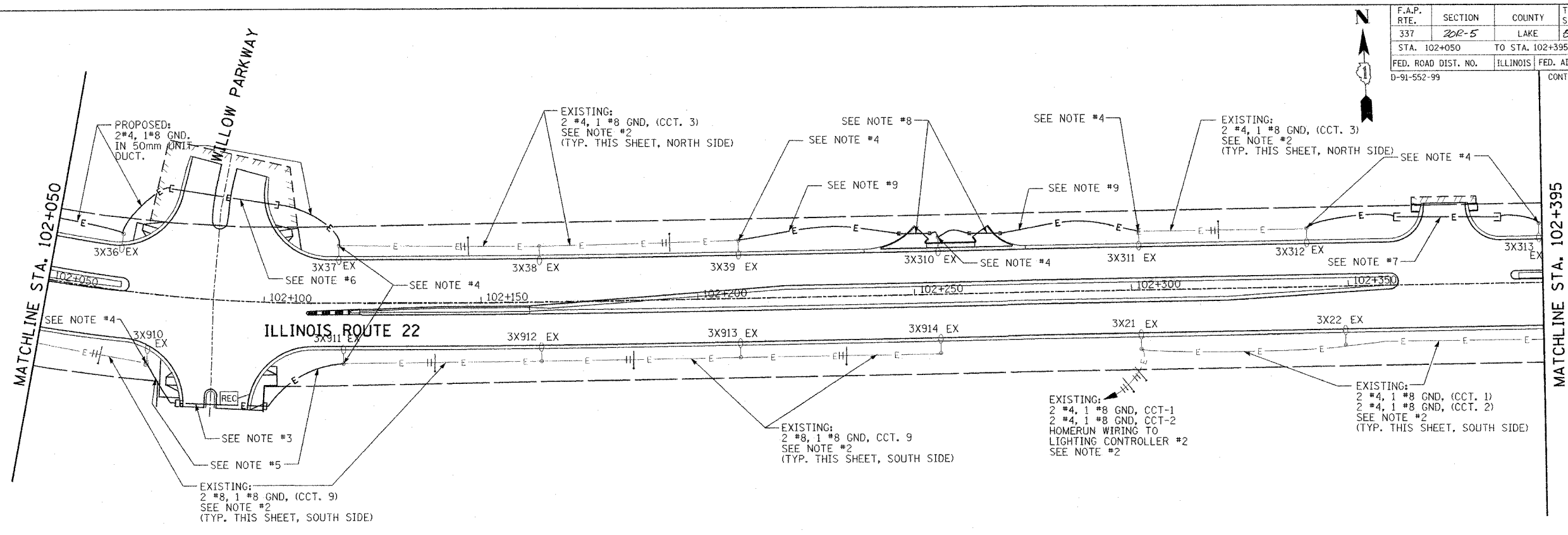

FINAL SURVEY	BY	DATE
SURVEY PLOTTED		
NOTE BOOK TEMPLATE		
AREAS CHECKED		
NO.		

ORIGINAL SURVEYED	BY	DATE
SURVEY PLOTTED		
NOTE BOOK TEMPLATE		
AREAS CHECKED		
NO.		

NOTES:

1. EXACT LOCATIONS OF RELOCATED AND PROPOSED POLES AND CONDUIT/CABLE ROUTINGS SHALL BE COORDINATED WITH UNDERGROUND UTILITIES, OWNER AND ENGINEER. LOCATIONS AND ROUTING SHOWN ON PLANS ARE APPROXIMATE.
2. LOCATE AND PROTECT EXISTING CONDUIT AND WIRING TO REMAIN AS REQUIRED.
3. PROPOSED 100mm PUSHED GRS CONDUIT (21m) WITH: 2*8, 1*8 GND. (CCT. 9) IN 50mm UNIT DUCT
4. CONTRACTOR SHALL REMOVE EXISTING WIRING IN EXISTING POLES AND SPLICE PROPOSED WIRING IN EXISTING LIGHT POLE HANDHOLE AS REQUIRED.
5. PROPOSED 2*8, 1*8 GND. (CCT. 9) IN 50mm UNIT DUCT.
6. PROPOSED 100mm PUSHED GRS CONDUIT (25m) WITH: 2*4, 1*8 GND. (CCT. 3) IN 50mm UNIT DUCT
7. PROPOSED 100mm TRENCHED GRS CONDUIT (20m) WITH: 2*4, 1*8 GND. (CCT. 3) IN 50mm UNIT DUCT
8. PROPOSED 100mm TRENCHED GRS CONDUIT (10m) WITH: 2*4, 1*8 GND. (CCT. 3) IN 50mm UNIT DUCT
9. PROPOSED 2*4, 1*8 GND. (CCT. 3) IN 50mm UNIT DUCT

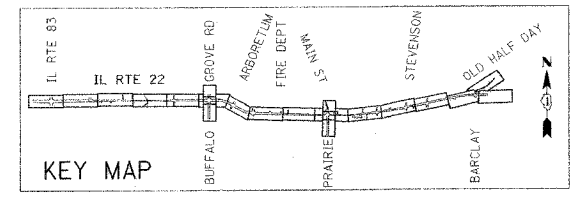

REVISIONS		ILLINOIS DEPARTMENT OF TRANSPORTATION IL RTE 22 (FAP 337) IL RTE 83 TO US 45 / IL 21 (MILWAUKEE AVE) PROPOSED LIGHTING PLAN (4 OF 10) STA. 102+050 TO STA. 102+395
NAME	DATE	
		SCALE: 1:500
		DATE: 03-22-2004
		DRAWN BY: CMW
		CHECKED BY: MAR

D:\WORK\2004\102+050 TO 102+395\102+050 TO 102+395.DWG