

F.A.P. RTE.	SECTION	COUNTY	TOTAL SHEETS	SHEET NO.
337	202-5	LAKE	862	407
STA. 103+400		TO STA. 103+750		
FED. ROAD DIST. NO.	ILLINOIS	FED. AID PROJECT		
D-91-552-99		CONTRACT #60881		

BY	DATE
FINAL SURVEYED	
SURVEY PLOTTED	
NOTE BOOK	
TEMPLATE	
AREAS	
CHECKED	
NO.	

BY	DATE
ORIGINAL SURVEYED	
SURVEY PLOTTED	
NOTE BOOK	
TEMPLATE	
AREAS	
CHECKED	
NO.	

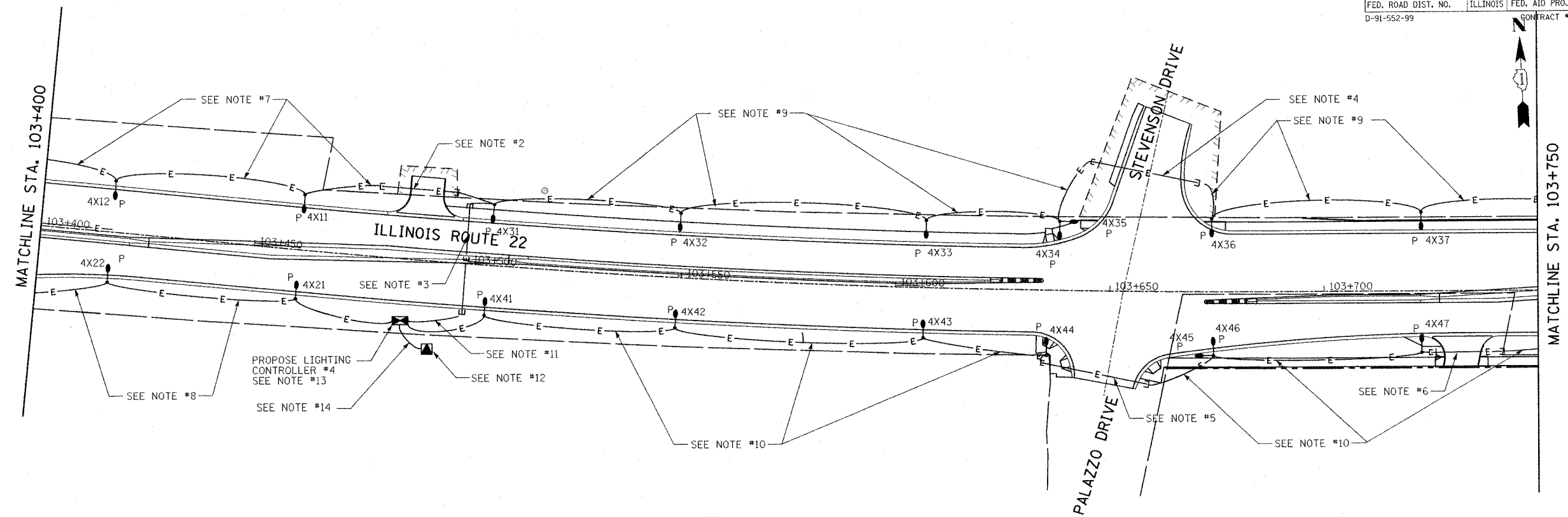

NOTES:

1. EXACT LOCATIONS OF RELOCATED AND PROPOSED POLES AND CONDUIT/CABLE ROUTINGS SHALL BE COORDINATED WITH UNDERGROUND UTILITIES, OWNER AND ENGINEER. LOCATIONS AND ROUTING SHOWN ON PLANS ARE APPROXIMATE.
2. PROPOSED 100mm TRENCHED GRS CONDUIT (18m) WITH: 2*4, 1*8 GND. (CCT 1) IN 50mm UNIT DUCT
3. PROPOSED 100mm PUSHED GRS CONDUIT (26m) WITH: 2*4, 1*8 GND. (CCT 1)
2*4, 1*8 GND. (CCT 3)
IN 50mm UNIT DUCT
4. PROPOSED 100mm PUSHED GRS CONDUIT (25m) WITH: 2*4, 1*8 GND. (CCT 3) IN 50mm UNIT DUCT
5. PROPOSED 100mm TRENCHED GRS CONDUIT (26m) WITH: 2*4, 1*8 GND. (CCT 4) IN 50mm UNIT DUCT
6. PROPOSED 100mm PUSHED GRS CONDUIT (18m) WITH: 2*4, 1*8 GND. (CCT 4) IN 50mm UNIT DUCT
7. PROPOSED 2*4, 1*8 GND. (CCT. 1) IN 50mm UNIT DUCT.
8. PROPOSED 2*4, 1*8 GND. (CCT. 2) IN 50mm UNIT DUCT.
9. PROPOSED 2*4, 1*8 GND. (CCT. 3) IN 50mm UNIT DUCT.
10. PROPOSED 2*4, 1*8 GND. (CCT. 4) IN 50mm UNIT DUCT.
11. PROPOSED 2*4, 1*8 GND. (CCT. 1) AND 2*4, 1*8 GND. (CCT. 3) IN 50mm UNIT DUCT.
12. PROPOSED UTILITY TRANSFORMER WITH 100A, 120/240V, 1-PHASE SECONDARY SERVICE. CONTRACTOR SHALL COORDINATE ALL LOCATIONS AND SERVICE INSTALLATION REQUIREMENTS WITH THE UTILITY.
13. PROPOSED LIGHTING CONTROLLER #4. EXACT LOCATION SHALL BE FIELD COORDINATED WITH OWNER, ENGINEER AND UTILITY COMPANY. PROVIDE CONTROLLER, CONCRETE PAD, GROUND FIELD AND ACCESSORIES AS SHOWN ON ELECTRICAL DETAIL SHEETS.
14. PROPOSED 3*2 XLP-USE IN 100mm GRS CONDUIT. PROVIDE MINIMUM 3.0m OF SLACK IN ALL WIRING AT UTILITY TRANSFORMER FOR USE BY UTILITY.

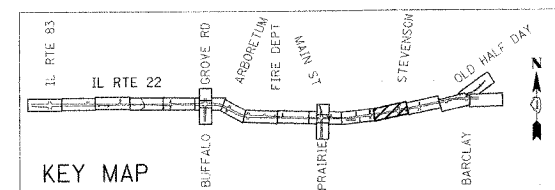

REVISIONS	
NAME	DATE

ILLINOIS DEPARTMENT OF TRANSPORTATION
 IL RTE 22 (FAP 337)
 IL RTE 83 TO US 45 / IL 21 (MILWAUKEE AVE)
PROPOSED LIGHTING PLAN (8 OF 10)
 STA. 103+400 TO STA. 103+750
 SCALE: 1:500
 DATE: 03-22-2004
 DRAWN BY: CMW
 CHECKED BY: MAR