

F.A.P. RTE.	SECTION	COUNTY	TOTAL SHEETS	SHEET NO.
337	202-5	LAKE	362	408
STA. 103+750		TO STA. 104+090		
FED. ROAD DIST. NO.		ILLINOIS	FED. AID PROJECT	
D-91-552-99		CONTRACT #60881		



FINAL SURVEYED	DATE
SURVEY PLOTTED	
NOTE BOOK TEMPLATE	
AREAS CHECKED	
NO.	

ORIGINAL SURVEYED	DATE
SURVEY PLOTTED	
NOTE BOOK TEMPLATE	
AREAS CHECKED	
NO.	

MATCHLINE STA. 103+750

MATCHLINE STA. 104+090

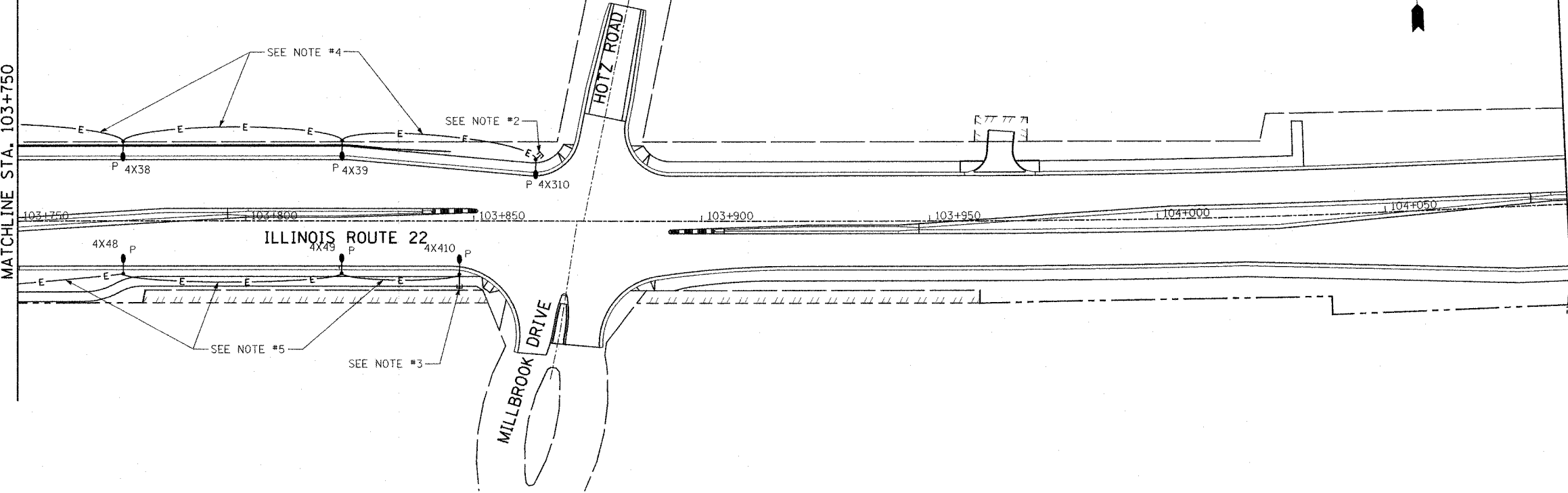

**NOTES:**

1. EXACT LOCATIONS OF RELOCATED AND PROPOSED POLES AND CONDUIT/CABLE ROUTINGS SHALL BE COORDINATED WITH UNDERGROUND UTILITIES, OWNER AND ENGINEER. LOCATIONS AND ROUTING SHOWN ON PLANS ARE APPROXIMATE.
2. PROVIDE 1-50mm CONDUIT STUBBED OUT 1.0m BEYOND LIGHT POLE FOUNDATION FOR FUTURE USE. CAP CONDUIT AT END.
3. PROVIDE 1-50mm CONDUIT STUBBED OUT 1.0m BEYOND SOUTH EDGE OF SIDEWALK FOR FUTURE USE. CAP CONDUIT AT END.
4. PROPOSED 2\*4, 1\*8 GND. (CCT. 3) IN 50mm UNIT DUCT
5. PROPOSED 2\*4, 1\*8 GND. (CCT. 4) IN 50mm UNIT DUCT

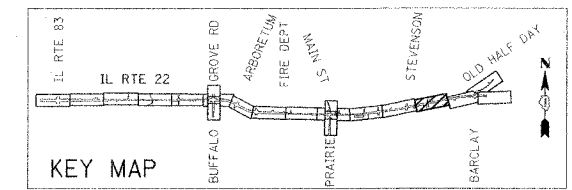

REVISIONS	
NAME	DATE

ILLINOIS DEPARTMENT OF TRANSPORTATION  
 IL RTE 22 (FAP 337)  
 IL RTE 83 TO US 45 / IL 21 (MILWAUKEE AVE)  
 PROPOSED LIGHTING PLAN (9 OF 10)  
 STA. 103+750 TO MILLBROOK DRIVE  
 SCALE: 1:500  
 DATE: 03-22-2004  
 DRAWN BY: CMW  
 CHECKED BY: MAR