

62030

F.A.P. RTE.	SECTION	COUNTY	TOTAL SHEETS	SHEET NO.
337	20 WRS-6	LAKE	318	1
FED. ROAD DIST. NO.	ILLINOIS	FED. AID PROJECT		

STATE OF ILLINOIS  
DEPARTMENT OF TRANSPORTATION  
DIVISION OF HIGHWAYS

FOR INDEX OF SHEETS, SEE SHEET NO. 2

PLANS FOR PROPOSED  
HIGHWAY

TRAFFIC DATA  
ADT:

IL RTE. 22, BUESCHING RD. TO OAKWOOD RD. = 18,400 (2000) 39,000 (2020)  
 IL RTE. 22, OAKWOOD RD. TO QUENTIN RD. = 17,000 (2000) 36,000 (2020)  
 IL RTE. 22, QUENTIN RD. TO E. LIMIT = 17,600 (2000) 40,000 (2020)  
 QUENTIN RD., SOUTH OF IL RTE. 22 = 15,100 (2000) 23,000 (2020)  
 QUENTIN RD., NORTH OF IL RTE. 22 = 10,100 (2000) 15,000 (2020)

POSTED SPEED LIMIT:

IL RTE. 22, EAST OF QUENTIN RD. = 50 MPH  
 EASTBOUND IL RTE. 22, WEST OF QUENTIN RD. = 40 MPH  
 WESTBOUND IL RTE. 22, WEST OF TELSER RD. = 40 MPH  
 WESTBOUND IL RTE. 22, BETWEEN TELSER RD. AND QUENTIN RD. = 45 MPH  
 QUENTIN RD., SOUTH OF IL ROUTE 22 = 45 MPH  
 QUENTIN RD., NORTH OF IL ROUTE 22 = 50 MPH

DESIGN DESIGNATION:

IL RTE. 22 3420(20) STRATEGIC REGIONAL ARTERIAL 8.11 (PCC-20)  
 QUENTIN RD. 2380(20) COUNTY ARTERIAL 8.11 (PCC-20)

IMPROVEMENT LOCATED IN  
THE VILLAGE OF LAKE ZURICH

METRIC RATIOS

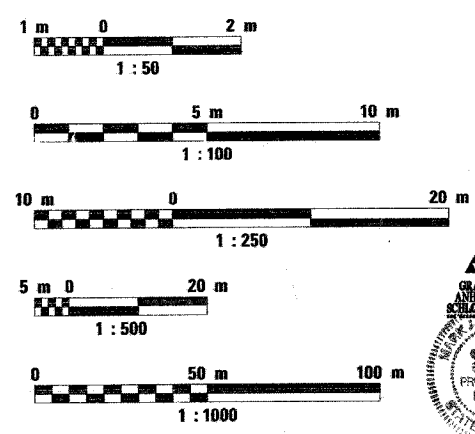

FULL SIZE PLANS HAVE BEEN PREPARED USING STANDARD ENGINEERING SCALES, REDUCED SIZED PLANS WILL NOT CONFORM TO STANDARD SCALES, IN MAKING MEASUREMENTS ON REDUCED PLANS, THE ABOVE SCALES MAY BE USED.

FOR UTILITY INFORMATION, CONTACT J.U.L.I.E.  
(JOINT UTILITY LOCATION INFORMATION FOR EXCAVATION)  
AT 1-800-892-0123

CONTRACT NO. 62030

COUNTY: LAKE SECTION: 20 WRS-6 F.A.P. ROUTE: 337 (IL RTE. 22)

F.A.P. ROUTE 337 (IL RTE. 22)  
BUESCHING ROAD TO QUENTIN ROAD  
SECTION: 20 WRS-6  
ROADWAY RECONSTRUCTION  
PROJECT NO: NHF-0337(007)  
LAKE COUNTY  
C-91-431-00

D-91-431-00

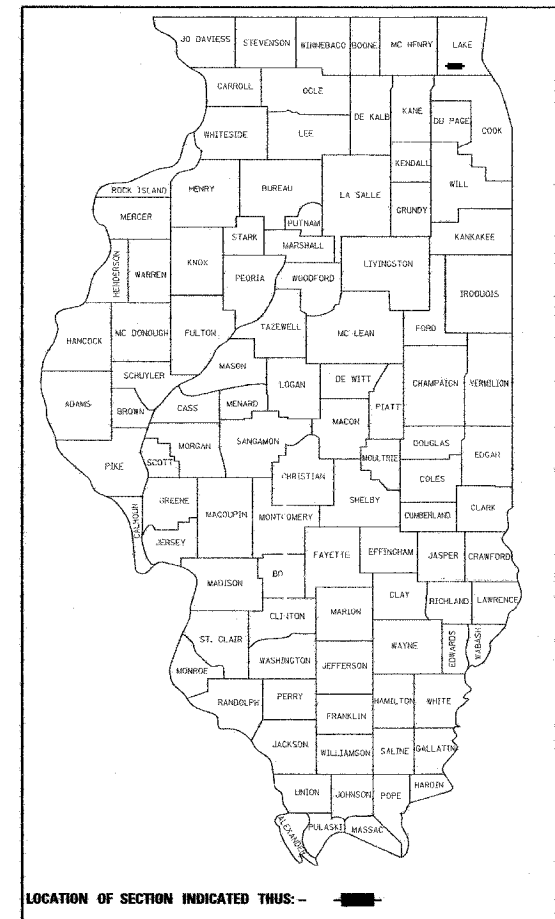

LOCATION OF SECTION INDICATED THUS: -

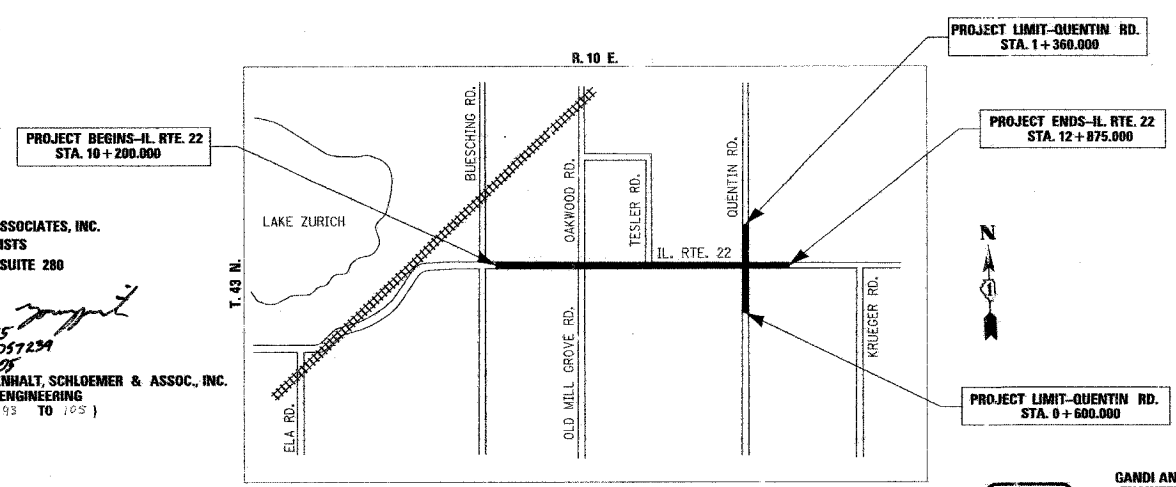

GRAEF, ANHALT, SCHLOEMER & ASSOCIATES, INC.  
ENGINEERS & SCIENTISTS  
8501 WEST HIGGINS ROAD, SUITE 280  
CHICAGO, IL 60631  
(773) 399-0112  
SIGNATURE: *[Signature]*  
DATE: 3/17/05  
IL LICENSE NO. 062-057294  
EXP. DATE: 11-30-05  
FIELD: GRAEF, ANHALT, SCHLOEMER & ASSOC., INC.  
UTILITY ENGINEERING  
(SHEETS 93 TO 195)

V3 INFRASTRUCTURE SERVICES, LTD.  
7325 JANES AVENUE, SUITE 100  
WOODHIDGE, IL 60517  
(630) 724-9800  
SIGNATURE: *[Signature]*  
DATE: 3/17/05  
IL LICENSE NO. 081-005712  
EXP. DATE: 11-30-06  
FIELD: V3 INFRASTRUCTURE SERVICES, LTD.  
STRUCTURAL ENGINEERING  
(SHEETS 150 TO 197)

GROSS & NET LENGTH OF IMPROVEMENT: 2,675 METERS = 2.675 KILOMETERS

PROJECT LIMIT-QUENTIN RD.  
STA. 1+360.000  
PROJECT ENDS-IL RTE. 22  
STA. 12+875.000  
PROJECT LIMIT-QUENTIN RD.  
STA. 0+600.000

GANDI AND ASSOCIATES, INC.  
ENGINEERS AND PLANNERS  
6035 N. NORTHWEST HIGHWAY, SUITE 306  
CHICAGO, IL 60631  
(773) 774-5910  
SIGNATURE: *[Signature]*  
DATE: March 17, 2005  
IL LICENSE NO. 34993  
EXP. DATE: Nov. 30, 2005  
FIELD: GANDI AND ASSOCIATES, INC.  
TRAFFIC ENGINEERING  
(SHEETS 179 TO 195)

STATE OF ILLINOIS  
DEPARTMENT OF TRANSPORTATION  
DIVISION OF HIGHWAYS  
SUBMITTED: March 21, 2005  
*[Signature]* DISTRICT ENGINEER  
May 13, 2005  
*[Signature]* ENGINEER OF DESIGN AND ENVIRONMENT  
May 13, 2005  
*[Signature]* DIRECTOR, DIVISION OF HIGHWAYS

PRINTED BY AUTHORITY OF THE STATE OF ILLINOIS

JAMES J. BENES & ASSOCIATES  
CONSULTING ENGINEERS  
950 WARRENVILLE ROAD, SUITE 101  
LISLE, IL 60532  
(630) 719-7570  
SIGNATURE: *[Signature]*  
DATE: 3/17/05  
IL LICENSE NO. 062-045065  
EXP. DATE: NOVEMBER 30, 2005  
FIELD: JAMES J. BENES AND ASSOCIATES, INC.  
CIVIL ENGINEERING  
(SHEETS 1-61, 74-92, 144-173, 200-201 & 220-319)

IDOT PROJECT MANAGER: KIM VORMITAG (847) 705-4055