

F.A.P. RTE.	SECTION	COUNTY	TOTAL SHEETS	SHEET NO.
337	20 WRS-6	LAKE	3/8	35
STA. 9+950		TO STA. 10+650		
FED. ROAD DIST. NO.		ILLINOIS FED. AID PROJECT		
CONTRACT NO. 62030				

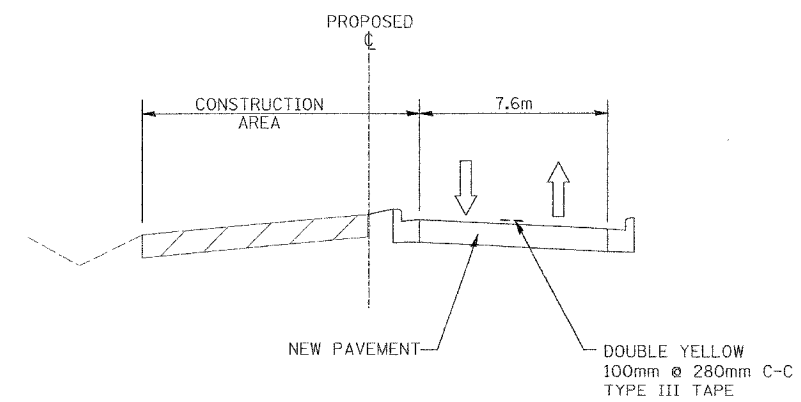
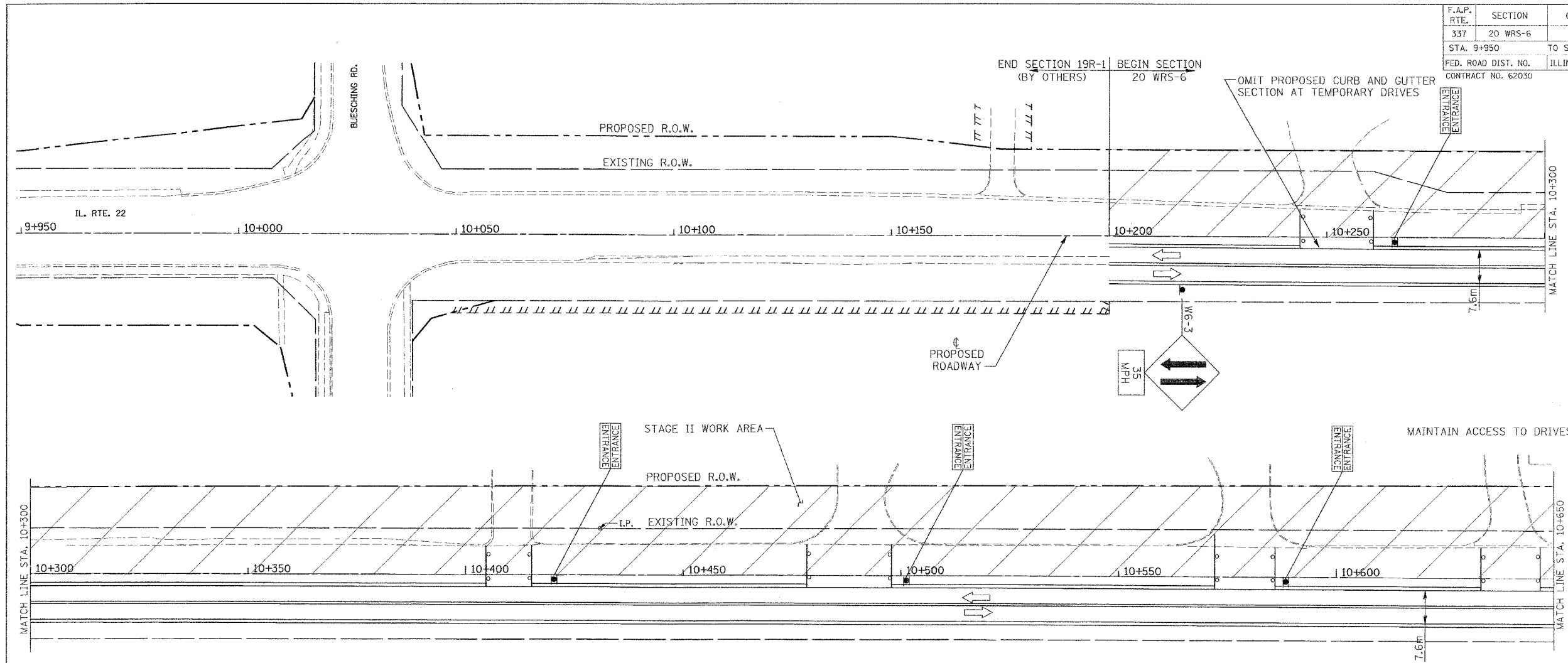

IL 22 STAGE II
STA. 10+200 TO STA. 11+450

- LEGEND**
- CONSTRUCTION AREA
 - DIRECTION OF TRAFFIC
 - TEMPORARY CONCRETE BARRIER WALL WITH VERTICAL PANELS AND STEADY BURN LIGHTS @ 15m C-C
 - TYPE 2 BARRICADES WITH STEADY BURN LIGHTS AT 30m C-C UNLESS OTHERWISE NOTED
 - IMPACT ATTENUATOR
 - TEMPORARY PAVEMENT
 - CONSTRUCTION SIGN
 - DRAINAGE STRUCTURE
 - TEMPORARY CULVERT
 - TEMPORARY SWALE
 - ARROW BOARD

REVISIONS		ILLINOIS DEPARTMENT OF TRANSPORTATION ILLINOIS ROUTE 22 MAINTENANCE OF TRAFFIC STAGE II STA. 9+950 TO STA. 10+650 SCALE IN METERS HORIZ. 1:6500
NAME	DATE	
		DRAWN BY: SMP CHECKED BY: SJC

DATE: 03/11/05