

F.A.P. RTE.	SECTION	COUNTY	TOTAL SHEETS	SHEET NO.
337	20 WRS-6	LAKE	318	47
STA. 0+400		TO STA. 1+100		
FED. ROAD DIST. NO.		ILLINOIS FED. AID PROJECT		
CONTRACT NO. 62030				

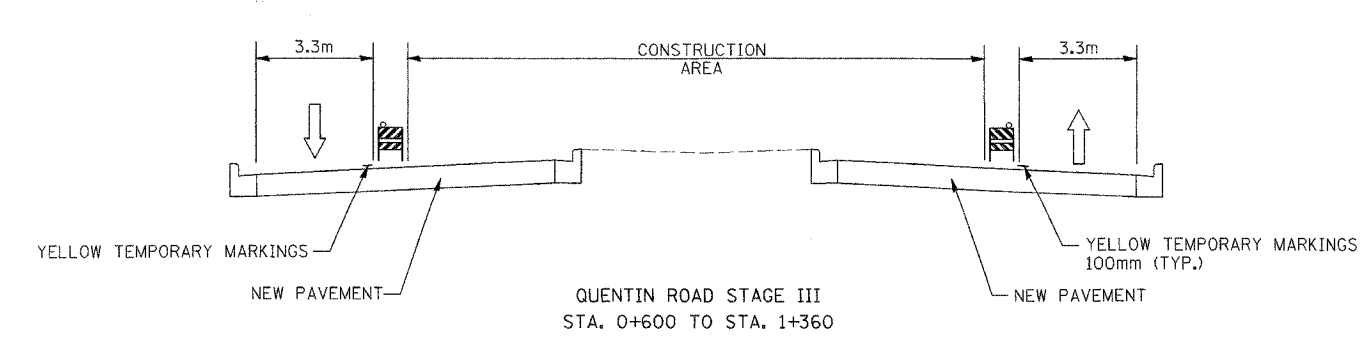
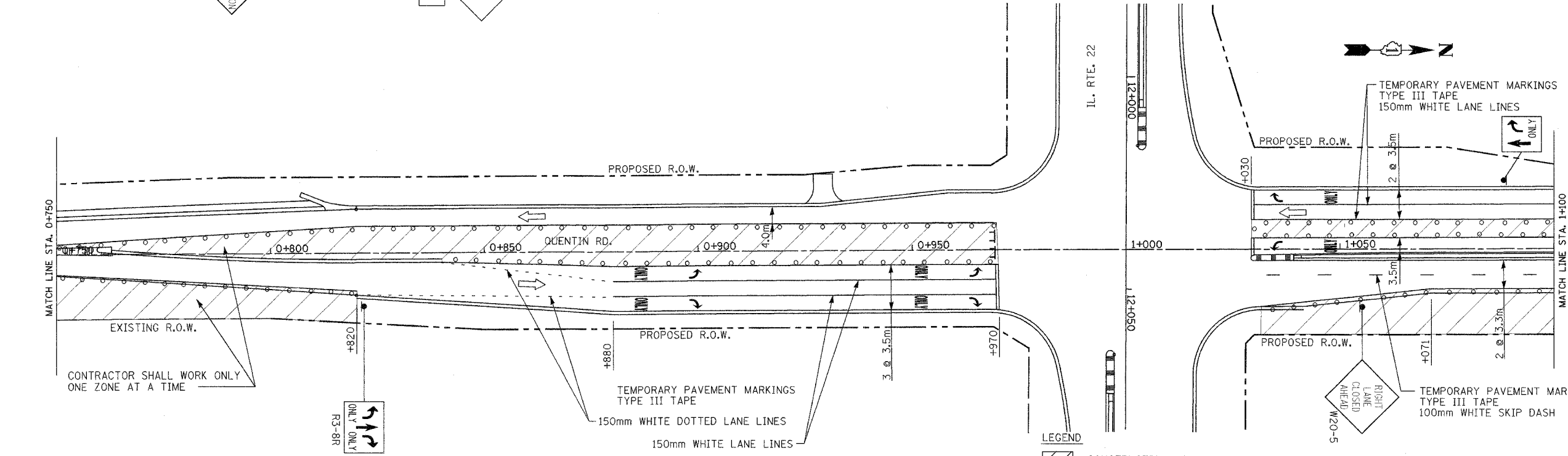
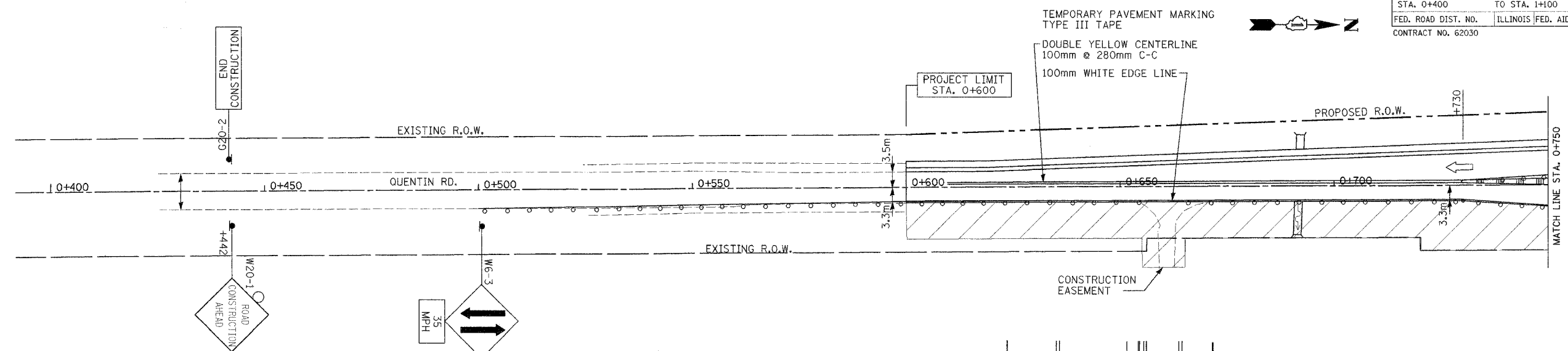

- LEGEND**
- CONSTRUCTION AREA
 - DIRECTION OF TRAFFIC
 - TEMPORARY CONCRETE BARRIER WALL WITH VERTICAL PANELS AND STEADY BURN LIGHTS @ 15m C-C
 - TYPE 2 BARRICADES WITH STEADY BURN LIGHTS AT 30m C-C UNLESS OTHERWISE NOTED
 - IMPACT ATTENUATOR
 - TEMPORARY PAVEMENT
 - CONSTRUCTION SIGN
 - DRAINAGE STRUCTURE
 - TEMPORARY CULVERT
 - TEMPORARY SWALE
 - ARROW BOARD

REVISIONS	
NAME	DATE

ILLINOIS DEPARTMENT OF TRANSPORTATION
ILLINOIS ROUTE 22
MAINTENANCE OF TRAFFIC
STAGE III
STA. 0+400 TO STA. 1+100

SCALE IN METERS
HORIZ. (1:500) DRAWN BY: SMP
DATE: 03/11/05 CHECKED BY: SJG