

F.A.U. RTE.	SECTION	COUNTY	TOTAL SHEETS	SHEET NO.
3545	54-WRS-7	DuPAGE	235	28
STA.		TO STA.		
FED. ROAD DIST. NO.	ILLINOIS	FED. AID PROJECT		
CONTRACT NO. 62291				

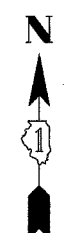

**GENERAL NOTES:**

- DETOUR SIGNS SHALL BE COVERED IF WORK IS SUSPENDED. AT THE END OF ANY WORK SUSPENSION, THE SIGNS SHALL BE UNCOVERED 48 HOURS PRIOR TO RESUMING WORK.
- ALL BARRICADES SHALL BE EQUIPPED WITH STEADY BURN AMBER LIGHTS. THE USE OF BARRICADES WITH FLASHING LIGHTS WILL NOT BE ALLOWED.
- ADVANCE ROAD CLOSURE NOTICE SIGNS SHALL BE INSTALLED TWO WEEKS PRIOR TO THE START OF CONSTRUCTION. ALL ADVANCE WARNING SIGNS SHALL BE INSTALLED TWO DAYS PRIOR TO THE START OF CONSTRUCTION. ALL TRAFFIC CONTROL ITEMS SHALL CONFORM TO THE REQUIREMENTS OF THE IDOT STANDARD SPECIFICATIONS AND IDOT STATE STANDARDS, AS WELL AS THE SPECIAL PROVISIONS FOR TRAFFIC CONTROL AND PROTECTION.
- ALL WARNING SIGNS SHALL HAVE BLACK LEGEND AND BORDER ON REFLECTORIZED ORANGE BACKGROUND UNLESS OTHERWISE SPECIFIED. WARNING SIGNS SHALL BE 48"x48" IN SIZE AND SHALL BE IN LIKE NEW CONDITION. DAMAGED AND/OR DIRTY WARNING SIGNS WILL NOT BE ALLOWED.
- WORK WHICH MAY INTERFERE WITH TRAFFIC FLOW AT INTERSECTIONS SHALL BE PERFORMED BETWEEN 9:00 A.M. AND 3:00 P.M. ONLY. FLAGGERS SHALL BE USED FOR ALL SUCH OPERATIONS.
- PROPOSED GROUND MOUNTED SIGN LOCATIONS MAY BE ADJUSTED IN THE FIELD AS DIRECTED BY THE ENGINEER TO FIT FIELD CONDITIONS.
- ALL SIGNS SHALL CONFORM TO DISTRICT ONE SPECIFICATIONS.

**LEGEND**

□ TYPE III BARRICADE

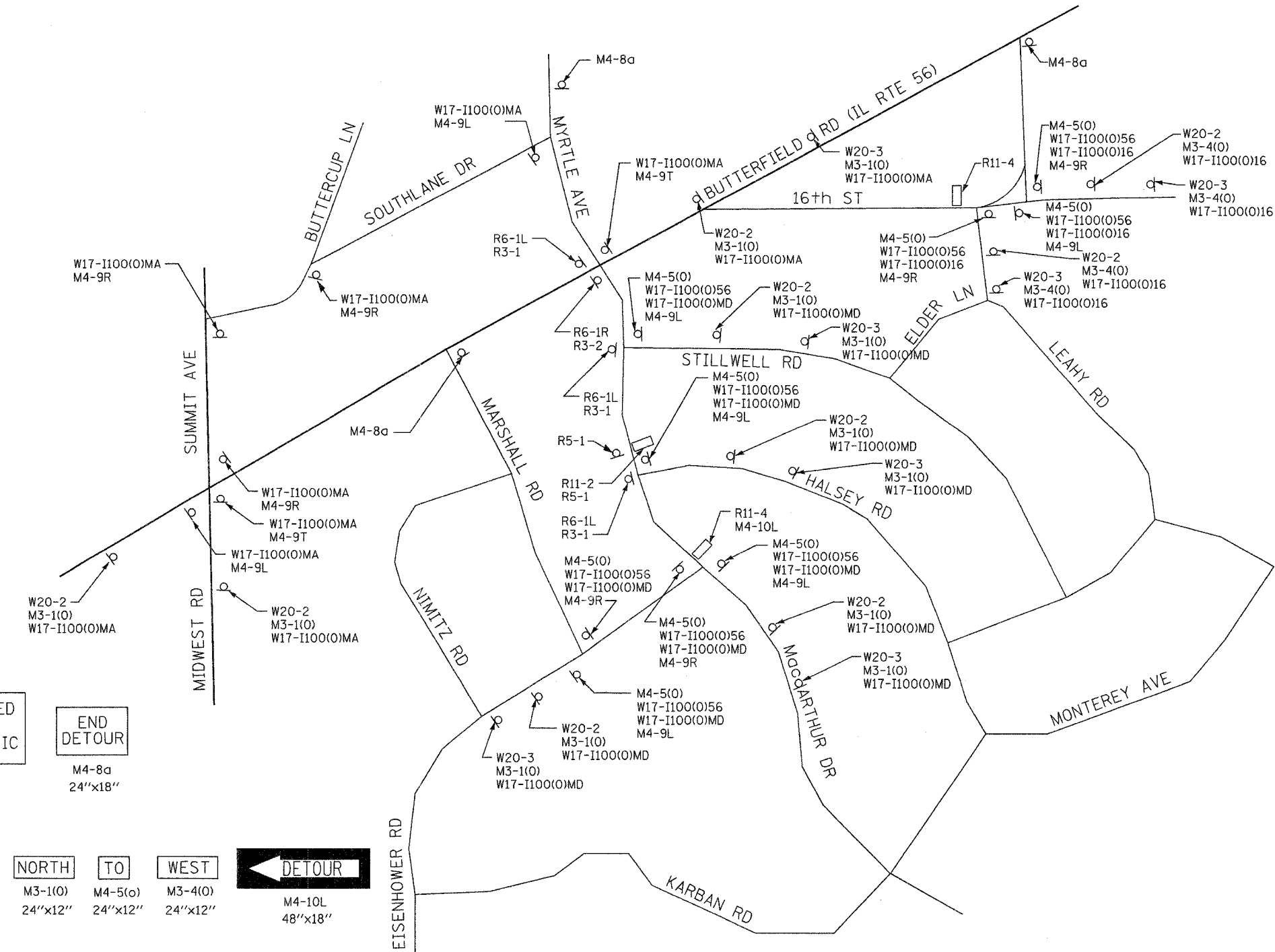
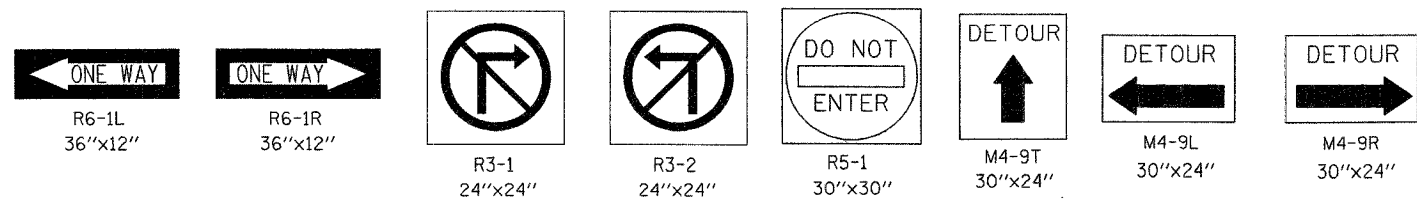
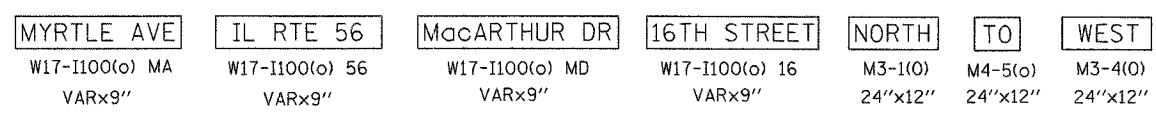
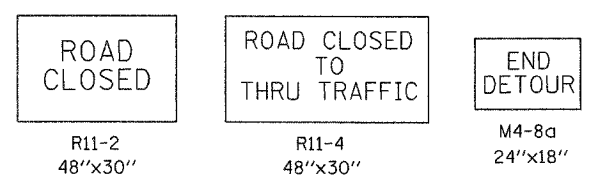
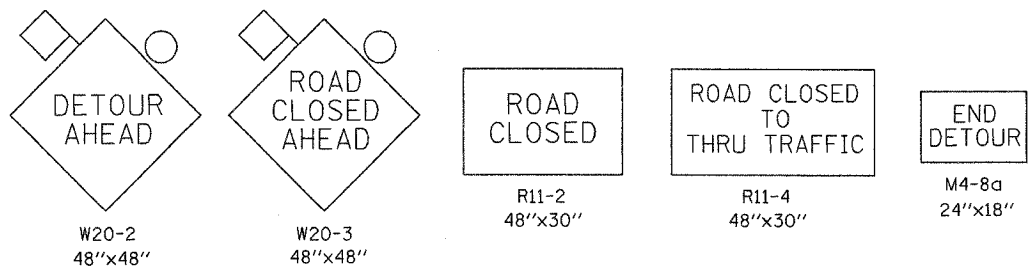

REVISIONS	
NAME	DATE

ILLINOIS DEPARTMENT OF TRANSPORTATION  
 F.A.U. ROUTE 3545  
 BUTTERFIELD ROAD

MAINTENANCE OF TRAFFIC  
 STAGES 2 AND 3 DETOUR SIGNING

SCALE: N/A  
 DATE: 2/20/04

DRAWN BY: SMP  
 CHECKED BY: MGJ