

F.A.U. RTE.	SECTION	COUNTY	TOTAL SHEETS	SHEET NO.
148T	66R	DUPAGE	412	44
STA. 23+00.00		TO STA. 144+00.00		
FED. ROAD DIST. NO.	ILLINOIS	FED. AID PROJECT		
CONTRACT NO. 62376				

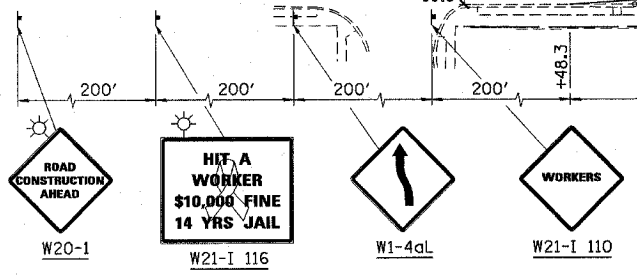
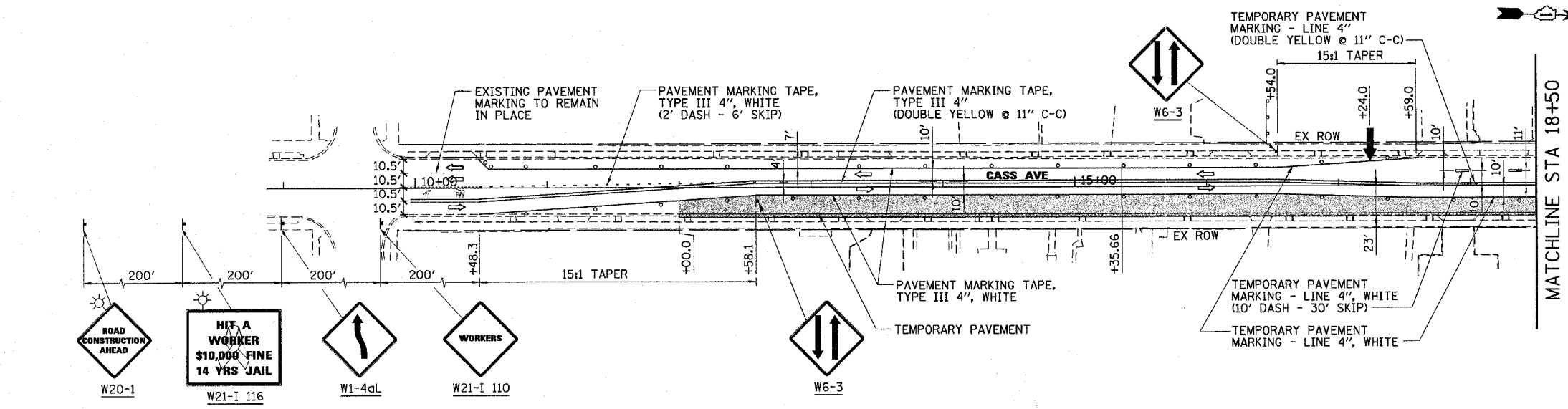
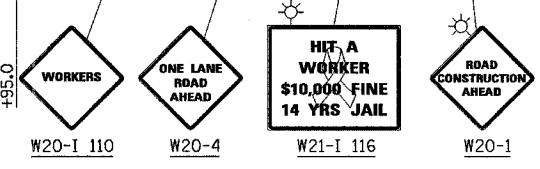
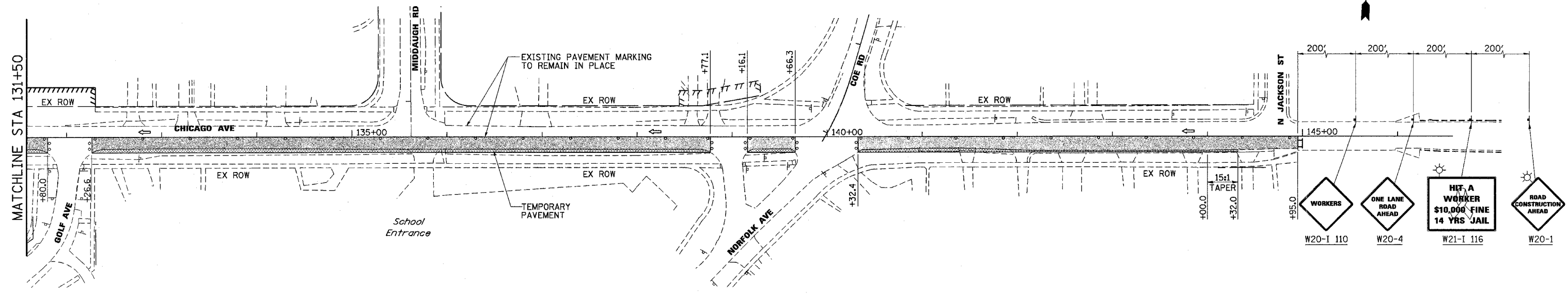

NOTES:

1. CONTRACTOR SHALL MAINTAIN TRAFFIC ALONG CHICAGO AVE IN ACCORDANCE WITH IDOT STANDARD 701501.
2. CONTRACTOR SHALL MAINTAIN TRAFFIC AT ALL SIDE ROAD INTERSECTIONS IN ACCORDANCE WITH IDOT STANDARD 701701 AND IDOT DISTRICT ONE DETAILS, "TRAFFIC CONTROL AND PROTECTION FOR SIDEROADS, INTERSECTIONS AND DRIVEWAYS" AND "TRAFFIC CONTROL AND PROTECTION AT TURN BAYS (TO REMAIN OPEN TO TRAFFIC)".
3. SEE DETOUR PLAN FOR ADDITIONAL INFORMATION AND SIGNING.
4. CONTRACTOR SHALL MAINTAIN TRAFFIC ALONG CASS AVENUE IN ACCORDANCE WITH IDOT STANDARD 701606.
5. SIGNS SHALL BE PLACED AT ALL COMMERCIAL DRIVEWAYS DURING CONSTRUCTION TO IDENTIFY OPENING LOCATIONS. SEE TEMPORARY DRIVEWAY SIGN DETAIL.

LEGEND:

- TEMPORARY WIDENING
- WORKING AREA, PRE-STAGE
- TRAFFIC DIRECTION
- BARRICADES OR DRUMS @ 50' C-C WITH STEADY BURN LIGHTS
- VERTICAL PANELS W/STEADY BURN LIGHT @ 50' C-C
- TYPE III BARRICADE W/2 STEADY BURN LIGHTS
- TRAFFIC CONTROL SIGNS
- ARROW BOARD

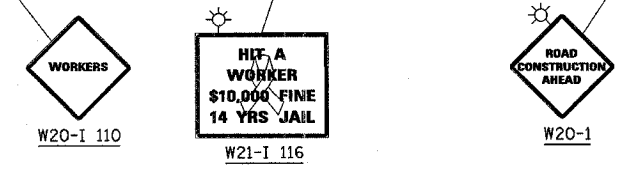
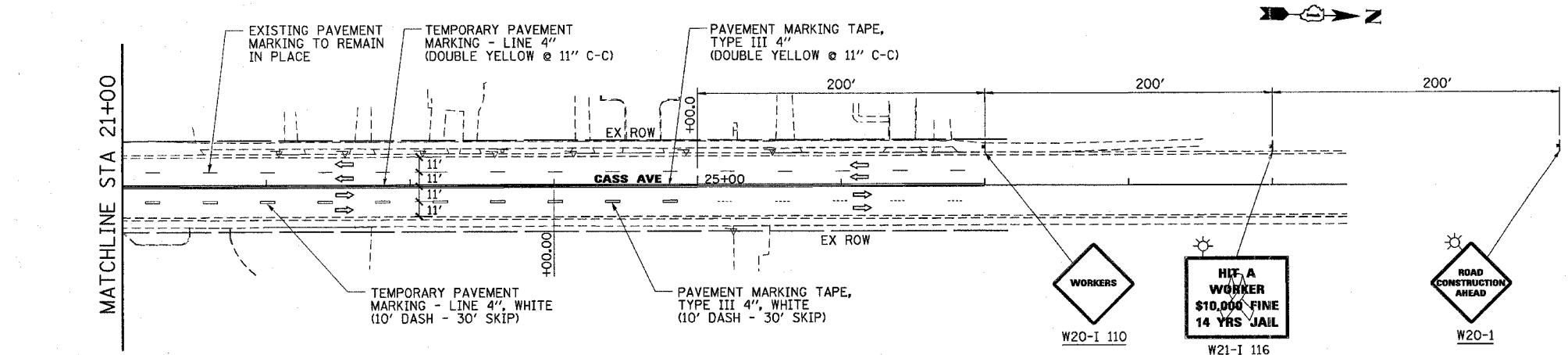
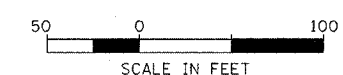

REVISIONS	
NAME	DATE

ILLINOIS DEPARTMENT OF TRANSPORTATION
SUGGESTED MAINTENANCE OF TRAFFIC PLAN
MAPLE AVENUE / CHICAGO AVENUE
PRE-STAGE
SHEET 4 OF 4

SCALE: 1"=50'
DATE: 22-NOV-2004
DRAWN BY: E.D.
CHECKED BY: G.T.

Whole Firm Registration No. 04-00533

Stanley Consultants INC.
850 West Higgins Road, Suite 730
Chicago, Illinois 60631-2801
www.stanleygroup.com