

F.A.U. RTE.	SECTION	COUNTY	TOTAL SHEETS	SHEET NO.
1487	66R	DuPAGE	412	18
STA. 23+00.00		TO STA. 144+00.00		
FED. ROAD DIST. NO.		ILLINOIS FED. AID PROJECT		
CONTRACT NO. 62376				

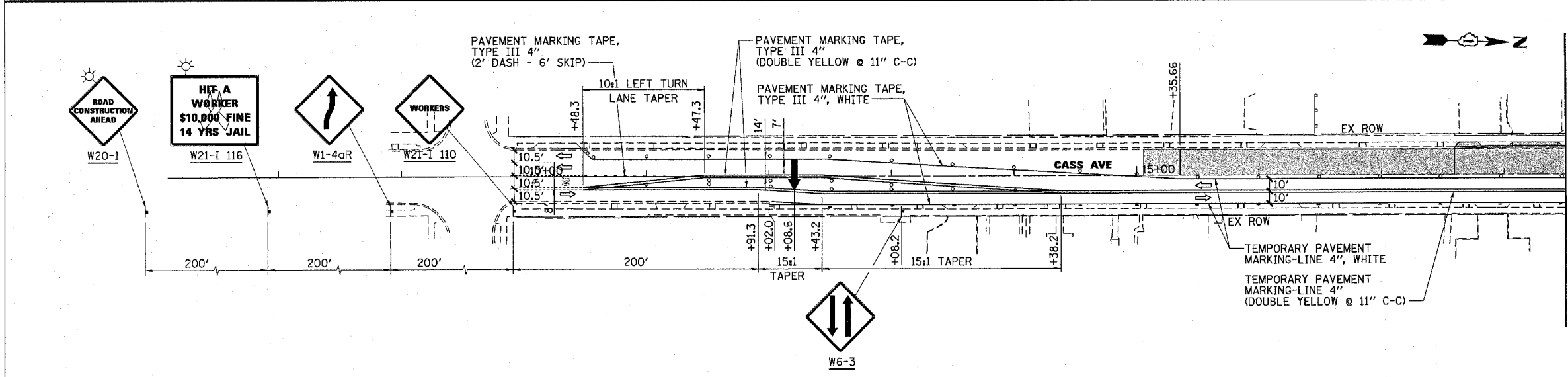

- NOTES:**
- CONTRACTOR SHALL MAINTAIN TRAFFIC ALONG CHICAGO AVE IN ACCORDANCE WITH IDOT STANDARD 701501.
 - CONTRACTOR SHALL MAINTAIN TRAFFIC AT ALL SIDE ROAD INTERSECTIONS IN ACCORDANCE WITH IDOT STANDARD 701701 AND IDOT DISTRICT ONE DETAILS, "TRAFFIC CONTROL AND PROTECTION FOR SIDEROADS, INTERSECTIONS AND DRIVEWAYS" AND "TRAFFIC CONTROL AND PROTECTION AT TURN BAYS (TO REMAIN OPEN TO TRAFFIC)".
 - SEE DETOUR PLAN FOR ADDITIONAL INFORMATION AND SIGNING.
 - CONTRACTOR SHALL MAINTAIN TRAFFIC ALONG CASS AVENUE IN ACCORDANCE WITH IDOT STANDARD 701606.
 - SIGNS SHALL BE PLACED AT ALL COMMERCIAL DRIVEWAYS DURING CONSTRUCTION TO IDENTIFY OPENING LOCATIONS. SEE TEMPORARY DRIVEWAY SIGN DETAIL.

- LEGEND:**
- TEMPORARY WIDENING
 - WORKING AREA, STAGE 1
 - TRAFFIC DIRECTION
 - BARRICADES OR DRUMS @ 50' C-C WITH STEADY BURN LIGHTS
 - VERTICAL PANELS W/STEADY BURN LIGHT @ 50' C-C
 - TYPE III BARRICADE W/2 STEADY BURN LIGHTS
 - TRAFFIC CONTROL SIGNS
 - ARROW BOARD

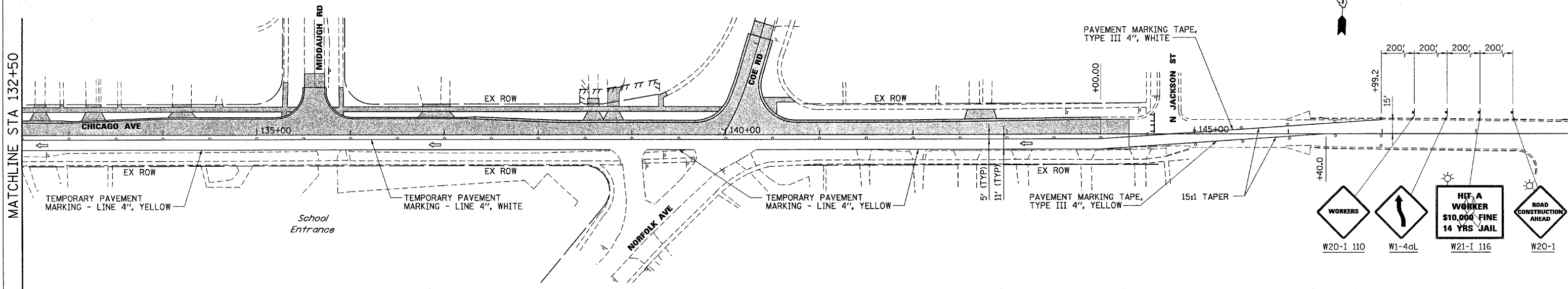
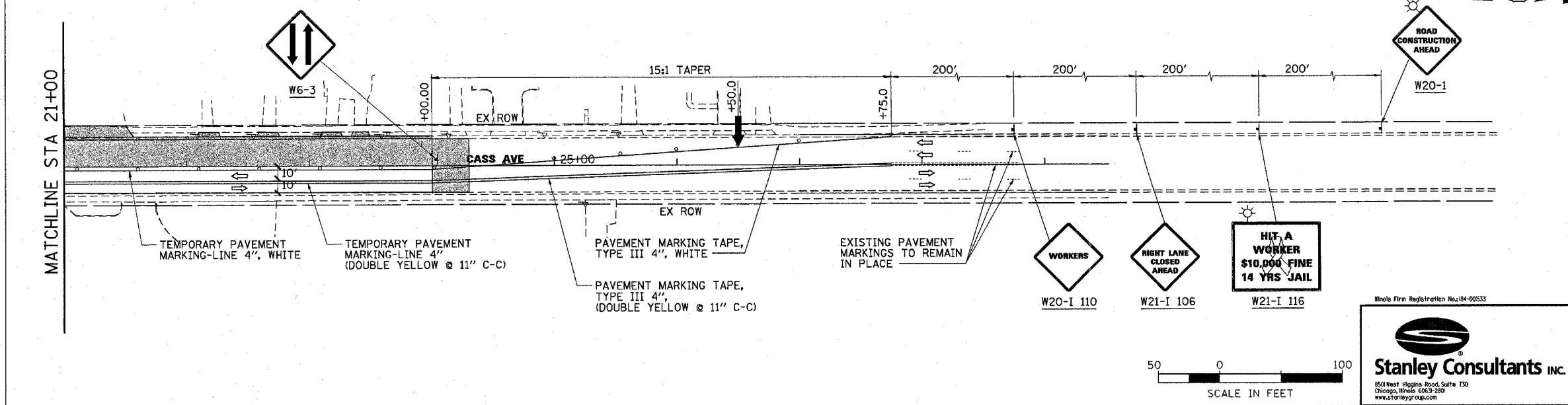

REVISIONS	
NAME	DATE

ILLINOIS DEPARTMENT OF TRANSPORTATION

SUGGESTED MAINTENANCE OF TRAFFIC PLAN
MAPLE AVENUE / CHICAGO AVENUE
STAGE 1
SHEET 4 OF 4

SCALE: 1"=50'
DATE: 04-JAN-2005
DRAWN BY: E.D.
CHECKED BY: G.T.

Illinois Fire Registration No. 04-00533

Stanley Consultants INC.
850 West Higgins Road, Suite 730
Chicago, Illinois 60630-2803
www.stanleygrp.com

