

NOTES:

- CONTRACTOR SHALL MAINTAIN TRAFFIC ALONG NAPERVILLE RD/CHICAGO AVE IN ACCORDANCE WITH IDOT STANDARD 701501.
- CONTRACTOR SHALL MAINTAIN TRAFFIC AT ALL SIDE ROAD INTERSECTIONS IN ACCORDANCE WITH IDOT STANDARD 701701 AND IDOT DISTRICT ONE DETAILS, "TRAFFIC CONTROL AND PROTECTION FOR SIDEROADS, INTERSECTIONS AND DRIVEWAYS" AND "TRAFFIC CONTROL AND PROTECTION AT TURN BAYS (TO REMAIN OPEN TO TRAFFIC)".
- SEE DETOUR PLAN FOR ADDITIONAL INFORMATION AND SIGNING.
- CONTRACTOR SHALL MAINTAIN TRAFFIC ALONG CASS AVENUE IN ACCORDANCE WITH IDOT STANDARD 701501.
- THIS SECTION OF NAPERVILLE ROAD SHALL BE CONSTRUCTED IN SUB-STAGES AS DIRECTED BY THE ENGINEER.
- SIGNS SHALL BE PLACED AT ALL COMMERCIAL DRIVEWAYS DURING CONSTRUCTION TO IDENTIFY OPENING LOCATIONS. SEE TEMPORARY DRIVEWAY SIGN DETAIL.

F.A.U. RTE.	SECTION	COUNTY	TOTAL SHEETS	SHEET NO.
148T	66R	DuPAGE	412	50
STA. 23+00.00		TO STA. 144+00.00		
FED. ROAD DIST. NO.		ILLINOIS FED. AID PROJECT		
CONTRACT NO. 62376				

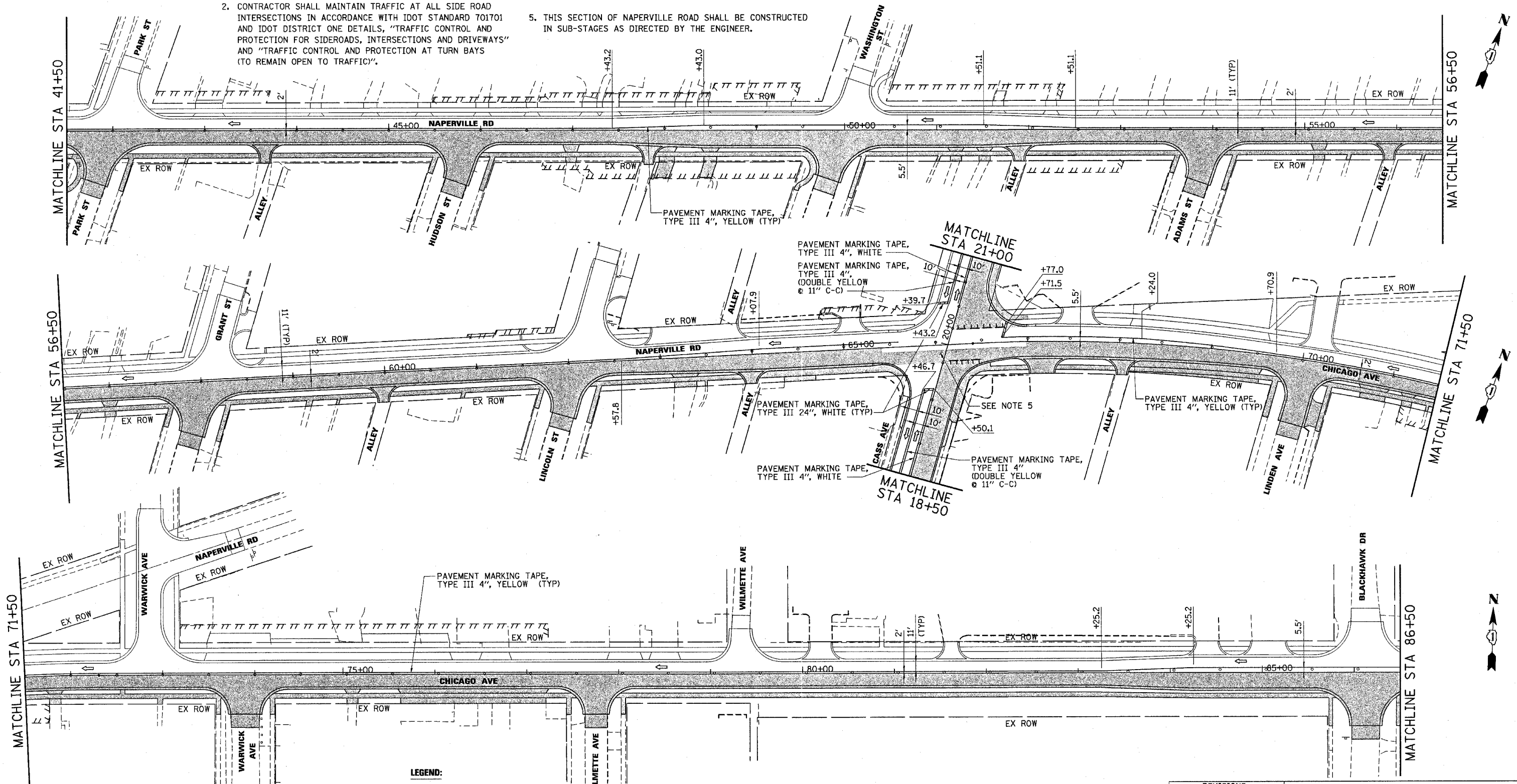

- LEGEND:**
- TEMPORARY WIDENING
 - WORKING AREA, STAGE 2
 - TRAFFIC DIRECTION
 - BARRICADES OR DRUMS @ 50' C-C WITH STEADY BURN LIGHTS

- VERTICAL PANELS W/STEADY BURN LIGHT @ 50' C-C
- TYPE III BARRICADE W/2 STEADY BURN LIGHTS
- TRAFFIC CONTROL SIGNS
- ARROW BOARD

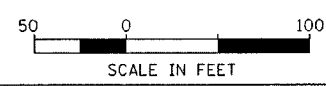

Wholesale Firm Registration No. 84-00533

Stanley Consultants Inc.
 850 West Higgins Road, Suite 730
 Chicago, Illinois 60633-2001
 www.stanleygroup.com

REVISIONS	
NAME	DATE

ILLINOIS DEPARTMENT OF TRANSPORTATION

**SUGGESTED MAINTENANCE OF TRAFFIC PLAN
 MAPLE AVENUE / CHICAGO AVENUE
 STAGE 2
 SHEET 2 OF 4**

SCALE: 1"=50'
 DATE: 22-NOV-2004

DRAWN BY: E.D.
 CHECKED BY: G.T.