

F.A.U. RTE.	SECTION	COUNTY	TOTAL SHEETS	SHEET NO.
1487	66R	DU PAGE	412	121
STA. 23+00.00		TO STA. 144+00.00		
FED. ROAD DIST. NO.		ILLINOIS FED. AID PROJECT		
CONTRACT NO. 62376				

TIE BAR AND SEALING SCHEDULE									
PAVEMENT TYPE	EPOXY COATED	DEFORMED	SIZE	LENGTH	SPACING	DRILL & GROUT	POUR IN	SEAL	STANDARD
JOINTED PCC									420001, 420101 & 420111 (GEN)
TRANSVERSE									
SAWED CONTRACTION JOINT	Y	N	•	18	12	N	Y	HP (HOTPOUR)	420001
CONSTRUCTION JOINT	Y	N	•	13	12	N	Y	HP	420101, 420106
EXPANSION JOINT	Y	N	•	18	12	N	Y	PF (PREFORM)	420001
LONGITUDINAL									
SAWED CONTRACTION JOINT	Y	N	NO. 6	30	30	N	Y	HP	420001
CONSTRUCTION JOINT	Y	N	NO. 6	24	24	Y	N	••	420001
CURB AND GUTTER	Y	N	NO. 6	24	24	Y	-	HP	606001

• SEE TABLE STANDARD 420001
 •• ASTM D 3405 SEALANT

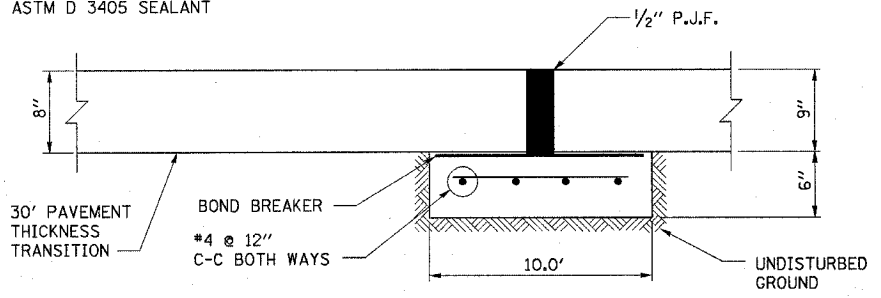

**SEPARATION JOINT WITH SLEEPER SLAB
 DETAIL A**
 NTS

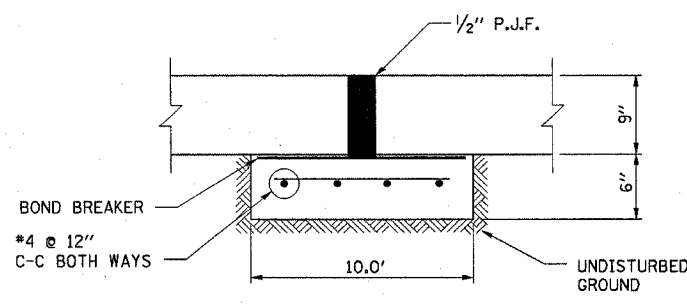
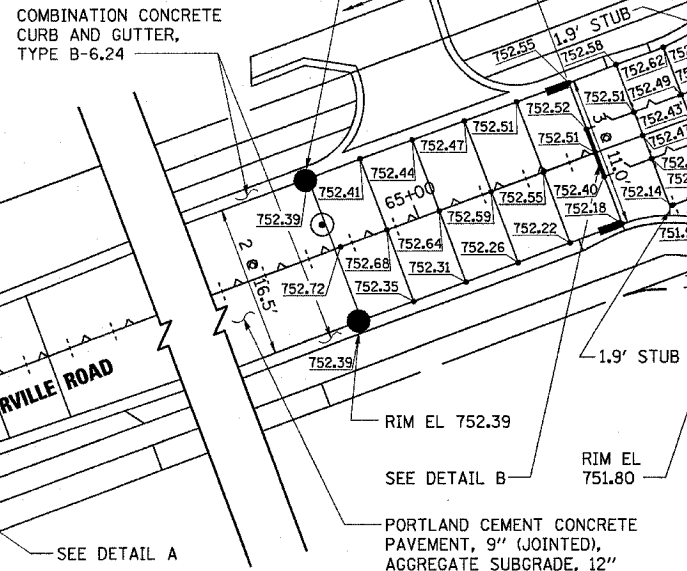

**SEPARATION JOINT WITH SLEEPER SLAB
 DETAIL B**
 NTS

LEGEND:

- CONSTRUCTION JOINT W/TIE BARS
- SAWED LONGITUDINAL JOINT W/TIE BARS
- SEPARATION JOINT WITH SLEEPER SLAB (SEE DETAIL ON THIS SHEET)
- SAWED CONTRACTION JOINT
- PROPOSED MANHOLE
- PROPOSED CATCH BASIN
- PROPOSED INLET
- PANEL WITH DOWEL BARS ON ALL SIDES. (SEE STANDARDS 420001, 420101, AND 420111 FOR MORE INFORMATION)

- NOTES:**
- ALL JOINTS EXCEPT SEPARATION JOINT WITH SLEEPER SLAB SHALL BE INCLUDED IN THE COST OF PORTLAND CEMENT CONCRETE PAVEMENT, 9" (JOINTED) OR PORTLAND CEMENT CONCRETE PAVEMENT, 8" (JOINTED)
 - TO PREVENT MID-PANEL CRACKING, TIE MAXIMUM LONGITUDINAL AND TRANSVERSE JOINT SPACING SHALL BE 12' ON NAPERVILLE RD. AND 14' ON CASS AVE.

PROP CURVE (C5)
 PI STA = 69+38.04
 $\Delta = 18^\circ 38' 37''$ (LT)
 $D = 3^\circ 09' 31''$
 $R = 1,813.96'$
 $T = 297.76'$
 $L = 590.25'$
 $E = 24.28'$
 PC STA = 66+40.28
 PT STA = 72+30.53
 SE = N.C.

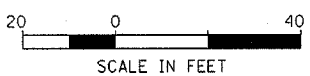

REVISIONS	
NAME	DATE

ILLINOIS DEPARTMENT OF TRANSPORTATION

**INTERSECTION DETAILS
 NAPERVILLE ROAD AND CASS AVENUE**

SCALE: 1"=20'
 DATE 14-JAN-2005

DRAWN BY E.D.
 CHECKED BY G.T.