

F.A.U. RTE.	SECTION	COUNTY	TOTAL SHEETS	SHEET NO.
1487	66R	DuPAGE	412	128
STA. 23+00.00		TO STA. 144+00.00		
FED. ROAD DIST. NO.		ILLINOIS FED. AID PROJECT		
CONTRACT NO. 62376				

**LEGEND:**

- |  |  |
|--|--|
| ① POLYUREA PAVEMENT MARKING, TYPE I WHITE LINE, 4", FT   | ⑩ RAISED REFLECTIVE PAVEMENT MARKER, CRYSTAL, EACH<br>◀ ONE-WAY CRYSTAL MARKER |
| ② POLYUREA PAVEMENT MARKING, TYPE I YELLOW LINE, 4", FT  | ⑪ RAISED REFLECTIVE PAVEMENT MARKER, AMBER, EACH<br>◀ TWO-WAY AMBER MARKER     |
| ③ POLYUREA PAVEMENT MARKING, TYPE I DOUBLE YELLOW LINE, 4" @ 11", FT                                   | ⑫ RAISED REFLECTIVE PAVEMENT MARKER, AMBER, EACH<br>▶ ONE-WAY AMBER MARKER     |
| ④ POLYUREA PAVEMENT MARKING, TYPE I WHITE LINE, 6", FT   | ⑬ POLYUREA PAVEMENT MARKING, TYPE I WHITE LINE, 6", 2' LONG, 6' SPACING        |
| ⑤ RAISED REFLECTIVE PAVEMENT MARKER (BRIDGE), AMBER, EACH<br>▶ TWO-WAY AMBER MARKER                    | ⑭ POLYUREA PAVEMENT MARKING, TYPE I WHITE LINE, 6", 10' LONG, 30' SPACING      |
| ⑥ POLYUREA PAVEMENT MARKING, TYPE I WHITE LINE, 12", FT  | ⑮ POLYUREA PAVEMENT MARKING, TYPE I LETTERS AND SYMBOLS WHITE (18.3) SQ FT     |
| ⑦ POLYUREA PAVEMENT MARKING, TYPE I YELLOW LINE, 12", FT   |  |
| ⑧ POLYUREA PAVEMENT MARKING, TYPE I WHITE LINE, 24", FT  |  |
| ⑨ POLYUREA PAVEMENT MARKING, TYPE I LETTERS AND SYMBOLS WHITE, (11.8+8.8)=20.6 SQ FT, EACH COMBINATION |  |

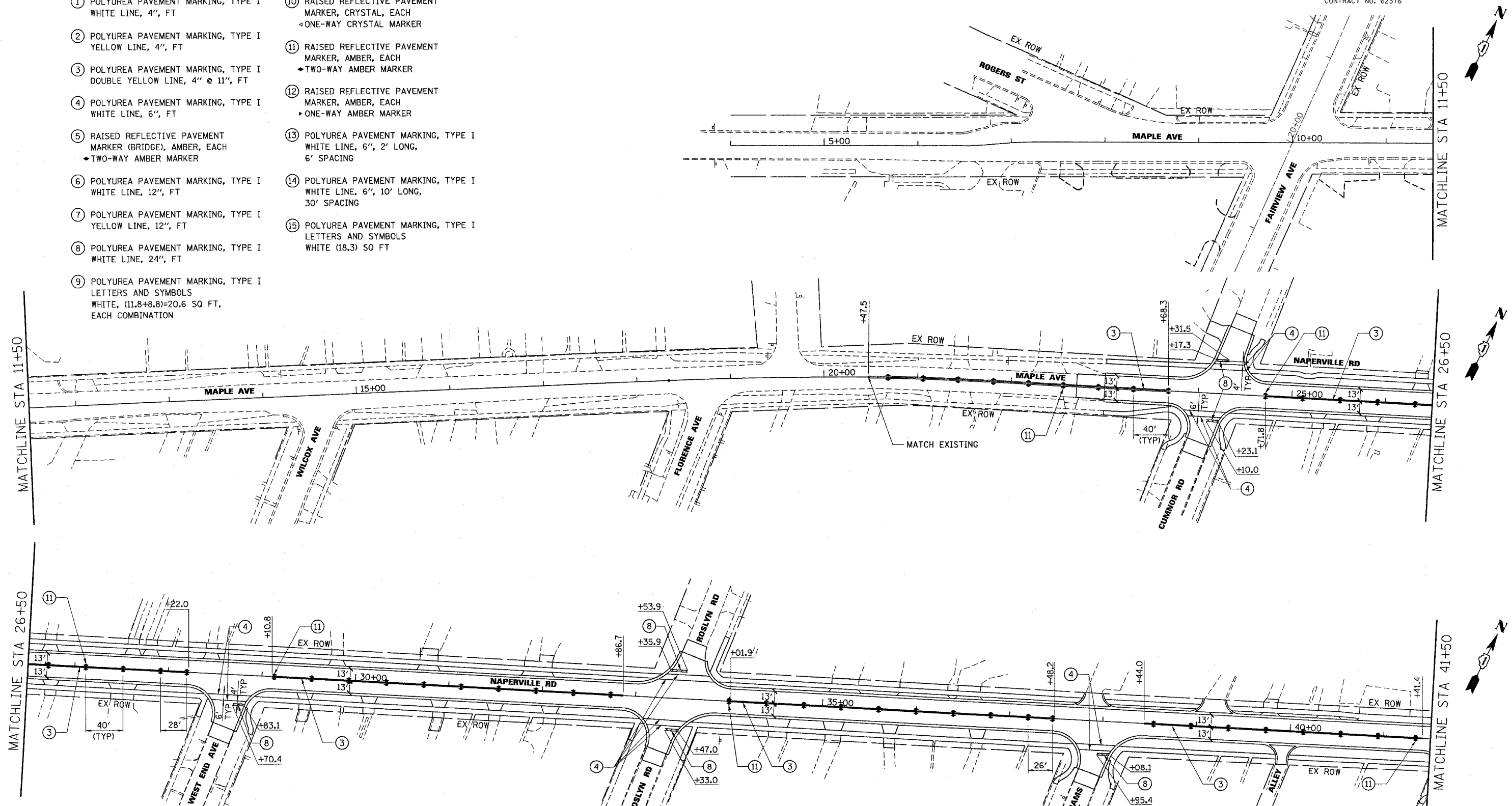

MATCHLINE STA 11+50

MATCHLINE STA 11+50

MATCHLINE STA 26+50

MATCHLINE STA 26+50

MATCHLINE STA 41+50

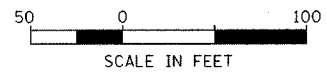

Illinois Firm Registration No. 84-00533

**Stanley Consultants INC.**  
850 West Higgins Road, Suite 730  
Chicago, Illinois 60630-2808  
www.stanleygroup.com

REVISIONS	
NAME	DATE

ILLINOIS DEPARTMENT OF TRANSPORTATION

**PAVEMENT MARKING  
MAPLE AVENUE / CHICAGO AVENUE  
SHEET 1 OF 4**

SCALE: 1"=50'  
DATE: 22-NOV-2004

DRAWN BY: E.D.  
CHECKED BY: A.M.