

FAP 330,	SECTION	COUNTY	TOTAL SHEETS	SHEET NO.
FAI 90/94	2004-124I	COOK	36	9

Sheet 1 of 11

CONTRACT 62603

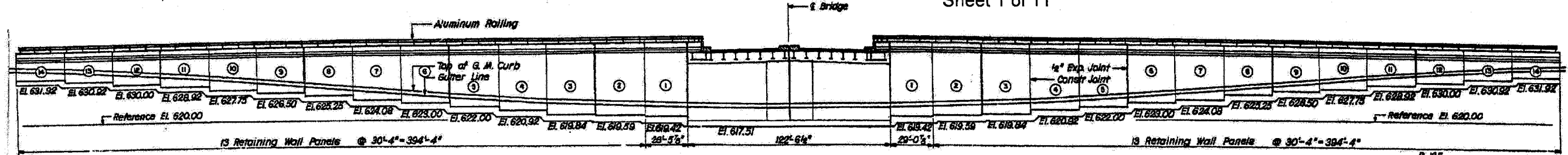

ELEVATION A-A
Scale: Horiz. 1"=30'-0"; Vert. 1"=10'-0"

STATION 57+54.38
BUILT 197 BY
STATE OF ILLINOIS
F.A. RT. 45 SEC. 464-HB-BR
PROJECT U-183(23)
LOADING HS20

NAME PLATE

See Sta 213
(For location see Sheet No. 4)

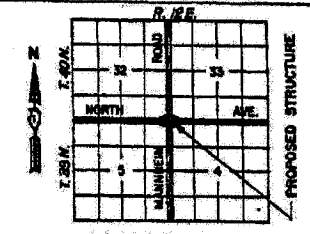

LOCATION PLAN

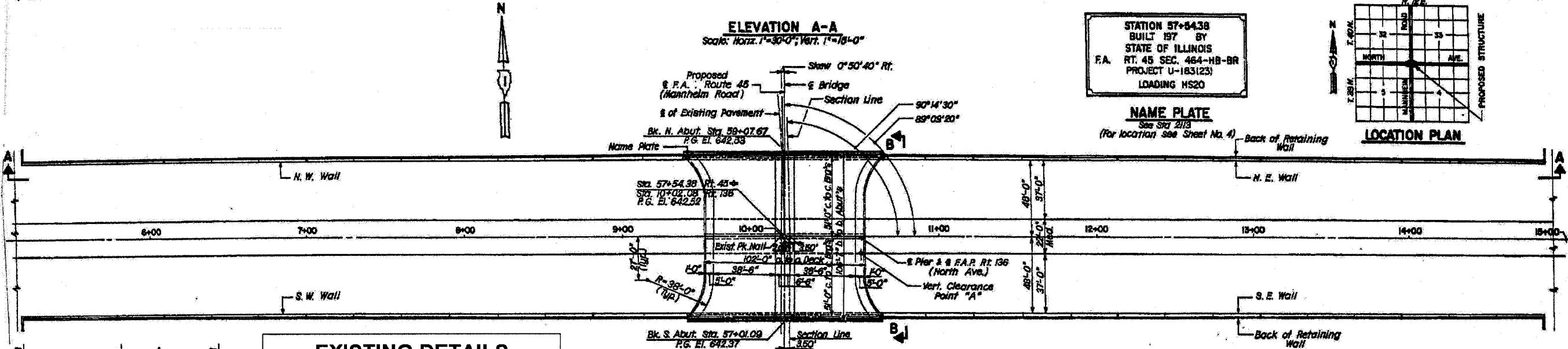

EXISTING DETAILS FOR INFORMATION ONLY

TOTAL BILL OF MATERIALS

PAY ITEM	UNIT	QUANTITY
Concrete Removal	Cu Yd	113.9
Concrete Superstructure	Cu Yd	128.3
Bar Splicers	Each	276
Reinforcement Bars Epoxy Coated	Pound	21,420
Deck Slab Repair Full Depth, Type II	Sq Yd	16
Epoxy Crack Sealing	Foot	121
Bridge Deck Hydro-Scarification 1/2"	Sq Yd	859
Bridge Deck Latex Concrete Overlay, 2 1/4"	Sq Yd	859
Bituminous Concrete Removal (Deck)	Sq Yd	859
Bridge Deck Grooving	Sq Yd	1,057
Protective Coat	Sq Yd	2,235
Protective Shield	Sq Yd	1,230

General Notes
Reinforcement bars shall conform to the requirements of AASHTO M-31, M322, Grade 60.

Plan dimensions and details relative to existing structure have been taken from existing plans and are subject to nominal construction variations. It shall be the Contractor's responsibility to verify such dimensions and details in the field and make necessary approved adjustments prior to construction or ordering of materials. Such variations shall not be cause for additional compensation for a change in the scope of the work, however, the Contractor will be paid for the quantity actually furnished at the unit price bid for the work.

Any reinforcement bars that are damaged during concrete removal shall be replaced with a approved bar splicer or anchorage system. Cost shall be included in the cost of "Concrete Removal".

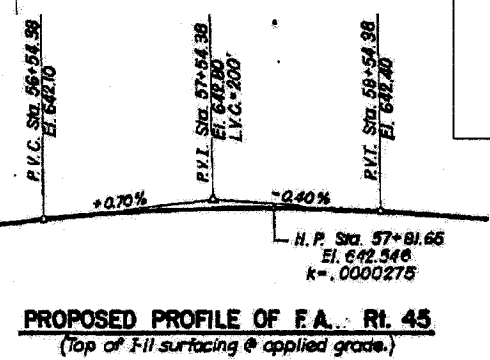

PROPOSED PROFILE OF F.A. RT. 45
(Top of Fill surfacing @ applied grade.)

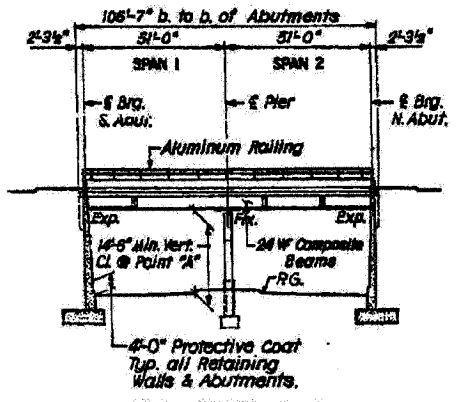

ELEVATION B-B
Scale: 1"=30'-0"

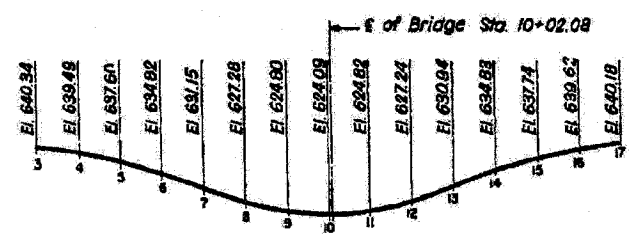

EXISTING PROFILE OF F.A.P. RT. 136 (NORTH AVE.)

ILLINOIS DEPARTMENT OF TRANSPORTATION
GERNERAL PLAN AND ELEVATION
LOC 1: US 12/ 45 OVER IL 64
SN 016-0336