

F.A.I. RTE.	SECTION	COUNTY	TOTAL SHEETS	SHEET NO.
94	*	COOK	860	68
STA. 2200+00.00 TO STA. 2362+00.00				
FED. ROAD DIST. NO. ILLINOIS		FED. AID PROJECT		
* (1516.1, 1717 & 1818) R-8		62694		

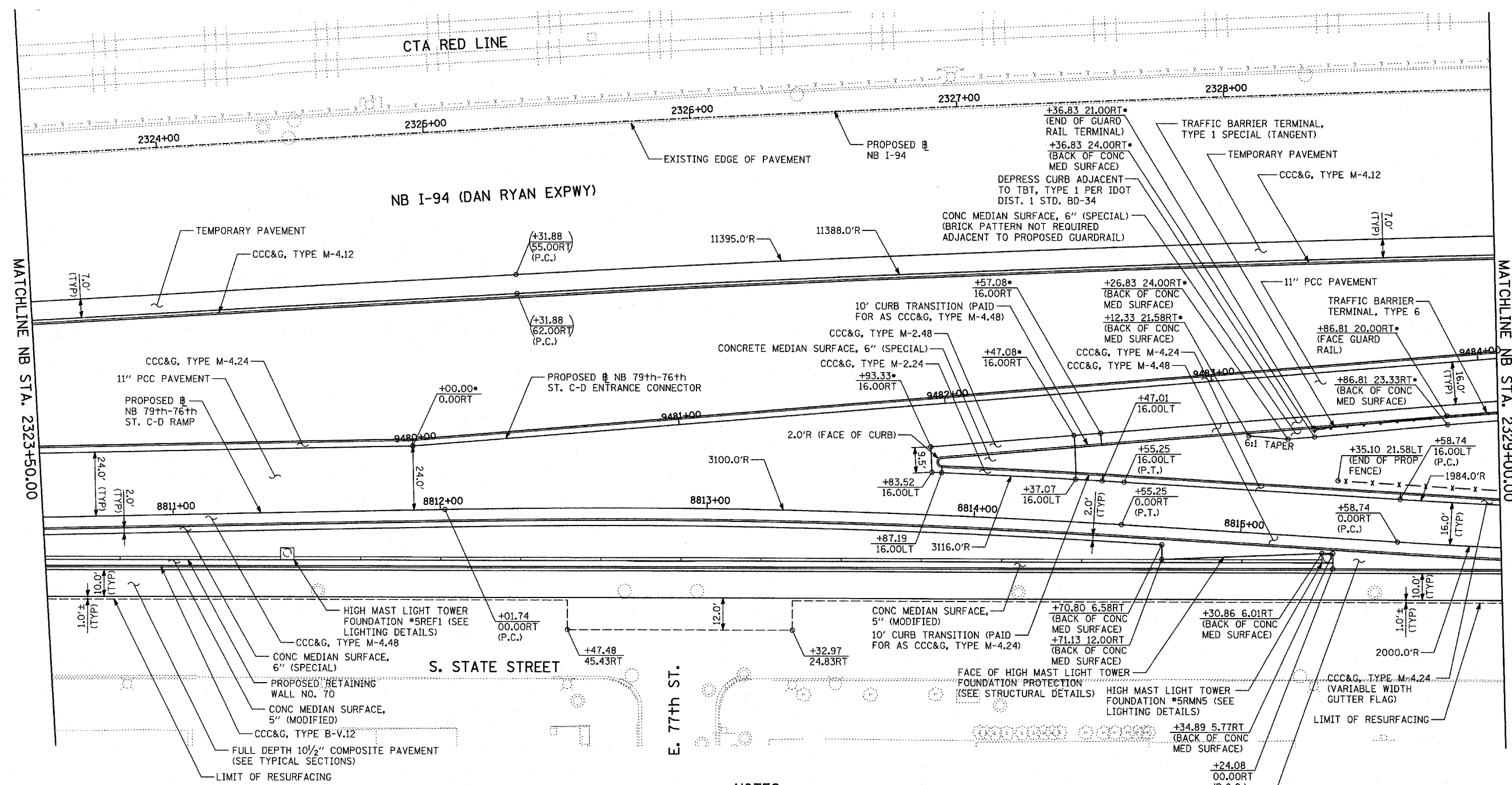

MATCHLINE NB STA. 2329+00.00

MATCHLINE NB STA. 2323+50.00

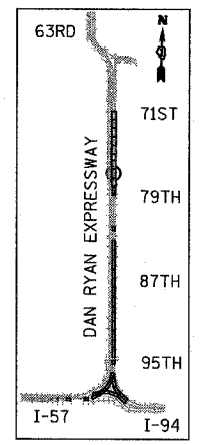

LOCATION MAP

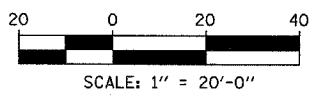

NOTES:

- THESE STATION/OFFSET CALLOUTS ARE BASED UPON THE 79th-76th C-D ENTRANCE CONNECTOR ALIGNMENT.

LEGEND:

	PAVEMENT REMOVAL		COMB CONC CURB & GUTTER REMOVAL		SOIL BORING LOCATIONS
	PAVED SHOULDER REMOVAL		CHAIN LINK FENCE REMOVAL		LIGHT POLE FOUNDATION REMOVAL (SEE EXISTING ELECTRICAL PLANS)
	PAVEMENT/SHOULDER REMOVAL, SPECIAL		CONCRETE BARRIER/GUARDRAIL REMOVAL		
			TREE REMOVAL (UNITS) (NO UNIT SHOWN = <6)		

NOTES:

- ALL STATION/OFFSET/RADIUS CALLOUTS MEASURED TO EDGE OF PAVEMENT UNLESS OTHERWISE NOTED.
- EXACT LOCATIONS OF EXISTING PIERS/ABUTMENTS TO BE FIELD VERIFIED

LEGEND:

- (+XX.XX XX.XXRT) MAINLINE & STATION/OFFSET
- +XX.XX XX.XXRT RAMP & STATION/OFFSET

REVISIONS	
NAME	DATE

ILLINOIS DEPARTMENT OF TRANSPORTATION
 F.A.I. 94 (DAN RYAN EXPRESSWAY)

PROPOSED PLAN
 NB 79th TO 76th STREET C-D RAMP
 NB I-94 STA. 2323+50.00 TO 2329+00.00

SCALE: 1"=20'
 DATE: MARCH 18, 2005

DRAWN BY: MPG
 CHECKED BY: JPM

TYLIN INTERNATIONAL